

0			

(SUBMIT IN TRIPLICATE)

UNITED STATES
DEPARTMENT OF THE INTERIOR
GEOLOGICAL SURVEY

Land Office **Navajo Agency**
Navajo Allotted Cont.
No. **Y-149-Ind.-9217**
Unit _____

SUNDRY NOTICES AND REPORTS ON WELLS

NOTICE OF INTENTION TO DRILL.....	<input checked="" type="checkbox"/>	SUBSEQUENT REPORT OF WATER SHUT-OFF.....	
NOTICE OF INTENTION TO CHANGE PLANS.....		SUBSEQUENT REPORT OF SHOOTING OR ACIDIZING.....	
NOTICE OF INTENTION TO TEST WATER SHUT-OFF.....		SUBSEQUENT REPORT OF ALTERING CASING.....	
NOTICE OF INTENTION TO RE-DRILL OR REPAIR WELL.....		SUBSEQUENT REPORT OF RE-DRILLING OR REPAIR.....	
NOTICE OF INTENTION TO SHOOT OR ACIDIZE.....		SUBSEQUENT REPORT OF ABANDONMENT.....	
NOTICE OF INTENTION TO PULL OR ALTER CASING.....		SUPPLEMENTARY WELL HISTORY.....	
NOTICE OF INTENTION TO ABANDON WELL.....			

(INDICATE ABOVE BY CHECK MARK NATURE OF REPORT, NOTICE, OR OTHER DATA)

January 19, 1959

Well No. **1** is located **1900** ft. from **N** line and **660** ft. from **E** line of sec. **11**
SW/4 Section 11 **24 North** **9 West** **187N**
(1/4 Sec. and Sec. No.) (Twp.) (Range) (Meridian)
Wilcox **San Juan** **New Mexico**
(Field) (County or Subdivision) (State or Territory)

The elevation of the derrick floor above sea level is **6647** ft.

DETAILS OF WORK

(State names of and expected depths to objective sands; show sizes, weights, and lengths of proposed casings; indicate mudding jobs, cementing points, and all other important proposed work)

Callup sandstone zone 5150-5300; 1 3/8" 48 pound casing to 250', 3-1/2" 17 pound casing to 5450'. Plan to drill to 5150', core 5150 to 5210', drill 5210 to 5280; core 5280 to 5340; drill 5340 to TD at about 5450. Set production string and selectively perforate and free and complete.

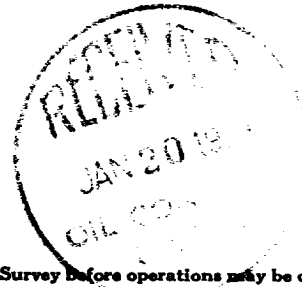

I understand that this plan of work must receive approval in writing by the Geological Survey before operations may be commenced.

Company **KERN COUNTY LAND COMPANY**

Address **304 Karber Building**

Albuquerque, New Mexico

By **John S. Baker**
John S. Baker
 Title **District Geologist**

NEW MEXICO OIL CONSERVATION COMMISSION
Well Location and Acreage Dedication Plat

Section A.

Date January 19, 1959

Operator KERN COUNTY LAND COMPANY Lease Navajo Allotted Cont. #I-149-Ind.-9217
Well No. 1 Unit Letter L Section 11 Township 24 North Range 9 West NMPM
Located 1980 Feet From south Line, 660 Feet From west Line
County San Juan G. L. Elevation 6637 Dedicated Acreage 40 Acres
Name of Producing Formation Gallup Pool wildcat

1. Is the Operator the only owner* in the dedicated acreage outlined on the plat below?
Yes X No _____.
2. If the answer to question one is "no," have the interests of all the owners been consolidated by communitization agreement or otherwise? Yes _____ No _____. If answer is "yes," Type of Consolidation _____
3. If the answer to question two is "no," list all the owners and their respective interests below:

<u>Owner</u>	<u>Land Description</u>
_____	_____
_____	_____
_____	_____

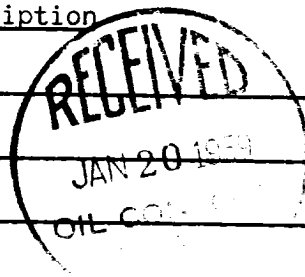

Section B

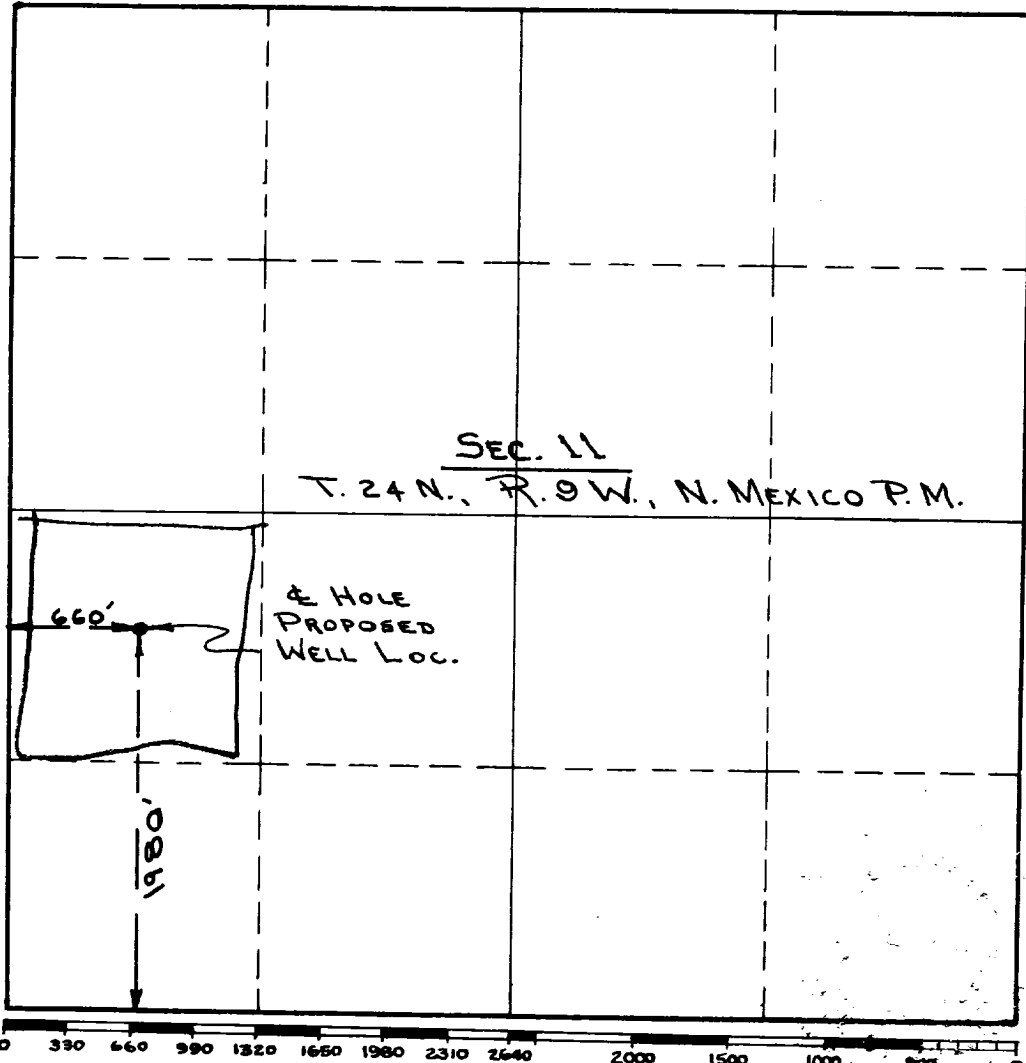

This is to certify that the information in Section A above is true and complete to the best of my knowledge and belief.

KERN COUNTY LAND COMPANY
(Operator)
C. W. Braddy
(Representative)
C. W. Braddy
304 Korber Building
Address Albuquerque, N.M.

This is to certify that the well location shown on the plat in Section B was plotted from field notes of actual surveys made by me or under my supervision and that the same is true and correct to the best of my knowledge and belief.

Date Surveyed 1-9-59

Salmon M. Clark
Registered Professional
Engineer and/or Land Surveyor.
APPLICATION FOR REGISTRATION
APPLIED FOR IN NEW MEXICO.
Certificate No. 2779-COLO.
the reverse side)

INSTRUCTIONS FOR COMPLETION:

1. Operator shall furnish and certify to the information called for in Section A.
2. Operator shall outline the dedicated acreage for both oil and gas wells on the plat in Section B.
3. A registered professional engineer or land surveyor registered in the State of New Mexico or approved by the Commission shall show on the plat the location of the well and certify this information in the space provided.
4. All distances shown on the plat must be from the outer boundaries of Section.
5. If additional space is needed for listing owners and their respective interests as required in question 3, Section A, please use space below

* "Owner" means the person who has the right to drill into and to produce from any pool and to appropriate the production either for himself or for himself and another. (65-3-29 (e) NMSA 1953 Comp.)

NEW MEXICO OIL CONSERVATION COMMISSION
WELL LOCATION AND ACREAGE DEDICATION PLAT

FORM C-128
 Revised 5/1/57

SEE INSTRUCTIONS FOR COMPLETING THIS FORM ON THE REVERSE SIDE

SECTION A

Operator KERN COUNTY LAND COMPANY		Lease Navajo Alotted Cont. #I-149-Ind.-		Well No. 1
Unit Letter L	Section 11	Township 24 North	Range 9 West	County San Juan
Actual Footage Location of Well: 1980 feet from the south line and 660 feet from the west line				
Ground Level Elev. 6637	Producing Formation Callup	Pool Wildcat	Dedicated Acreage: 40 Acres	

1. Is the Operator the only owner in the dedicated acreage outlined on the plat below? YES NO ____ . ("Owner" means the person who has the right to drill into and to produce from any pool and to appropriate the production either for himself or for himself and another. (65-3-29 (e) NMSA 1935 Comp.)
2. If the answer to question one is "no," have the interests of all the owners been consolidated by communitization agreement or otherwise? YES ____ NO ____ . If answer is "yes," Type of Consolidation ____
3. If the answer to question two is "no," list all the owners and their respective interests below:

Owner	Land Description

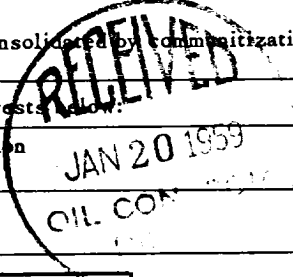

SECTION B

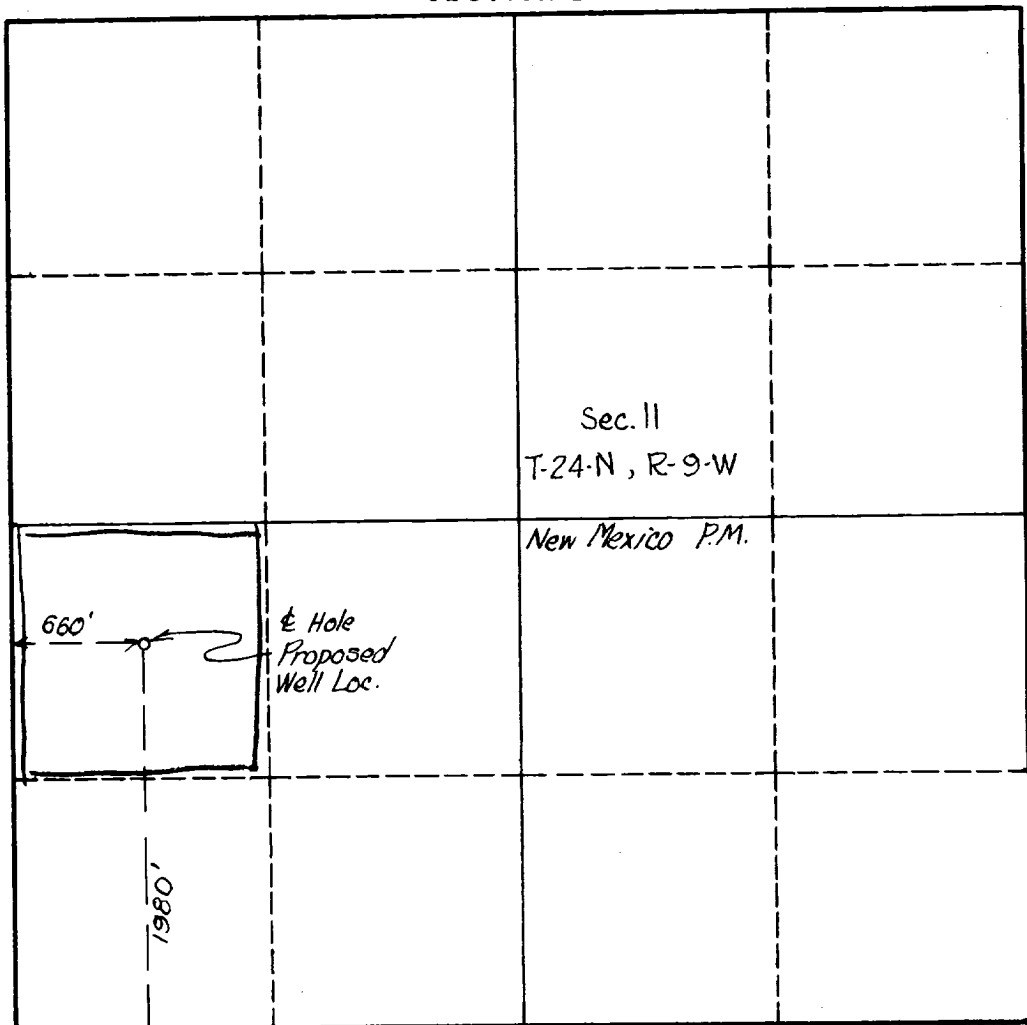

CERTIFICATION

I hereby certify that the information in SECTION A above is true and complete to the best of my knowledge and belief.

C. W. Brady

Name **C. W. Brady**
 Position **District Engineer**
 Company **KERN COUNTY LAND COMPANY**
 Date **January 19, 1959**

I hereby certify that the well location shown on the plat in SECTION B was plotted from field notes of actual surveys made by me or under my supervision, and that the same is true and correct to the best of my knowledge and belief.

Date Surveyed
January 9, 1959
 Registered Professional Engineer and/or Land Surveyor

s/Elmer M. Clark
 Certificate No.

2279 - Colorado

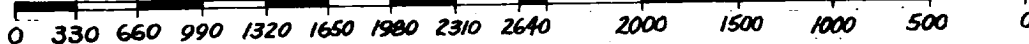

INSTRUCTIONS FOR COMPLETION OF FORM C-128

1. Operator shall furnish and certify to the information called for in Section A.
2. Operator shall outline the dedicated acreage for *both* oil and gas wells on the plat in Section B.
3. A registered professional engineer or land surveyor registered in the State of New Mexico or approved by the Commission shall show on the plat the location of the well and certify this information in the space provided.
4. All distances shown on the plat must be from the outer boundaries of the Section.
5. If additional space is needed for listing owners and their respective interests as required in question 3 of Section A, please use space below.

CERTIFICATE OF SURVEY

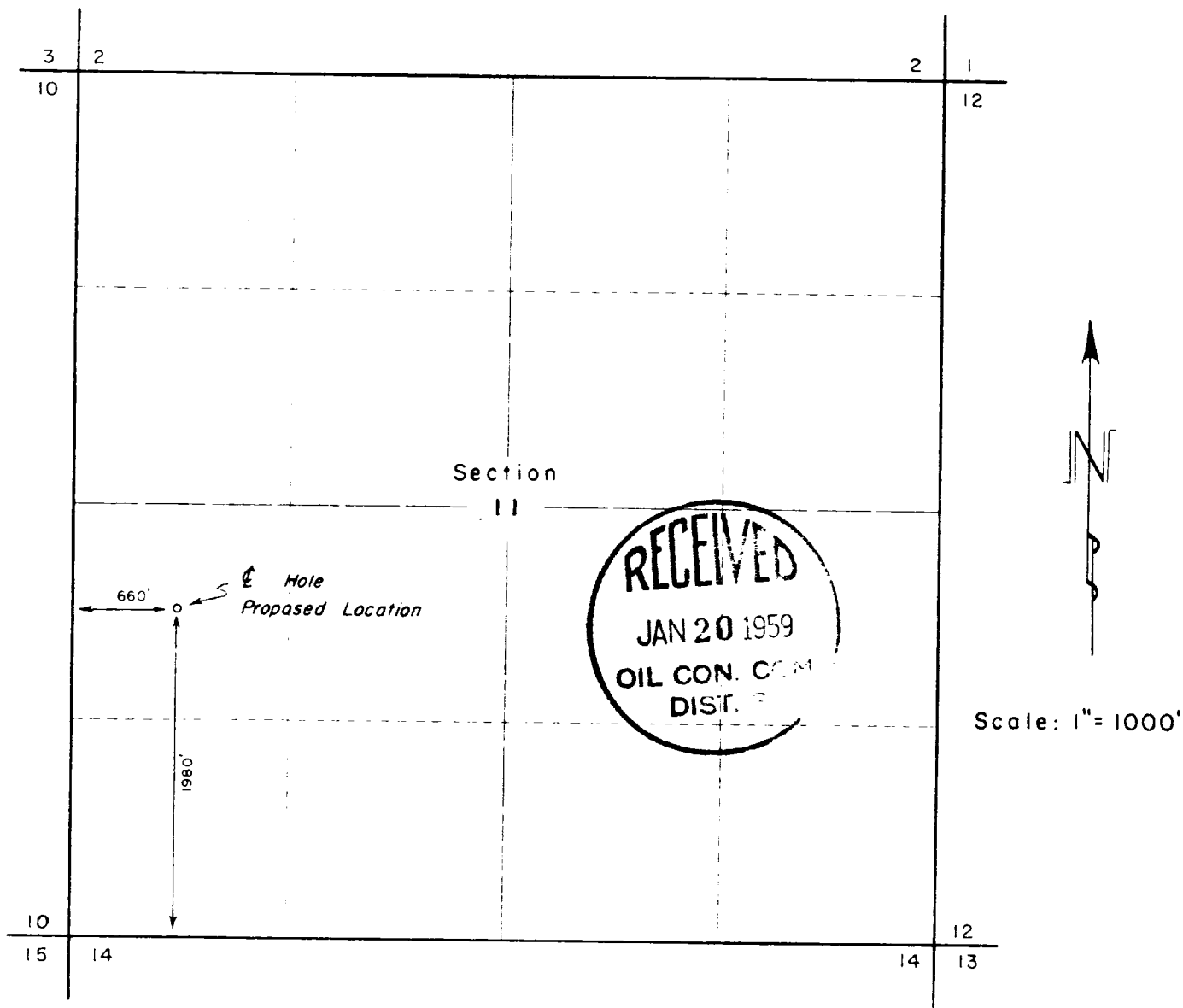

WELL LOCATION: Kern County Land Co. - Magnolia - Navajo No. 1

Located 660 feet East of the West line and 1980 feet North of the South line of Section 11,
 Township 24 North, Range 9 West, New Mexico Principal Meridian,
 San Juan County, New Mexico
 Existing ground elevation determined at 6637 feet based on adjoining well locations.

I hereby certify the above plat represents a survey made under my supervision and is accurate to the best of my knowledge and belief.

Elmer M. Clark

ELMER M. CLARK
 Registered Land Surveyor
 State of Colo (No 2279)

E. M. CLARK & ASSOCIATES
 Durango, Colorado
 January 11, 1959