

(SUBMIT IN TRIPLICATE)

UNITED STATES
DEPARTMENT OF THE INTERIOR
GEOLOGICAL SURVEY

Land Office Santa Fe
Lease No. SF 078241
Unit E. H. Hoggie

SUNDRY NOTICES AND REPORTS ON WELLS

NOTICE OF INTENTION TO DRILL	<input checked="" type="checkbox"/>	SUBSEQUENT REPORT OF WATER SHUT-OFF	<input type="checkbox"/>
NOTICE OF INTENTION TO CHANGE PLANS	<input type="checkbox"/>	SUBSEQUENT REPORT OF SHOOTING OR ACIDIZING	<input type="checkbox"/>
NOTICE OF INTENTION TO TEST WATER SHUT-OFF	<input type="checkbox"/>	SUBSEQUENT REPORT OF ALTERING CASING	<input type="checkbox"/>
NOTICE OF INTENTION TO RE-DRILL OR REPAIR WELL	<input type="checkbox"/>	SUBSEQUENT REPORT OF RE-DRILLING OR REPAIR	<input type="checkbox"/>
NOTICE OF INTENTION TO SHOOT OR ACIDIZE	<input type="checkbox"/>	SUBSEQUENT REPORT OF ABANDONMENT	<input type="checkbox"/>
NOTICE OF INTENTION TO PULL OR ALTER CASING	<input type="checkbox"/>	SUPPLEMENTARY WELL HISTORY	<input type="checkbox"/>
NOTICE OF INTENTION TO ABANDON WELL	<input type="checkbox"/>		<input type="checkbox"/>

(INDICATE ABOVE BY CHECK MARK NATURE OF REPORT, NOTICE, OR OTHER DATA)

E. H. Hoggie

Farmington, New Mexico May 5, 1959

Well No. 1 is located 1980 ft. from N line and 1980 ft. from E line of sec. 8

NE/4 Section 8 T-24-N R-9-W N.M.P.M.
($\frac{1}{4}$ Sec. and Sec. No.) (Twp.) (Range) (Meridian)
Bigi-Lower Gallup San Juan New Mexico
(Field) (County or Subdivision) (State or Territory)

The elevation of the derrick floor above sea level is _____ ft. (To be reported later.)

DETAILS OF WORK

(State names of and expected depths to objective sands; show sizes, weights, and lengths of proposed casings; indicate mudding jobs, cementing points, and all other important proposed work)

We propose to drill the above well to a depth of approximately 5600' and complete in the Gallup zone. Stimulation will be as indicated on reaching this depth. Rotary tools will be used to total depth.

Proposed casing program is as follows:

SIZE	DEPTH	CEMENT	REMARKS
8-5/8"	200'	---	Amount of cement to circulate.
5-1/2"	5600'	---	150% of theoretical fill.

Copies of location plat are attached. A copy of any survey taken will be submitted upon completion of well.

I understand that this plan of work must receive approval in writing by the Geological Survey before operations may be commenced.

Company Pan American Petroleum Corporation

Address Box 487

Farmington, New Mexico

ORIGINAL SIGNED BY
By R. M. Bauer, Jr.

Title Field Engineer

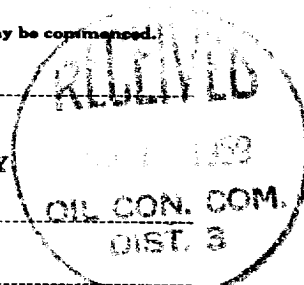

NEW MEXICO OIL CONSERVATION COMMISSION

Well Location and Acreage Dedication Plat

Section A.

Date May 5, 1959

Operator PAN AMERICAN PETROLEUM CORPORATION Lease E. H. HEGGIE
Well No. 1 Unit Letter G Section 8 Township 24 NORTH Range 9 WEST NMPM
Located 1980 Feet From NORTH Line, 1980 Feet From EAST Line
County SAN JUAN G. L. Elevation * Dedicated Acreage 80 Acres
Name of Producing Formation GALLUP Pool BISTI LOWER GALLUP

1. Is the Operator the only owner* in the dedicated acreage outlined on the plat below?
Yes ☒ No ☐ *TO BE REPORTED LATER
2. If the answer to question one is "no," have the interests of all the owners been consolidated by communitization agreement or otherwise? Yes ☐ No ☐ If answer is "yes,"
Type of Consolidation _____
3. If the answer to question two is "no," list all the owners and their respective interests below:

Owner

Land Description

Section B

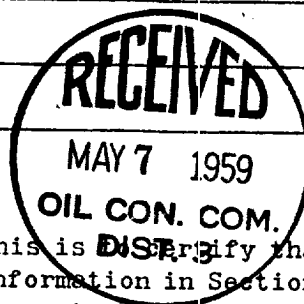
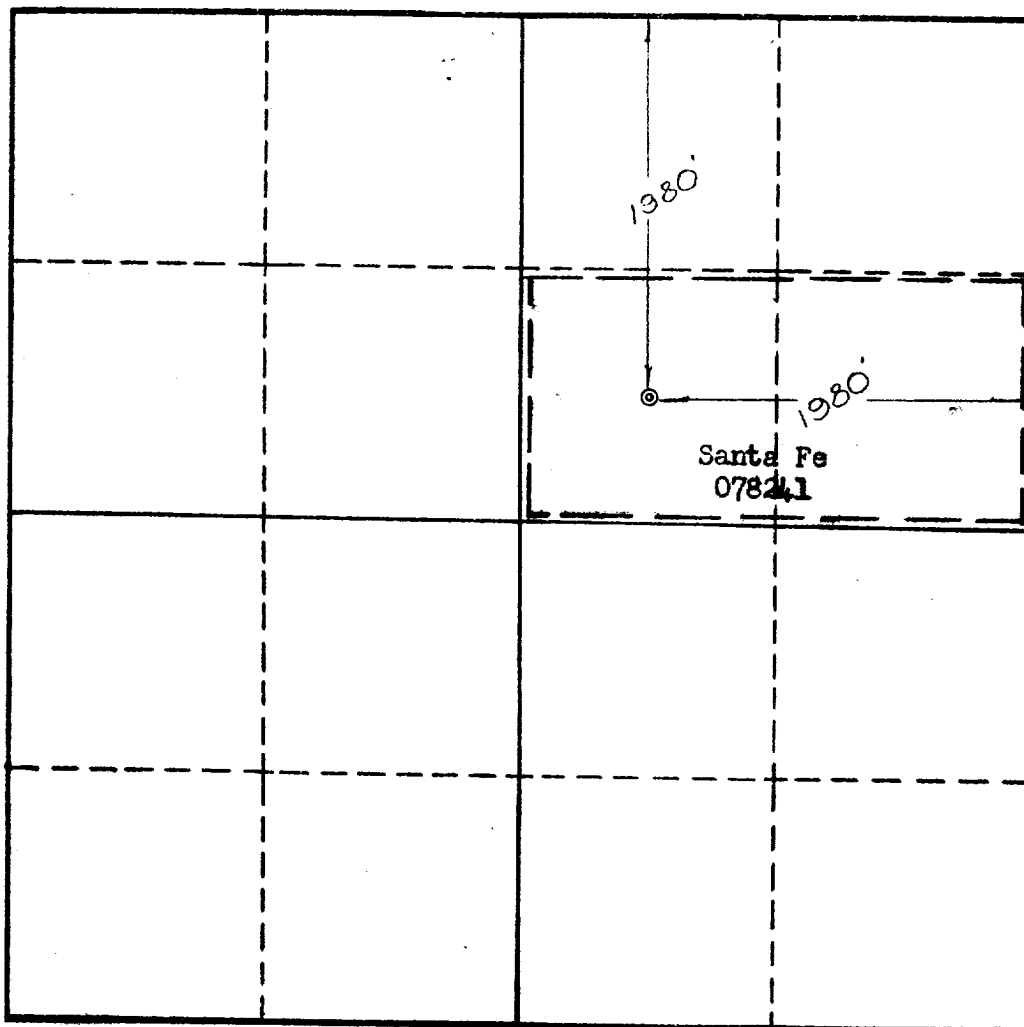

This is to certify that the information in Section A above is true and complete to the best of my knowledge and belief.

PAN AMERICAN PETROLEUM CORP.
(Operator)

R. M. Bauer, Jr. *RMB*
(Representative)

Box 487, Farmington, New Mexico
Address

This is to certify that the well location shown on the plat in Section B was plotted from field notes and other surveys made by me or under my supervision and that the same is true to the best of my knowledge and belief.

Date Surveyed May 4, 1959

Ernest V. Echoshawk
Ernest V. Echoshawk
Registered Land Surveyor.

Certificate No. 1545

