

(SUBMIT IN TRIPLICATE)

UNITED STATES  
DEPARTMENT OF THE INTERIOR  
GEOLOGICAL SURVEY

Land Office Sante Fe  
Lease No. 078301  
Unit F

Section 12

SUNDRY NOTICES AND REPORTS ON WELLS

NOTICE OF INTENTION TO DRILL	<input checked="" type="checkbox"/>	SUBSEQUENT REPORT OF WATER SHUT-OFF	
NOTICE OF INTENTION TO CHANGE PLANS		SUBSEQUENT REPORT OF SHOOTING OR ACIDIZING	
NOTICE OF INTENTION TO TEST WATER SHUT-OFF		SUBSEQUENT REPORT OF ALTERING CASING	
NOTICE OF INTENTION TO RE-DRILL OR REPAIR WELL		SUBSEQUENT REPORT OF RE-DRILLING OR REPAIR	
NOTICE OF INTENTION TO SHOOT OR ACIDIZE		SUBSEQUENT REPORT OF ABANDONMENT	
NOTICE OF INTENTION TO PULL OR ALTER CASING		SUPPLEMENTARY WELL HISTORY	
NOTICE OF INTENTION TO ABANDON WELL			

(INDICATE ABOVE BY CHECK MARK NATURE OF REPORT, NOTICE, OR OTHER DATA)

10/1, 1959

Well No. Federal 9-12 is located 1980 ft. from N line and 1980 ft. from E line of sec. 12  
SE, NW, Sec 12 24N 10W N 104 W  
(1/4 Sec. and Sec. No.) (Twp.) (Range) (Meridian)  
Bisti-Lower Gallup San Juan New Mexico  
(Field) (County or Subdivision) (State or Territory)

The elevation of the derrick floor above sea level is \_\_\_\_\_ ft. Will report later

DETAILS OF WORK

(State names of and expected depths to objective sands; show sizes, weights, and lengths of proposed casings; indicate mudding jobs, cementing points, and all other important proposed work)

Notice is hereby given of intention to drill the Federal 9-12 #4 in the Bisti-Lower Gallup field. A 12 1/4" hole will be drilled to a depth of 300 ft. and 8-5/8" csg will be set at that point. Cement will be circulated to surface and the casing will be tested with 1000psi water pressure after WOC for 24 hours. A 7-7/8" hole will then be drilled to a TD of approximately 5550' and 5 1/2" csg will be set there with 300 sx neat cement. The casing will be tested with 1500 psi water pressure after WOC for 30 hours. The Marye and Huerfano sands will be perforated, the well will be fraced, and ~~in~~ after cleaning out, the well will be placed on production.

I understand that this plan of work must receive approval in writing by the Geological Survey before operations may be commenced.

Company Standard Oil Company of Texas  
Address Box 1531  
Farmington, New Mexico By [Signature]  
Title Field Foreman

NEW MEXICO OIL CONSERVATION COMMISSION  
WELL LOCATION AND ACREAGE DEDICATION PLAT

FORM C-128  
Revised 5/1/57

SEE INSTRUCTIONS FOR COMPLETING THIS FORM ON THE REVERSE SIDE

SECTION A

Operator <b>STANDARD OIL COMPANY OF TEXAS</b>		Lease <b>FEDERAL 9 - 12 (073301)</b>		Well No. <b>4</b>
Unit Letter <b>F</b>	Section <b>12</b>	Township <b>24 NORTH</b>	Range <b>10 WEST</b>	County <b>SAN JUAN</b>

Actual Footage Location of Well:  
**1980** feet from the **NORTH** line and **1980** feet from the **WEST** line

Ground Level Elev. <b>Will report later</b>	Producing Formation <b>Gallup</b>	Pool <b>Histi-Lower Gallup</b>	Dedicated Acreage: <b>80</b> Acres
--	--------------------------------------	-----------------------------------	---------------------------------------

Ref: GLO plat dated 24 June 1935

1. Is the Operator the only owner in the dedicated acreage outlined on the plat below? YES ☐ NO ☒. ("Owner" means the person who has the right to drill into and to produce from any pool and to appropriate the production either for himself or for himself and another. (65-3-29 (e) NMSA 1935 Comp.)
2. If the answer to question one is "no," have the interests of all the owners been consolidated by communitization agreement or otherwise? YES ☒ NO ☐. If answer is "yes," Type of Consolidation **Designated Operator**
3. If the answer to question two is "no," list all the owners and their respective interests below:

Owner	Land Description

SECTION B

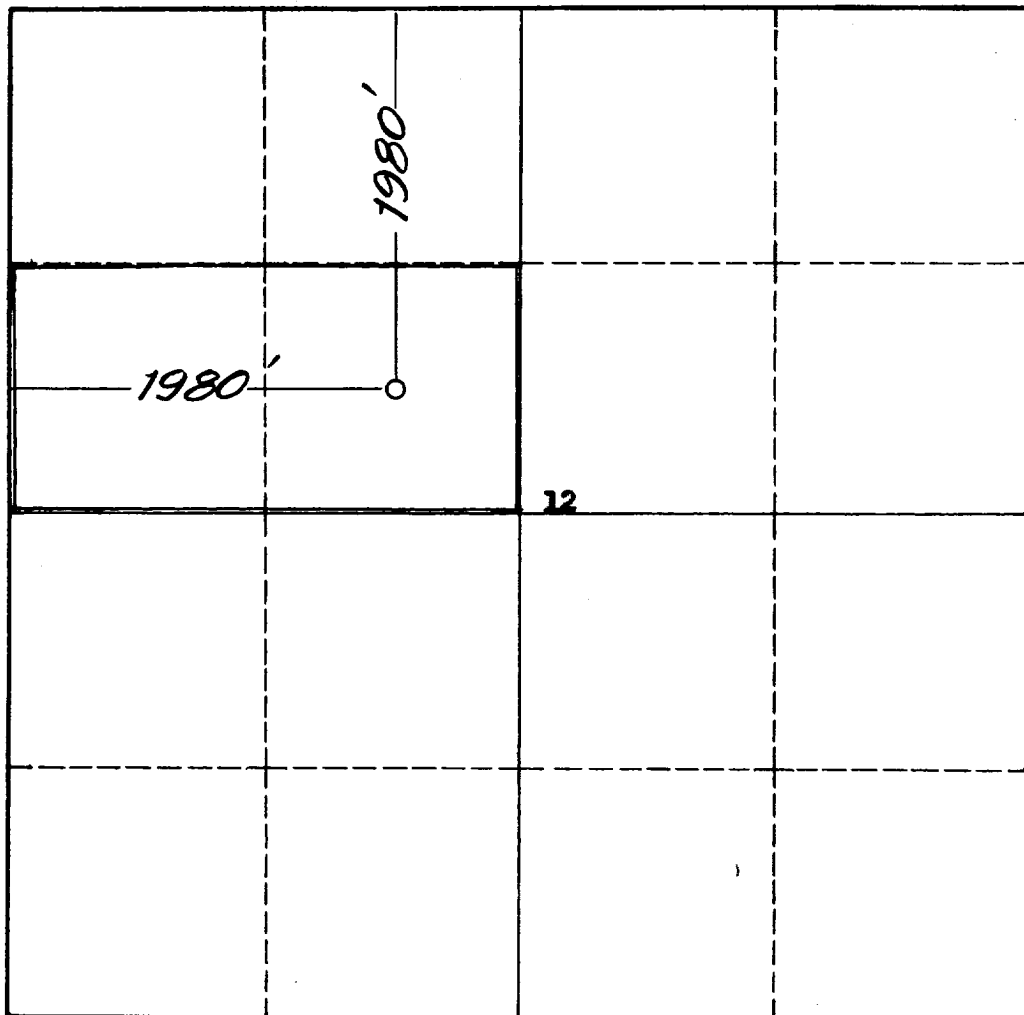

I hereby certify that the information in SECTION A above is true and complete to the best of my knowledge and belief.

Name <i>J. L. Lantry</i>
Position <b>Field Force</b>
Company <b>Standard Oil Co. of Texas</b>
Date <b>10/1/59</b>

I hereby certify that the well location shown on the plat in SECTION B was plotted from field notes of actual surveys made by me or under my supervision, and that the same is true and correct to the best of my knowledge and belief.

Date Surveyed <b>29 September 1959</b>
Registered Professional Engineer and/or Land Surveyor <i>James P. Leno</i>
Certificate No. <b>1463</b>

0 330 660 990 1320 1650 1980 2310 2640 2000 1500 1000 500 0

## INSTRUCTIONS FOR COMPLETION OF FORM C-128

1. Operator shall furnish and certify to the information called for in Section A.
2. Operator shall outline the dedicated acreage for *both* oil and gas wells on the plat in Section B.
3. A registered professional engineer or land surveyor registered in the State of New Mexico or approved by the Commission shall show on the plat the location of the well and certify this information in the space provided.
4. All distances shown on the plat must be from the outer boundaries of the Section.
5. If additional space is needed for listing owners and their respective interests as required in question 3 of Section A, please use space below.