

MEXICO OIL CONSERVATION COMMISSION
WELL LOCATION AND ACREAGE DEDICATION PLAT

Form C-102
Supersedes C-128
Effective 1-1-65

OK

All distances must be from the outer boundaries of the Section.

| | | | | | |
|---|---------------------------------------|---|------------------------|---------------------------------------|----------------------|
| Operator Dugan Production Corporation | | | Lease Big 8 | | Well No. 1 |
| Unit Letter L | Section 8 | Township 24 North | Range 9 West | County San Juan | |
| Actual Footage Location of Well: | | | | | |
| 1530 feet from the South line and | | 840 feet from the West line | | | |
| Ground Level Elev. 6771 | Producing Formation Wildcat | Pool Greenhorn | | Dedicated Acreage: 40 Acres | |

1. Outline the acreage dedicated to the subject well by colored pencil or hachure marks on the plat below.
2. If more than one lease is dedicated to the well, outline each and identify the ownership thereof (both as to working interest and royalty).
3. If more than one lease of different ownership is dedicated to the well, have the interests of all owners been consolidated by communitization, unitization, force-pooling, etc?

☐ Yes ☐ No If answer is "yes," type of consolidation _____

If answer is "no," list the owners and tract descriptions which have actually been consolidated. (Use reverse side of this form if necessary.) _____

No allowable will be assigned to the well until all interests have been consolidated (by communitization, unitization, forced-pooling, or otherwise) or until a non-standard unit, eliminating such interests, has been approved by the Commission.

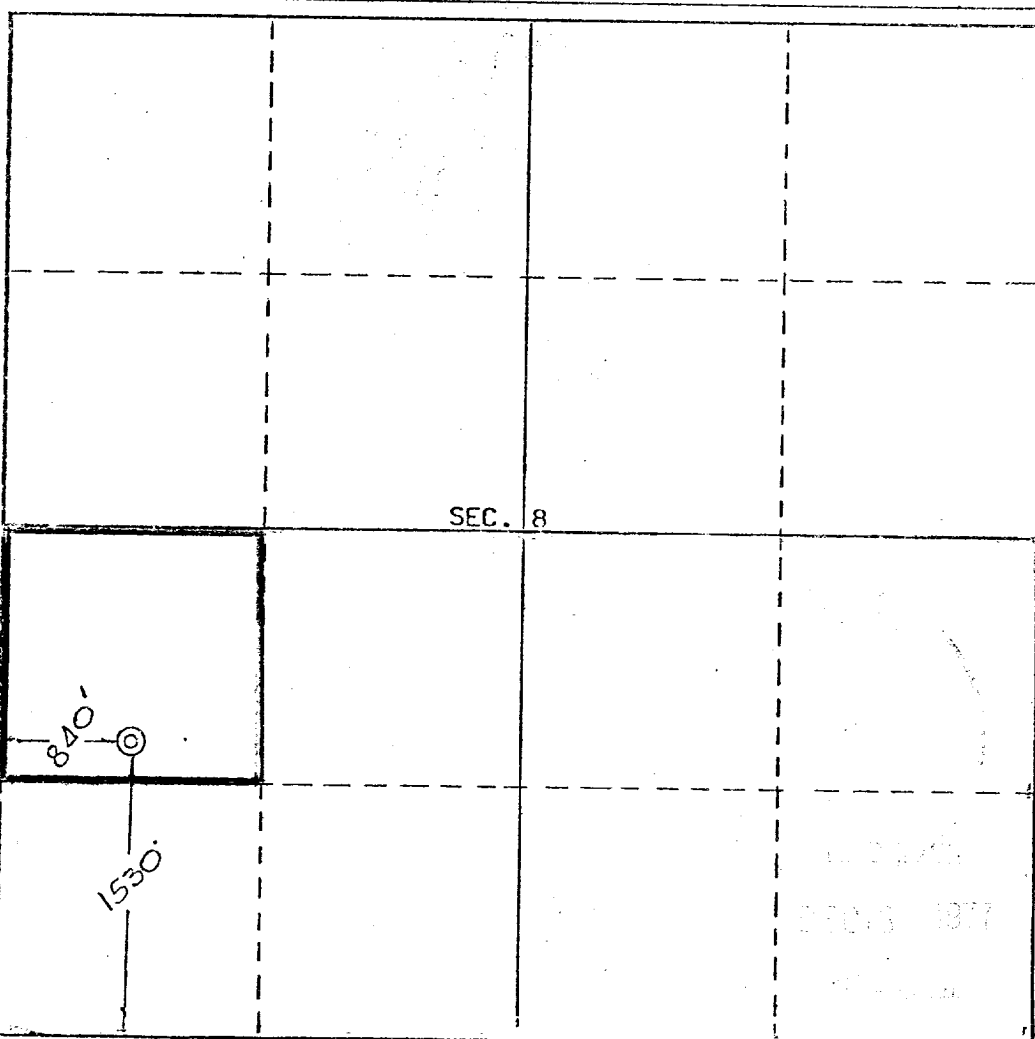

CERTIFICATION

I hereby certify that the information contained herein is true and complete to the best of my knowledge and belief.

Jim L. Jacobs

Name
Jim L. Jacobs

Position
Geologist

Company
Dugan Production Corp.

Date
12-6-77

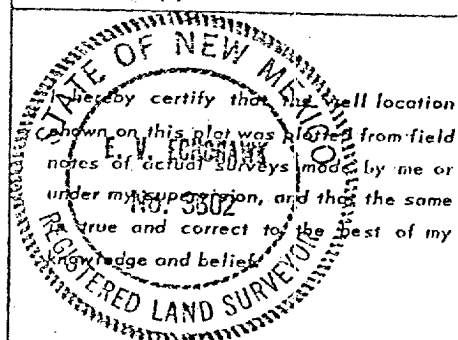

Date Surveyed
February 2, 1976

Registered Professional Engineer
and/or Land Surveyor

E.V. Echhawk

Certificate No. 3602
E.V. Echhawk L.S.