

UNITED STATES
DEPARTMENT OF THE INTERIOR
GEOLOGICAL SURVEY

APPLICATION FOR PERMIT TO DRILL, DEEPEN, OR PLUG BACK

1a. TYPE OF WORK
DRILL ☒ DEEPEN ☐ PLUG BACK ☐

b. TYPE OF WELL
OIL WELL ☒ GAS WELL ☐ OTHER ☐ SINGLE ZONE ☒ MULTIPLE ZONE ☐

2. NAME OF OPERATOR
J. Gregory Merrion & Robert L. Bayless

3. ADDRESS OF OPERATOR
P.O. Box 1541, Farmington, NM 87401

4. LOCATION OF WELL (Report location clearly and in accordance with any State requirements.)*
At surface 1920' FNL & 1800' FEL
At proposed prod. zone 2020' same

14. DISTANCE IN MILES AND DIRECTION FROM NEAREST TOWN OR POST OFFICE*

15. DISTANCE FROM PROPOSED* LOCATION TO NEAREST PROPERTY OR LEASE LINE, FT. (Also to nearest drlg. unit line, if any)

16. NO. OF ACRES IN LEASE
318.63

17. NO. OF ACRES ASSIGNED TO THIS WELL
40

18. DISTANCE FROM PROPOSED LOCATION* TO NEAREST WELL, DRILLING COMPLETED, OR APPLIED FOR, ON THIS LEASE, FT.

19. PROPOSED DEPTH
6100 ft.

20. ROTARY OR CABLE TOOLS
Rotary

21. ELEVATIONS (Show whether DF, RT, GR, etc.)
6959' GL

22. APPROX. DATE WORK WILL START*
09-30-81

23. PROPOSED CASING AND CEMENTING PROGRAM

SIZE OF HOLE	SIZE OF CASING	WEIGHT PER FOOT	SETTING DEPTH	QUANTITY OF CEMENT
12-1/4"	8-5/8"	28#	200'	175 sacks
7-7/8"	4-1/2"	10.5#	6100'	875 sacks

Will drill 12-1/4" hole to 200 ft. and set 200 ft. of 8-5/8", 28#, used casing with 175 sacks cement. Will drill 7-7/8" hole to 6100 ft. and run open hole logs. If appears productive will run 6100 ft. of 4-1/2", 10.5#, new casing and cement with 875 sacks. Will set stage collar at approximately 4750 ft. and bring cement up across Ojo Alamo formation. Will perforate and stimulate as required. Minimum specifications for pressure control equipment which is to be used: 10", 900 series double ram BOP.

ESTIMATED TOPS

Formation	Depth	Content
Ojo Alamo	1500'	
Pictured Cliffs	2175'	salt water
Mesa Verde	2990'	salt water
Gallup	5580'	oil, salt water

IN ABOVE SPACE DESCRIBE PROPOSED PROGRAM: If proposal is to deepen or plug back, give data on present productive zone and proposed new productive zone. If proposal is to drill or deepen directionally, give pertinent data on subsurface locations and measured and true vertical depths. Give blowout preventer program, if any.

24. SIGNED [Signature] TITLE Engineer DATE August 26, 1981
(This space for Federal or State office use)

PERMIT NO. _____ APPROVAL DATE _____

APPROVED BY _____ TITLE _____
CONDITIONS OF APPROVAL, IF ANY:

APPROVED
AS AMENDED

JAMES F. SHAW
DISTRICT ENGINEER

All distances must be from the outer boundaries of the Section.

Operator: MERRION & BAYLESS			Lease Scarecrow		Well No. 2
Unit Letter G	Section 4	Township 24N	Range 8W	County San Juan	
Actual Footage Location of Well: 1920 feet from the North line and 1800 feet from the East line					
Ground Level Elev: 6959	Producing Formation Gallup		Pool Wildcat	Dedicated Acreage: 40 Acres	

1. Outline the acreage dedicated to the subject well by colored pencil or hatchure marks on the plat below.
2. If more than one lease is dedicated to the well, outline each and identify the ownership thereof (both as to working interest and royalty).
3. If more than one lease of different ownership is dedicated to the well, have the interests of all owners been consolidated by communitization, unitization, force-pooling, etc?

☐ Yes ☐ No If answer is "yes," type of consolidation _____

If answer is "no," list the owners and tract descriptions which have actually been consolidated. (Use reverse side of this form if necessary.) _____

No allowable will be assigned to the well until all interests have been consolidated (by communitization, unitization, forced-pooling, or otherwise) or until a non-standard unit, eliminating such interests, has been approved by the Commission.

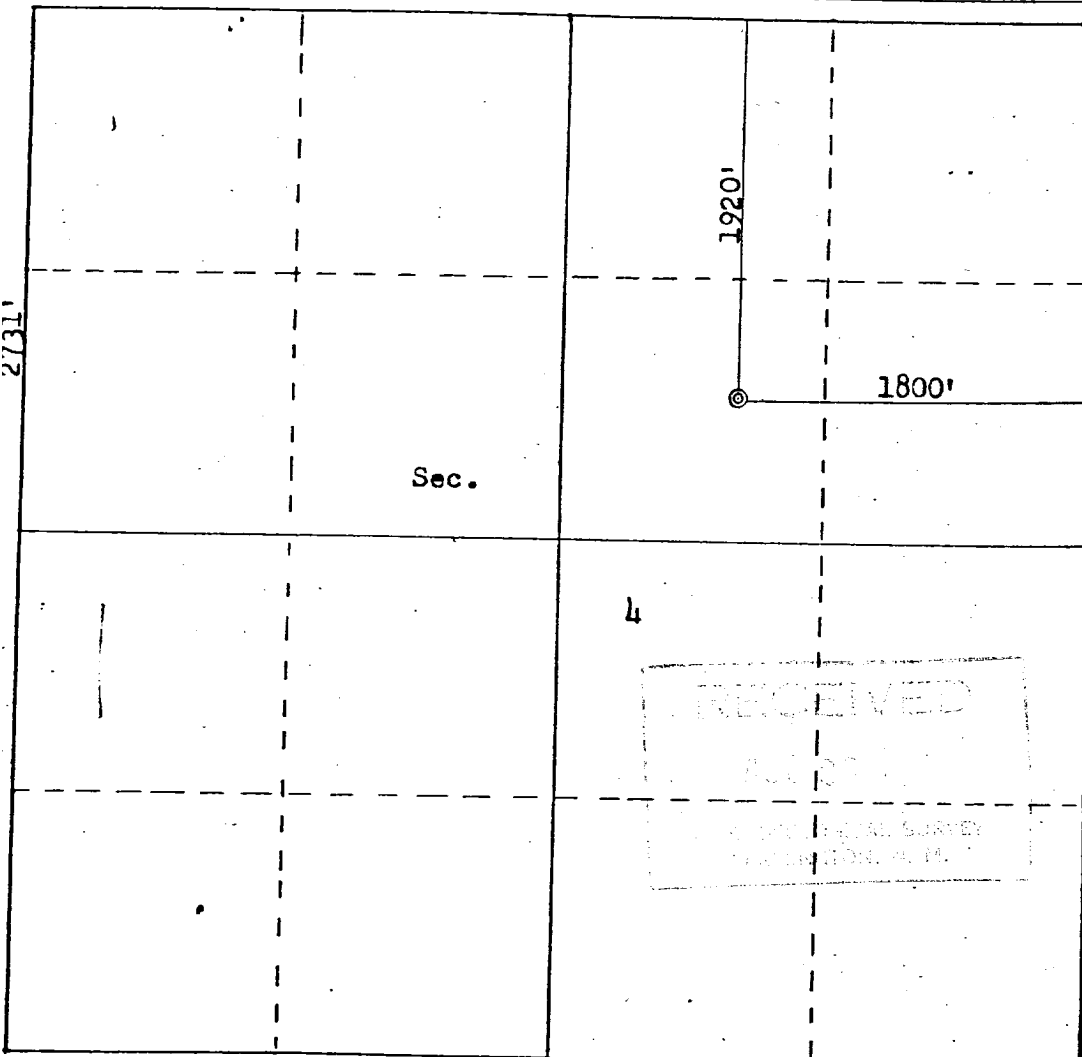

Scale: 1"=1000'

CERTIFICATION	
I hereby certify that the information contained herein is true and complete to the best of my knowledge and belief.	
<i>Steven S. Dunn</i>	
Name	Steven S. Dunn
Position	Engineer
Company	Merrion & Bayless
Date	August 26, 1981
I hereby certify that the well location shown on this plat was plotted from field notes of actual surveys made by me or under my supervision, and that the same is true and correct to the best of my knowledge and belief.	
Date Surveyed	August 21, 1981
Registered Professional Engineer and Land Surveyor	
<i>Fred B. Kerr, Jr.</i>	
Certificate No.	3950