

**District I**

1625 N. French Dr., Hobbs, NM 88240

**District II**

811 South First, Artesia, NM 88210

**District III**

1000 Rio Brazos Road, Aztec, NM 87410

**District IV**

1220 S. St. Francis Dr., Santa Fe, NM 87505

State of New Mexico  
Energy Minerals and Natural Resources

Oil Conservation Division

1220 South St. Francis Dr.

Santa Fe, NM 87505

Form C-101

Revised March 17, 1999

Submit to appropriate District Office

State Lease - 6 Copies

Fee Lease - 5 Copies

☐ AMENDED REPORT**APPLICATION FOR PERMIT TO DRILL, RE-ENTER, DEEPEN, PLUGBACK, OR ADD A ZONE**

|   |   |   |
|---|---|---|
| <sup>1</sup> Operator Name and Address<br><b>Yates Petroleum Corporation (505) 748-1471</b> |   | <sup>2</sup> OGRID Number<br><b>25575</b>   |
| <b>105 South 4th St., Artesia, NM 88210</b>   |   | <sup>3</sup> API Number<br><b>245-30659</b> |
| <sup>4</sup> Property Code<br><b>28012</b>  | <sup>5</sup> Property Name<br><b>Ristra AGW</b> | <sup>6</sup> Well No.<br><b>2</b>           |

<sup>7</sup> Surface Location

| UL or lot no. | Section   | Township   | Range     | Lot Idn | Feet from the | North/South line | Feet from the | East/West line | County    |
|---------------|-----------|------------|-----------|---------|---------------|------------------|---------------|----------------|-----------|
| <b>N</b>      | <b>32</b> | <b>24n</b> | <b>9w</b> |         | <b>683</b>    | <b>South</b>     | <b>2080</b>   | <b>West</b>    | <b>SJ</b> |

<sup>8</sup> Proposed Bottom Hole Location If Different From Surface

| UL or lot no. | Section | Township | Range | Lot Idn | Feet from the | North/South line | Feet from the | East/West line | County |
|---------------|---------|----------|-------|---------|---------------|------------------|---------------|----------------|--------|
|               |         |          |       |         |               |                  |               |                |        |

|   |                               |
|---|-------------------------------|
| <sup>9</sup> Proposed Pool 1<br><b>Bisti Lower Gallup</b> | <sup>10</sup> Proposed Pool 2 |
|---|-------------------------------|

|  |   |  |   |  |
|--|---|--|---|--|
| <sup>11</sup> Work Type Code<br><b>N</b> | <sup>12</sup> Well Type Code<br><b>O</b>      | <sup>13</sup> Cable/Rotary<br><b>R</b>   | <sup>14</sup> Lease Type Code<br><b>S</b> | <sup>15</sup> Ground Level Elevation<br><b>6820'</b> |
| <sup>16</sup> Multiple<br><b>No</b>      | <sup>17</sup> Proposed Depth<br><b>5,060'</b> | <sup>18</sup> Formation<br><b>Mancos</b> | <sup>19</sup> Contractor                  | <sup>20</sup> Spud Date<br><b>6-15-01</b>            |

<sup>21</sup> Proposed Casing and Cement Program

| Hole Size      | Casing Size   | Casing weight/foot | Setting Depth | Sacks of Cement | Estimated TOC  |
|----------------|---------------|--------------------|---------------|-----------------|----------------|
| <b>12-1/4"</b> | <b>8-5/8"</b> | <b>24</b>          | <b>275'</b>   | <b>180 sx</b>   | <b>Surface</b> |
| <b>7-7/8"</b>  | <b>5-1/2"</b> | <b>15.5</b>        | <b>5,060'</b> | <b>900 sx</b>   | <b>Surface</b> |
|                |               |                    |               |                 |                |
|                |               |                    |               |                 |                |
|                |               |                    |               |                 |                |

<sup>22</sup> Describe the proposed program. If this application is to DEEPEN or PLUG BACK, give the data on the present productive zone and proposed new productive zone.

Describe the blowout prevention program, if any. Use additional sheets if necessary.

**Will use 2000# BOP and run logs and DST as appropriate.****Will set DV tool at ≈3500'. Volumes caculated @ ≈66% excess.**<sup>23</sup> I hereby certify that the information given above is true and complete to the best of my knowledge and belief.

Signature:

Printed name:

Title: **Consultant**Date: **April 24, 2001**Phone: **(505) 466-8120**

## OIL CONSERVATION DIVISION

Approved by:

Title:

Approved:

Conditions of Approval:

Attached ☐**DEPUTY OIL & GAS INSPECTOR, DIST. 35****25 2001**

Ex:

**AF****25 2002**

State of New Mexico  
Energy, Minerals & Mining Resources Department

Form C - 102

OIL CONSERVATION DIVISION  
2040 South Pacheco  
Santa Fe, NM 87505

☐ AMENDED REPORT

WELL LOCATION AND ACREAGE DEDICATION PLAT

|                            |  |                                 |
|----------------------------|--|---------------------------------|
| APA Number<br>30-045-30659 | Pool Code<br>5890                            | Pool Name<br>BISTI LOWER GALLUP |
| Property Code<br>28012     | Property Name<br>RISTRA AGW STATE            | Well Number<br>2                |
| OGRID No.<br>25575         | Operator Name<br>YATES PETROLEUM CORPORATION | Elevation<br>6820' --           |

| Surface Location |            |               |              |          |                     |                      |                      |                   |                    |
|------------------|------------|---------------|--------------|----------|---------------------|----------------------|----------------------|-------------------|--------------------|
| UL or Lot<br>N.  | Sec.<br>32 | Twp.<br>24 N. | Rge.<br>9 W. | Lot Idn. | Feet from ><br>683' | North/South<br>SOUTH | Feet from ><br>2080' | East/West<br>WEST | County<br>SAN JUAN |

| Bottom Hole Location If Different From Surface |      |      |      |          |             |             |             |           |        |
|--|------|------|------|----------|-------------|-------------|-------------|-----------|--------|
| UL or Lot                                      | Sec. | Twp. | Rge. | Lot Idn. | Feet from > | North/South | Feet from > | East/West | County |

|                        |         |               |           |
|------------------------|---------|---------------|-----------|
| Dedication<br>80 (M+N) | Joint ? | Consolidation | Order No. |
|------------------------|---------|---------------|-----------|

NO ALLOWABLE WILL ASSIGNED TO THIS COMPLETION UNTIL ALL INTERESTS HAVE BEEN CONSOLIDATED  
OR A NON-STANDARD UNIT HAS BEEN APPROVED BY THE DIVISION

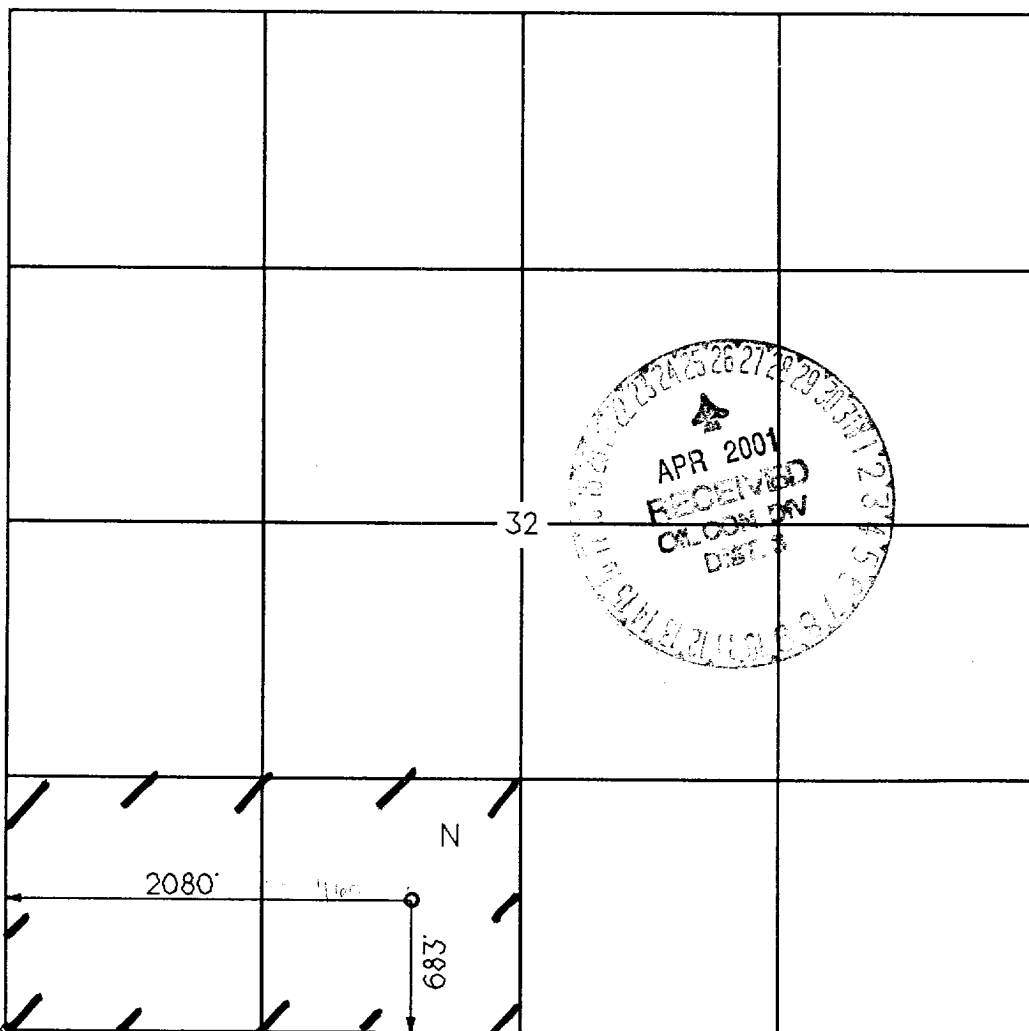

|   |                      |
|---|----------------------|
| OPERATOR CERTIFICATION  |                      |
| I hereby certify that the information contained herein is true and complete to the best of my knowledge and belief.   |                      |
| Signature   | <i>Brian Wood</i>    |
| Printed Name  | BRIAN WOOD           |
| Title   | CONSULTANT           |
| Date  | APR. 24, 2001        |
| SURVEYOR CERTIFICATION  |                      |
| I hereby certify that the well location on this plat was plotted from field notes of actual surveys made by me or under my supervision, and that the same is true and correct to the best of my belief. |                      |
| Date of Survey  |                      |
| Signature and Seal of Professional Surveyor   | <i>G. Huddleston</i> |
|   |                      |