



COPY TO 0022

IN REPLY REFER TO:

UNITED STATES
DEPARTMENT OF THE INTERIOR
GEOLOGICAL SURVEY
P. O. Box 965
Farmington, New Mexico

April 30, 1956

Southern Union Gas Company
1001 Burt Building
Dallas, Texas

Re: Jicarilla Tribal
Contract 100

Gentlemen:

Receipt is acknowledged of your "Notice of Intention to Drill" dated April 26, 1956 covering your well No. 3-D Jicarilla in SE $\frac{1}{4}$ sec. 32, T. 26 N., R. 3 W., N. M. P. M., Rio Arriba County, New Mexico, Tapicito Pictured Cliffs pool.

Your proposed work is hereby approved subject to compliance with the provisions of the "Oil and Gas Operating Regulations" revised May 25, 1942, a copy of which will be sent to you on request, and subject to the following conditions:

1. Drilling operations so authorized are subject to the attached sheet for general conditions of approval.
2. Furnish copies of all logs.
3. Approved subject to the approval of the New Mexico Oil Conservation Commission of this unorthodox location.

Very truly yours,

(Orig. Sgd.) P. T. McGRATH

P. T. McGrath
District Engineer

PTMcGrath:ac



IN REPLY REFER TO:

UNITED STATES
DEPARTMENT OF THE INTERIOR
GEOLOGICAL SURVEY



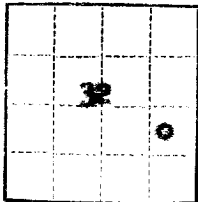

(SUBMIT IN TRIPLICATE)

UNITED STATES
DEPARTMENT OF THE INTERIOR
GEOLOGICAL SURVEY

Land Office **Jicarilla Tribal**
Lease No. **Contract No. 100**
Unit **Sec. 32, T-26N,**
R-3W, N.M.P.M., Rio Arriba
County, New Mexico

SUNDRY NOTICES AND REPORTS ON WELLS

NOTICE OF INTENTION TO DRILL	<input checked="" type="checkbox"/>	SUBSEQUENT REPORT OF WATER SHUT-OFF	
NOTICE OF INTENTION TO CHANGE PLANS		SUBSEQUENT REPORT OF SHOOTING OR ACIDIZING	
NOTICE OF INTENTION TO TEST WATER SHUT-OFF		SUBSEQUENT REPORT OF ALTERING CASING	
NOTICE OF INTENTION TO RE-DRILL OR REPAIR WELL		SUBSEQUENT REPORT OF RE-DRILLING OR REPAIR	
NOTICE OF INTENTION TO SHOOT OR ACIDIZE		SUBSEQUENT REPORT OF ABANDONMENT	
NOTICE OF INTENTION TO PULL OR ALTER CASING		SUPPLEMENTARY WELL HISTORY	
NOTICE OF INTENTION TO ABANDON WELL			

(INDICATE ABOVE BY CHECK MARK NATURE OF REPORT, NOTICE, OR OTHER DATA)

April 26, 1956

Well No. **3-D** is located **1650** ft. from **S** line and **1090** ft. from **E** line of sec. **32**

Section 32 (1/4 Sec. and Sec. No.) **26-N** (Twp.) **3-W** (Range) **N.M.P.M.** (Meridian)

Pictured Cliffs (Field) **Rio Arriba County** (County or Subdivision) **New Mexico** (State or Territory)

The elevation of the derrick floor above sea level is _____ ft. **To be determined.**

DETAILS OF WORK

(State names of and expected depths to objective sands; show sizes, weights, and lengths of proposed casings; indicate mudding jobs, cementing points, and all other important proposed work)

The objective sand is the Pictured Cliffs formation anticipated at approximately 3500'

Proposed Casing Program: 100' 9-5/8" Cemented to surface
3550' 5-1/2" cemented with 150 sacks

Rotary Tools will be employed from surface to T.D. Estimated T.D. 3550'.

The well will be sand fraced in an effort to stimulate production.

I understand that this plan of work must receive approval in writing by the Geological Survey before operations may be commenced.

Company **Southern Union Gas Company**

Address **1001 Burt Building**

Dallas, Texas

By

A. M. Wiederkehr

Title **Manager, Exploration Dept.**

NEW MEXICO
OIL CONSERVATION COMMISSION

Form C-128

Well Location and/or Gas Proration Plat

Date April 26, 1956

Operator SOUTHERN UNION GAS COMPANY

Lease JICARILLA

Well No. 3-D Section 32 Township 26 NORTH Range 3 WEST, NMPM

Located 1650 Feet From the SOUTH Line, 1090 Feet From the EAST Line,

RIO ARRIBA

County, New Mexico.

G. L. Elevation To be determined

Name of Producing Formation Pictured Cliffs Pool Tapicito P.C. Dedicated Acreage 320.0

(Note: All distances must be from outer boundaries of Section)

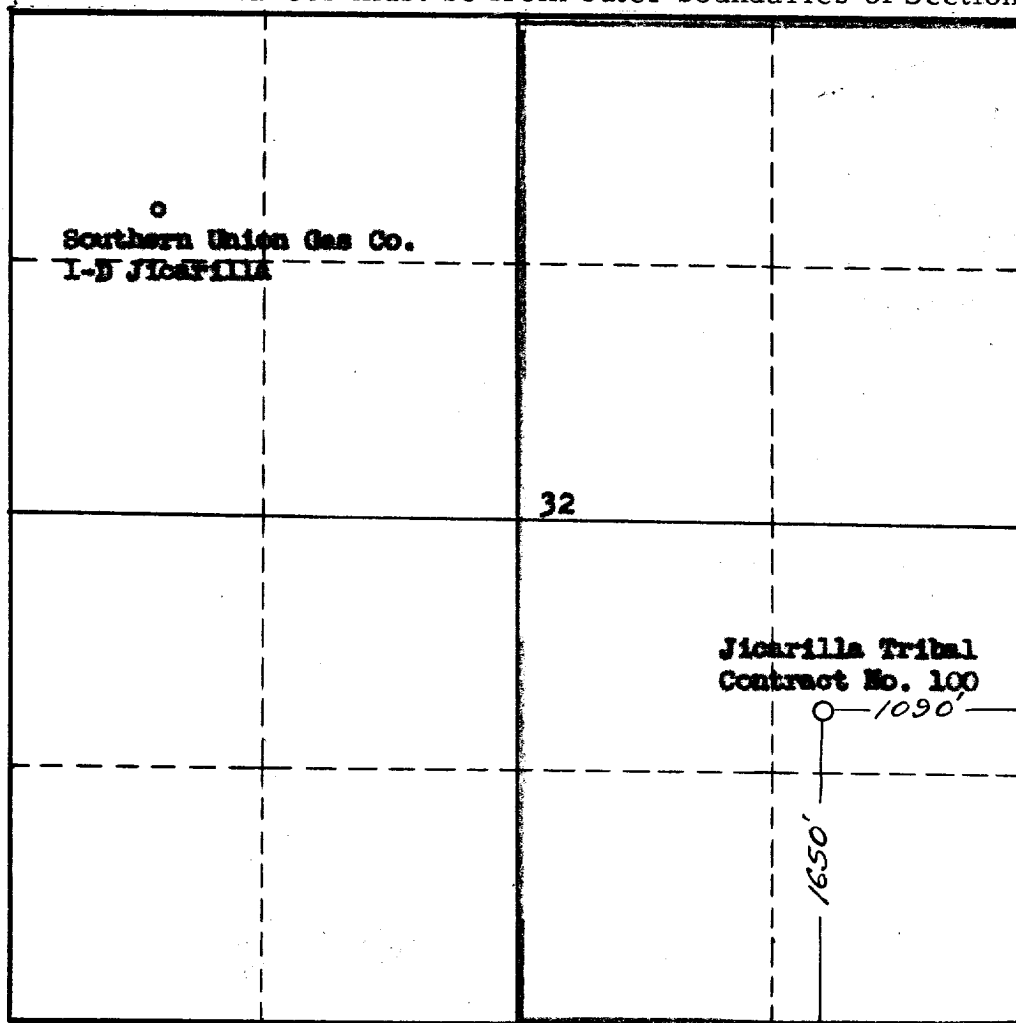

SCALE: 1"=1000'

1. Is this Well a Dual Comp.? Yes ___ No X.
2. If the answer to Question 1 is yes, are there any other dually completed wells within the dedicated acreage? Yes ___ No X.

This is to certify that the above plat was prepared from field notes of actual surveys made by me or under my supervision and that the same are true and correct to the best of my knowledge and belief.

Name A.M. Wiederkehr
Position Manager, Exploration Dept.
Representing Southern Union Gas Company
Address 1001 Bart Bldg., Dallas, Texas

Date Surveyed 27 March 1956
Registered Professional Engineer and/or
Land Surveyor James P. Leese
N. Mex. Reg. No. 1463