



IN REPLY REFER TO: ✓

UNITED STATES
DEPARTMENT OF THE INTERIOR
GEOLOGICAL SURVEY
P. O. Box 965
Farmington, New Mexico

June 22, 1956

Northwest Production Corporation
520 Simms Building
Albuquerque, New Mexico

Re: Jicarilla Contract #117

Gentlemen:

Receipt is acknowledged of your "Notice of Intention to Drill" dated June 21, 1956 covering your well No. 2-33 "E" in SE $\frac{1}{4}$ NE $\frac{1}{4}$ Sec. 33, T. 26 N., R. 3 W., N. M. P. M., Rio Arriba County, New Mexico, Wildcat MV & Tapacito P.C. pool.

Your proposed work is hereby approved subject to compliance with the provisions of the "Oil and Gas Operating Regulations" revised May 25, 1942, a copy of which will be sent to you on request, and subject to the following conditions:

1. Drilling operations so authorized are subject to the attached sheet for general conditions of approval.
2. Furnish copies of all logs.

Very truly yours,

(Orig. Sgd.) P. T. McGRATH

P. T. McGrath
District Engineer

PTMcGrath:ao
cc - Jicarilla Agency



IN REPLY REFER TO:

UNITED STATES
DEPARTMENT OF THE INTERIOR
GEOLOGICAL SURVEY



[Faint, mostly illegible text body of the document]



[Faint text at bottom right]

1952 - 6
File - 1

(SUBMIT IN TRIPLICATE)

UNITED STATES
DEPARTMENT OF THE INTERIOR
GEOLOGICAL SURVEY

Budget Bureau No. 12-31-55.
Approval expires 12-31-55.

Indian Agency _____

Stonerville

Allottee Contract # 117

Lease No. _____

SUNDRY NOTICES AND REPORTS ON WELLS

NOTICE OF INTENTION TO DRILL	<input checked="" type="checkbox"/>	SUBSEQUENT REPORT OF WATER SHUT-OFF	
NOTICE OF INTENTION TO CHANGE PLANS		SUBSEQUENT REPORT OF SHOOTING OR ACIDIZING	
NOTICE OF INTENTION TO TEST WATER SHUT-OFF		SUBSEQUENT REPORT OF ALTERING CASING	
NOTICE OF INTENTION TO REDRILL OR REPAIR WELL		SUBSEQUENT REPORT OF REDRILLING OR REPAIR	
NOTICE OF INTENTION TO SHOOT OR ACIDIZE		SUBSEQUENT REPORT OF ABANDONMENT	
NOTICE OF INTENTION TO PULL OR ALTER CASING		SUPPLEMENTARY WELL HISTORY	
NOTICE OF INTENTION TO ABANDON WELL			

(INDICATE ABOVE BY CHECK MARK NATURE OF REPORT, NOTICE, OR OTHER DATA)

June 22, 1956

Well No. T 2-13 is located 1619 ft. from N line and 97 ft. from E line of sec. 13

24 Sec. and Sec. No. 31 24 31 R.R.P.M.
(Twp.) (Range) (Meridian)

Valley of a Spanish PC San Juan New Mexico
(County or Subdivision) (State or Territory)

The elevation of the ungraded ground above sea level is 770.5 ft.

DETAILS OF WORK

(State names of and expected depths to objective sands; show sizes, weights, and lengths of proposed casings; indicate mudding jobs, cementing points, and all other important proposed work)

Propose to drill to 110', set 9-5/8" O.D. casing and cement to surface with approx. 175 cu yd. Drill with water or minimum mud to approx. 140', set 7" O.D. casing and cement with 150 cu yd and 90 cu yd. Drill with gas to total depth of approx. 637', set 5" O.D. casing and cement with 150 cu yd. Perforate the 5" casing and fracture the GILF zone, then bridge plug at approx. 300', perforate 5" casing at approx. 1105' and approximate the Pictured Cliffs formation with approx. 150 cu yd. If the primary cement job is not effective in cementing the proposed 7" casing intermediate string with the proposed 5" casing production string. Perforate the Pictured Cliffs formation and fracture with approx. 10,000 gal. water. Drill out temporary bridge plug, clean out to 90 and run tubing with production pump out at approx. 900' to produce the formation there the tubing and the Pictured Cliffs formation there the casing-tubing annulus. A side-door check will be placed in the tubing at approx. 1100'. The 1/2 of sec. 13, containing 30 acres, is dedicated to this well.

I understand that this plan of work must receive approval in writing by the Geological Survey before operations may be commenced.

Company AMERICAN PRODUCTION CORPORATION

Address 900 Stone Building
Albuquerque, New Mexico

By Ray Phillips, Jr.Title Asst. Mgr. Production Operations

NEW MEXICO
OIL CONSERVATION COMMISSION

Form C-128

Well Location and/or Gas Proration Plat

Date JUN 21 1956

Operator NORTHWEST PRODUCTION COMPANY Lease "E"

Well No. 2-33 Section 33 Township 26 NORTH Range 3 WEST, NMPM

Located 1619 Feet From the NORTH Line, 974 Feet From the EAST Line,

RIO ARRIBA County, New Mexico. G. L. Elevation 7450.5 UNGRADED.

Name of Producing Formation Mesaverde and Pictured Cliffs Pool Wildcat MV Tapacito Ext. PC Dedicated Acreage 320

(Note: All distances must be from outer boundaries of Section)

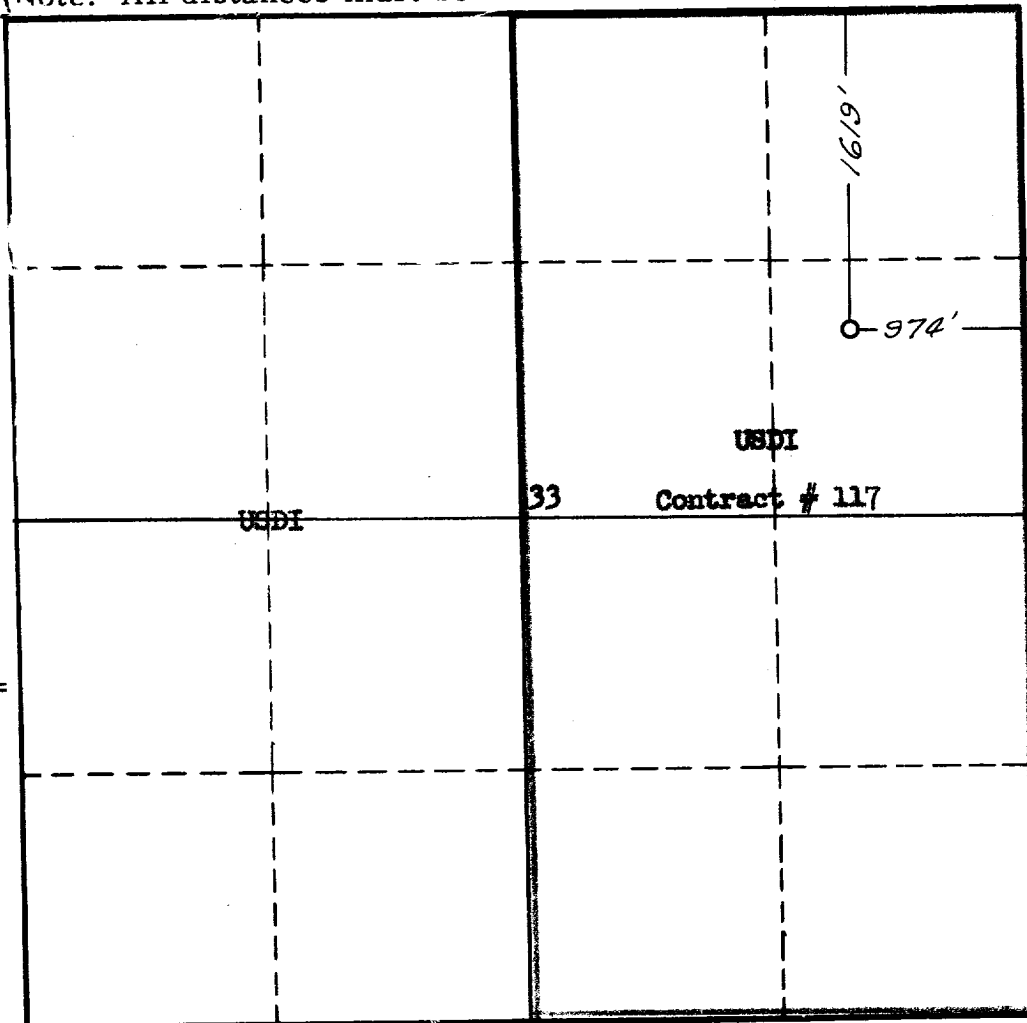

NOTE

This section of form is to be used for gas wells only.

SCALE: 1"=1000'

1. Is this Well a Dual Comp.? Yes X No

2. If the answer to Question 1 is yes, are there any other dually completed wells within the dedicated acreage? Yes No X

Name Ray Phillips, Jr.
Position Asst. Mgr., Production Operations
Representing Northwest Production Corporation
Address 520 Sims Bldg., Albuquerque, New Mexico

This is to certify that the above plat was prepared from field notes of actual surveys made by me or under my supervision and that the same are true and correct to the best of my knowledge and belief.

Date Surveyed 8 JUNE 1956

James P. Leese
Registered Professional Engineer and/or
Land Surveyor James P. Leese
N. Mex. Reg. No. 1463