

Form 9-331b
(April 1962)

(SUBMIT IN TRIPLICATE)

UNITED STATES
DEPARTMENT OF THE INTERIOR
GEOLOGICAL SURVEY

Indian Agency Sicorilla
Apache
Allottee _____
Lease No. Sicorilla Apache
116 "A"

SUNDRY NOTICES AND REPORTS ON WELLS

NOTICE OF INTENTION TO DRILL	<input checked="" type="checkbox"/>	SUBSEQUENT REPORT OF WATER SHUT-OFF	<input type="checkbox"/>
NOTICE OF INTENTION TO CHANGE PLANS	<input type="checkbox"/>	SUBSEQUENT REPORT OF SHOOTING OR ACIDIZING	<input type="checkbox"/>
NOTICE OF INTENTION TO TEST WATER SHUT-OFF	<input type="checkbox"/>	SUBSEQUENT REPORT OF ALTERING CASING	<input type="checkbox"/>
NOTICE OF INTENTION TO REDRILL OR REPAIR WELL	<input type="checkbox"/>	SUBSEQUENT REPORT OF REDRILLING OR REPAIR	<input type="checkbox"/>
NOTICE OF INTENTION TO SHOOT OR ACIDIZE	<input type="checkbox"/>	SUBSEQUENT REPORT OF ABANDONMENT	<input type="checkbox"/>
NOTICE OF INTENTION TO PULL OR ALTER CASING	<input type="checkbox"/>	SUPPLEMENTARY WELL HISTORY	<input type="checkbox"/>
NOTICE OF INTENTION TO ABANDON WELL	<input type="checkbox"/>		

APR 6 1962

U. S. GEOLOGICAL SURVEY
WASHINGTON, NEW MEXICO

(INDICATE ABOVE BY CHECK MARK NATURE OF REPORT, NOTICE, OR OTHER DATA)

Sicorilla Apache 116 "A"

Farmington, New Mexico April 4, 1962

Well No. 9 is located 1090 ft. from N line and 800 ft. from E line of sec. 25

NE 1/4, Sec. 25

T-26-N

R-3-E

N.M.P.M.

(1/4 Sec. and Sec. No.)

(Twp.)

(Range)

(Meridian)

Civilian Pictured Cliffs

Rio Arriba

New Mexico

(Field)

(County or Subdivision)

(State or Territory)

The elevation of the derrick floor above sea level is _____ ft. (To be reported later)

DETAILS OF WORK

(State names of and expected depths to objective sands; show sizes, weights, and lengths of proposed casings; indicate mudding jobs, cementing points, and all other important proposed work)

We propose to drill the above well approximately 4100' to develop and produce indicated Pictured Cliffs Gas Reserves. Stimulation will be as indicated upon reaching this depth.

Casing program:

SIZE	DEPTH	REMARKS
6-5/8"	200'	Most inner - circulate to surface.
4-1/2"	4100'	Next, inner, 6% gel - Circulate

Copies of location plat are attached. Copies of electrical logs will be forwarded upon completion of well.

I understand that this plan of work must receive approval in writing by the Geological Survey before operations may be commenced.

Company Pan American Petroleum Corporation

Address Box 480

Farmington, New Mexico

Attn: L. O. Spear, Jr.

Original signed by
By R. M. BAUER, JR.

Title Senior Petroleum Engineer

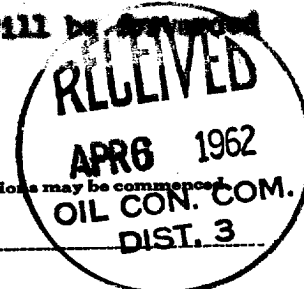

Verbal approval R. Esor to J. Glover 4/4/62.

NEW MEXICO OIL CONSERVATION COMMISSION

Well Location and Acreage Dedication Plat

SECTION A.

Date **January 16, 1962**

Operator **Pan American Petroleum Corporation** Lease **Jicarilla Apache 118 "A"**
 Well No. **3** Unit Letter **A** Section **25** Township **26 North** Range **3 West** NMPM
 Located **1030** Feet From **North** Line, **880** Feet From **East** Line
 County **Rio Arriba** G. L. Elevation **report later** Dedicated Acreage **161.42** Acres
 Name of Producing Formation **Pictured Cliffs** Pool **Gavilan Pictured Cliffs**

1. Is the Operator the only owner* in the dedicated acreage outlined on the plat below? Yes ☒ No
2. If the answer to question One is "No," have the interests of all the owners been consolidated by communitization agreement or otherwise? Yes _____ No _____ If answer is "Yes," Type of Consolidation _____
3. If the answer to question Two is "No," list all the owners and their respective interests below

OWNER

LAND DESCRIPTION

SECTION B.

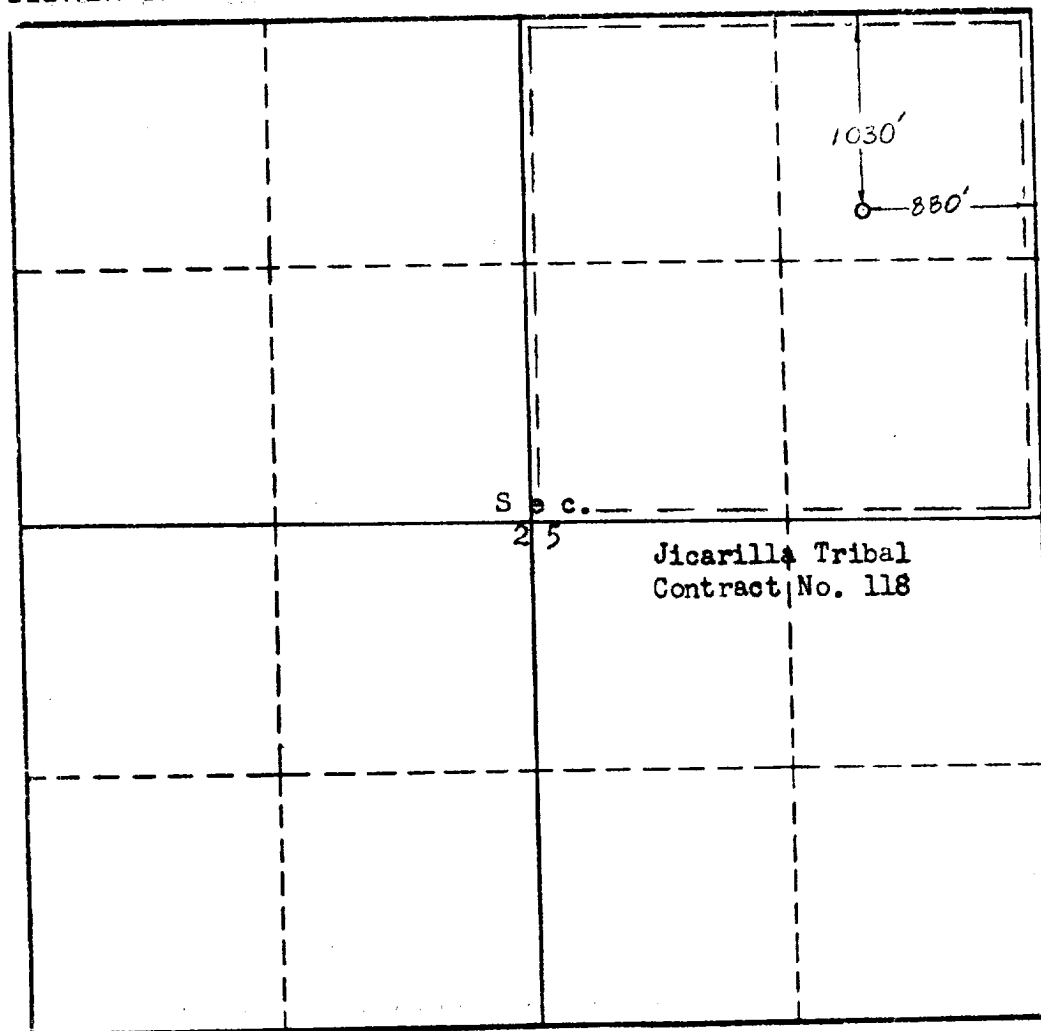

S 25

Jicarilla Tribal
Contract No. 118

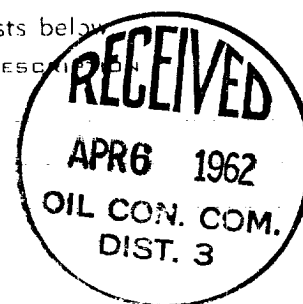

This is to certify that the information in Section A above is true and complete to the best of my knowledge and belief.

Pan American Petroleum Corp.

(OPERATOR)

R. M. Bauer, Jr.

R. M. Bauer, Jr.

(REPRESENTATIVE)

Box 480, Farmington, New Mex.

(ADDRESS)

This is to certify that the well location shown on the plat in Section B was plotted from field notes of actual surveys made by me or under my supervision and that the same is true and correct to the best of my knowledge and belief.

Date Surveyed **January 6, 1962****Four States Engineering Co.**

FARMINGTON, NEW MEXICO

James H. ...
 REGISTERED ENGINEER OR
 LAND SURVEYOR

Certificate No. **598**