

Company... Lowry et al Operating Account.....

Lease... **Santa Fe 07930**..... Well No. **2 - Sanborn**

Sec. **24**....., T. **26 N.**....., R. **6 W.**..... N.M.P.M.....

Location **1800' from the South line and 1720' from the West line.**

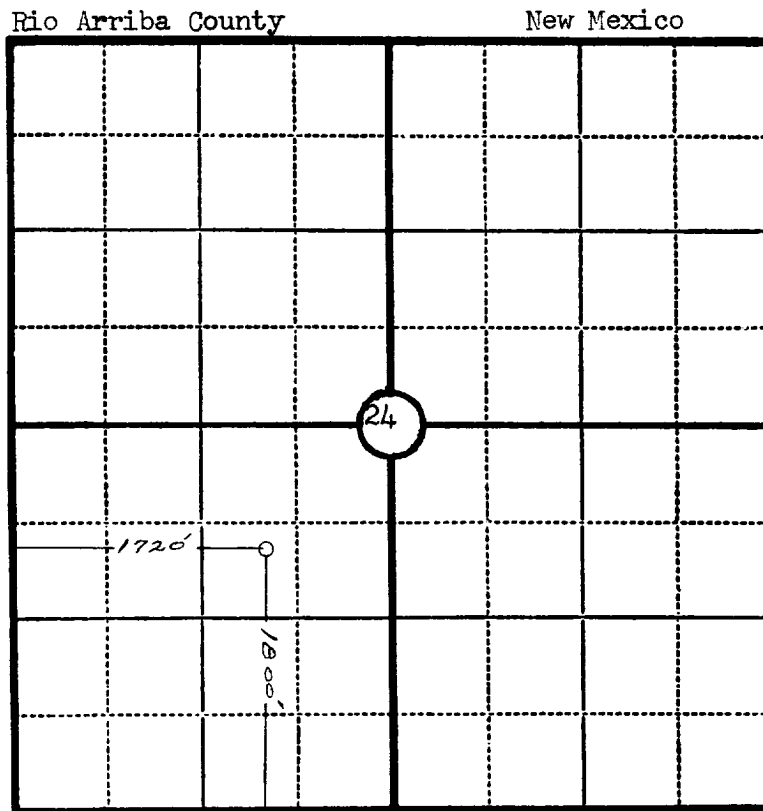

This is to certify that the above plat was prepared from field notes of actual surveys made by me or under my supervision and that the same are true and correct to the best of my knowledge and belief.

Seal:

Charles J. Finklea
Registered Professional
Engineer and Land Surveyor.

Charles J. Finklea
N. Mex. Reg. No. 1302

Surveyed **November 12**....., 19 **52**