

## NEW MEXICO OIL CONSERVATION COMMISSION

Santa Fe, New Mexico

## NOTICE OF INTENTION TO DRILL

Notice must be given to the Oil Conservation Commission or its proper agent and approval obtained before drilling begins. If changes in the proposed plan are considered advisable, a copy of this notice showing such changes will be returned to the sender. Submit this notice in triplicate. One copy will be returned following approval. See additional instructions in Rules and Regulations of the Commission.

Farmington, New Mexico

Place

December 18, 1955

Date

OIL CONSERVATION COMMISSION,  
Santa Fe, New Mexico,

Gentlemen:

You are hereby notified that it is our intention to commence the drilling of a well to be known as \_\_\_\_\_

Lowry et al Operating Account  
Company or Operator

Kaine

Lease

well No. 1 in SE 1/4 NW 1/4 NE 1/4

of Sec. 20, T. 26 N, R. 6W, N. M., P. M., South Blanco field, Rio Arriba County.

N

The well is 1090 feet (N.) (0) of the North line and 1470 feet (E.) (0) of the East line of Section 20, 26N, 6W

(Give location from section or other legal subdivision lines. Cross out wrong directions.)

If state land the oil and gas lease is No. \_\_\_\_\_ Assignment No. \_\_\_\_\_

If patented land the owner is C. A. Kaine

Address Astec, New Mexico

If government land the permittee is \_\_\_\_\_

Address \_\_\_\_\_

The lessee is \_\_\_\_\_

Address \_\_\_\_\_

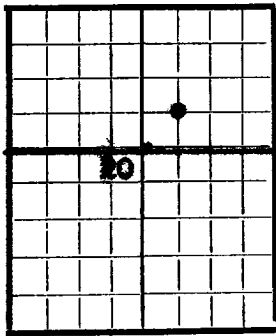

AREA 640 ACRES

LOCATE WELL CORRECTLY

We propose to drill well with drilling equipment as follows: Rotary to Total

Depth

The status of a bond for this well in conformance with Rule 39 of the General Rules and Regulations of the Commission is as follows: Blanket Bond on file (Tim G. Lowry)

We propose to use the following strings of casing and to land or cement them as indicated:

Size of Hole	Size of Casing	Weight Per Foot	New or Second Hand	Depth	Landed or Cemented	Sacks Cement
12 1/4"	9 5/8	43.50#	Used	100'	Cement	50 sacks
7 7/8"	5 1/2	14.00#	New	3100'	Cement	100 sacks

If changes in the above plan become advisable we will notify you before cementing or landing casing. We estimate that the first productive oil or gas sand should occur at a depth of about 3100 feet.

Additional information:

Approved 1-17, 19 56

except as follows:

Subject to communication  
OF Drilling Unit

Sincerely yours,

Lowry et al Operating Account  
Company or Operator

By

Position Superintendent

Send communications regarding well to:

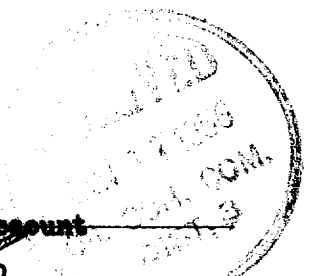
Name Frank GrayAddress P. O. Box 967, Farmington, New MexicoBy Ernest B. ArnoldTitle Oil and Gas Inspector Dist. #3.

Entered as Second-Class Matter, October 3, 1917, under Post Office No. 384, at Chicago, Ill., under special agreement of Post Office and General Delivery. Accepted for mailing at special rate of postage provided for in Act of October 3, 1917. Postage paid at Chicago, Ill., and at additional mailing offices.

Copyright, 1920, by American Medical Association, 535 North Dearborn Street, Chicago, Ill.

Published by the American Medical Association, 535 North Dearborn Street, Chicago, Ill.

Vol. 23

No. 11

CHICAGO, ILL., NOVEMBER 13, 1920

Published for the American Medical Association, 535 North Dearborn Street, Chicago, Ill.

Subscription price, Five Dollars per Annum in Advance

Entered as Second-Class Matter, October 3, 1917, under Post Office No. 384, at Chicago, Ill., under special agreement of Post Office and General Delivery.

Accepted for mailing at special rate of postage provided for in Act of October 3, 1917. Postage paid at Chicago, Ill., and at additional mailing offices.

Copyright, 1920, by American Medical Association, 535 North Dearborn Street, Chicago, Ill.

Published by the American Medical Association, 535 North Dearborn Street, Chicago, Ill.

Published for the American Medical Association, 535 North Dearborn Street, Chicago, Ill.

Subscription price, Five Dollars per Annum in Advance

Entered as Second-Class Matter, October 3, 1917, under Post Office No. 384, at Chicago, Ill., under special agreement of Post Office and General Delivery.

Accepted for mailing at special rate of postage provided for in Act of October 3, 1917. Postage paid at Chicago, Ill., and at additional mailing offices.

Copyright, 1920, by American Medical Association, 535 North Dearborn Street, Chicago, Ill.

Published by the American Medical Association, 535 North Dearborn Street, Chicago, Ill.

Published for the American Medical Association, 535 North Dearborn Street, Chicago, Ill.

Subscription price, Five Dollars per Annum in Advance

Entered as Second-Class Matter, October 3, 1917, under Post Office No. 384, at Chicago, Ill., under special agreement of Post Office and General Delivery.

Accepted for mailing at special rate of postage provided for in Act of October 3, 1917. Postage paid at Chicago, Ill., and at additional mailing offices.

Copyright, 1920, by American Medical Association, 535 North Dearborn Street, Chicago, Ill.

Published by the American Medical Association, 535 North Dearborn Street, Chicago, Ill.

Published for the American Medical Association, 535 North Dearborn Street, Chicago, Ill.

Subscription price, Five Dollars per Annum in Advance

Entered as Second-Class Matter, October 3, 1917, under Post Office No. 384, at Chicago, Ill., under special agreement of Post Office and General Delivery.

COMPANY LOWRY et al OPERATING ACCOUNT

Well Name & No. \_\_\_\_\_ Lease No. \_\_\_\_\_

Location 1090' from the North line and 1470' from the East line.

Being in SE 1/4 NW 1/4

Sec. 20, T26 N., R 6 W., N.M.P.M., Rio Arriba County, New Mexico.

Ground Elevation 6396, ungraded.

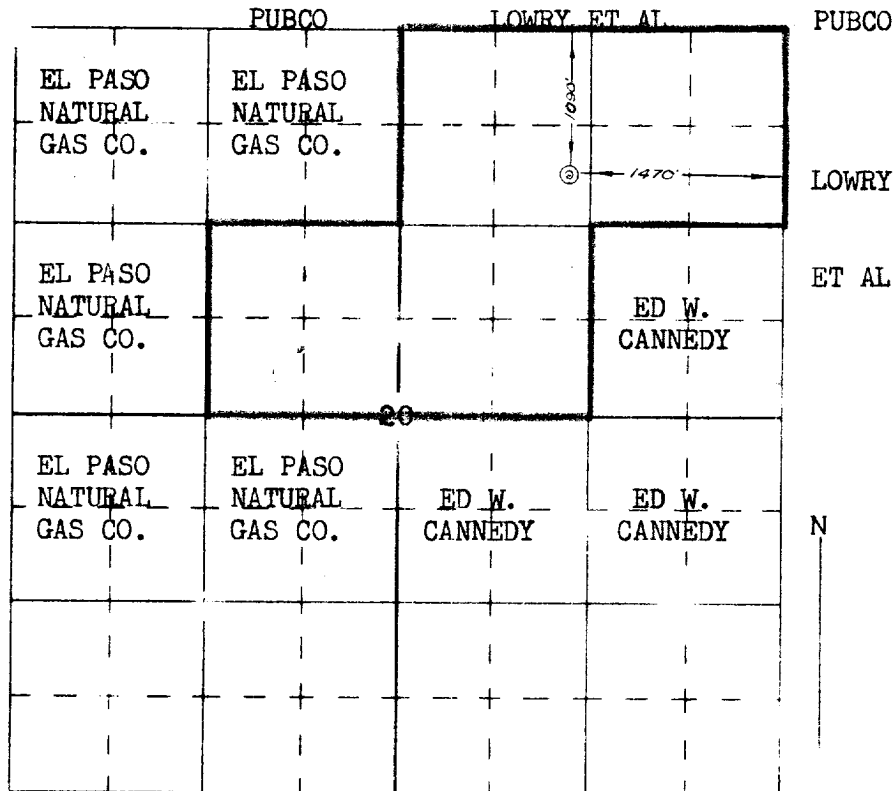

Surveyed December 9, 1955

This is to certify that the above plat was prepared from field notes of actual surveys made by me or under my supervision and that the same are true and correct to the best of my knowledge and belief.

*Ernest V. Echohawk*  
Ernest V. Echohawk  
Registered Land Surveyor  
N. M. Reg. #1545

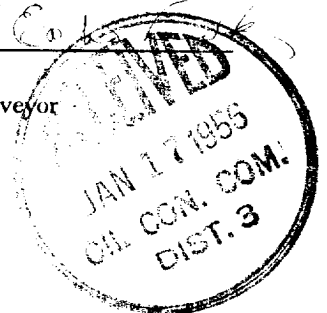

## OIL CONSERVATION COMMISSION

AZTEC DISTRICT OFFICE

No. Copies received 5

## DISTRIBUTION

	NO. FURNISHED	
Operator	1	
County En	1	
Production Office		
Marketing Office		
Finance	2	
Insurance		
Legal	1	✓