

(SUBMIT IN TRIPLICATE)

UNITED STATES
DEPARTMENT OF THE INTERIOR
GEOLOGICAL SURVEY

Land Office N M

Lease No. 03552

Unit _____

Reuter D-344

SUNDRY NOTICES AND REPORTS ON WELLS

NOTICE OF INTENTION TO DRILL	<input checked="" type="checkbox"/>	SUBSEQUENT REPORT OF WATER SHUT-OFF	
NOTICE OF INTENTION TO CHANGE PLANS		SUBSEQUENT REPORT OF SHOOTING OR ACIDIZING	
NOTICE OF INTENTION TO TEST WATER SHUT-OFF		SUBSEQUENT REPORT OF ALTERING CASING	
NOTICE OF INTENTION TO RE-DRILL OR REPAIR WELL		SUBSEQUENT REPORT OF RE-DRILLING OR REPAIR	
NOTICE OF INTENTION TO SHOOT OR ACIDIZE		SUBSEQUENT REPORT OF ABANDONMENT	
NOTICE OF INTENTION TO PULL OR ALTER CASING		SUPPLEMENTARY WELL HISTORY	
NOTICE OF INTENTION TO ABANDON WELL			

(INDICATE ABOVE BY CHECK MARK NATURE OF REPORT, NOTICE, OR OTHER DATA)

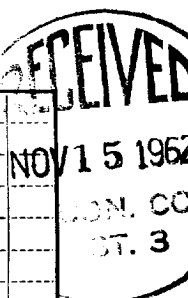

November 11, 1962

Well No. D-344 is located 995 ft. from N line and 1580 ft. from W line of sec. 22

NE 1/4 NW 1/4 Section 22 26 North 6 West N M P M
(1/4 Sec. and Sec. No.) (Twp.) (Range) (Meridian)

Basin Dakota Rio Arriba New Mexico
(Field) (County or Subdivision) (State or Territory)

The elevation of the derrick floor above sea level is 6679 ft. Ground Level 6667

DETAILS OF WORK

(State names of and expected depths to objective sands; show sizes, weights, and lengths of proposed casings; indicate mudding jobs, cementing points, and all other important proposed work)

It is proposed to drill to approximately 7700' to test the Dakota formation. Rotary equipment using mud circulation will be used to total depth. The following casing and cementing program will be used:

9-5/8" 36# J-55 Seamless Casing to 250' cemented top to bottom
5" OD - 15# J-55 Seamless Casing to approximately 7700'. This string will be cemented thru the casing shoe with 150 sks. 12% aquagel cement followed by 100 sks. latex cement. It will also be cemented thru a stage collar at approximately 5450' with 430 sks. 12% aquagel cement followed by 50 sks. neat. This second stage will also contain 12% gilsonite per sack. The second stage is 150% of the calculated volume required to cover the Mesa Verde and Pictured Cliffs zones.

The Dakota zone will be perforated and fractured as needed.

I understand that this plan of work must receive approval in writing by the Geological Survey before operations may be commenced.

Company Caulkins Oil Company

Address Box 780

Farmington, New Mexico

By Frank Gray
Title Superintendent

NEW MEXICO OIL CONSERVATION COMMISSION
WELL LOCATION AND ACREAGE DEDICATION PLAT

SECTION A.

DATE November 11, 1962

OPERATOR Caulkins Oil Company LEASE Reuter
WELL NO. D 344 UNIT LETTER C SECTION 22 TOWNSHIP 26 North RANGE 6 West NMPM
LOCATED 995 FEET FROM North LINE, 1580 FEET FROM West LINE
COUNTY Rio Arriba G. L. ELEVATION 6667 DEDICATED ACREAGE 320 ACRES
NAME OF PRODUCING FORMATION Dakota POOL Basin Dakota

1. IS THE OPERATOR THE ONLY OWNER* IN THE DEDICATED ACREAGE OUTLINED ON THE PLAT BELOW? YES X NO
2. IF THE ANSWER TO QUESTION ONE IS "NO," HAVE THE INTERESTS OF ALL THE OWNERS BEEN CONSOLIDATED BY COMMUNIZATION AGREEMENT OR OTHERWISE? YES NO IF ANSWER IS "YES," TYPE OF CONSOLIDATION M.

3. IF THE ANSWER TO QUESTION TWO IS "NO," LIST ALL THE OWNERS AND THEIR RESPECTIVE INTERESTS BELOW:
- | OWNER | LAND DESCRIPTION |
|-------|------------------|
| | |
| | |
| | |

SECTION B.

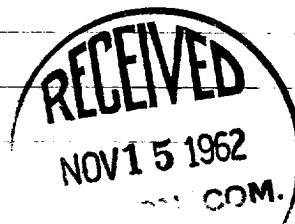
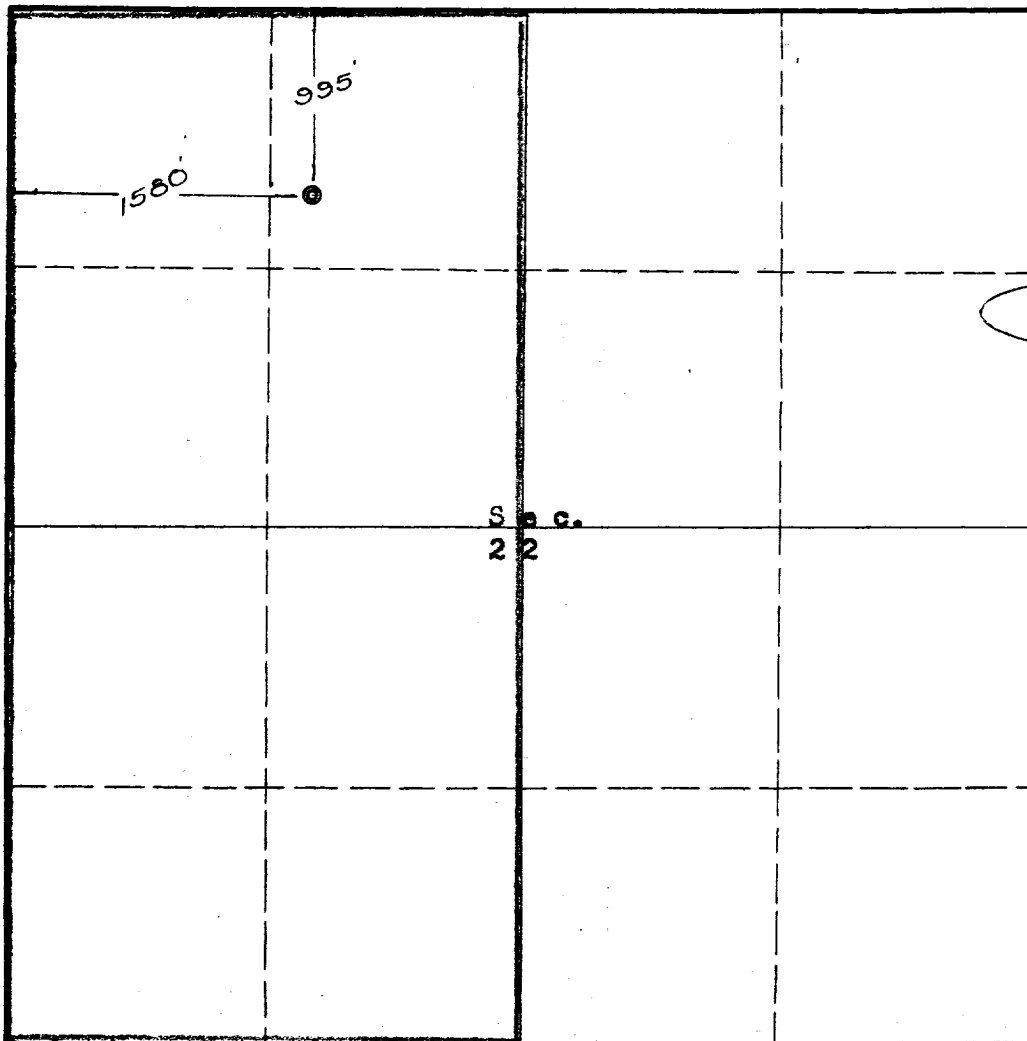

THIS IS TO CERTIFY THAT THE INFORMATION IN SECTION A ABOVE IS TRUE AND COMPLETE TO THE BEST OF MY KNOWLEDGE AND BELIEF.

Caulkins Oil Company
(OPERATOR)

Frank Gray
(REPRESENTATIVE)

P. O. Box 780
Farmington, New Mexico
(ADDRESS)

THIS IS TO CERTIFY THAT THE WELL LOCATION SHOWN ON THE PLAT IN SECTION B WAS PLOTTED FROM FIELD NOTES OF ACTUAL SURVEYS MADE BY ME OR UNDER MY SUPERVISION AND THAT THE SAME IS TRUE AND CORRECT TO THE BEST OF MY KNOWLEDGE AND BELIEF.

DATE SURVEYED Nov. 9, 1962

FARMINGTON, NEW MEXICO

Emmett E. Eckel
REGISTERED ENGINEER OR
LAND SURVEYOR

CERTIFICATE NO. 3602

