

UNITED STATES
DEPARTMENT OF THE INTERIOR
GEOLOGICAL SURVEY

30-039-06

APPLICATION FOR PERMIT TO DRILL, DEEPEN, OR PLUG BACK

1a. TYPE OF WORK
 DRILL DEEPEN PLUG BACK

5. LEASE DESIGNATION AND SERIAL NO.
 Our #1617-A
 6. IF INDIAN, ALLOTTEE OR TRIBE NAME
 Jicarilla Contract 101
 7. UNIT AGREEMENT NAME

8. FARM OR LEASE NAME
 McIntyre

9. WELL NO.
 1

10. FIELD AND POOL, OR WILDCAT
 Blanco Mesaverde & Basin

11. SEC., T., R., M., OR BLK. AND SURVEY OR AREA
 Dakota

Section 11-T26N-R4W

12. COUNTY OR PARISH 13. STATE
 Rio Arriba New Mexico

b. TYPE OF WELL
 OIL WELL GAS WELL OTHER SINGLE ZONE MULTIPLE ZONE

2. NAME OF OPERATOR
 Consolidated Oil & Gas, Inc.

3. ADDRESS OF OPERATOR
 410 East Mexico Avenue, Denver 22, Colorado

4. LOCATION OF WELL (Report location clearly and in accordance with any State requirements.)*
 At surface
 1730' FNL & 1450' FWL of Section 11
 At proposed prod. zone

14. DISTANCE IN MILES AND DIRECTION FROM NEAREST TOWN OR POST OFFICE*
 65 miles west & north of Cuba, New Mexico

15. DISTANCE FROM PROPOSED* LOCATION TO NEAREST PROPERTY OR LEASE LINE, FT. (Also to nearest drlg. line, if any)
 1450'

16. NO. OF ACRES IN LEASE
 320

17. NO. OF ACRES ASSIGNED TO THIS WELL
 320

18. DISTANCE FROM PROPOSED LOCATION* TO NEAREST WELL, DRILLING, COMPLETED, OR APPLIED FOR, ON THIS LEASE, FT.
 -

19. PROPOSED DEPTH
 8,000'

20. ROTARY OR CABLE TOOLS
 Rotary

21. ELEVATIONS (Show whether DF, RT, GR, etc.)
 6,888.1' GL

22. APPROX. DATE WORK WILL START*
 August 20, 1965

23. PROPOSED CASING AND CEMENTING PROGRAM

SIZE OF HOLE	SIZE OF CASING	WEIGHT PER FOOT	SETTING DEPTH	QUANTITY OF CEMENT
12-3/4"	9-5/8"	32#	300'	Circulate to surface
9"	7"	23#	4,000'	250 cu. ft.
6-1/2"	4-1/2"	11.5#	8,000'	150 cu. ft. around csg. shoe;
		10.5#		150 cu. ft. through stage collar
		9.5#		at 5,900' to protect Mesaverde

Use rotary and drill to base of Pictured Cliffs with mud. Set 7" intermediate string. Gas drill to TD of 8,000'. Set 4-1/2" production string and cement to protect both the Dakota and Mesaverde zones. Jet perforate opposite zones of porosity as indicated by Gamma-Ray Neutron Densilog and sand-water frac treat each zone separately. Dual complete in accordance with New Mexico Corporation Commission rules.

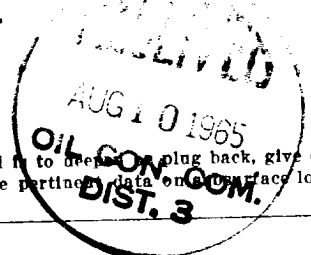

IN ABOVE SPACE DESCRIBE PROPOSED PROGRAM: If proposal is to deepen or plug back, give data on present productive zone and proposed new productive zone. If proposal is to drill or deepen directionally, give pertinent data on surface locations and measured and true vertical depths. Give blowout preventer program, if any.

24. SIGNED _____ TITLE Production Manager DATE 8-6-65

(This space for Federal or State office use)

PERMIT NO. _____ APPROVAL DATE _____

APPROVED BY [Signature] TITLE _____

CONDITIONS OF APPROVAL, IF ANY:

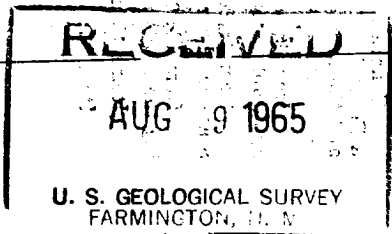

*See Instructions On Reverse Side

**NEW MEXICO OIL CONSERVATION COMMISSION
WELL LOCATION AND ACERAGE DEDICATION PLAT**

All distances must be from the outer boundaries of the Section

Operator CONSOLIDATED GAS AND OIL INC.			Lease MC INTYRE		Well No. 1
Unit Letter F	Section 11	Township 26 NORTH	Range 4 WEST	County RIO ARRIBA	
Actual Footage Location of Well: 1730 feet from the NORTH line and 1450 feet from the WEST line			Dedicated Acreage: Acres		
Ground Level Elev. 6888.1			Producing Formation		

1. Outline the acreage dedicated to the subject well by colored pencil or hachure marks on the plat.
2. If more than one lease is dedicated to the well, outline each and identify the ownership thereof (both as to working interest and royalty).
3. If more than one lease of different ownership is dedicated to the well, have the interests of all owners been consolidated by communitization, unitization, force-pooling, etc?
 Yes No If answer is "yes," type of consolidation

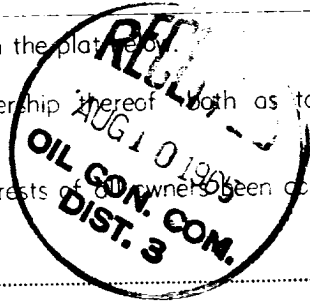

If answer is "no," list the owners and tract descriptions which have actually consolidated. (Use reverse side of this form if necessary.)

No allowable will be assigned to the well until all interests have been consolidated (by communitization, unitization, forced-pooling, or otherwise) or until a non standard unit, eliminating such interests, has been approved by the Commission.

CERTIFICATION

I hereby certify that the information contained herein is true and complete to the best of my knowledge and belief.

Wayne Rogers
Name
Production Manager
Position
Consolidated Oil & Gas, Inc.
Company
August 6, 1965
Date

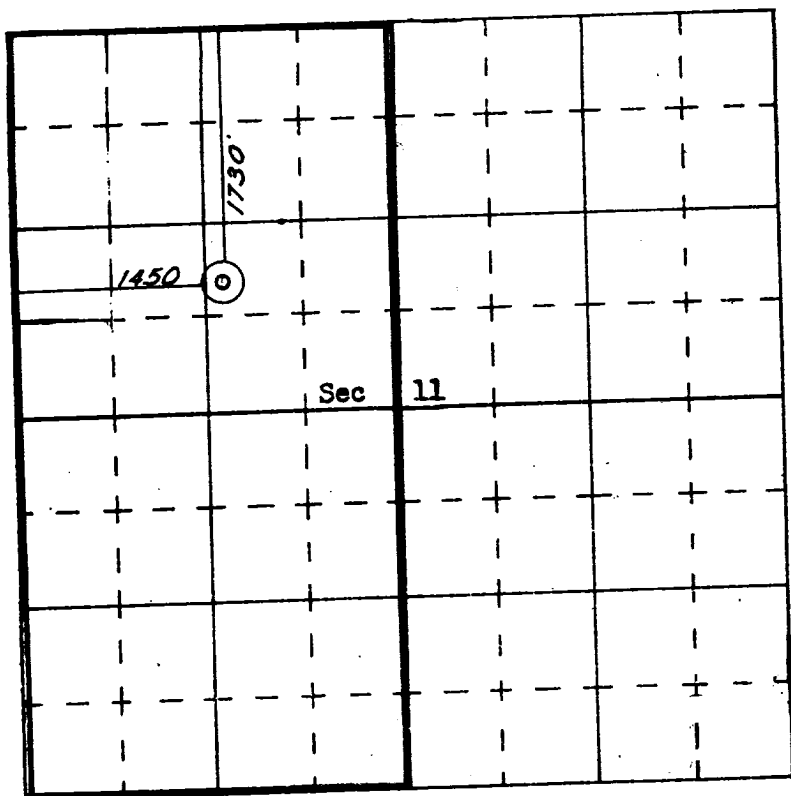

N

I hereby certify that the well location shown on this plat was plotted from field notes of actual surveys made by me or under my supervision, and that the same is true and correct to the best of my knowledge and belief.

1965.
 Registered Professional Engineer
 and Land Surveyor **W. P. Leese.**
San Engineering Company.
 N. M. State Seal
 Certificate No. _____