

UNITED STATES
DEPARTMENT OF THE INTERIOR
GEOLOGICAL SURVEY

APPLICATION FOR PERMIT TO DRILL, DEEPEN, OR PLUG BACK

30-039-21361

5. LEASE DESIGNATION AND SERIAL NO.
NM 03733

6. IF INDIAN, ALLOTTEE OR TRIBE NAME

7. UNIT AGREEMENT NAME

8. FARM OR LEASE NAME
Breech

9. WELL NO.
314

10. FIELD AND POOL, OR WILDCAT
South Blanco-Otero Chacra
Pictured Cliffs

11. SEC., T., R., M., OR BLK.
AND SURVEY OR AREA
Section 18 26N 6W

12. COUNTY OR PARISH
Rio Arriba

13. STATE
New Mexico

16. NO. OF ACRES IN LEASE
2400

17. NO. OF ACRES ASSIGNED
TO THIS WELL
160 each ✓

20. ROTARY OR CABLE TOOLS
Rotary

22. APPROX. DATE WORK WILL START*
June 30, 1977

1a. TYPE OF WORK
DRILL ☒ DEEPEN ☐ PLUG BACK ☐

b. TYPE OF WELL
OIL WELL ☐ GAS WELL ☒ OTHER ☐ SINGLE ZONE ☐ MULTIPLE ZONE ☒

2. NAME OF OPERATOR
Caulkins Oil Company

3. ADDRESS OF OPERATOR
P.O. Box 700, Farmington, New Mexico

4. LOCATION OF WELL (Report location clearly and in accordance with any State requirements.)
At surface 200 from the South and 700 from the East
At proposed prod. zone Same

14. DISTANCE IN MILES AND DIRECTION FROM NEAREST TOWN OR POST OFFICE*
35 miles Southeast of Blanco, New Mexico

15. DISTANCE FROM PROPOSED*
LOCATION TO NEAREST
PROPERTY OR LEASE LINE, FT.
(Also to nearest drlg. unit line, if any) 700

18. DISTANCE FROM PROPOSED LOCATION*
TO NEAREST WELL, DRILLING COMPLETED,
OR APPLIED FOR, ON THIS LEASE, FT. 2750

19. PROPOSED DEPTH
4150

21. ELEVATIONS (Show whether DF, RT, GR, etc.)
6730 Gr.

23. PROPOSED CASING AND CEMENTING PROGRAM

SIZE OF HOLE	SIZE OF CASING	WEIGHT PER FOOT	SETTING DEPTH	QUANTITY OF CEMENT
12 3/4	8 5/8	24	120	Sufficient to circulate
7 7/8	4 1/2	10.5	4150	750 sacks

Surface formation San Jose. No abnormal pressure or temperature anticipated.

It is proposed to drill well to 4150' using gel based 2% mud. Float will be run in drill pipe at bit. ES Ind. and Density Logs will be run in open hole.

Run 4 1/2" 10.5# h-40 casing will be cemented at TD with 350 sacks 50-50 pos cement containing 12% gel per sack followed by 100 sacks West cement. Casing will have rotating scratchers and centralizers thru Pictured Cliffs and Chacra.

After Model "R" production packer will be run on 1 1/4" IS 2.3# tubing. Tubing will be set at top of Chacra Zone with packer below Pictured Cliffs perforations.

Run 1" NU 10 rd tht. V-55 tubing will be run to top of Pictured Cliffs perforations.

Pictured Cliffs and Chacra Zones will be sand water frac'd to stimulate prod.

A Shaffer 6" Model LMP, 6000# test, 3000# WP Blowout preventer will be in use at all times while drilling below 120'. Blowout preventer will be tested at least once during each 24 hours day.

IN ABOVE SPACE DESCRIBE PROPOSED PROGRAM: If proposal is to deepen or plug back, give data on present productive zone and proposed new productive zone. If proposal is to drill or deepen directionally, give pertinent data on subsurface locations and measured and true vertical depths. Give blowout preventer program, if any.

24. SIGNED Charles E. Vergue TITLE Superintendent DATE March 17, 1977
(This space for Federal or State office use)

PERMIT NO. _____ APPROVAL DATE _____

APPROVED BY _____ TITLE _____ DATE _____
CONDITIONS OF APPROVAL, IF ANY: _____

**NEW MEXICO OIL CONSERVATION COMMISSION
WELL LOCATION AND ACREAGE DEDICATION PLAT**

Form C-102
Supersedes C-128
Effective 1-4-65

All distances must be from the outer boundaries of the Section.

Operator Caulkins Oil Company			Lease NM 03733		Well No. 314
Tract Letter P	Section 18	Township 26 North	Range 6 West	County Rio Arriba	
Actual Footage Location of Well:					
900	feet from the	South	line and	790	feet from the East line
Ground Level Elev. 6739	Producing Formation Pictured Cliffs Chacra		Pool South Blanco Otero Chacra	Dedicated Acreage: 160 each Acres	

1. Outline the acreage dedicated to the subject well by colored pencil or hachure marks on the plat below.
2. If more than one lease is dedicated to the well, outline each and identify the ownership thereof (both as to working interest and royalty).
3. If more than one lease of different ownership is dedicated to the well, have the interests of all owners been consolidated by communitization, unitization, force-pooling, etc?

☐ Yes ☐ No If answer is "yes," type of consolidation _____

If answer is "no," list the owners and tract descriptions which have actually been consolidated. (Use reverse side of this form if necessary.) _____

No allowable will be assigned to the well until all interests have been consolidated (by communitization, unitization, forced-pooling, or otherwise) or until a non-standard unit, eliminating such interests, has been approved by the Commission.

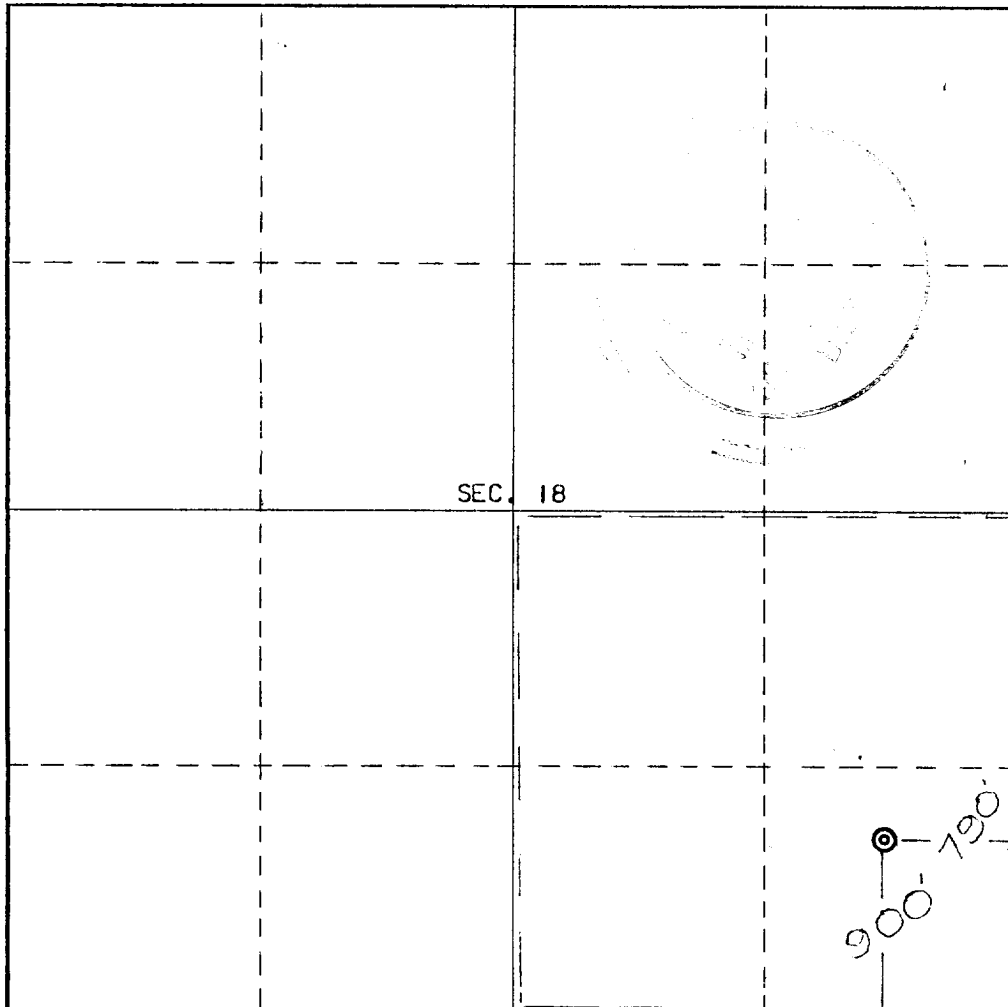

CERTIFICATION

I hereby certify that the information contained herein is true and complete to the best of my knowledge and belief.

Name *Robert E. Eychawk*
Position **Superintendent**
Company **Caulkins Oil Company**
Date **March 17, 1977**

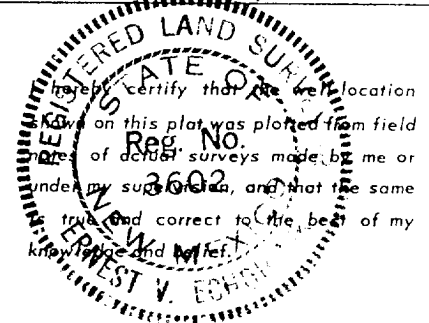

Date Surveyed **March 6, 1977**
Registered Professional Engineer and/or Land Surveyor
E. V. Echow
Certificate No. **3602**
E.V. Echow LS