

NO. OF COPIES RECEIVED	6
DISTRIBUTION	
SANTA FE	1
FILE	1
U.S.G.S.	2
LAND OFFICE	1
OPERATOR	1

NEW MEXICO OIL CONSERVATION COMMISSION

FOR ...
DRILLING COMPLETED

EXPIRES 7-7-77

30-039-21375
Form C-101
Revised 1-1-65

5A. Indicate Type of Lease	
STATE <input checked="" type="checkbox"/>	FEE <input type="checkbox"/>
5. State Oil & Gas Lease No.	
EZ-877-5	

APPLICATION FOR PERMIT TO DRILL, DEEPEN, OR PLUG BACK

1a. Type of Work		7. Unit Agreement Name	
b. Type of Well DRILL <input checked="" type="checkbox"/> DEEPEN <input type="checkbox"/> PLUG BACK <input type="checkbox"/>		8. Farm or Lease Name	
OIL WELL <input type="checkbox"/> GAS WELL <input checked="" type="checkbox"/> OTHER <input type="checkbox"/> SINGLE ZONE <input checked="" type="checkbox"/> MULTIPLE ZONE <input type="checkbox"/>		Harvey	
2. Name of Operator		9. Well No.	
Leland Petroleum Production Inc. <i>Stephen M. Thompson</i>		1	
3. Address of Operator		10. Field and Pool, or Wildcat	
2506 McKinney, Suite A, Dallas, Texas 75201		Ballard PC Ext	
4. Location of Well		12. County	
UNIT LETTER <u>N</u> LOCATED <u>830</u> FEET FROM THE <u>south</u> LINE		Rio Arriba	
AND <u>1850</u> FEET FROM THE <u>west</u> LINE OF SEC. <u>2</u> TWP. <u>25N</u> RGE. <u>7W</u> NMPM			
19. Proposed Depth		19A. Formation	20. Rotary or C.T.
3000		Pictured Cliff	Rotary
21. Elevations (Show whether DF, RT, etc.)	21A. Kind & Status Plug. Bond	21B. Drilling Contractor	22. Approx. Date Work will start
6375	one Well (\$5000.00)	Wilson Drilling Co.	ASAP

23.

PROPOSED CASING AND CEMENT PROGRAM

SIZE OF HOLE	SIZE OF CASING	WEIGHT PER FOOT	SETTING DEPTH	SACKS OF CEMENT	EST. TOP
12 1/4"	8 5/8"	20#	120'	90 sacks class "B"	surface
6 1/2"	4 1/2"	10.5#	3000'	plus 2% CaCl ₂	
				100 sacks 65-35 Poz mix plus 12% gel	surface
				100 sacks class "B"	

Move in and rig up rotary tools. Drill 12 1/4" hole to 120 feet, and set 8 5/8" casing as above. Install 600 series blow out preventers and test. Drill 6 1/2" hole to 3000 feet. Run open hole logs to evaluate Pictured Cliff formation. If well is commercial, 4 1/2" casing will be run and cemented as above. If the well is not commercial, it will be plugged and abandoned as per Oil Conservation Commission instructions.

No abnormal pressures are anticipated, and the well will be drilled with mud having the following characteristics: Wt. 9.0±, viscosity 32±, WL 10±.

Gas under this lease is not dedicated to an existing contract.

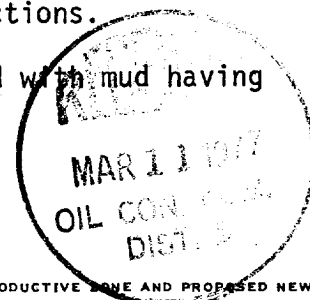

IN ABOVE SPACE DESCRIBE PROPOSED PROGRAM: IF PROPOSAL IS TO DEEPEN OR PLUG BACK, GIVE DATA ON PRESENT PRODUCTIVE ZONE AND PROPOSED NEW PRODUCTIVE ZONE. GIVE BLOWOUT PREVENTER PROGRAM, IF ANY.

I hereby certify that the information above is true and complete to the best of my knowledge and belief.

Signed William T. Jones Title Agent Date 2-22-77
(This space for State Use)

APPROVED BY W. Kendrick TITLE SUPERVISOR DESP. 60 DATE APR 2-1977
CONDITIONS OF APPROVAL, IF ANY:

NEW MEXICO OIL CONSERVATION COMMISSION
WELL LOCATION AND ACREAGE DEDICATION PLAT

Form C-102
Supersedes C-128
Effective 1-1-65

All distances must be from the outer boundaries of the Section.

Operator <u>Stephen M. Thompson</u> Leland Petroleum Production Inc.		Lease <u>Harvey</u>		Well No. <u>1</u>
Unit Letter <u>N</u>	Section <u>2</u>	Township <u>25N</u>	Range <u>7W</u>	County <u>Rio Arriba</u>
Actual Footage Location of Well: <u>830</u> feet from the <u>South</u> line and <u>1850</u> feet from the <u>West</u> line				
Ground Level Elev. <u>6375</u>	Producing Formation <u>Pictured Cliff</u>	Pool <u>Ballard Pictured Cliff</u>	Dedicated Acreage: <u>160</u> ✓ Acres	

1. Outline the acreage dedicated to the subject well by colored pencil or hachure marks on the plat below.
2. If more than one lease is dedicated to the well, outline each and identify the ownership thereof (both as to working interest and royalty).
3. If more than one lease of different ownership is dedicated to the well, have the interests of all owners been consolidated by communitization, unitization, force-pooling, etc?

☐ Yes ☐ No If answer is "yes," type of consolidation _____

If answer is "no," list the owners and tract descriptions which have actually been consolidated. (Use reverse side of this form if necessary.) _____

No allowable will be assigned to the well until all interests have been consolidated (by communitization, unitization, forced-pooling, or otherwise) or until a non-standard unit, eliminating such interests, has been approved by the Commission.

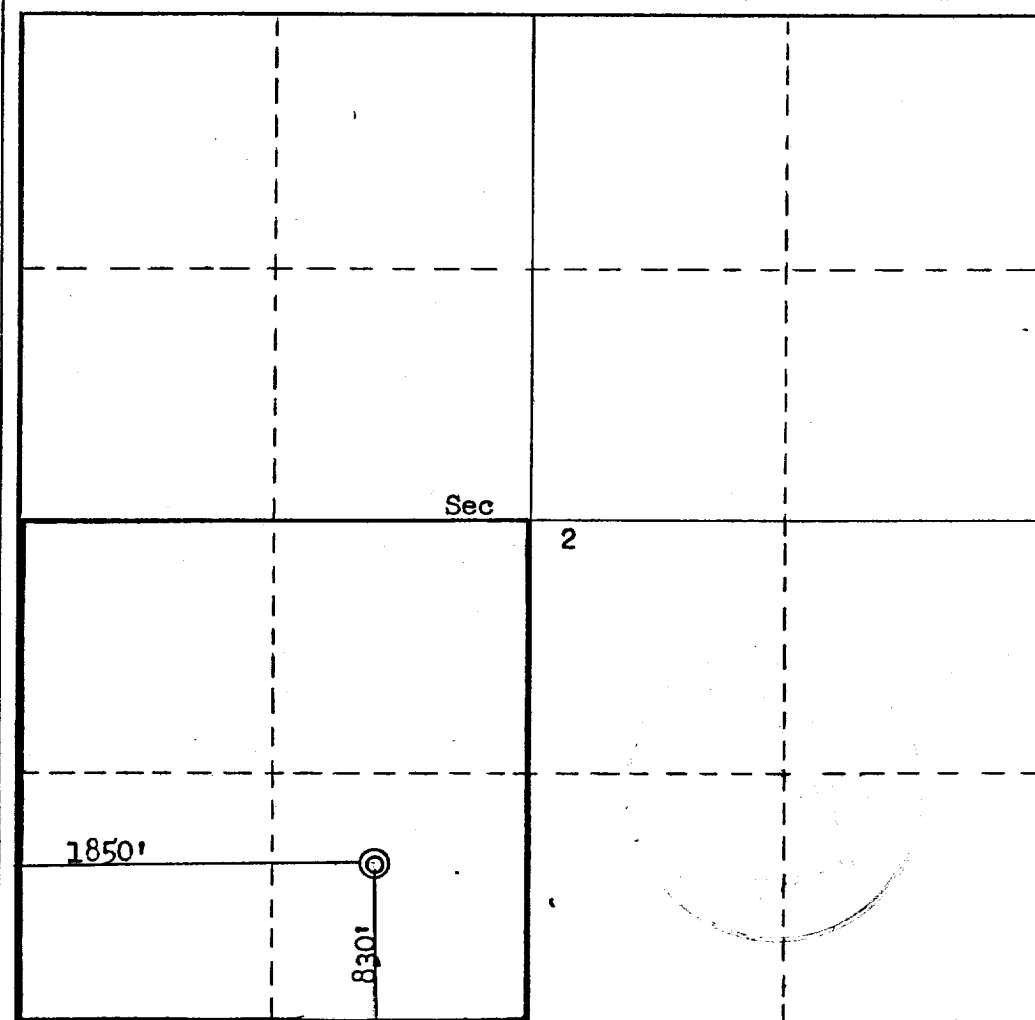

CERTIFICATION

I hereby certify that the information contained herein is true and complete to the best of my knowledge and belief.

William T. Jones

Name
Agent

Position
Leland Petroleum Prod., Inc.

Company
February 22, 1977

Date
William T. Jones

I hereby certify that the well location shown on this plat was plotted from field notes of actual surveys made by me or under my supervision, and that the same is true and correct to the best of my knowledge and belief.

Date Surveyed
February 23, 1977

Registered Professional Engineer and/or Land Surveyor

Fred B. Kerr Jr.

Certificate No.

3950

