

UNITED STATES  
DEPARTMENT OF THE INTERIOR  
GEOLOGICAL SURVEY

SUNDRY NOTICES AND REPORTS ON WELLS

(Do not use this form for proposals to drill or to deepen or plug back to a different reservoir. Use Form 9-331-C for such proposals.)

1. oil ☐ well gas ☒ well other ☐

2. NAME OF OPERATOR  
Supron Energy Corporation

3. ADDRESS OF OPERATOR  
P.O. Box 808, Farmington, New Mexico 87401

4. LOCATION OF WELL (REPORT LOCATION CLEARLY. See space 17 below.)  
AT SURFACE: 925 Ft./S; 1658 Ft./W line  
AT TOP PROD. INTERVAL: Same as above  
AT TOTAL DEPTH: Same as above

16. CHECK APPROPRIATE BOX TO INDICATE NATURE OF NOTICE, REPORT, OR OTHER DATA

REQUEST FOR APPROVAL TO:		SUBSEQUENT REPORT OF:	
TEST WATER SHUT-OFF	<input type="checkbox"/>		<input type="checkbox"/>
FRACTURE TREAT	<input type="checkbox"/>		<input type="checkbox"/>
SHOOT OR ACIDIZE	<input type="checkbox"/>		<input type="checkbox"/>
REPAIR WELL	<input type="checkbox"/>		<input type="checkbox"/>
PULL OR ALTER CASING	<input type="checkbox"/>		<input type="checkbox"/>
MULTIPLE COMPLETE	<input checked="" type="checkbox"/>		<input type="checkbox"/>
CHANGE ZONES	<input type="checkbox"/>		<input type="checkbox"/>
ABANDON*	<input type="checkbox"/>		<input type="checkbox"/>
(other)			

5. LEASE  
Contract No. 153

6. IF INDIAN, ALLOTTEE OR TRIBE NAME  
Jicarilla Apache

7. UNIT AGREEMENT NAME

8. FARM OR LEASE NAME  
Jicarilla "J"

9. WELL NO.  
10-E

10. FIELD OR WILDCAT NAME  
Basin Dakota - Blanco Mesaverde

11. SEC., T., R., M., OR BLK. AND SURVEY OR AREA  
Sec. 26, T-26N, R-5W, N.M.P.M.

12. COUNTY OR PARISH  
Rio Arriba

13. STATE  
New Mexico

14. API NO.

15. ELEVATIONS (SHOW DF, KDB, AND WD)  
6582 R.K.B.

(NOTE: Report results of multiple completion or zone change on Form 9-330.)

17. DESCRIBE PROPOSED OR COMPLETED OPERATIONS (Clearly state all pertinent details, and give pertinent dates, including estimated date of starting any proposed work. If well is directionally drilled, give subsurface locations and measured and true vertical depths for all markers and zones pertinent to this work.)\*

The original request on the APD was for a Dakota completion only. After running logs, it was determined that the Mesaverde zone should also be completed. We hereby request permission to make this well a Dakota - Mesaverde dual. Tubing will be run to the Dakota zone. The Mesaverde will be produced through the annulus. A packer will be run to separate the two zones.

Subsurface Safety Valve: Manu. and Type \_\_\_\_\_

18. I hereby certify that the foregoing is true and correct

SIGNED Kenneth E. Roddy TITLE Production Supt. DATE October 29, 1980  
Kenneth E. Roddy

(This space for Federal or State office use)

APPROVED BY \_\_\_\_\_ TITLE \_\_\_\_\_ DATE \_\_\_\_\_  
CONDITIONS OF APPROVAL, IF ANY:

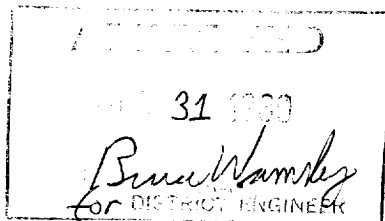

\*See Instructions on Reverse Side

NMOCC

All distances must be from the outer boundaries of the Section.

Operator <b>SUPRON ENERGY CORPORATION</b>			Lease <b>JICARILLA "J"</b>		Well No. <b>10-E</b>
Unit Letter <b>N</b>	Section <b>26</b>	Township <b>26 NORTH</b>	Range <b>5 WEST</b>	County <b>RIO ARriba</b>	
Actual Footage Location of Well:					
925 feet from the		<b>SOUTH</b> line and	1658 feet from the		<b>WEST</b> line
Ground Level Elev. <b>6571</b>	Producing Formation <b>ME SAVERDE</b> <b>DAKOTA</b>		Pool <b>BLANCO</b> <b>BASIN</b>		Dedicated Acreage <b>S/2 320</b> Acres

1. Outline the acreage dedicated to the subject well by colored pencil or hatchure marks on the plat below.
2. If more than one lease is dedicated to the well, outline each and identify the ownership thereof (both as to working interest and royalty).
3. If more than one lease of different ownership is dedicated to the well, have the interests of all owners been consolidated by communitization, unitization, force-pooling, etc?

☐ Yes ☐ No If answer is "yes," type of consolidation \_\_\_\_\_

If answer is "no," list the owners and tract descriptions which have actually been consolidated. (Use reverse side of this form if necessary.) \_\_\_\_\_

No allowable will be assigned to the well until all interests have been consolidated (by communitization, unitization, forced-pooling, or otherwise) or until a non-standard unit, eliminating such interests, has been approved by the Division.

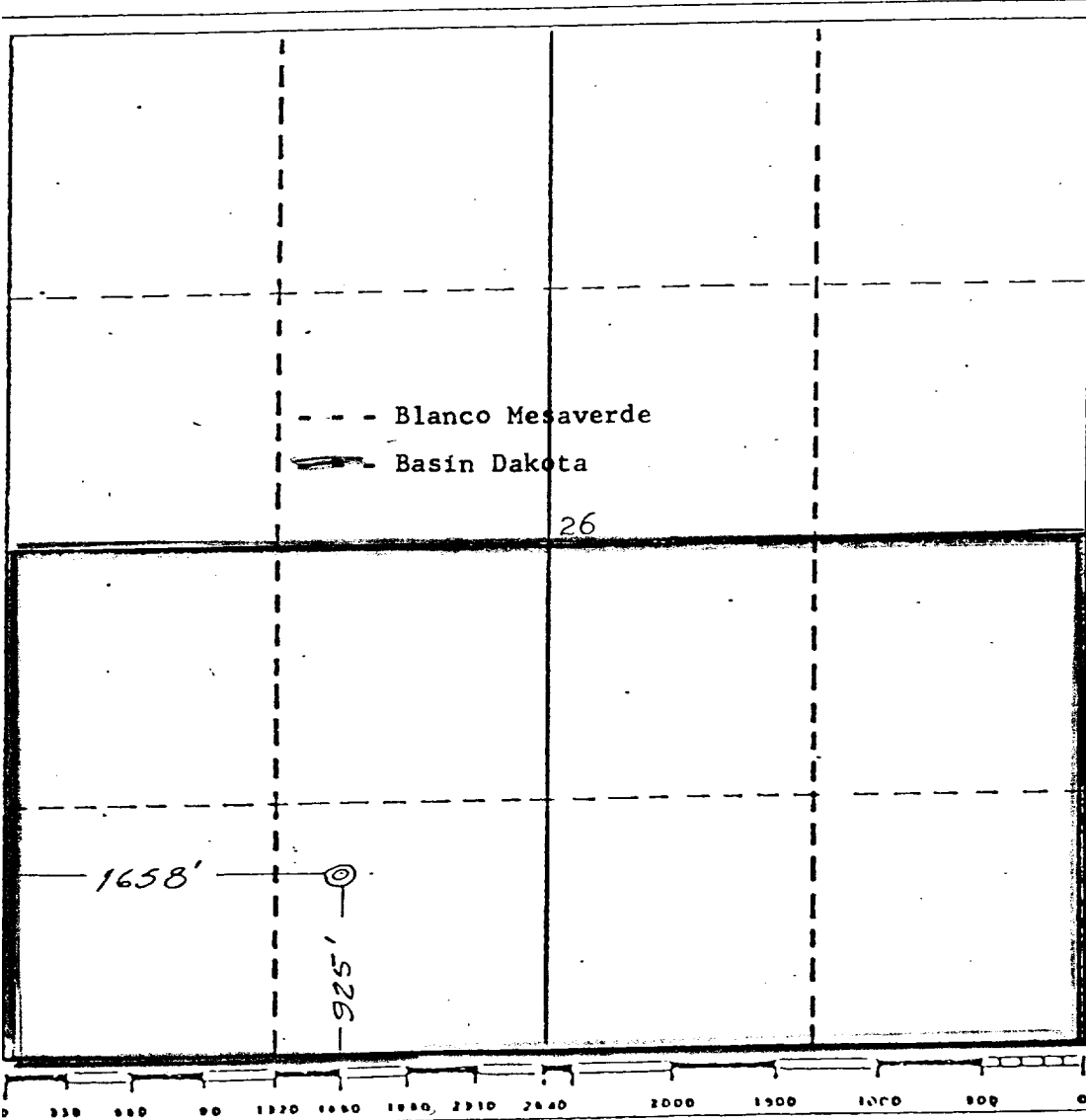

CERTIFICATION

I hereby certify that the information contained herein is true and complete to the best of my knowledge and belief.

*Rudy D. Motto*  
Name

Rudy D. Motto

Position

Area Superintendent

Company

SUPRON ENERGY CORPORATION

Date

February 29, 1980

I hereby certify that the information shown on this plat or plotted field notes, as actual surveys made by me or under my supervision, and that same is true and correct to the best of my knowledge and belief.

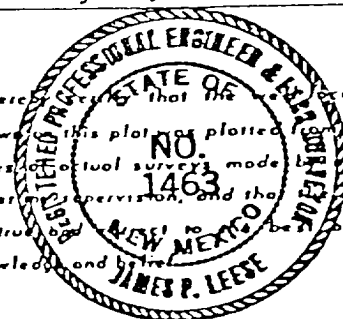

Date Surveyed

February 6, 1980

Registered Professional Engineer  
and Land Surveyor

*James P. Leese*  
James P. Leese

Certificate No.

1463