

OIL CONSERVATION DIVISION

P. O. BOX 2088

SANTA FE, NEW MEXICO 87501

Form C-107  
Revised 10-1-78

STATE OF NEW MEXICO

ENERGY AND MINERALS DEPARTMENT

All distances must be from the outer boundaries of the Section.

Operator <b>MARATHON OIL COMPANY</b>			Lease <b>JICARILIA APACHE</b>		Well No. <b>9E</b>
Unit Letter <b>0</b>	Section <b>28</b>	Township <b>26N</b>	Range <b>5W</b>	County <b>Rio Arriba</b>	
Actual Footage Location of Well: <b>1040</b> feet from the <b>South</b> line and <b>1685</b> feet from the <b>East</b> line					
Ground Level Elev. <b>6684</b>	Producing Formation <b>Point Lookout</b>		Pool <b>Blanco Mesaverde</b>		Dedicated Acreage: <b>320</b> Acres

1. Outline the acreage dedicated to the subject well by colored pencil or hachure marks on the plat below.
2. If more than one lease is dedicated to the well, outline each and identify the ownership thereof (both as to working interest and royalty).
3. If more than one lease of different ownership is dedicated to the well, have the interests of all owners been consolidated by communitization, unitization, force-pooling, etc?

Yes  No If answer is "yes," type of consolidation N/A

If answer is "no," list the owners and tract descriptions which have actually been consolidated. (Use reverse side of this form if necessary.) \_\_\_\_\_

No allowable will be assigned to the well until all interests have been consolidated (by communitization, unitization, forced-pooling, or otherwise) or until a non-standard unit, eliminating such interests, has been approved by the Commission. **BLANCO MESAVERDE CERTIFICATION 11-16-81. DALE T. CADDY** *Dale Caddy*

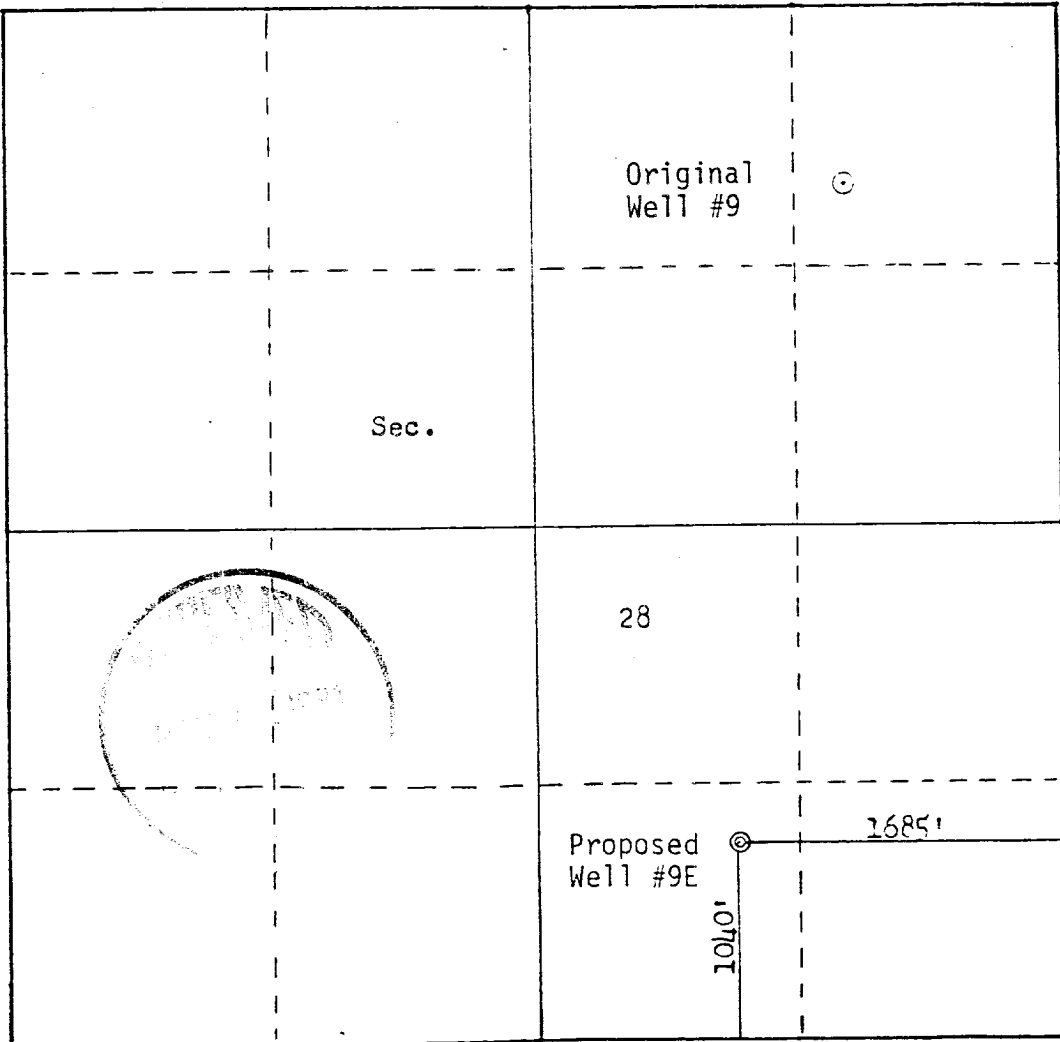

Scale: 1"=1000'

**CERTIFICATION**

I hereby certify that the information contained herein is true and complete to the best of my knowledge and belief.

*Dale T. Caddy*

Name Dale T. Caddy  
 Position District Operations Manager  
 Company Marathon Oil Company  
 Date November 21, 1980

I hereby certify that the well location shown on this plat was plotted from field notes of actual surveys made by me or under my supervision, and that the same is true and correct to the best of my knowledge and belief.

Date Surveyed November 11, 1980

Registered Professional Engineer and Land Surveyor  
*Fred B. Kerr, Jr.*  
 Fred B. Kerr, Jr.  
 Certificate No. 3950