

UNITED STATES
DEPARTMENT OF THE INTERIOR
GEOLOGICAL SURVEY

SUNDRY NOTICES AND REPORTS ON WELLS

(Do not use this form for proposals to drill or to deepen or plug back to a different reservoir. Use Form 9-331-C for such proposals.)

1. oil well ☐ gas well ☒ other

2. NAME OF OPERATOR
Tenneco Oil Company

3. ADDRESS OF OPERATOR
Box 3249, Englewood, CO 80155

4. LOCATION OF WELL (REPORT LOCATION CLEARLY. See space 17 below.)
AT SURFACE: 870' FWL, 1850' FNL
AT TOP PROD. INTERVAL:
AT TOTAL DEPTH:

16. CHECK APPROPRIATE BOX TO INDICATE NATURE OF NOTICE, REPORT, OR OTHER DATA

REQUEST FOR APPROVAL TO:

TEST WATER SHUT-OFF	<input type="checkbox"/>
FRACTURE TREAT	<input type="checkbox"/>
SHOOT OR ACIDIZE	<input type="checkbox"/>
REPAIR WELL	<input type="checkbox"/>
PULL OR ALTER CASING	<input type="checkbox"/>
MULTIPLE COMPLETE	<input type="checkbox"/>
CHANGE ZONES	<input type="checkbox"/>
ABANDON*	<input type="checkbox"/>
(other)	<input type="checkbox"/>

Proposal for

SUBSEQUENT REPORT OF:

ABANDON* ☐ ☐
(other) Proposal for Dual Completion

5. LEASE
Contract #109

6. IF INDIAN, ALLOTTEE OR TRIBE NAME
Jicarilla Apache

7. UNIT AGREEMENT NAME

8. FARM OR LEASE NAME
Jicarilla B

9. WELL NO.
5E

10. FIELD OR WILDCAT NAME
Basin Dakota

11. SEC., T., R., M., OR BLK. AND SURVEY OR
AREA
Sec. 21, T26N, R5W

12. COUNTY OR PARISH Rio Arriba	13. STATE NM
------------------------------------	-----------------

14. API NO.

15. ELEVATIONS (SHOW DF, KDB, AND WD)
6578' GR

RECEIVED

(NOTE: Report results of multiple completion or zone change on Form 9-330.)

OCT 04 1982

U. S. GEOLOGICAL SURVEY
FARMINGTON, N. H.

17. DESCRIBE PROPOSED OR COMPLETED OPERATIONS (Clearly state all pertinent details, and give pertinent dates, including estimated date of starting any proposed work. If well is directionally drilled, give subsurface locations and measured and true vertical depths for all markers and zones pertinent to this work.)*

Tenneco proposes to convert the above-captioned well into a dual completion by also completing in the Mesaverde, as outlined in the attached detailed procedure. Attached is a revised dedication plat.

Subsurface Safety Valve: Manu. and Type

Set @ _____ Ft.

18. I hereby certify that the foregoing is true and correct

SIGNED

Denise Wilson TITLE

TITLE Production Analyst DATE September 30, 1982

(This space for Federal or State office use)

APPROVED BY _____
CONDITIONS OF APPROVAL, IF ANY:

TITLE

DATE _____

~~APPROVED
AS AMENDED~~

OGT 0,5 1982

JAMES F. SIMS
DISTRICT ENGINEER

ANMOCC

*See Instructions on Reverse Side

WELL NO. 5E9-5/8 "OD, 36 LB, K-55 CSG. W/ 200 SXTOC surface4-1/2 "OD, 11.6/10.5, K-55 CSG. W/452/190/402SXTOC 4018'/2583'/surface

DETAILED PROCEDURE:

1. MIRUSU. NDWH. NUBOP.
2. RIH w/tbg & bit. DO DV's & cmt to latch collar @7458'.
3. PT csg to 3500 psi. Roll hole w/1% KCl wtr & spot 500 gals 7-1/2% DI HCL @7418'.
4. POOH w/tbg & bit.
5. Run GR/CCL/CBL from TD to 4000. Tekcopy to RM. Perf Dakota 'B' & 'D' w/3-1/8" premium charge csg gun using 1 JSPF as follows:

7319-35'	16'
7366-84'	18'
7405-18'	13'

 Total: 47', 47 holes.
6. Acidize Dakota 'B' & 'D' w/1000 gal 15% weighted HCL & 70 - 1.1 SG balls.
7. Run WL junk basket to PBTD.
8. Frac w/60,000 gal 30# X-L 1% KCl @50 BPM as follows:

17,000 gal pad
5,000 gal w/1# 20/40
9,000 gal w/2# 20/40
20,000 gal w/3# 20/40
9,000 gal w/4# 20/40

 Total: 119,000# 20/40, 60,000 gel
 Flush to 1 bbl shy of top perf.
9. Set Baker WL set RBP @7260' & dump 2 sx sd on RBP. PT to 3500 psi. RIH w/tbg.
10. Spot 250 gal 7-1/2% DI HCL @7201'. POOH w/tbg.
11. Perf Dakota 'A' w/3-1/8" premium charge csg gun using 2 JSPF as follows:

7190-7201'	11'	22 holes
------------	-----	----------
12. Acidize Dakota 'A' w/400 gal 15% weighted HCL & 33 balls.

Cont'd....

295'

DV @,
2583'DV @,
4018'LC @,
7458'

7499

WELL SITE

13. Roundtrip WL junk basket to 7250'.

14. Frac Dakota 'A' w/50,000 gal 30# X-L 1% KCl @25 BPM as follows:

15,000 gal pad
5,000 gal w/1# 20/40
5,000 gal w/2# 20/40
10,000 gal w/3# 20/40
15,000 gal w/4# 20/40

Total: 105,000# 20/40

15. RIH w/2-3/8" tbg & ret. head. CO to RBP w/foam. POOH w/RBP. RIH w/tbg. CO to PBTD w/foam.

16. Land tbg @7350'. Kick well around w/N₂. FTCU.

MV COMPLETION - May have to be squeezed based on results of CBL.

1. RIH w/tbg & tag PBTD. CO w/foam if necessary. POOH w/tbg.
2. Set WL set Baker RBP @4800'. Dump 2 sxs sd on RBP. Load hole w/1% KCl wtr. PT RBP to 3500 psi.
3. Perf Cliffhouse w/3-1/8" premium charge csg gun & 2 JSPF as follows:
4756-69' 13' & 26 holes
4. Acidize Cliffhouse w/750 gals 15% weighted HCL & 39 - 1.1 SG balls.
5. Run WL junk basket to knock balls off.
6. Frac Cliffhouse w/slick 1% KCl wtr & 20/40 sd as follows:

13,000 gal pad
5,000 gal w/.5 ppg 20/40
5,000 gal w/1.0 ppg 20/40
5,000 gal w/1.5 ppg 20/40
12,000 gal w/2.0 ppg 20/40

Flush to within 1 bbl of top perf.

Total: 40,074 gal & 39,000# 20/40

Rate = 50 BPM.

7. RIH w/tbg & ret. head. CO to RBP w/foam. Latch RBP & POOH w/tbg & RBP.
8. RIH w/2-3/8" tbg w/4-1/2" lock-set pkr & SN. Position Baker 4-1/2" lock-set pkr to be @4850' when tbg lands in Dakota perms. Run blast jts across MV perms.
at 7090 *
9. Set lock-set pkr, land tbg_A NDBOP. NUWH.
10. NDBOP. NUWH. Swab in Dakota.
11. FTCU. SI for AOF.

* Tbg landed at 7090 for future production survey.

OIL CONSERVATION DIVISION

STATE OF NEW MEXICO
ENERGY AND MINERALS DEPARTMENTP. O. BOX 2088
SANTA FE, NEW MEXICO 87501Form C-107
Revised 10-1-78

All distances must be from the outer boundaries of the Section.

Operator TENNECO OIL COMPANY			Lease JICARILLA "B"		Well No. 5E
Unit Letter E	Section 21	Township 26N	Range 5W	County Rio Arriba	
Actual Footage Location of Well: 1850 feet from the North line and 870 feet from the West line					
Ground Level Elev. 6578	Producing Formation Dakota	Pool Basin Dakota / Und. Mesaverde		Dedicated Acreage: 320/160 Acres	

1. Outline the acreage dedicated to the subject well by colored pencil or hachure marks on the plat below.
2. If more than one lease is dedicated to the well, outline each and identify the ownership thereof (both as to working interest and royalty).
3. If more than one lease of different ownership is dedicated to the well, have the interests of all owners been consolidated by communitization, unitization, force-pooling, etc?

☐ Yes ☐ No If answer is "yes," type of consolidation _____

If answer is "no," list the owners and tract descriptions which have actually been consolidated. (Use reverse side of this form if necessary.) _____

No allowable will be assigned to the well until all interests have been consolidated (by communitization, unitization, forced-pooling, or otherwise) or until a non-standard unit, eliminating such interests, has been approved by the Commission.

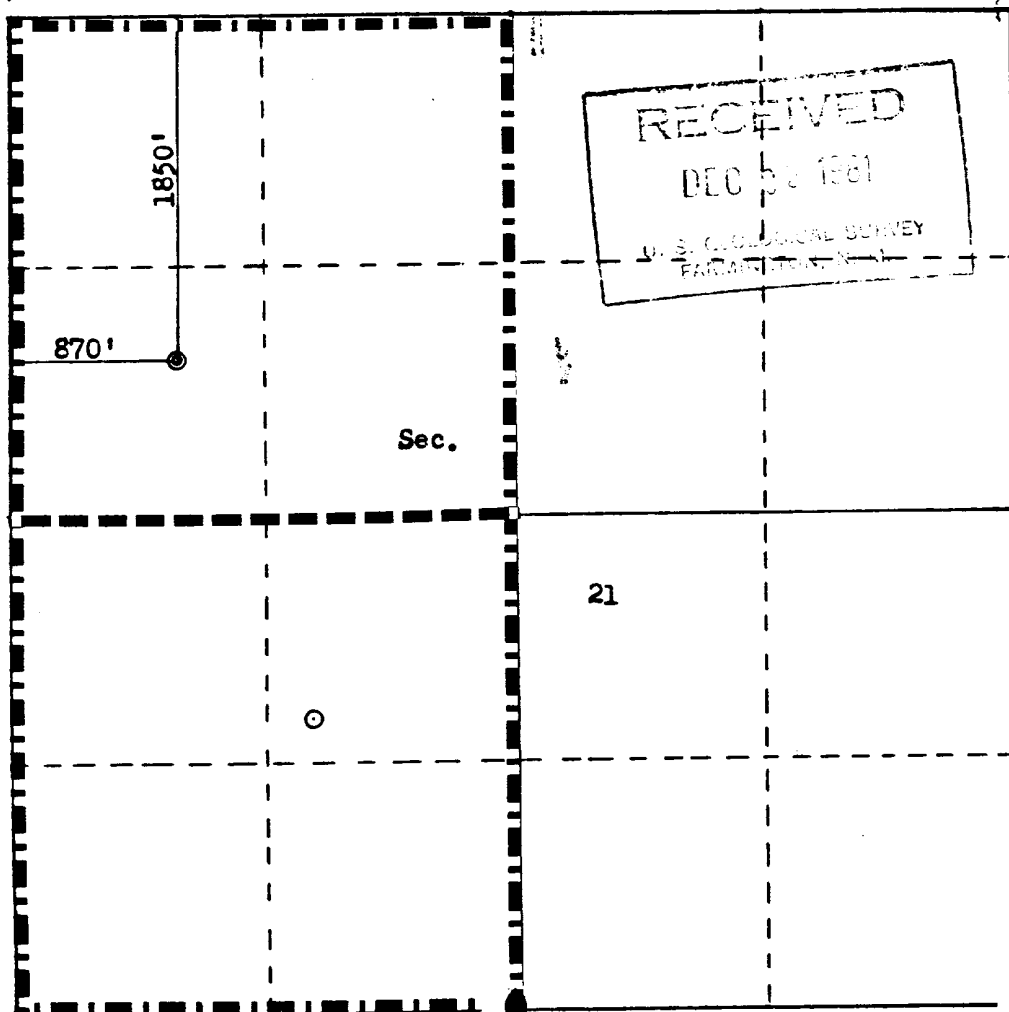

Scale: 1"=1000'

CERTIFICATION

I hereby certify that the information contained herein is true and complete to the best of my knowledge and belief.

Name
Don H. Harrison

Position
Production Analyst

Company
Tenneco Oil Company

Date
10-13-81

I hereby certify that the well location shown on this plat was plotted from field notes of actual surveys made by me or under my supervision, and that the same is true and correct to the best of my knowledge and belief.

Date Surveyed
October 15, 1981

Registered Professional Engineer and Land Surveyor
Fred B. Kerr Jr.

Certificate No.
3950