

UNITED STATES
DEPARTMENT OF THE INTERIOR
BUREAU OF LAND MANAGEMENT

APPLICATION FOR PERMIT TO DRILL, DEEPEN, OR PLUG BACK

1a. TYPE OF WORK
 DRILL DEEPEN PLUG BACK
 b. TYPE OF WELL
 OIL WELL GAS WELL OTHER
 SINGLE ZONE MULTIPLE ZONE
 2. NAME OF OPERATOR
 El Paso Exploration Company
 3. ADDRESS OF OPERATOR
 PO Box 4289, Farmington, NM 87499
 4. LOCATION OF WELL (Report location clearly and in accordance with any State requirements*)
 At surface 1770'S, 1500'E
 At proposed prod. zone

5. LEASE DESIGNATION AND SERIAL NO.
 Jicarilla 119N Cont
 6. IF INDIAN, ALLOTTEE OR TRIBE NAME
 7. UNIT AGREEMENT NAME
 8. FARM OR LEASE NAME
 Jicarilla 119 N
 9. WELL NO.
 4E
 10. FIELD AND POOL, OR WILDCAT
 Basin Dakota
 11. SEC., T., R., M., OR BLK. AND SURVEY OR AREA
 Sec. 6, T-26-N, R- 4-V
 NMPM
 12. COUNTY OR PARISH
 Rio Arriba NM
 13. STATE

14. DISTANCE IN MILES AND DIRECTION FROM NEAREST TOWN OR POST OFFICE
 20 miles Northwest of Lindrith, NM
 15. DISTANCE FROM PROPOSED* LOCATION TO NEAREST PROPERTY OR LEASE LINE, FT. (Also to nearest drlg. unit line, if any)
 1500'
 16. NO. OF ACRES IN LEASE
 2587.18
 17. NO. OF ACRES ASSIGNED TO THIS WELL
 E 322.72
 18. DISTANCE FROM PROPOSED LOCATION* TO NEAREST WELL, DRILLING, COMPLETED, OR APPLIED FOR, ON THIS LEASE, FT.
 250'
 19. PROPOSED DEPTH
 8350'
 20. ROTARY OR CABLE TOOLS
 Rotary
 21. ELEVATIONS (Show whether DF, RT, GR, etc.)
 7151'GL
 DRILLING OPERATIONS AUTHORIZED ARE SUBJECT TO COMPLIANCE WITH ATTACHED GENERAL REQUIREMENTS
 22. APPROX. DATE WORK WILL START*
 This action is subject to administrative appeal pursuant to 30 CFR 290.

SIZE OF HOLE	SIZE OF CASING	WEIGHT PER FOOT	SETTING DEPTH	QUANTITY OF CEMENT
12 1/4"	9 5/8"	36.0#	200'	130 cu.ft.circulated
7 7/8"	4 1/2"	10.5#	8350'	1138 cu.ft.circulated

Selectively perforate and sand water fracture the Dakota formation.
 A 3000 psi WP and 6000 psi test double gate preventer equipped with blind and pipe rams will be used for blow out prevention on this well.
 This gas is dedicated.
 The E/2 of Section 6 is dedicated to this well.

RECEIVED
 JAN 14 1985
 OIL CON. DIV.
 DIST. 3

IN ABOVE SPACE DESCRIBE PROPOSED PROGRAM: If proposal is to deepen or plug back, give data on present productive zone and proposed new productive zone. If proposal is to drill or deepen directionally, give pertinent data on subsurface locations and measured and true vertical depths. Give blowout preventer program, if any.

24. SIGNED [Signature] TITLE Drilling Clerk
 (This space for Federal or State office use)
 PERMIT NO. _____ APPROVAL DATE _____
 APPROVED BY _____ TITLE _____
 CONDITIONS OF APPROVAL, IF ANY:

APPROVED
 DATE 10-15-84
 AS AMENDED
 DEC 05 1984
 [Signature]
 AREA MANAGER
 FARMINGTON RESOURCE AREA

OPERATOR
 *See Instructions On Reverse Side

All distances must be from the outer boundaries of the Section.

Operator EL PASO EXPLORATION COMPANY			Lease JICARILLA 119N		Well No. LE
Unit Letter J	Section 6	Township 26N	Range 4W	County Rio Arriba	
Actual Footage Location of Well: 1770 feet from the South line and 1500 feet from the East line					
Ground Level Elev: 7151	Producing Formation Dakota		Pool Basin	Dedicated Acreage: 322.712 Acres	

1. Outline the acreage dedicated to the subject well by colored pencil or hachure marks on the plat below.
2. If more than one lease is dedicated to the well, outline each and identify the ownership thereof (both as to working interest and royalty).
3. If more than one lease of different ownership is dedicated to the well, have the interests of all owners been consolidated by communitization, unitization, force-pooling, etc?

Yes No If answer is "yes," type of consolidation _____

If answer is "no," list the owners and tract descriptions which have actually been consolidated. (Use reverse side of this form if necessary.) _____

No allowable will be assigned to the well until all interests have been consolidated (by communitization, unitization, forced-pooling, or otherwise) or until a non-standard unit, eliminating such interests, has been approved by the Commission.

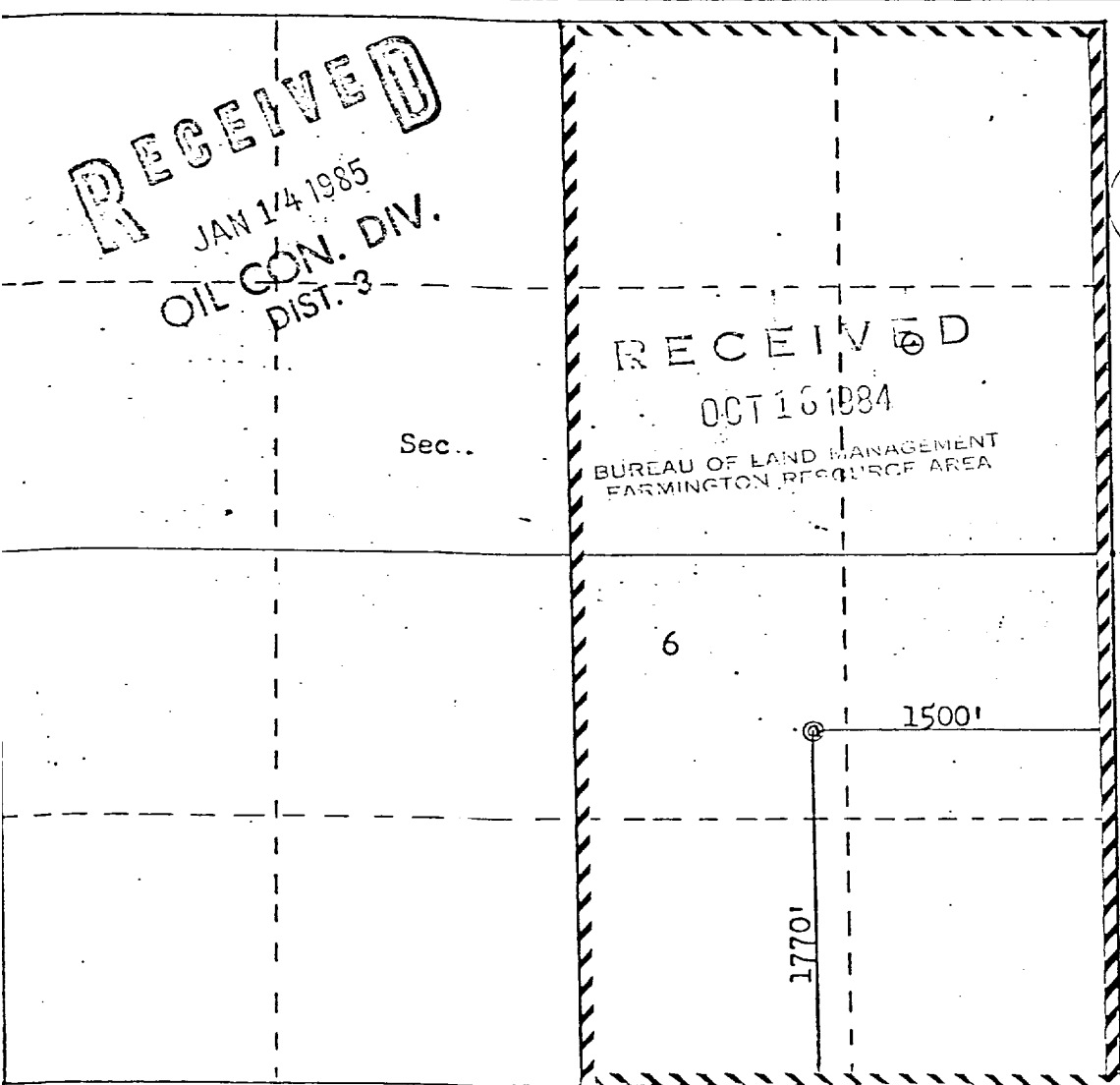

RECEIVED
JAN 14 1985
OIL CON. DIV.
DIST. 3

RECEIVED
OCT 16 1984
BUREAU OF LAND MANAGEMENT
FARMINGTON RESOURCE AREA

CERTIFICATION	
I hereby certify that the information contained herein is true and complete to the best of my knowledge and belief.	
<i>Regina Bradford</i>	
Name	Drilling Clerk
Position	El Paso Exploration
Company	October 15, 1984
Date	
I hereby certify that the well location shown on this plat was plotted from field notes of actual surveys made by me or under my supervision, and that the same is true and correct to the best of my knowledge and belief.	
Date Surveyed	September 27, 1984
Registered Professional Engineer and Land Surveyor	
<i>Fred B. Kerr Jr.</i>	
Certificate No. 4000	