

P. O. BOX 2088
SANTA FE, NEW MEXICO 87501

Form C-101
Revised 10-1-78

NO. OF COPIES RECEIVED	
DISTRIBUTION	
SANTA FE	
FILE	
U.S.O.S.	
LAND OFFICE	
OPERATION	

RECEIVED

OCT 03 1988

APPLICATION FOR PERMIT TO DRILL, DEEPEN, **OIL COM BACK**

1a. Type of Work DRILL <input checked="" type="checkbox"/> DEEPEN <input type="checkbox"/> PLUG BACK <input type="checkbox"/>		7. Unit Agreement Name Bear Canyon Unit	
b. Type of Well OIL WELL <input checked="" type="checkbox"/> GAS WELL <input type="checkbox"/> OTHER <input type="checkbox"/>		8. Form or Lease Name	
2. Name of Operator Amoco Production Company		9. Well No. 8	
3. Address of Operator 2325 E. 30th Street, Farmington NM 87401		10. Field and Pool, or Wildcat Gavilan Mancos Ext.	
4. Location of Well UNIT LETTER K LOCATED 1750 FEET FROM THE South LINE AND 1300 FEET FROM THE West LINE OF SEC. 14 TWP. 26N RST. 2W NMPM		12. County Rio Arriba	
13. Proposed Depth 7600'		19A. Formation Gallup	
21. Elevations (Show whether DJ, RT, etc.) 7414' Gr		22. Approx. Date Work will start As soon as permitted	
21A. Kind & Status Plug. Bond State-wide		21B. Drilling Contractor Unknown	
23. PROPOSED CASING AND CEMENT PROGRAM			

SIZE OF HOLE	SIZE OF CASING	WEIGHT PER FOOT	SETTING DEPTH	SACKS OF CEMENT	EST. TOP
12-1/4"	10-3/4"	40.5# K55	300'	See attached	sheet
9-7/8"	7-5/8"	26.4# K55	6150'	" "	"
6-3/4"	5"	29.7# N80 15# K55	7600'	DV tool set at	4000'

CONFIDENTIAL

Lease Description: T26N-R2W NMPM: Section 14: NW/4, NW/4 NE/4, E/2 SW/4
Section 23: NE/4 NW/4

Amoco proposes to drill the above well to further develop of the Gavilan Mancos reservoir. The well will be drilled to the surface casing point using native mud. The well will then be drilled to TD with a low solids nondispersed mud system. Completion design will be based on open hole logs. Copies of all logs will be filed upon completion. Amoco's standard blowout preventer will be utilized; see attached drawing for blowout preventer design. Upon completion, the well site will be cleaned and the reserve pit filled and leveled. The gas from this well is not dedicated.

IN ABOVE SPACE DESCRIBE PROPOSED PROGRAM: IF PROPOSAL IS TO DEEPEN OR PLUG BACK, GIVE DATA ON PRESENT PRODUCTIVE ZONE AND PROPOSED NEW PRODUCTIVE ZONE. GIVE BLOWOUT PREVENTER PROGRAM, IF ANY.

I hereby certify that the information above is true and complete to the best of my knowledge and belief.

Signed *R. Shaw* Title Adm. Supervisor Date Sept 29, 1988
(This space for State Use)

APPROVED BY *Ernie Busch* TITLE DEPUTY OIL & GAS INSPECTOR, DIST. #3 DATE OCT 03 1988
CONDITIONS OF APPROVAL, IF ANY:

PROPOSED CASING AND CEMENTING PROGRAM

<u>Size Of Hole</u>	<u>Size Of Casing</u>	<u>Weight Per Foot</u>	<u>Setting Depth</u>	<u>Quantity Of Cement</u>
12-1/4"	10-3/4"	40.5#, K55	300'	350 cf Class B, 2% CaCl ₂ , 15.6 ppg
9-7/8"	7-5/8"	26.4#, K55 and 29.7#, N80	6750'	Stage 1: 794 cf 50:50 poz, 10% salt, .6% fla 13.9 ppg, tailed in with 118 cf Class B 15.6 ppg Stage 2: 1110 cf Class B 65:35 poz, 10% salt, .6% fla, 12.1 ppg, tailed in with 216 cf Class B, 15.6 ppg
Est. Top of cement at surface				
6-3/4"	5"	15#, K55	7600'	150 cf Class B 50:50 poz, 10% salt, .6% fla, 13.9 ppg
Liner top approximately 6500'				
DV tool set at 4000'				

CONFIDENTIAL

All distances must be from the outer boundaries of the Section.

Operator AMOCO PRODUCTION COMPANY			Lease BEAR CANYON UNIT		Well No. # 8
Unit Letter K	Section 14	Township 26 NORTH	Range 2 WEST	County RIO ARRIBA	
Actual Footage Location of Wells 1750 feet from the SOUTH line and 1800 feet from the WEST line					
Ground Level Elev. 7414	Producing Formation Gallup	Pool Gavilan Mancos	Dedicated Acres 640 Acres		

1. Outline the acreage dedicated to the subject well by colored pencil or hachure marks on the plat below.
2. If more than one lease is dedicated to the well, outline each and identify the ownership thereof (both as to working interest and royalty).
3. If more than one lease of different ownership is dedicated to the well, have the interests of all owners been consolidated by communitization, unitization, force-pooling, etc?

☒ Yes ☐ No If answer is "yes," type of consolidation Communitization

If answer is "no," list the owners and tract descriptions which have actually been consolidated. (Use reverse side of this form if necessary.)

No allowable will be assigned to the well until all interests have been consolidated (by communitization, unitization, forced-pooling, or otherwise) or until a non-standard unit, eliminating such interests, has been approved by the Division.

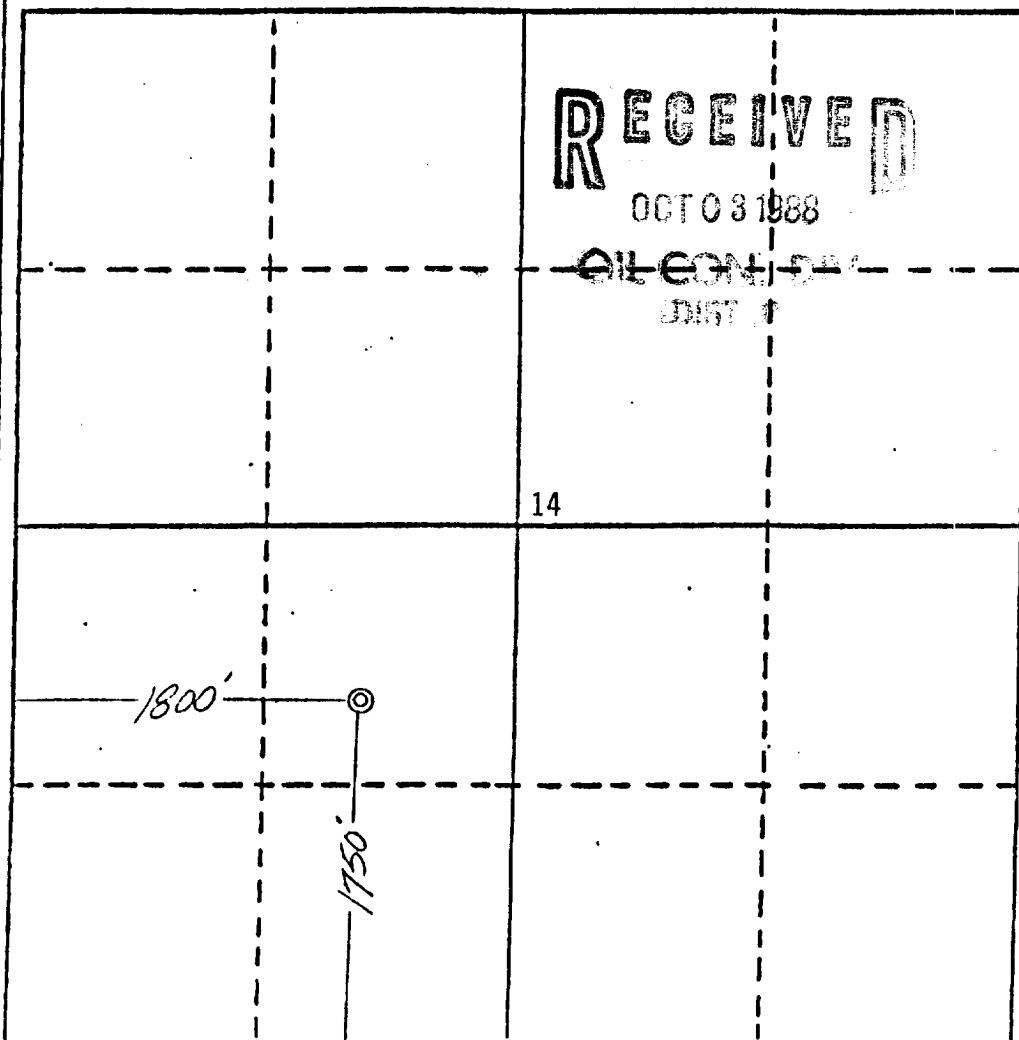

CERTIFICATION

I hereby certify that the information contained herein is true and complete to the best of my knowledge and belief.

B.D. Shaw

Name
B.D. Shaw
Position
Adm. Supervisor
Company
Amoco Production Co
Date
Sept 29, 1988

I hereby certify that the location shown on this plat was plotted from field notes of actual surveys made by me or under my supervision, and that the same is true and correct to the best of my knowledge and belief.

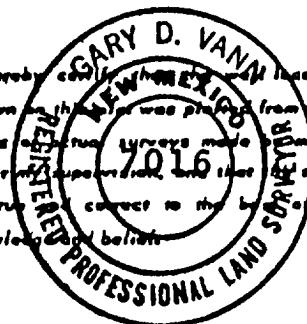

Date Surveyed
July 28, 1988
Registered Professional Engineer and/or Land Surveyor
Gary D. Vann
Gary D. Vann

Certificate No.

7016

