

UNITED STATES
DEPARTMENT OF THE INTERIOR
BUREAU OF LAND MANAGEMENT

APPLICATION FOR PERMIT TO DRILL, DEEPEN, OR PLUG BACK

1A. TYPE OF WORK DRILL <input checked="" type="checkbox"/> DEEPEN <input type="checkbox"/> PLUG BACK <input type="checkbox"/>				5. LEASE DESIGNATION AND SERIAL NO. NM 03381	
B. TYPE OF WELL OIL WELL <input type="checkbox"/> GAS WELL <input checked="" type="checkbox"/> OTHER <input type="checkbox"/> SINGLE ZONE <input type="checkbox"/> MULTIPLE ZONE <input checked="" type="checkbox"/>				6. IF INDIAN, ALLOTTEE OR TRIBE NAME	
2. NAME OF OPERATOR Caulkins Oil Company				7. UNIT AGREEMENT NAME	
3. ADDRESS OF OPERATOR P.O. Box 340 Bloomfield, New Mexico 87413				8. FARM OR LEASE NAME Breech "B"	
4. LOCATION OF WELL (Report location clearly and in accordance with any State requirements.) At surface 1664' F/S and 1611' F/E At proposed prod. zone Same				9. WELL NO. 172-R	
14. DISTANCE IN MILES AND DIRECTION FROM NEAREST TOWN OR POST OFFICE* 30 Miles South west of Blanco, New Mexico				10. FIELD AND POOL, OR WILDCAT Basin Dakota - Blanco MV	
15. DISTANCE FROM PROPOSED* LOCATION TO NEAREST PROPERTY OR LEASE LINE, FT. (Also to nearest drlg. unit line, if any) 990'		16. NO. OF ACRES IN LEASE 1120		17. NO. OF ACRES ASSIGNED TO THIS WELL 320 326.15/326.15	
18. DISTANCE FROM PROPOSED LOCATION* TO NEAREST WELL, DRILLING, COMPLETED, OR APPLIED FOR, ON THIS LEASE, FT. 525'		19. PROPOSED DEPTH 2750' 7300'		20. ROTARY OR CABLE TOOLS Rotary	
21. ELEVATIONS (Show whether DF, RT, GR, etc.) DRILLING OPERATIONS AUTHORIZED ARE 6412 GR				22. APPROX. DATE WORK WILL START* June 1, 1989	
23. SUMMARY OF PROPOSED PROGRAM WITH ATTACHED GENERAL REQUIREMENTS				This action is subject to Federal and State procedural review pursuant to 43 CFR 161.3 and appeal pursuant to 43 CFR 161.3	
SIZE OF HOLE		SIZE OF CASING		WEIGHT PER FOOT	
12 1/4"		8 5/8"		24#	
7 7/8"		4 1/2"		10.5#	
				SETTING DEPTH	
				300'	
				7300'	
				230 Cu.Ft.	
				1700 Cu.Ft.	

It is proposed to drill new hole, surface to 7300', using 9.1# plus gel based mud. Float will be run in drill pipe at bit. ES Gamma and Porosity Logs will be run in open hole.

A Schaeffer 10" Model LWP, 6000# test BOP will be in use at all times while drilling below surface casing and until production casing is cemented. BOP will be tested at lease one time during each 24 hour period and results recorded on daily drilling report.

8 5/8" 24# surface casing will be cemented at approx. 300' with sufficient cement to circulate to surface, 200 sacks, 230 Cu.Ft.

4 1/2" 10.5# J-55 Smls casing will be cemented surface to 7300' in 3 stages with sufficient cement to circulate to surface, approx. 1700 Cu.Ft.
(OVER)

IN ABOVE SPACE DESCRIBE PROPOSED PROGRAM: If proposal is to deepen or plug back, give data on present productive zone and proposed new productive zone. If proposal is to drill or deepen directionally, give pertinent data on subsurface locations and measured and true vertical depths. Give blowout preventer program, if any.

24. SIGNED Charles E. Vergues TITLE Superintendent DATE 3-28-89
(This space for Federal or State office use)

PERMIT NO. _____ APPROVAL DATE _____

APPROVED BY _____ TITLE _____ DATE _____
CONDITIONS OF APPROVAL, IF ANY:

*See Instructions On Reverse Side

Title 18 U.S.C. Section 1001, makes it a crime for any person knowingly and willfully to make to any department or agency of the United States any false, fictitious or fraudulent statements or representations as to any matter within its jurisdiction.

It is proposed to complete well in Mesa Verde and Dakota Zones. After treating and testing zones separately, well will be commingled in wellbore.

Administrative approval for commingling in wellbore will be obtained from New Mexico OCD before completing.

Estimated formation tops and bottoms:

Alamo	1960' to 2130'
Fruitland	2630' to 2700'
Pictured Cliffs	2710' to 2810'
Mesa Verde	4405' to 5195'
Dakota	7030' to 7255'

This well to replace well No. 172. Now single completed in Dakota Zone.

Old well has a casing leak and efforts to clean up have been underway and unsuccessful since June 1987.

Old well location 1850' from South and 960' from East, Section 7, 26 North 6 West.

Application to P & A old well will be submitted under separate cover.

**NEW MEXICO OIL CONSERVATION COMMISSION
WELL LOCATION AND ACREAGE DEDICATION PLAT**

Form C-102
Supersedes C-121
Effective 1-1-83

All distances must be from the outer boundaries of the Section.

Operator CAULKINS OIL COMPANY			Lease NM 03381 <i>B</i>		Well No. 172-R
Unit Letter J	Section 7	Township 26 NORTH	Range 6 WEST	County RIO ARRIBA	
Actual Footage Location of Well					
1664 feet from the SOUTH		line and 1611		feet from the EAST	
Ground Level Elev. 6412	Producing Formation Dakota <i>1.41</i>		Pool Basin <i>1.41</i>		Dedicated Acreage 320 <i>326.15</i> / <i>526.15</i> Acres

1. Outline the acreage dedicated to the subject well by colored pencil or hatchure marks on the plat below.
2. If more than one lease is dedicated to the well, outline each and identify the ownership thereof (both as to working interest and royalty).
3. If more than one lease of different ownership is dedicated to the well, have the interests of all owners been consolidated by communitization, unitization, force-pooling, etc?

☐ Yes ☐ No If answer is "yes," type of consolidation _____

If answer is "no," list the owners and tract descriptions which have actually been consolidated. (Use reverse side of this form if necessary.) _____

No allowable will be assigned to the well until all interests have been consolidated (by communitization, unitization, forced-pooling, or otherwise) or until a non-standard unit, eliminating such interests, has been approved by the Commission.

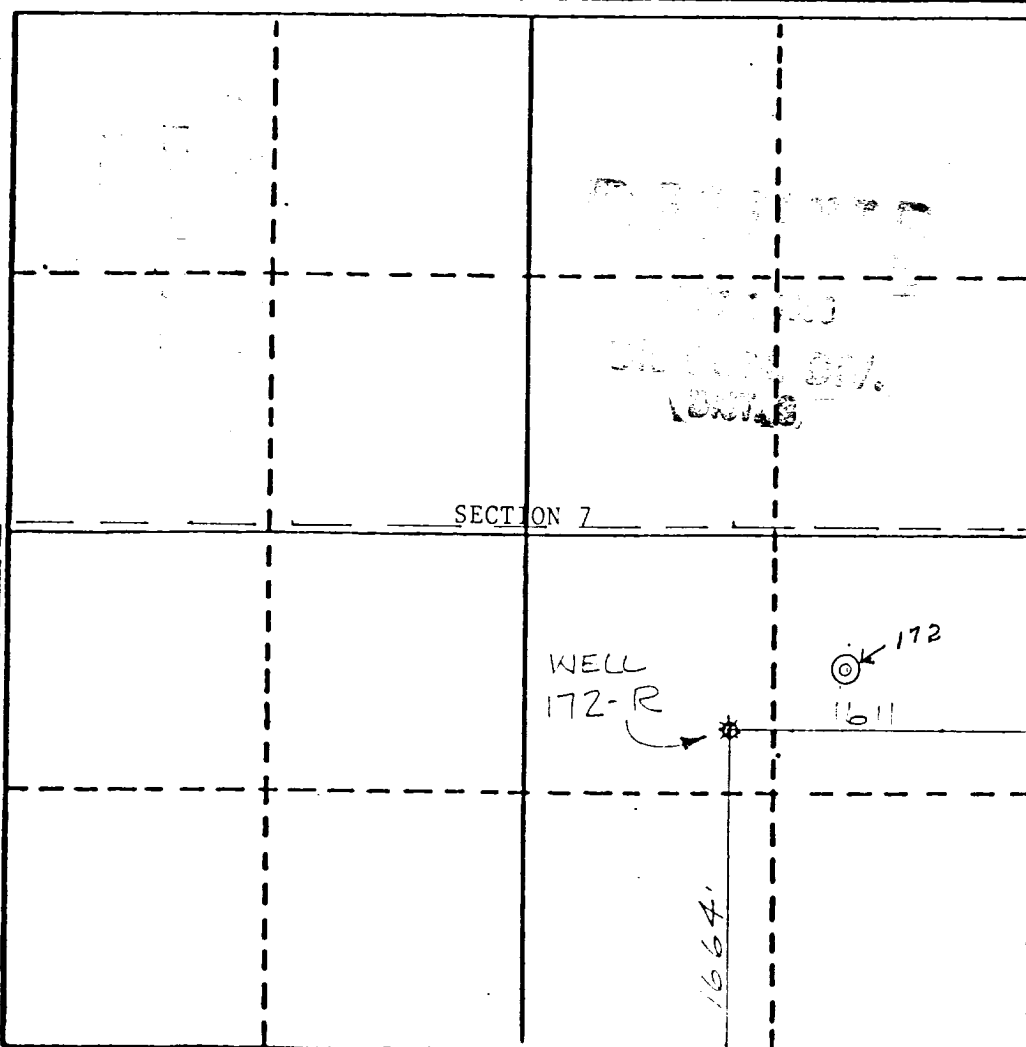

CERTIFICATION

I hereby certify that the information contained herein is true and complete to the best of my knowledge and belief.

Charles E. Verquer

Name

Charles E. Verquer

Position

Superintendent

Company

Caulkins Oil Company

Date

2-24-89

I hereby certify that the well location shown on this plat was plotted from field notes of actual surveys made by me or under my supervision and that the same is true and correct to the best of my knowledge and belief.

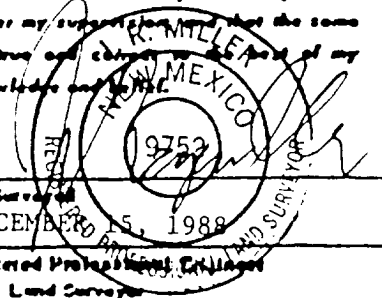

Date Surveyed
DECEMBER 15, 1988

Registered Professional Engineer and/or Land Surveyor

J. ROGER MILLER

Certificate No.
9752



Well - Breech "B" 172-R
1664' F/S and 1611' F/E
Section 7, 26 North 6 West
Rio Arriba County, New Mexico

Scale - 2" = 1 Mile
Access road and location

Pink - ROW from State Road 403
to lease line
Yellow - Well location
Red Cross - Water Haul Route

