

(SUBMIT IN TRIPLICATE)

UNITED STATES
DEPARTMENT OF THE INTERIOR
GEOLOGICAL SURVEY

Budget Bureau No. 42-R359.4
Approval expires 12-31-60.

Indian Agency Hicarilla
Apache
Allottee Contract #96
Lease No. Hicarilla #1

SUNDRY NOTICES AND REPORTS ON WELLS

NOTICE OF INTENTION TO DRILL	<input checked="" type="checkbox"/>	SUBSEQUENT REPORT OF WATER SHUT-OFF	
NOTICE OF INTENTION TO CHANGE PLANS		SUBSEQUENT REPORT OF SHOOTING OR ACIDIZING	
NOTICE OF INTENTION TO TEST WATER SHUT-OFF		SUBSEQUENT REPORT OF ALTERING CASING	
NOTICE OF INTENTION TO REDRILL OR REPAIR WELL		SUBSEQUENT REPORT OF REDRILLING OR REPAIR	
NOTICE OF INTENTION TO SHOOT OR ACIDIZE		SUBSEQUENT REPORT OF ABANDONMENT	
NOTICE OF INTENTION TO PULL OR ALTER CASING		SUPPLEMENTARY WELL HISTORY	
NOTICE OF INTENTION TO ABANDON WELL			

(INDICATE ABOVE BY CHECK MARK NATURE OF REPORT, NOTICE, OR OTHER DATA)

July 14, 1961

Well No. 9 is located 890 ft. from SW line and 1730 ft. from E line of sec. 2
SW 1/4 Sec. 2 26N 3W 104PM
(1/4 Sec. and Sec. No.) (Twp.) (Range) (Meridian)
Gavilan Pictured Cliffs Rio Arriba New Mexico
(Field) (County or Subdivision) (State or Territory)

The elevation of the Grd. level above sea level is 7034 ft.

DETAILS OF WORK

(State names of and expected depths to objective sands; show sizes, weights, and lengths of proposed casing; include mudding jobs, cementing points, and all other important proposed work)

Note: Loc. is in the "Tolerance Zone" (100' W & 100' S) of the Standard 200'x200' area due to the proximity of Tapacito Wash to the standard location. The location as is requested will be approx. 150 SW of the Wash.

1. Drill 10-3/4" hole to 325' & cement 10-3/4" csg. w/+ 125 sac. Circulate cement to surface. W.O.C. for 18 hrs. & press. test csg. w/600 psi for 30 mins.
2. Drill 6-3/4" hole to 3755' T.D.
3. Cement 2-7/8" csg. @ 3730' w/125 sac. Run temp. survey within 24 hrs. W.O.C. for 18 hrs. & press. test csg. w/1500 psi for 30 min.
4. Perf an est. 50' of Pictured Cliffs sand & sd-water frac. w/an est. 1000 gals. treated water & 10000' sd. per foot perf.
5. Clean well up & put on prod.

I understand that this plan of work must receive approval in writing by the Geological Survey before operations may be commenced.

Company Secony Mobil Oil Company, Inc.

Address P. O. Box 3971

Durango, Colorado

By P. M. Barry

Title Dist. Prod. Supt.



NUMBER OF COPIES RECEIVED	
DISTRIBUTION	
SANTA FE	
FILE	
U.S.S.	
LAND OFFICE	
TRANSPORTER	OIL GAS
PRODUCTION OFFICE	
OPERATOR	

NEW MEXICO OIL CONSERVATION COMMISSION
WELL LOCATION AND ACREAGE DEDICATION PLAT
 SEE INSTRUCTIONS FOR COMPLETING THIS FORM ON THE REVERSE SIDE

FORM C-128
 Revised 5/1/57

SECTION A

Operator Socony Mobil Oil Company, Inc.		Lease Jicarilla "H"		Well No. 9	
Unit Letter 0	Section 2	Township 26N	Range 3W	County Rio Arriba	
Actual Footage Location of Well: 890 feet from the South line and 1750 feet from the East line					
Ground Level Elev. 7034'	Producing Formation Pictured Cliffs		Pool Gavilan		Dedicated Acreage: 160 Acres

1. Is the Operator the only owner in the dedicated acreage outlined on the plat below? YES X NO ____ . ("Owner" means the person who has the right to drill into and to produce from any pool and to appropriate the production either for himself or for himself and another. (65-3-29 (a) NMSA 1935 Comp.)
2. If the answer to question one is "no," have the interests of all the owners been consolidated by communitization agreement or otherwise? YES ____ NO ____ . If answer is "yes," Type of Consolidation ____
3. If the answer to question two is "no," list all the owners and their respective interests below:

Owner Socony Mobil Oil Company, Inc.	Land Description SE $\frac{1}{4}$ Sec. 2
---	---

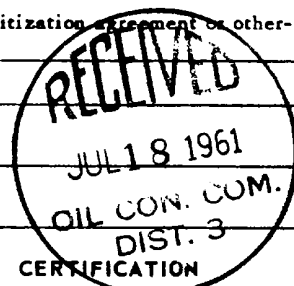

SECTION B

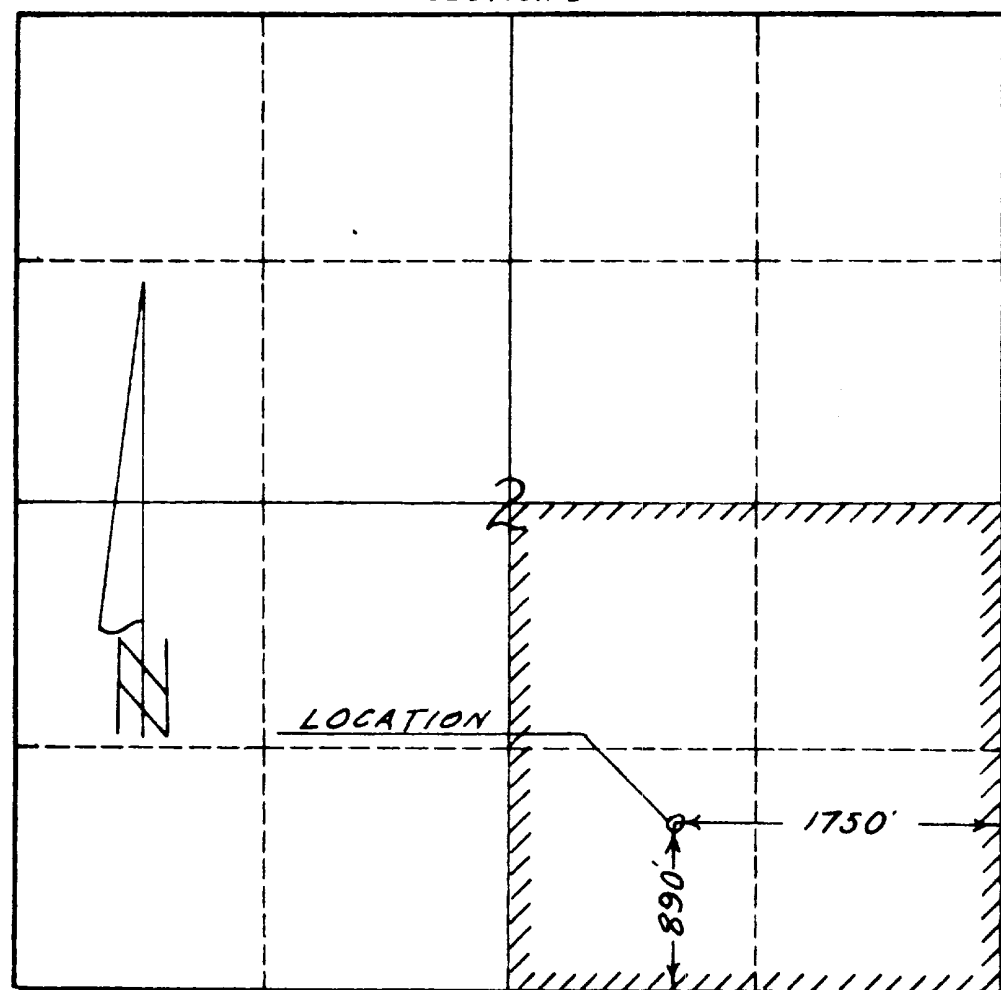

I hereby certify that the information in SECTION A above is true and complete to the best of my knowledge and belief.

Name <i>Am. Barry</i>
Position Dist. Prod. Supt.
Company Socony Mobil Oil Co., Inc.
Date 7/12/61

I hereby certify that the well location shown on the plat in SECTION B was plotted from field notes of actual surveys made by me or under my supervision, and that the same is true and correct to the best of my knowledge and belief.

Date Surveyed 7/11/61
Registered Professional Engineer and/or Land Surveyor

Raymond L. Peterson
 Certificate No. LS 333

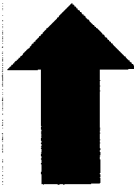

LTR



Job separation sheet

NEW MEXICO OIL CONSERVATION COMMISSION

Form C-122

MULTI-POINT BACK PRESSURE TEST FOR GAS WELLS

Revised 12-1-55

Pool Tapacito Formation Pictured Cliffs County Rio Arriba
Initial _____ Annual _____ Special X Date of Test 10/17/61
Company Secony Mobil Oil Co., Inc. Lease Jicarilla N Well No. 9
Unit 0 Sec. 2 Twp. 26N Rge. 3W Purchaser El Paso Natural Gas Co.
Casing 2-7/8" Wt. 6.5# I.D. 2.441 Set at 3713' Perf. 3591' To 3711'
Tubing _____ Wt. _____ I.D. _____ Set at _____ Perf. _____ To _____
Gas Pay: From 3591' To 3711' L 3641 xG .680 -GL 2476 Bar.Press. 12 psi
Producing Thru: Casing X Tubing _____ Type Well _____
Date of Completion: _____ Packer _____ Single-Bradenhead-G. G. or G.O. Dual
Reservoir Temp. _____

OBSERVED DATA

Tested Through (Prover) (Choke) (Meter)

Type Taps _____

No.	Flow Data					Tubing Data		Casing Data		Duration of Flow Hr.
	(Prover) (Line) Size	(Choke) (Orifice) Size	Press. psig	Diff. h _w	Temp. °F.	Press. psig	Temp. °F.	Press. psig	Temp. °F.	
SI										
1.	2	0.750	72	-	57			934		
2.								72	57	3 hrs.
3.										
4.										
5.										

FLOW CALCULATIONS

No.	Coefficient (24-Hour)	$\sqrt{h_w P_f}$	Pressure psia	Flow Temp. Factor F _t	Gravity Factor F _g	Compress. Factor F _{pv}	Rate of Flow Q-MCFPD @ 15.025 psia
1.	12.3650	-	84	1.0029	.9393	1.011	909
2.							
3.							
4.							
5.							

PRESSURE CALCULATIONS

Gas Liquid Hydrocarbon Ratio _____ cf/bbl.
Gravity of Liquid Hydrocarbons _____ deg.
P_c 5.551 (1-e^{-s}) .165

Specific Gravity Separator Gas .680
Specific Gravity Flowing Fluid _____
P_c 946 P_c² 894.9

No.	P _w P _t (psia)	P _t ²	F _c Q	(F _c Q) ²	(F _c Q) ² (1-e ^{-s})	P _w ²	P _c ² -P _w ²	Cal. P _w	P _w P _c
1.	84	7.06	5.495	30.195	4.982	12.04	882.9		
2.									
3.									
4.									
5.									

Absolute Potential: 1001 MCFPD; n .85COMPANY Secony Mobil Oil Company, Inc.ADDRESS P. O. Box 3371, Durango, ColoradoAGENT and TITLE R. W. Hensley, Prod. Engr.

WITNESSED _____

COMPANY _____

Dist: MOCC 4

EPNG - Galloway 1

" Parrish 1

" Dispth. 1

Fngtn 1

Dgo 1

REMARKS



INSTRUCTIONS

This form is to be used for reporting multi-point back pressure tests on gas wells in the State, except those on which special orders are applicable. Three copies of this form and the back pressure curve shall be filed with the Commission at Box 871, Santa Fe.

The log log paper used for plotting the back pressure curve shall be of at least three inch cycles.

NOMENCLATURE

Q = Actual rate of flow at end of flow period at W. H. working pressure (P_w).
MCF/da. @ 15.025 psia and 60° F.

P_c = 72 hour wellhead shut-in casing (or tubing) pressure whichever is greater.
psia

P_w = Static wellhead working pressure as determined at the end of flow period.
(Casing if flowing thru tubing, tubing if flowing thru casing.) psia

P_t = Flowing wellhead pressure (tubing if flowing through tubing, casing if flowing through casing.) psia

P_f = Meter pressure, psia.

h_w = Differential meter pressure, inches water.

F_g = Gravity correction factor.

F_t = Flowing temperature correction factor.

F_{pv} = Supercompressibility factor.

n = Slope of back pressure curve.

Note: If P_w cannot be taken because of manner of completion or condition of well, then P_w must be calculated by adding the pressure drop due to friction within the flow string to P_t .