

(SUBMIT IN TRIPLICATE)

Land Office **New Mexico**

Lease No. **SF-079395**

Unit **M**

UNITED STATES
DEPARTMENT OF THE INTERIOR
GEOLOGICAL SURVEY

SUNDRY NOTICES AND REPORTS ON WELLS

NOTICE OF INTENTION TO DRILL	X	SUBSEQUENT REPORT OF WATER SHUT-OFF
NOTICE OF INTENTION TO CHANGE PLANS		SUBSEQUENT REPORT OF SHOOTING OR ACIDIZING
NOTICE OF INTENTION TO TEST WATER SHUT-OFF		SUBSEQUENT REPORT OF ALTERING CASING
NOTICE OF INTENTION TO RE-DRILL OR REPAIR WELL		SUBSEQUENT REPORT OF RE-DRILLING OR REPAIR
NOTICE OF INTENTION TO SHOOT OR ACIDIZE		SUBSEQUENT REPORT OF ABANDONMENT
NOTICE OF INTENTION TO PULL OR ALTER CASING		SUPPLEMENTARY WELL HISTORY
NOTICE OF INTENTION TO ABANDON WELL		

(INDICATE ABOVE BY CHECK MARK NATURE OF REPORT, NOTICE, OR OTHER DATA)

January 5 19 59

Federal Elliott

Well No. T 5 is located 660 ft. from N line and 660 ft. from E line of sec. 20

28
(1/4 Sec. and Sec. No.)

25N

(Twp.)

LOW

(Range)

H.M.P.M.

(Meridian)

Bisti Lower Gallup
(Field)

San Juan
(County or Subdivision)

New Mexico
(State or Territory)

The elevation of the derrick floor above sea level is 7 ft.

DETAILS OF WORK

(State names of and expected depths to objective sands; show sizes, weights, and lengths of proposed casings; indicate mudding jobs, cementing points, and all other important proposed work)

We intend to drill a 12 $\frac{1}{4}$ " hole to approximately 250' and set 9 5/8" 32.3 lb. H-40 casing with sufficient cement to circulate allowing 24 hrs. WOC time. An 8 3/4" hole will be drilled to approximately 5400' to test the Lower Gallup and 5 $\frac{1}{2}$ " 14 lb. J-55 casing will be set with 300 sax, allowing 72 hrs. WOC time. All casing jobs will be tested according to regulations.

OPERATIONS BY:
 ✓ ~~LEASING LESSEES~~
 ✓ ~~CO. OF O. ON FILE~~
 ✓ ~~CO. OF O. ATTACHED~~
 ✓ ~~ATTACHED~~
 ✓ ~~FILE~~

I understand that this plan of work must receive approval in writing by the Geological Survey before operations may be commenced.

Company **FRANK O. ELLIOTT & ORA H. HALL, JR.**

Address **Box 703**

Bowell, New Mexico

By

Title	Agent
-------	-------

NEW MEXICO OIL CONSERVATION COMMISSION

Well Location and Acreage Dedication Plat

Section A.

Date _____

Operator Frank Elliott Lease Federal Elliott
Well No. T 5 Unit Letter M Section 28 Township 25 North Range 10 West NMPM
Located 660 Feet From South Line, 660 Feet From West Line
County San Juan G. L. Elevation 6735 Dedicated Acreage 80 Acres
Name of Producing Formation Battle p Pool Bist.

1. Is the Operator the only owner* in the dedicated acreage outlined on the plat below?
Yes X No _____.
2. If the answer to question one is "no," have the interests of all the owners been consolidated by communitization agreement or otherwise? Yes _____ No _____. If answer is "yes,"
Type of Consolidation _____
3. If the answer to question two is "no," list all the owners and their respective interests below:

Owner

Land Description

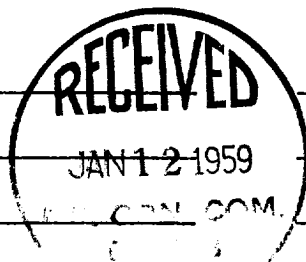

Section. B

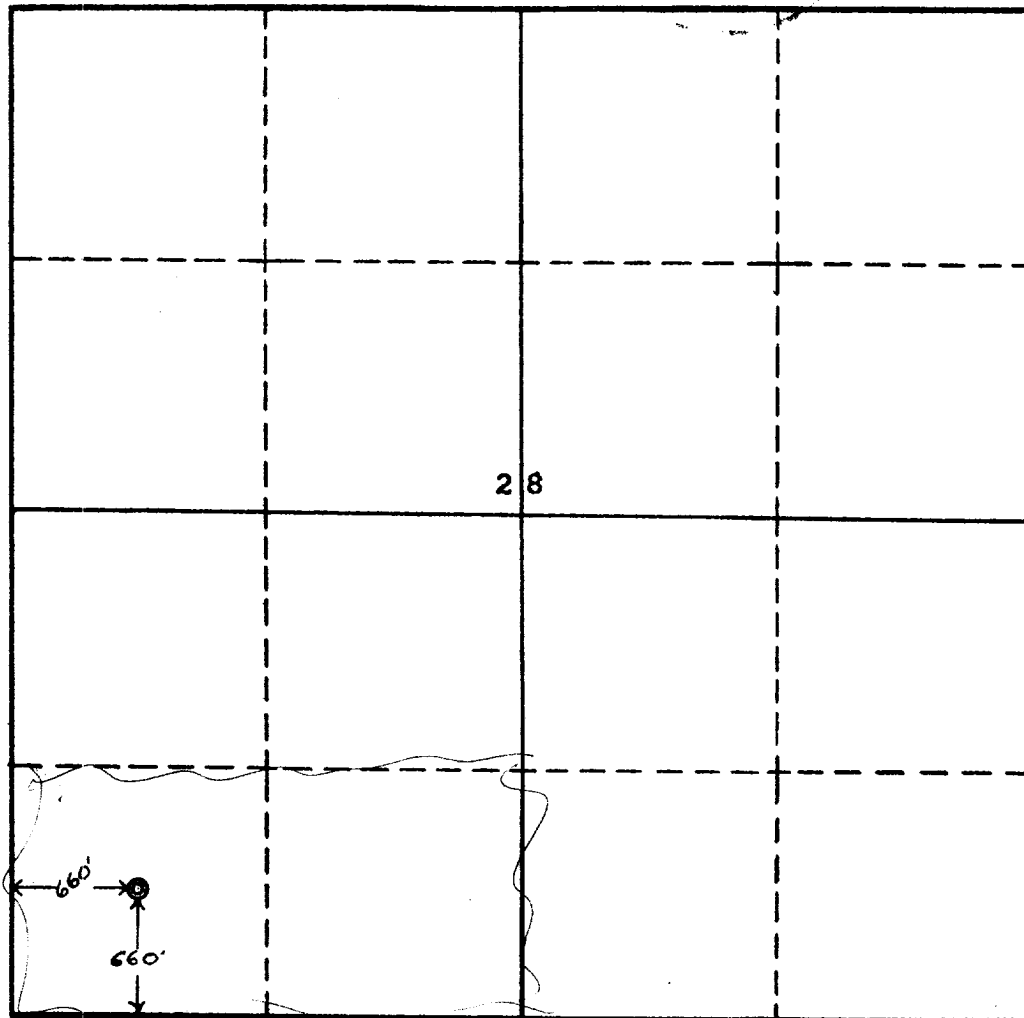

This is to certify that the information in Section A above is true and complete to the best of my knowledge and belief.

(Operator)
Frank Elliott
(Representative)
Box 703 Roswell N. M.
Address

This is to certify that the well location shown on the plat in Section A was plotted from field notes of actual surveys made 1958 or under my supervision and that the same is true and correct to the best of my knowledge and belief.

Date Surveyed Jan. 8, 1959

Ernest V. Echoshawk
Ernest V. Echoshawk
Registered Land Surveyor.

Certificate No. 1545

