

(SUBMIT IN TRIPLICATE)

UNITED STATES  
DEPARTMENT OF THE INTERIOR  
GEOLOGICAL SURVEY

Indian Agency Navajo

Allottee No. 011106

Lease No. 14-20-603-1374

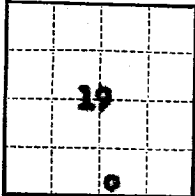

SUNDRY NOTICES AND REPORTS ON WELLS

NOTICE OF INTENTION TO DRILL	<input checked="" type="checkbox"/>	SUBSEQUENT REPORT OF WATER SHUT-OFF	
NOTICE OF INTENTION TO CHANGE PLANS		SUBSEQUENT REPORT OF SHOOTING OR ACIDIZING	
NOTICE OF INTENTION TO TEST WATER SHUT-OFF		SUBSEQUENT REPORT OF ALTERING CASING	
NOTICE OF INTENTION TO REDRILL OR REPAIR WELL		SUBSEQUENT REPORT OF REDRILLING OR REPAIR	
NOTICE OF INTENTION TO SHOOT OR ACIDIZE		SUBSEQUENT REPORT OF ABANDONMENT	
NOTICE OF INTENTION TO PULL OR ALTER CASING		SUPPLEMENTARY WELL HISTORY	
NOTICE OF INTENTION TO ABANDON WELL			

RECEIVED

U. S. GEOLOGICAL SURVEY  
FARMINGTON, NEW MEXICO

(INDICATE ABOVE BY CHECK MARK NATURE OF REPORT, NOTICE, OR OTHER DATA)

Ma-Ga-E December 22, 1952  
Well No. 2 is located 660 ft. from NE line and 1980 ft. from E line of sec. 19  
SE 1/4 Section 19 25 North 10 West N. M. P. M.  
(1/4 Sec. and Sec. No.) (Twp.) (Range) (Meridian)  
Blair San Juan County New Mexico  
(Field) (County or Subdivision) (State or Territory)

RECEIVED  
JAN 7 1952  
OIL CON. COM.  
DIST. 3

The elevation of the derrick floor above sea level is \_\_\_\_\_ ft.

DETAILS OF WORK

(State names of and expected depths to objective sands; show sizes, weights, and lengths of proposed casings; indicate mudding points, and all other important proposed work)

Gallup formation - approximately 5100 feet

8 5/8" Surface casing - approximately 250 feet, and circulate cement.

If commercial production is encountered, run 5 1/2" production string and cement sufficiently, test casing, perforate pay, and treat as necessary.

R. W. S.

I understand that this plan of work must receive approval in writing by the Geological Survey before operations may be commenced.

Company Wellshire Development Company

Address 425 Petroleum Club Bldg.

Denver 2, Colorado

By G. Wallberg

Title General Partner



NEW MEXICO OIL CONSERVATION COMMISSION  
Well Location and Acreage Dedication Plat

Section A.

Date December 22, 1958

Operator Wellshire Development Corporation Lease #2 NTA-BA-EL Sunray-Indcontinent & Sinclair Oil Co.  
Well No. 2 Unit Letter O Section 19 Township 25 North Range 10 West NMPM  
Located 660 Feet From South Line, 1980 Feet From Last Line  
County San Juan G. L. Elevation 6574 Dedicated Acreage 80 Acres  
Name of Producing Formation Gallup Pool B186

1. Is the Operator the only owner\* in the dedicated acreage outlined on the plat below?  
Yes ☒ No ☐.
2. If the answer to question one is "no," have the interests of all the owners been consolidated by communitization agreement or otherwise? Yes ☐ No ☐. If answer is "yes," Type of Consolidation \_\_\_\_\_
3. If the answer to question two is "no," list all the owners and their respective interests below:

Owner

Land Description

Wellshire Development Co.

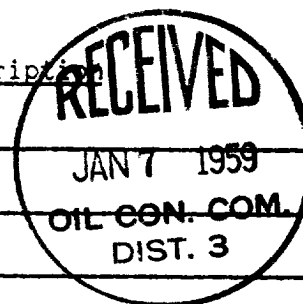

Section B

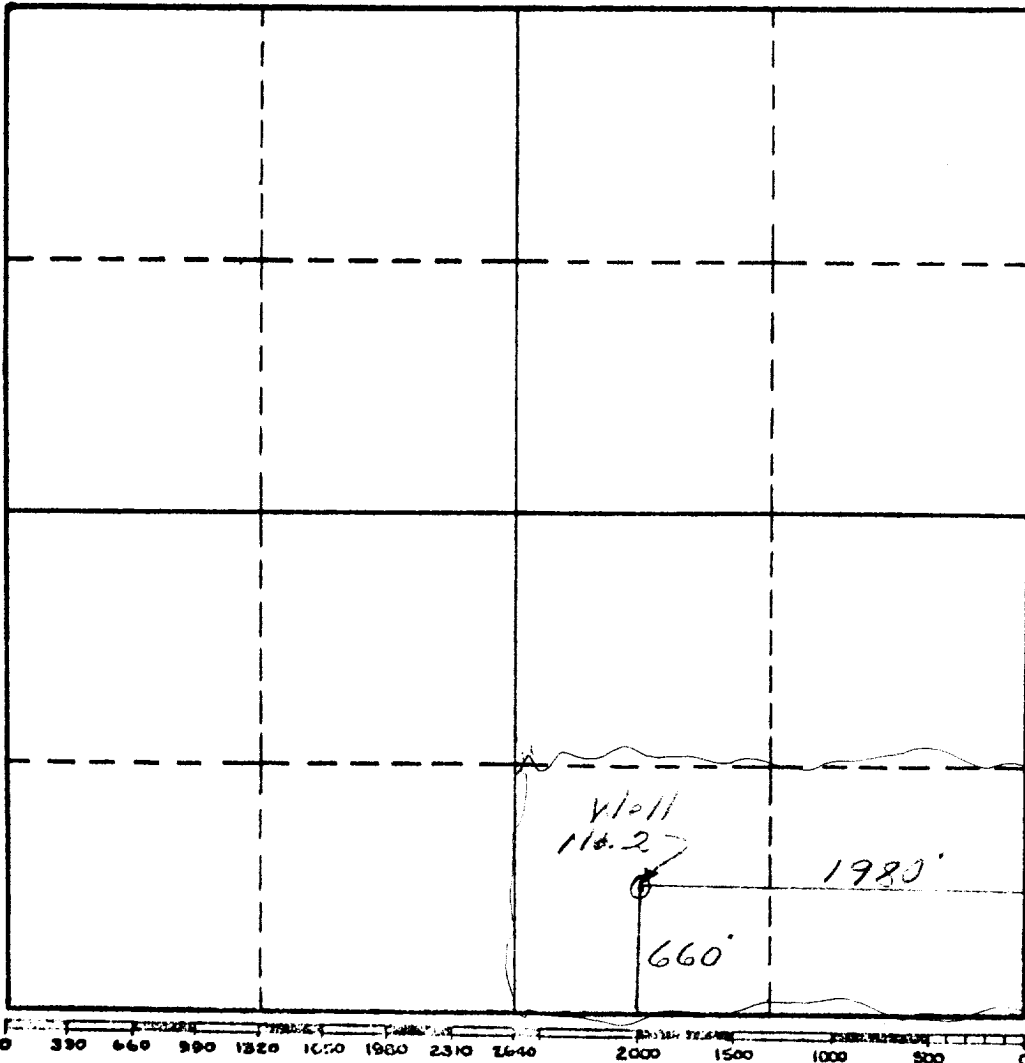

This is to certify that the information in Section A above is true and complete to the best of my knowledge and belief.

Wellshire Development Co.  
(Operator)

R. H. Long  
(Representative)

435 Petro Club Bldg.  
Address

Danver -

This is to certify that the well location shown on the plat in Section B was plotted from field notes of actual surveys made by me or under my supervision and that the same is true and correct to the best of my knowledge and belief.

Date Surveyed Dec. 20, 1958

C. L. Pott  
Registered Professional  
Engineer and/or Land Surveyor.

Certificate No. 704