

Form 9-331a  
(Feb. 1951)

(SUBMIT IN TRIPLICATE)

UNITED STATES  
DEPARTMENT OF THE INTERIOR  
GEOLOGICAL SURVEY

Land Office Santa Fe

Lease No. 27 076079

Unit \_\_\_\_\_

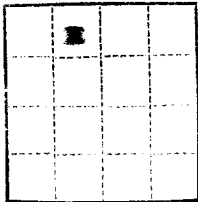

SUNDRY NOTICES AND REPORTS ON WELLS

NOTICE OF INTENTION TO DRILL	<input checked="" type="checkbox"/>	SUBSEQUENT REPORT OF WATER SHUT-OFF	
NOTICE OF INTENTION TO CHANGE PLANS		SUBSEQUENT REPORT OF SHOOTING OR ACIDIZING	
NOTICE OF INTENTION TO TEST WATER SHUT-OFF		SUBSEQUENT REPORT OF ALTERING CASING	
NOTICE OF INTENTION TO RE-DRILL OR REPAIR WELL		SUBSEQUENT REPORT OF RE-DRILLING OR REPAIR	
NOTICE OF INTENTION TO SHOOT OR ACIDIZE		SUBSEQUENT REPORT OF ABANDONMENT	
NOTICE OF INTENTION TO PULL OR ALTER CASING		SUPPLEMENTARY WELL HISTORY	
NOTICE OF INTENTION TO ABANDON WELL			

(INDICATE ABOVE BY CHECK MARK NATURE OF REPORT, NOTICE, OR OTHER DATA)

December 4, 1956

**Hannett-Federal**

Well No. 1 is located 790 ft. from N line and 1890 ft. from W line of sec. 24

22 1/4 (Twp.) 24 (Range) 6-2 (Meridian)

Robert P.C. W.C. (Field) San Juan (County or Subdivision) New Mexico (State or Territory)

The elevation of the derrick floor above sea level is 6979.68 ft. S.L.

DETAILS OF WORK

(State names of and expected depths to objective sands; show sizes, weights, and lengths of proposed casings; indicate mudlogging jobs, cementing points, and all other important proposed work)

Plan to drill and complete in the Pictured Cliffs formation.  
Will set 100' 6 1/8" casing with 100 sacks cement; set 5 1/2" 15.5# J-55 new casing at expected TD of 2500' and cement with 100 sacks cement. Perforate 5 1/2" casing and fracture treat formation with 40,000 gallons of water mixed 1 1/2 pounds of sand to the gallon. Reported top of Pictured Cliffs 2200'.

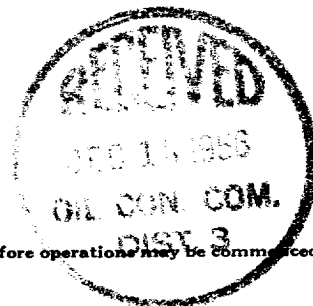

I understand that this plan of work must receive approval in writing by the Geological Survey before operations may be commenced.

Company WESTERN NATURAL GAS COMPANY

Address 823 Midland Tower

Midland, Texas

By

Title

Office Manager

DECEMBER 3, 1956

WESTERN NATURAL GAS CO., ETAL

A.T. HANNETT FEDERAL

SF 078479

1

24

25 N

8 W

790

NORTH

1850

WEST

SAN JUAN

6579.68

PICTURED CLIFF

WILDCAT

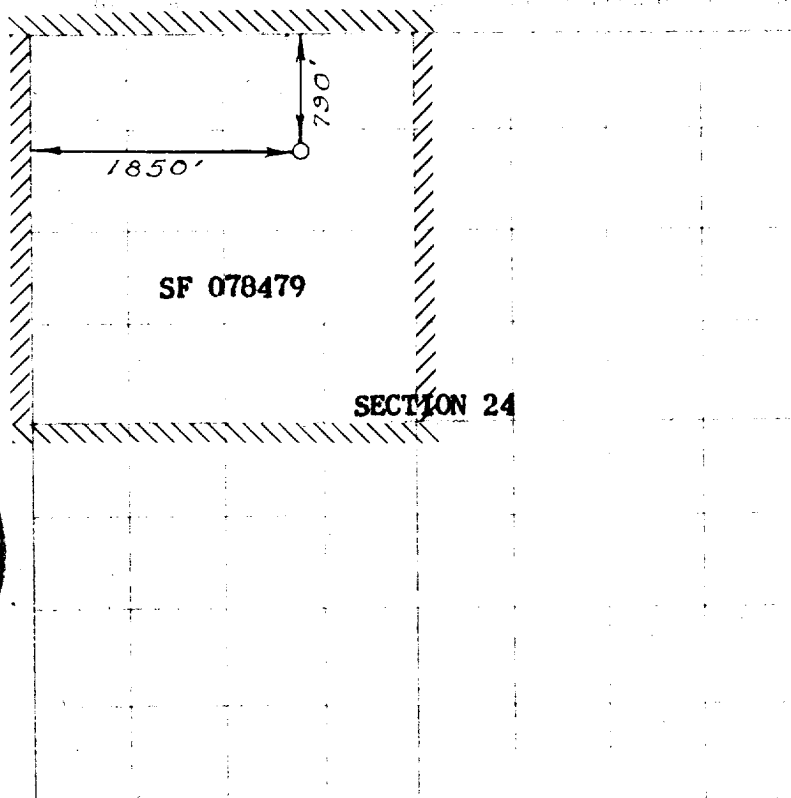
160 AC.  
(1882 PLAT)

RECEIVED  
DEC 13 1956  
U. S. GEOLOGICAL SURVEY  
FARMINGTON, NEW MEXICO

RECEIVED  
DEC 13 1956  
OIL CON. COM.  
DIST. 3

## NOTE

This section of  
terms to be used  
for this plat only

I, the undersigned, do hereby certify that the above plat is a true and correct  
field copy of actual survey made by me or under my direct  
supervision and that the same are true and correct to the  
best of my knowledge and belief.

Date Surveyed **NOVEMBER 24, 1956**

*E. O. Walker*  
Registered Professional Engineer and of Land Surveyor

1. Is this well a Ditch Connection?  
Yes ☐ No ☒
  2. If the answer to question 1  
is yes, are there any other ditches  
except for wells within one  
dedicated acreage?  
Yes ☐ No ☒
- Name \_\_\_\_\_  
Position \_\_\_\_\_  
Representing \_\_\_\_\_  
Address \_\_\_\_\_