



COPY TO O.G.C.

IN REPLY REFER TO:

UNITED STATES
DEPARTMENT OF THE INTERIOR
GEOLOGICAL SURVEY
P. O. Box 965
Farmington, New Mexico

September 23, 1955

Frank A. Schultz, Jr.
Box 72A
Farmington, New Mexico

Re: Santa Fe 078524

Gentlemen:

Receipt is acknowledged of your "Notice of Intention to Drill" dated September 23, 1955 covering your well No. 3-14 Schultz-Payne in SE¹ sec. 14, T. 25 N., R. 8 W., N. M. P. M., San Juan County, New Mexico, Ballard-Pictured Cliffs pool. *elyt*

Your proposed work is hereby approved subject to compliance with the provisions of the "Oil and Gas Operating Regulations" revised May 25, 1942, a copy of which will be sent to you on request, and subject to the following conditions:

1. Drilling operations so authorized are subject to the attached sheet for general conditions of approval.
2. Furnish copies of all logs.

Very truly yours,

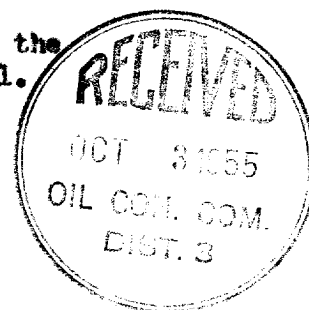

Jerry W. Long
Acting District Engineer

JWLong:ac

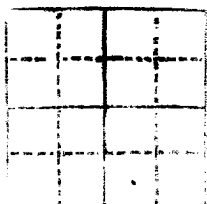

UNITED STATES
DEPARTMENT OF THE INTERIOR
GEOLOGICAL SURVEY



11

(SUBMIT IN TRIPLICATE)

UNITED STATES
DEPARTMENT OF THE INTERIOR
GEOLOGICAL SURVEY

Land Office Santa Fe

Lease No. 078524

Unit SE/4

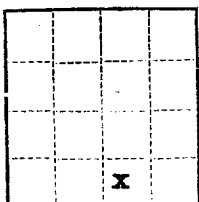

SUNDRY NOTICES AND REPORTS ON WELLS

NOTICE OF INTENTION TO DRILL	<input checked="" type="checkbox"/>	SUBSEQUENT REPORT OF WATER SHUT-OFF	
NOTICE OF INTENTION TO CHANGE PLANS		SUBSEQUENT REPORT OF SHOOTING OR ACIDIZING	
NOTICE OF INTENTION TO TEST WATER SHUT-OFF		SUBSEQUENT REPORT OF ALTERING CASING	
NOTICE OF INTENTION TO RE-DRILL OR REPAIR WELL		SUBSEQUENT REPORT OF RE-DRILLING OR REPAIR	
NOTICE OF INTENTION TO SHOOT OR ACIDIZE		SUBSEQUENT REPORT OF ABANDONMENT	
NOTICE OF INTENTION TO PULL OR ALTER CASING		SUPPLEMENTARY WELL HISTORY	
NOTICE OF INTENTION TO ABANDON WELL			

(INDICATE ABOVE BY CHECK MARK NATURE OF REPORT, NOTICE, OR OTHER DATA)

September 23, 1955

Schultz-Payne
Well No. 3-14 is located 840 ft. from ☒ line and 1760 ft. from ☒ line of sec. 14

SE/4 Sec. 14 T 25-N R 8-W N.M.P.M.
(1/4 Sec. and Sec. No.) (Twp.) (Range) (Meridian)

Ballard Picturec Cliffs San Juan County New Mexico
(Field) (County or Subdivision) (State or Territory)

The elevation of the derrick floor above sea level is _____ ft. To be furnished

DETAILS OF WORK

(State names of and expected depths to objective sands; show sizes, weights, and lengths of proposed casings; indicate mudding jobs, cementing points, and all other important proposed work)

Purpose to spud with cable tools; then drill with rotary tools to the top of the Pictured Cliffs formation - expected between 1,900 feet and 2,200 feet below surface. Completion with cable tools - and sand oil fracturing or shooting with solidified nitro glycerin as conditions warrant.

Casing program: 90 feet of 8-5/8" new 8 rd. thd. 24# casing. Circulate cement to surface, using at least 75 sacks of cement.

5-1/2" OD 14# J-55 seamless casing to be set on top of Pictured Cliffs formation, cemented with 100 sacks regular cement.

1" tubing to be set within 20 feet of total depth for production.

I understand that this plan of work must receive approval in writing by the Geological Survey before operations may be commenced.

Company Frank A. Schultz, Jr.

Address Box 728

Farmington, New Mexico

By

Title C. Beeson Neal, Agent in Farmington

Company FRANK A. SHULTZ, JR.

Lease..... Well No. 3-14 PAYNE

Sec. 14, T. 25 N., R. 8 W., N.M.P.M.

Location 840' FROM THE SOUTH LINE AND 1760' FROM THE EAST LINE.

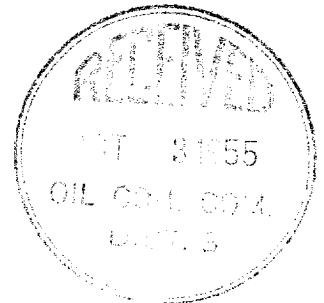
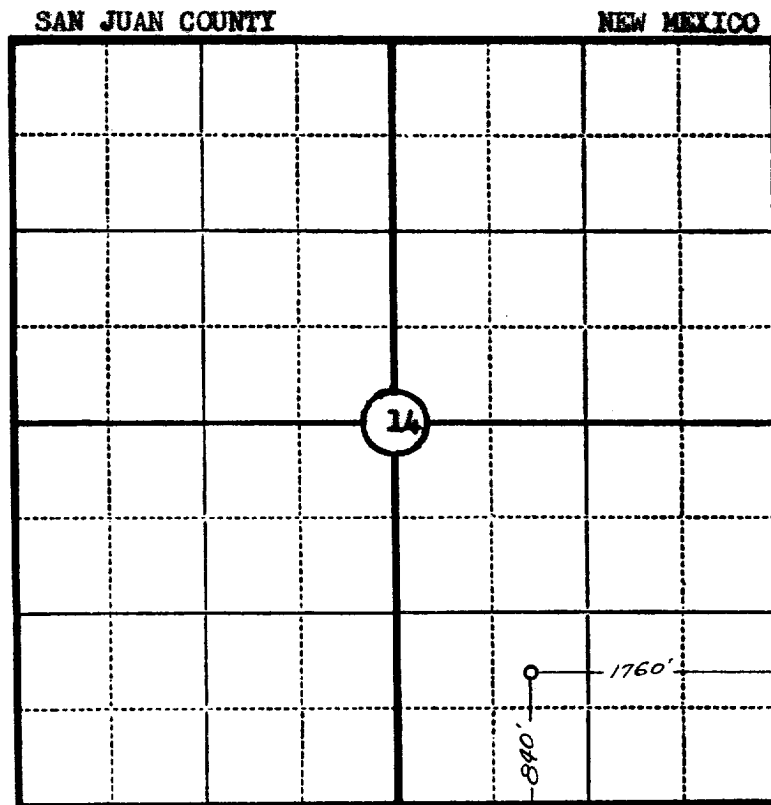

Scale—4 inches equal 1 mile.

This is to certify that the above plat was prepared from field notes of actual surveys made by me or under my supervision and that the same are true and correct to the best of my knowledge and belief.

Seal:

James P. Leese
Registered Land Surveyor.

James P. Leese
N. Mex. Reg. No. 1463

Surveyed 24 July, 1955

SAN JUAN ENGINEERING CO.
P. O. Box 752
FARMINGTON, N. M.