

APPROVED

(SUBMIT IN TRIPLICATE)

Indian Agency _____

WILSON 1001

Allotted **JANUARY ALLOTTED**Lease No. **14-20-603-325**UNITED STATES
DEPARTMENT OF THE INTERIOR
GEOLOGICAL SURVEY

SUNDRY NOTICES AND REPORTS ON WELLS

NOTICE OF INTENTION TO DRILL	<input checked="" type="checkbox"/>	SUBSEQUENT REPORT OF WATER SHUT-OFF	
NOTICE OF INTENTION TO CHANGE PLANS		SUBSEQUENT REPORT OF SHOOTING OR ACIDIZING	
NOTICE OF INTENTION TO TEST WATER SHUT-OFF		SUBSEQUENT REPORT OF ALTERING CASING	
NOTICE OF INTENTION TO REDRILL OR REPAIR WELL		SUBSEQUENT REPORT OF REDRILLING OR REPAIR	
NOTICE OF INTENTION TO SHOOT OR ACIDIZE		SUBSEQUENT REPORT OF ABANDONMENT	
NOTICE OF INTENTION TO PULL OR ALTER CASING		SUPPLEMENTARY WELL HISTORY	
NOTICE OF INTENTION TO ABANDON WELL			

(INDICATE ABOVE BY CHECK MARK NATURE OF REPORT, NOTICE, OR OTHER DATA)

August 22, 1959

Well No. **CU 29** is located **1900** ft. from **N** line and **500** ft. from **E** line of sec. **8**

NE 1/4 of SE 1/4 (1/4 Sec. and Sec. No.)	23N (Twp.)	12W (Range)	P.M.P.M. (Meridian)
BISTI LOWER GALLUP (Field)	SAN JUAN (County or Subdivision)	NEW MEXICO (State or Territory)	

The elevation of the ~~derrick floor~~ ^{ground level} above sea level is **6215** ft.

DETAILS OF WORK

(State names of and expected depths to objective sands; show sizes, weights, and lengths of proposed casings; indicate mudding jobs, cementing points, and all other important proposed work)

WE PROPOSE TO DRILL A 4 1/2" ROTARY TEST OF THE GALLUP SAND
WE PROPOSE TO DRILL A 12-1/4" HOLE TO APPROXIMATE LY 300' AND TO SET
8-9/8" 24 CTS. AND CINC CEMENT TO THE SURFACE
WE PROPOSE TO DRILL A 7-7/8" HOLE TO APPROX 4950' AND TO SET 4-1/2"
CASING ON BOTTOM AND TO USE SUFFICIENT CEMENT TO PLAC THE TOP 300' ABOVE
THE PAY ZONE. THE CASING WILL BE PERFORATED AND THE FORMATION STIMULATED
AS NECESSARY FOR COMMERCIAL PRODUCTION.

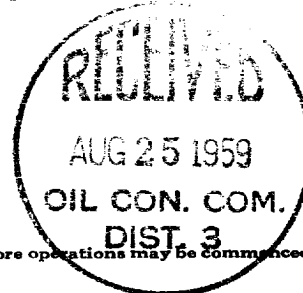

I understand that this plan of work must receive approval in writing by the Geological Survey before operations may be commenced.

Company **SUNRAY MID CONTINENT OIL COMPANY**Address **ROOM 166****PETROLEUM CENTER BUILDING****FARMINGTON, NEW MEXICO**By **E. H. RAGNEY**
DISTRICT MANAGER

Title _____

NEW MEXICO OIL CONSERVATION COMMISSION
WELL LOCATION AND ACREAGE DEDICATION PLAT

FORM C-128
 Revised 5/1/57

SEE INSTRUCTIONS FOR COMPLETING THIS FORM ON THE REVERSE SIDE

SECTION A

Operator SUNRAY MID-CONTINENT OIL CO.		Lease CENTRAL BISTI UNIT		Well No. 29
Unit Letter I	Section 6	Township 25 NORTH	Range 12 WEST	County SAN JUAN
Actual Footage Location of Well: 660 feet from the EAST line and 1980 feet from the SOUTH line				
Ground Level Elev. 6216.0	Producing Formation LOWER GALLUP SAND	Pool BISTI	Dedicated Acreage: 80 <i>JOINT</i> Acres	

1. Is the Operator the only owner in the dedicated acreage outlined on the plat below? YES _____ NO **X** . ("Owner" means the person who has the right to drill into and to produce from any pool and to appropriate the production either for himself or for himself and another. (65-3-29 (e) NMSA 1935 Comp.)
2. If the answer to question one is "no," have the interests of all the owners been consolidated by communication agreement or otherwise? YES **X** NO ____ . If answer is "yes," Type of Consolidation **UNITIZATION**
3. If the answer to question two is "no," list all the owners and their respective interests below:

Owner	Land Description



SECTION B

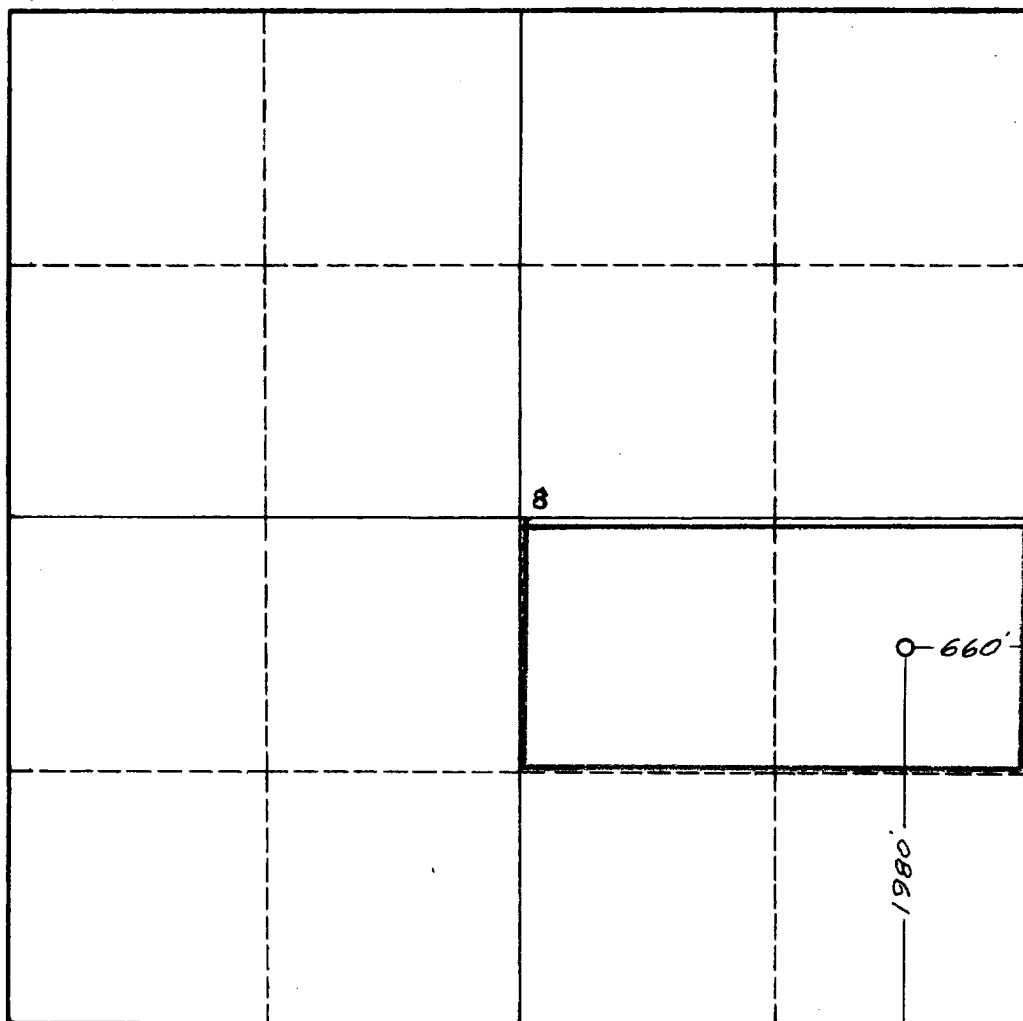

I hereby certify that the information in SECTION A above is true and complete to the best of my knowledge and belief.

E. H. RAMSEY

Name

DISTRICT MANAGER

Position

SUNRAY MID CONTINENT

Company

August 22, 1959

Date

I hereby certify that the well location shown on the plat in SECTION B was plotted from field notes of actual surveys made by me or under my supervision, and that the same is true and correct to the best of my knowledge and belief.

Date Surveyed

July 20, 1959

Registered Professional Engineer and/or Land Surveyor

James P. Leese
JAMES P. LEESE

Certificate No.

1463

0 330 660 990 1320 1650 1980 2310 2640 2000 1500 1000 500 0

INSTRUCTIONS FOR COMPLETION OF FORM C-128

1. Operator shall furnish and certify to the information called for in Section A.
2. Operator shall outline the dedicated acreage for *both* oil and gas wells on the plat in Section B.
3. A registered professional engineer or land surveyor registered in the State of New Mexico or approved by the Commission shall show on the plat the location of the well and certify this information in the space provided.
4. All distances shown on the plat must be from the outer boundaries of the Section.
5. If additional space is needed for listing owners and their respective interests as required in question 3 of Section A, please use space below.