

## NEW MEXICO OIL CONSERVATION COMMISSION

## Well Location and Acreage Dedication Plat

Section A.

Date

Operator **SHELL OIL COMPANY** Lease **Gov't L. M. Phillips #2 NW 036254**  
 Well No. **41-9** Unit Letter **A** Section **9** Township **25 NORTH** Range **12 WEST** NMPM  
 Located **660'** Feet From **THE NORTH** Line, **660'** Feet From **THE EAST** Line  
 County **SAN JUAN** G. L. Elevation **6189.57** Dedicated Acreage **80** Acres  
 Name of Producing Formation **Gallup** Pool **Bisti**

1. Is the Operator the only owner in the dedicated acreage outlined on the plat below?

Yes ☒ No

2. If the answer to question one is "no", have the interests of all the owners been consolidated by communitization agreement or otherwise? Yes No If answer is "yes", Type of Consolidation.

3. If the answer to question two is "no", list all the owners and their respective interests below:

Owner

Land Description



Section B.

Note: All distances must be from outer boundaries of Section.

This is to certify that the information  
 in Section A above is true and complete  
 to the best of my knowledge and belief.

**Shell Oil Company**

(Operator)

(Representative)

**705 West Municipal Drive**

(Address)

**Farmington, New Mexico**

**TBM Iron pin 450' S 28° W of**  
**Location: 6199.77**

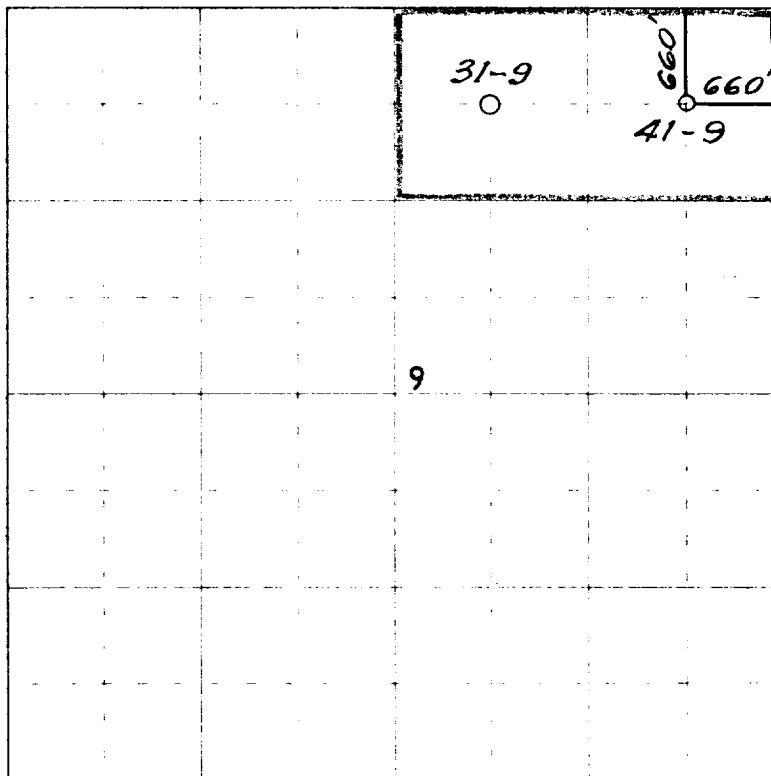

0 330 660 990 1320 1650 1980 2310 2640 2000 1500 1000 500 0

Scale 4 inches equal 1 mile

This is to certify that the above plat was prepared from field notes of actual surveys  
 made by me or under my supervision and that the same are true and correct to the best  
 of my knowledge and belief.

Date Surveyed **16 May 1957**

*James P. Leese*  
 Registered Professional Engineer and/or Land Surveyor  
**James P. Leese N. Mex. Reg. No. 1463**  
**720-472-1**

Farmington, New Mexico

OIL CONSERVATION COMMISSION		
AZTEC DISTRICT OFFICE		
No. C-1000-1001	✓	
Open	✓	
Santa Fe	✓	
Proctor	✓	
St. Louis	✓	
U.S. 100	✓	
Yreka	✓	
File	✓	✓