

(SUBMIT IN TRIPLICATE)

 UNITED STATES  
DEPARTMENT OF THE INTERIOR  
GEOLOGICAL SURVEY
Land Office Santa Fe, N.M.Lease No. 079207Unit W4 22-24-7N

## SUNDRY NOTICES AND REPORTS ON WELLS

NOTICE OF INTENTION TO DRILL	<input checked="" type="checkbox"/>	SUBSEQUENT REPORT OF WATER SHUT-OFF	
NOTICE OF INTENTION TO CHANGE PLANS		SUBSEQUENT REPORT OF SHOOTING OR ACIDIZING	
NOTICE OF INTENTION TO TEST WATER SHUT-OFF		SUBSEQUENT REPORT OF ALTERING CASING	
NOTICE OF INTENTION TO RE-DRILL OR REPAIR WELL		SUBSEQUENT REPORT OF REDRILLING OR REPAIR	
NOTICE OF INTENTION TO SHOOT OR ACIDIZE		SUBSEQUENT REPORT OF ABANDONMENT	
NOTICE OF INTENTION TO PULL OR ALTER CASING		SUPPLEMENTARY WELL HISTORY	
NOTICE OF INTENTION TO ABANDON WELL			

(INDICATE ABOVE BY CHECK MARK NATURE OF REPORT, NOTICE, OR OTHER DATA)

October 24, 1952

Well No. 1 is located 990 ft. from N line and 1650 ft. from E line of sec. 22

W4 Section 22 26N 7W R.M.P.M.

(1/4 Sec. and Sec. No.) (Twp.) (Range) (Meridian)

Rio Arriba New Mexico

(Field) (County or Subdivision) (State or Territory)

The elevation of the derrick floor above sea level is 6161.5 ft.

## DETAILS OF WORK

(State names of and expected depths to objective sands; show sizes, weights, and lengths of proposed casings; indicate mudding jobs, cementing points, and all other important proposed work)

Drill a Pictured Cliffs well, to commence in the near future; to set approximately 100 ft. of 10-3/4 in. 32.75 lb. surface casing, cement with approximately 75 sacks of cement, circulate to surface, and test for shut-off; to drill to approximately 2150 ft. and set 7 in. O.D. 20 lb. casing, cement with approximately 125 sacks cement, and test for water shut-off; to drill with cable tools to depth of approximately 2230 ft., testing gas string for water shut-off, shooting with approximately 4 quarts per foot, and completing.

I understand that this plan of work must receive approval in writing by the Geological Survey before operations may be commenced.

Company National Cooperative Refinery AssociationAddress 620 Union National Bank BuildingWichita 2, KansasBy Barton O. HollettTitle Manager, Development & Exploration

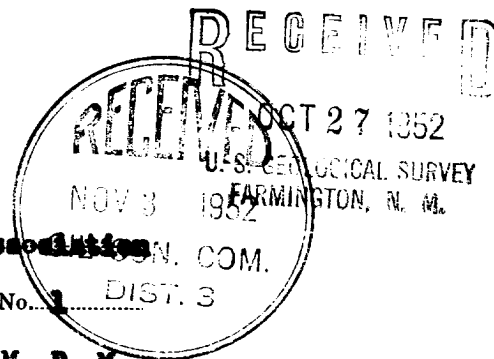

Company National Cooperative Refinery Association

Lease Loyd Miles Well No. 1

Sec. 22, T. 26 N, R. 7 W N. M. P. M.

Location 990' from the North line and 1650' from the West line.

Elevation 6154.5 Ungraded ground- Sea Level Datum

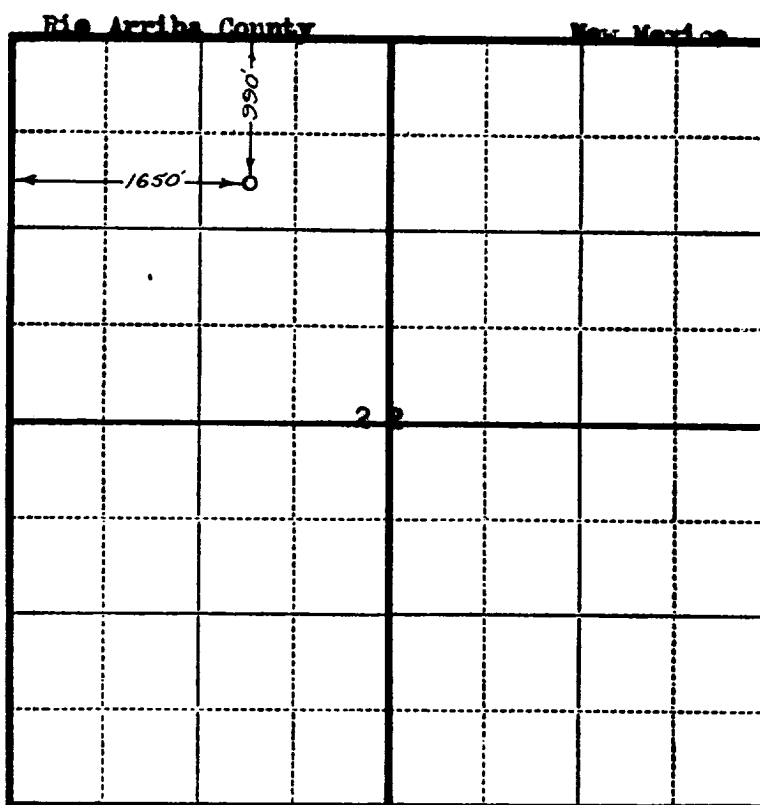

Scale—4 inches equal 1 mile.

This is to certify that the above plat was prepared from field notes of actual surveys made by me or under my supervision and that the same are true and correct to the best of my knowledge and belief.

Seal:

*James P. Leese*  
Registered Professional  
Engineer and Land Surveyor.

James P. Leese  
N. Mex. Reg. No. 1463

Surveyed 9 October, 1952