

PROPOSED CHOKE MANIFOLD
(MINIMUM REQUIREMENTS)
8 5/8 " CASING STRING

2" Adjustable Choke

To Separator

3,000 psi gage

2" Cross

To Blue Line

To Valve on
Drilling Spool

All Valves- " - 2,000 psi WP

AUG 11 1975

U. S. GEOLOGICAL SURVEY

2" Positive Choke

To Separator

MOBIL OIL CORPORATION

WELL NAME & NO. Jicarilla "G" #11

COUNTY & STATE: Rio Arriba, New Mexico

PROPOSED BOP STACK
8 5/8 " CASING

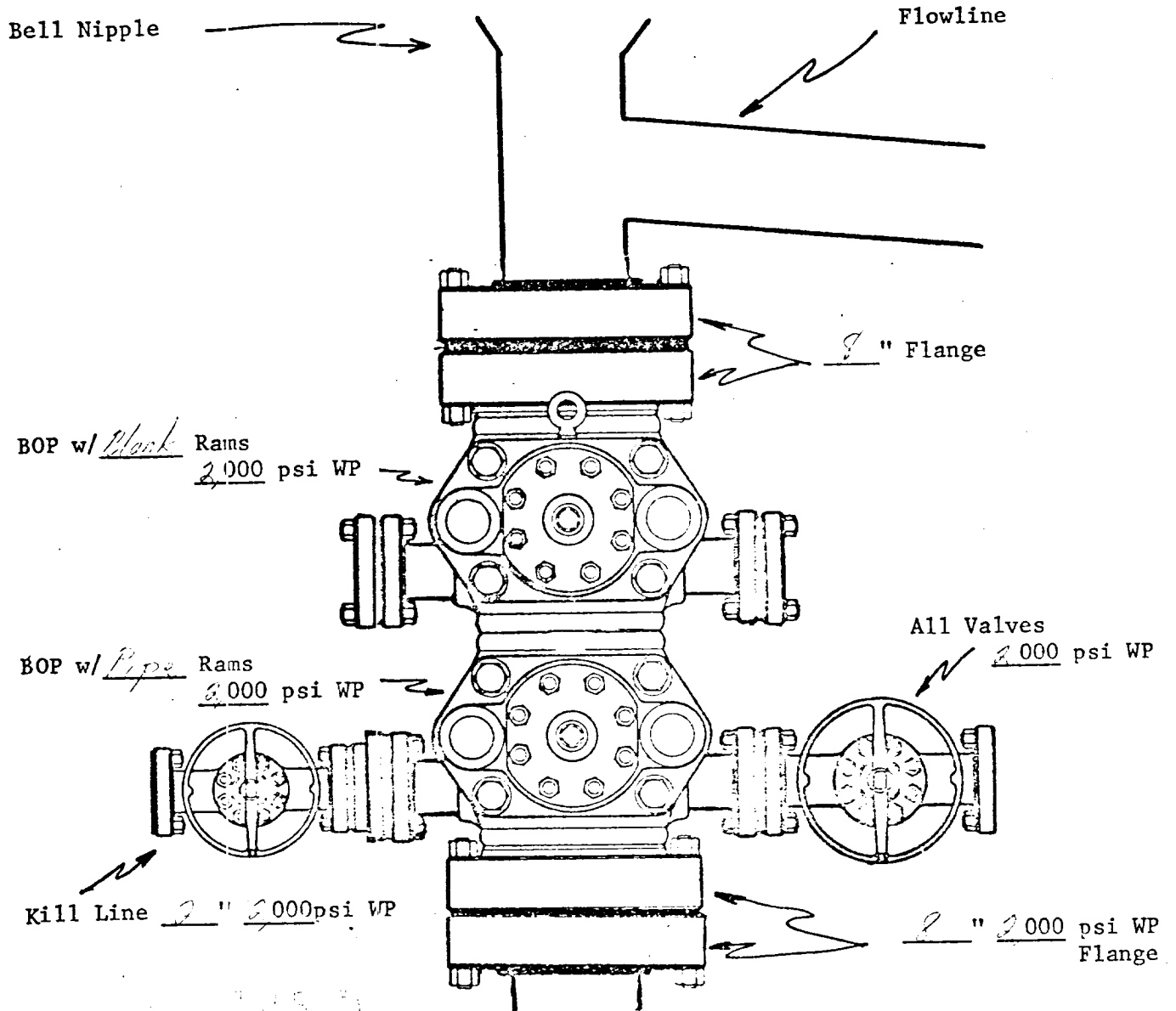

MAR 11 1975
 U. S. GEOLOGICAL SURVEY

MOBIL OIL CORPORATION
 WELL NAME & NO. Jicarilla "G" #11
 COUNTY & STATE: Rio Arriba, New Mexico

PROPOSED MUD PROGRAM
FOR
MOBIL OIL CORPORATION'S
JICARILLA "G" WELL NO. 11
BLANCO MESAVERDE & GAVLIN PICTURED CLIFFS
GAS POOLS
RIO ARriba COUNTY, NEW MEXICO

<u>DEPTH, FT.</u>		<u>TYPE MUD</u>	<u>WEIGHT</u>	<u>VISCOSITY</u>	<u>PH</u>	<u>WATER LOSS</u>
<u>FROM</u>	<u>TO</u>					
0	300	Spud Mud	- No Control -			
300	T.D.	Fresh water with low solids gel as necessary	- No Control -			

APR 11 1975
U.S. GEOLOGICAL SURVEY

MOBIL OIL CORPORATION
P. O. Box 633
Midland, Texas 79701

TWELVE-POINT SURFACE USE PLAN FOR
DRILLING OPERATIONS ON FEDERAL LEASES

Lease Name: Jicarilla "G" Well No. 11
Well Location: 990' FNL & 990' FWL, Sec. 36, T-27-N, R-3-W
Field: Blanco Mesaverde
County: Rio Arriba State: New Mexico

1. * Existing roads including location of the exit from the main highway.
2. * Planned access roads.
3. * Location of wells.
4. * Lateral roads to well location.
5. * Location of tank batteries and flow lines.
6. Location and types of water supply: Water will be trucked to well site.
7. Methods for handling waste disposal: Waste will be burned, buried and/or hauled from the well site.
8. Location of camps: None
9. Location of air strips: None
10. Location layout to include position or rig, mud tanks, reserve pits, burn pits, pipe racks, etc.: See attached diagram of proposed layout
11. Plans for restoration of the surface: Pits will be backfilled and levelled to original grade and left for return of natural vegetation. The pad will be left in place for well servicing.
12. Any other information that may be used in evaluating the impact on environment: Location site falls on the east slope of a timbered ridge consisting of pine and pinon trees.

FILE

AUG 11 1975

U. S. GEOLOGICAL SURVEY

* Shown on attached map.



RESERVE PIT LOCATION

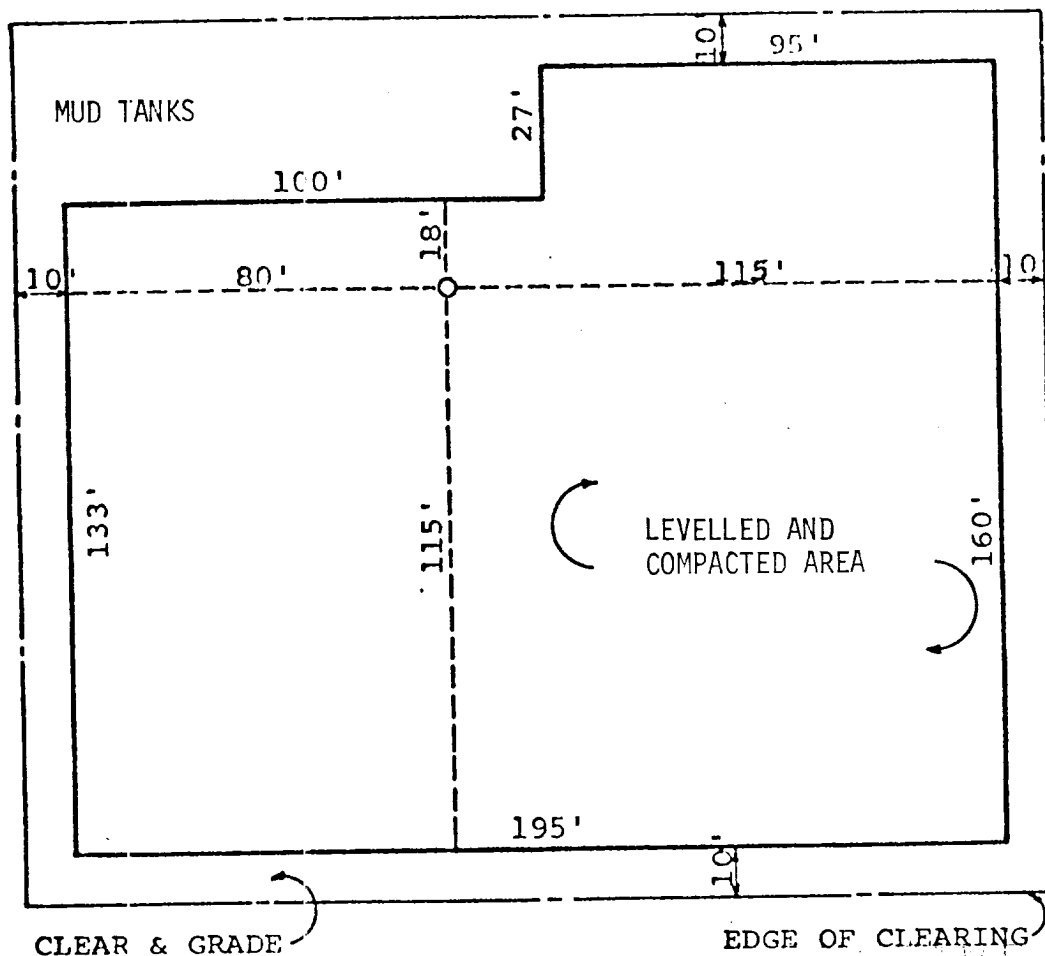

CLEAR & GRADE

EDGE OF CLEARING

JICARILLA "G" WELL NO. 11
990' FNL & 990' FWL, Sec. 36,
T-27-N, R-3-W, Rio Arriba Co.,
New Mexico

U. S. GEOLOGICAL SURVEY

NO.	DATE	BY	ALTERATION
STANDARD LOCATION PLAN 5000'-7000' DEEP WELLS ON STABLE SOIL			
MOBIL OIL CORPORATION MIDLAND, TEXAS			
DRAWN DLT	SCALE 1" = 40'	DATE 9-14-66	DWG. NO. A-322
CHECKED			

**NEW MEXICO OIL CONSERVATION COMMISSION
WELL LOCATION AND ACREAGE DEDICATION PLAT**

Form C-102
Supersedes C-128
Effective 1-1-65

All distances must be from the outer boundaries of the Section.

Operator Mobil Oil Corporation			Lease Jicarilla "G"		Well No. 11
Unit Letter D	Section 36	Township 27-N	Range 3-W	County Rio Arriba	
Actual Footage Location of Well: 990' feet from the North line and 990 feet from the West line					
Ground Level Elev. 7272'	Producing Formation Mesaverde	Pool Blanco Mesaverde		Dedicated Acreage: 320 Acres	

1. Outline the acreage dedicated to the subject well by colored pencil or hachure marks on the plat below.
2. If more than one lease is dedicated to the well, outline each and identify the ownership thereof (both as to working interest and royalty).
3. If more than one lease of different ownership is dedicated to the well, have the interests of all owners been consolidated by communitization, unitization, force-pooling, etc?

☐ Yes ☐ No If answer is "yes," type of consolidation _____

If answer is "no," list the owners and tract descriptions which have actually been consolidated (Use reverse side of this form if necessary.) _____

No allowable will be assigned to the well until all interests have been consolidated (by communitization, unitization, forced-pooling, or otherwise) or until a non-standard unit, eliminating such interests, has been approved by the Commission.

N 89° 59' E - 5279'

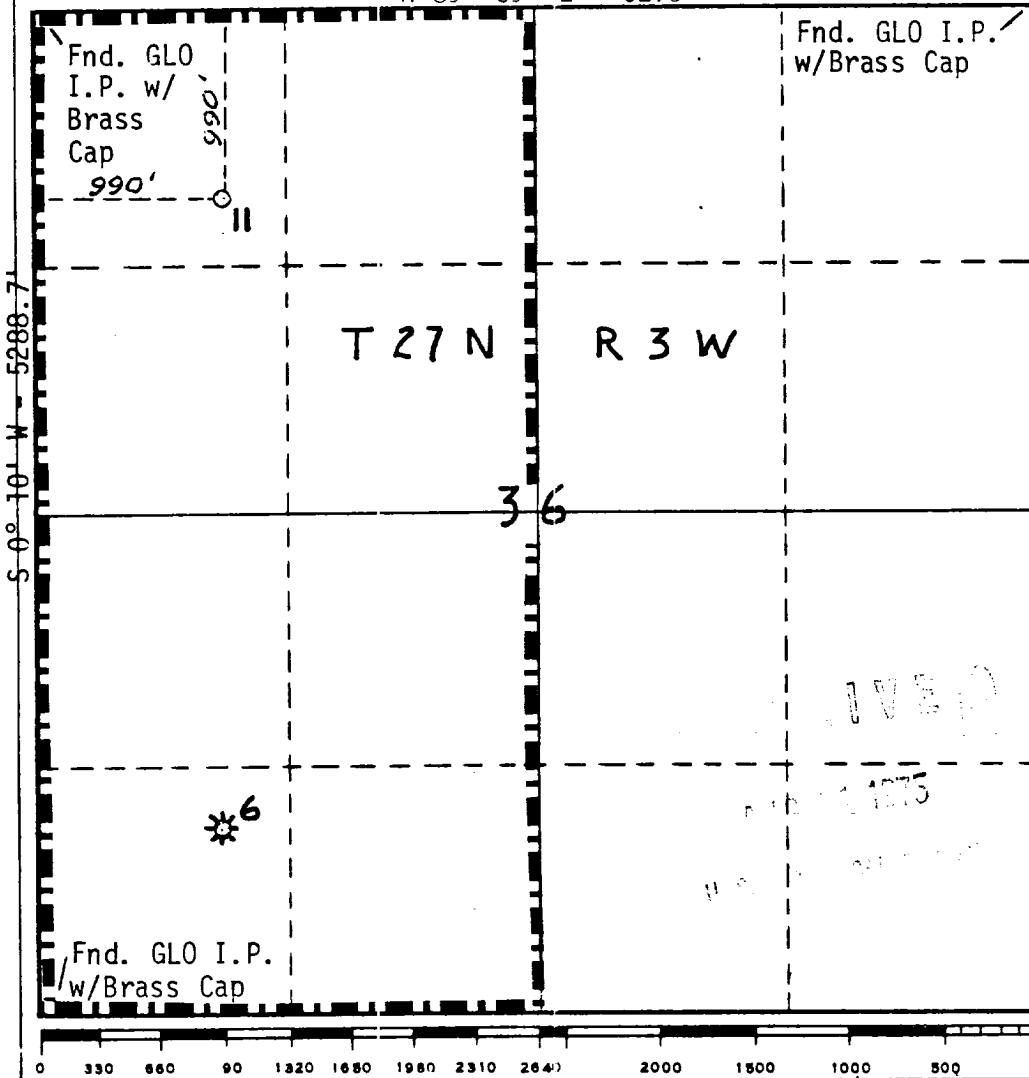

CERTIFICATION

I hereby certify that the information contained herein is true and complete to the best of my knowledge and belief.

W. B. Simmons, Jr.

Name
W. B. Simmons, Jr.

Position
Associate Engineer

Company
Mobil Oil Corporation

Date
August 7, 1975

I hereby certify that the well location shown on this plat was plotted from field notes of actual surveys made by me or under my supervision, and that the same is true and correct to the best of my knowledge and belief.

August 4, 1975

Date Surveyed
H. A. Carson, Jr.
Registered Professional Engineer
and/or Land Surveyor

H. A. Carson, Jr.
Certificate No.

5063

**NEW MEXICO OIL CONSERVATION COMMISSION
WELL LOCATION AND ACREAGE DEDICATION PLAT**

Form C-102
Supersedes C-128
Effective 1-1-65

All distances must be from the outer boundaries of the Section.

Operator Mobil Oil Corporation			Lease Jicarilla "G"		Well No. 11
Unit Letter D	Section 36	Township 27-N	Range 3-W	County Rio Arriba	
Actual Footage Location of Well: 990 feet from the North line and 990' feet from the West line					
Ground Level elev. 7272'	Producing Formation Pictured Cliffs		Pool Gavlin Pictured Cliffs		Dedicated Acreage; 160 Acres

- Outline the acreage dedicated to the subject well by colored pencil or hachure marks on the plat below.
- If more than one lease is dedicated to the well, outline each and identify the ownership thereof (both as to working interest and royalty).
- If more than one lease of different ownership is dedicated to the well, have the interests of ~~them~~ which have been consolidated by communitization, unitization, force-pooling, etc?

☐ Yes ☐ No If answer is "yes," type of consolidation _____

If answer is "no," list the owners and tract descriptions which have actually been consolidated. (Use reverse side of this form if necessary.) _____

No allowable will be assigned to the well until all interests have been consolidated (by communitization, unitization, forced-pooling, or otherwise) or until a non-standard unit, eliminating such interests, has been approved by the Commission.

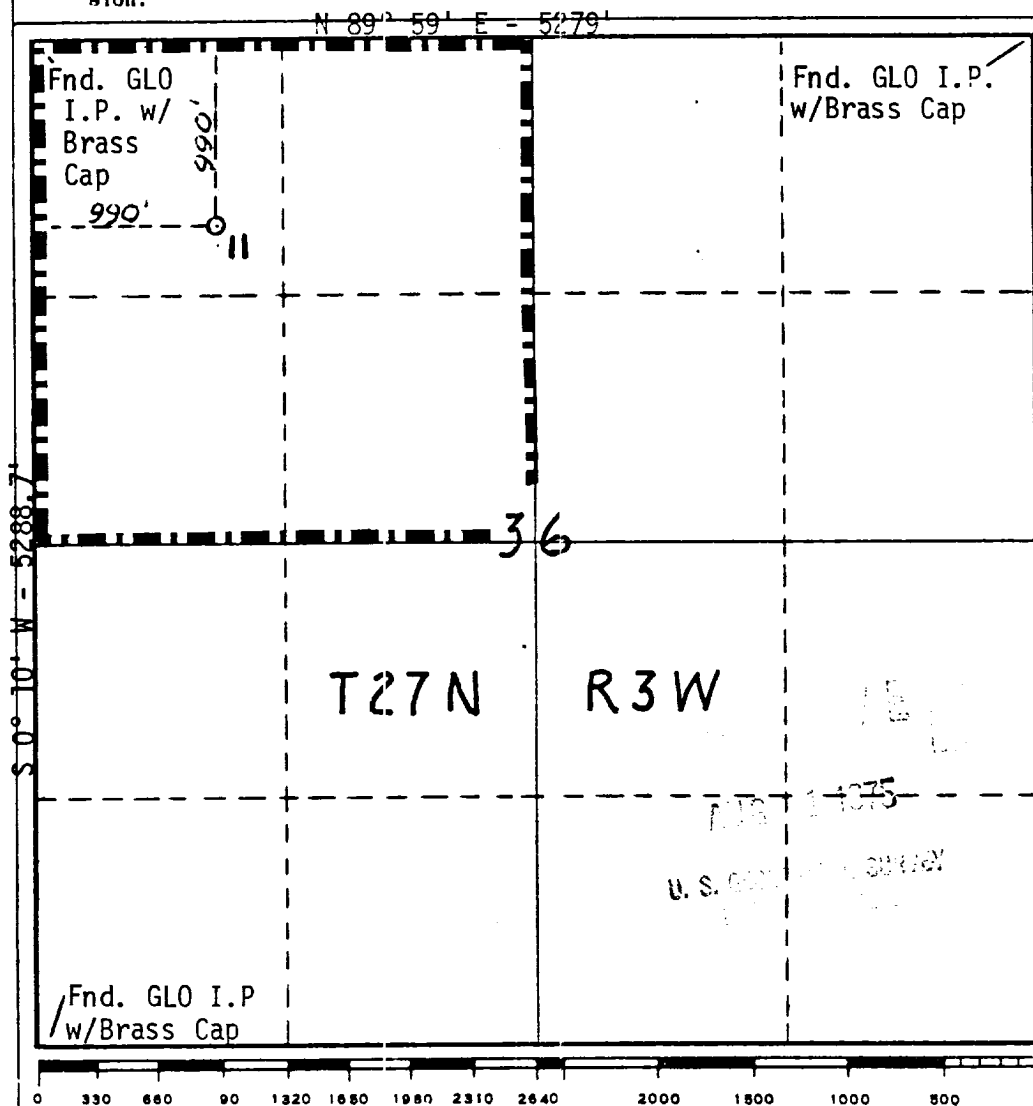
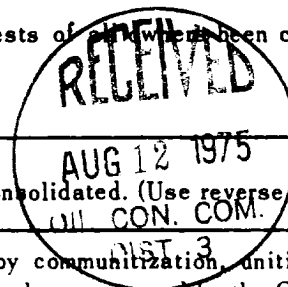

CERTIFICATION

I hereby certify that the information contained herein is true and complete to the best of my knowledge and belief.

W. B. Simmons Jr.

Name
W. B. Simmons, Jr.

Position
Associate Engineer

Company
Mobil Oil Corporation

Date
August 7, 1975

I hereby certify that the well location shown on this plat was plotted from field notes of actual surveys made by me or under my supervision, and that the same is true and correct to the best of my knowledge and belief.

August 4, 1975

Date Surveyed
H. A. Carson, Jr.
Registered Professional Engineer
and/or Land Surveyor

Certificate No.
5063