

(SUBMIT IN TRIPLICATE)

UNITED STATES
DEPARTMENT OF THE INTERIOR
GEOLOGICAL SURVEY

Land Office Santa Fe
Lease No. 079304
Unit Rincon Unit

SUNDRY NOTICES AND REPORTS ON WELLS

NOTICE OF INTENTION TO DRILL.....	SUBSEQUENT REPORT OF WATER SHUT-OFF.....
NOTICE OF INTENTION TO CHANGE PLANS.....	SUBSEQUENT REPORT OF SHOOTING OR ACIDIZING.....
NOTICE OF INTENTION TO TEST WATER SHUT-OFF.....	SUBSEQUENT REPORT OF ALTERING CASING.....
NOTICE OF INTENTION TO RE-DRILL OR REPAIR WELL.....	SUBSEQUENT REPORT OF RE-DRILLING OR REPAIR.....
NOTICE OF INTENTION TO SHOOT OR ACIDIZE.....	SUBSEQUENT REPORT OF ABANDONMENT.....
NOTICE OF INTENTION TO PULL OR ALTER CASING.....	SUPPLEMENTARY WELL HISTORY.....
NOTICE OF INTENTION TO ABANDON WELL.....	

(INDICATE ABOVE BY CHECK MARK NATURE OF REPORT, NOTICE, OR OTHER DATA)

September 22, 1951

Well No. 121 (40) is located 1600 ft. from S line and 990 ft. from W line of sec. 28

SW/ Sec. 2 (1/4 Sec. and Sec. No.) 27S (Twp.) 08 (Range) N.A.P.M. (Meridian)

Blanco M.V. & So. Blanco Dak. ext. (Field) Rio Arriba (County or Subdivision)

New Mexico (State or Territory)

The elevation of the derrick floor above sea level is 6669 ft.

DETAILS OF WORK

(State names of and expected depths to objective sands; show sizes, weights, and lengths of proposed casings; indicate mudding jobs, cementing points, and all other important proposed work)

It is intended to drill & ~~comple~~ complete a well in the Dakota formation & Mesa Verde formation. Mud circulation will be used thru the Pictured Cliffs & set intermediate casing. Gas circulation will be used thru the middle of the Greenhorn formation & 7" liner will be set. Mud circulation will be used thru the Dakota formation & production liner will be set. Possible productive intervals will be perforated & fractured. Est. T. D. 7825'.

Casing Program:

- 13 3/8" at 300' w/350 sks. cement circulated to surface.
- 5 7/8" at 3400' w/200 sks. cement circulated to surface.
- 7" at 7385' w/800 sks. cement.
- 5" at 7825' w/100 sks. cement.

The S/2 of Section 28 is dedicated to the Mesa Verde formation.
The S/2 of Section 28 is dedicated to the Dakota formation.

I understand that this plan of work must receive approval in writing by the Geological Survey before operations may be commenced.

S/2: SP 079304

Company El Paso Natural Gas Company

Address Box 771

Farmington, New Mexico

By Original Signed R. G. MILLER

Title Petroleum Engineer

NEW MEXICO OIL CONSERVATION COMMISSION

Well Location and Acreage Dedication Plat

Section A.

Date **SEPTEMBER 22, 1959**

Operator **EL PASO NATURAL GAS COMPANY** Lease **RINCON UNIT** **SF 079364**
 Well No. **128(MD)** Unit Letter **L** Section **28** Township **27-N** Range **6-W** NMPA **128**
 Located **1600** Feet From **SOUTH** Line **990** Feet From **WEST** Line
 County **BIO ARriba** G. L. Elevation **6679** Dedicated Acreage **320 & 320** Acres
 Name of Producing Formation **MESA VERDE AND DAKOTA** Pool **BLANCO MV & SO. BLANCO DAKOTA EXT.**

1. Is the Operator the only owner in the dedicated acreage outlined on the plat below?
 Yes ☒ No ☐
2. If the answer to question one is "no", have the interests of all the owners been consolidated by communitization agreement or otherwise? Yes ☐ No ☐ If answer is "yes", Type of Consolidation.
3. If the answer to question two is "no", list all the owners and their respective interests below:

Owner

Land Description

Section B.

Note: All distances must be from outer boundaries of section.

This is to certify that the information in Section A above is true and complete to the best of my knowledge and belief.

El Paso Natural Gas Company

(Operator)

Original Signed **R. G. MILLER**

(Representative)

Box 287

(Address)

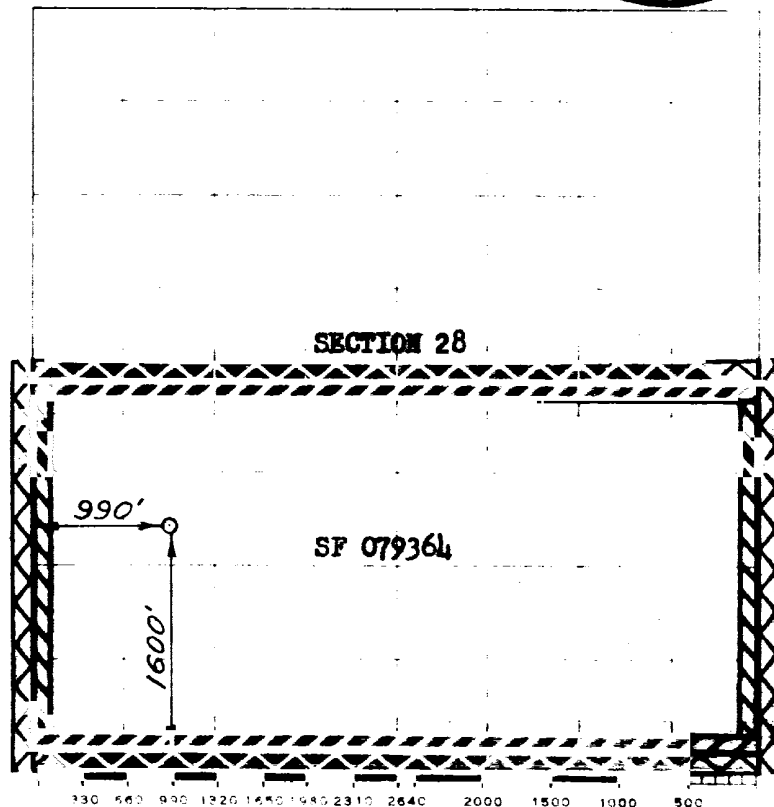
Farmington, New Mexico

Scale 1 inch equals 1 mile

This is to certify that the above plat was prepared from field notes of actual surveys made by me or under my supervision and that the same are true and correct to the best of my knowledge and belief.

(Seal)

Farmington, New Mexico

Date Surveyed **AUGUST 18, 1959**

R. G. Miller
 Registered Professional Engineer and/or Land Surveyor