

(SUBMIT IN TRIPLICATE)

UNITED STATES
DEPARTMENT OF THE INTERIOR
GEOLOGICAL SURVEY

Land Office Santa Fe
Lease No. 000385
Unit Rincon Unit

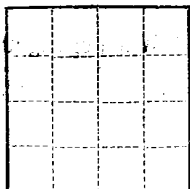

SUNDRY NOTICES AND REPORTS ON WELLS

NOTICE OF INTENTION TO DRILL.....	SUBSEQUENT REPORT OF WATER SHUT-OFF.....
NOTICE OF INTENTION TO CHANGE PLANS.....	SUBSEQUENT REPORT OF SHOOTING OR ACIDIZING.....
NOTICE OF INTENTION TO TEST WATER SHUT-OFF.....	SUBSEQUENT REPORT OF ALTERING CASING.....
NOTICE OF INTENTION TO RE-DRILL OR REPAIR WELL.....	SUBSEQUENT REPORT OF RE-DRILLING OR REPAIR.....
NOTICE OF INTENTION TO SHOOT OR ACIDIZE.....	SUBSEQUENT REPORT OF ABANDONMENT.....
NOTICE OF INTENTION TO PULL OR ALTER CASING.....	SUPPLEMENTARY WELL HISTORY.....
NOTICE OF INTENTION TO ABANDON WELL.....	

(INDICATE ABOVE BY CHECK MARK NATURE OF REPORT, NOTICE, OR OTHER DATA)

April 19, 1956

Well No. 65 is located 990 ft. from S line and 1650 ft. from E line of sec. 23
SE Section 23 27N 7W 106M
 (1/4 Sec. and Sec. No.) (Twp.) (Range) (Meridian)
So. Blanco P.C. Rio Arriba New Mexico
 (Field) (County or Subdivision) (State or Territory)

The elevation of the derrick floor above sea level is 6673 ft.

DETAILS OF WORK

(State names of and expected depths to objective sands; show sizes, weights, and lengths of proposed casings; indicate mudding jobs, cementing points, and all other important proposed work)

This plat is re-issued to show corrected elevation.



I understand that this plan of work must receive approval in writing by the Geological Survey before operations may be commenced.

Company El Paso Natural Gas Company

Address Box 997

Farmington, New Mexico

By [Signature]

Title Petroleum Engineer

OIL CONSERVATION COMMISSION

WELL LOCATION AND/OR GAS PRODUCTION PLAT

DATE MARCH 16, 1956OPERATOR EL PASO NATURAL GAS COMPANY LEASE RINCON SF 080385WELL NO. 65 SECTION 23 TOWNSHIP 27-N RANGE 7-W NMPMLOCATED 990 FEET FROM SOUTH LINE 1650 FEET FROM EAST LINERIO ARriba COUNTY, NEW MEXICO G. L. ELEVATION 6663NAME OF PRODUCING FORMATION PICTURED CLIFF POOL SO. BLANCO DEDICATED ACREAGE 160
(1882 PLATS)

Note: All distances must be from outer boundaries of section.

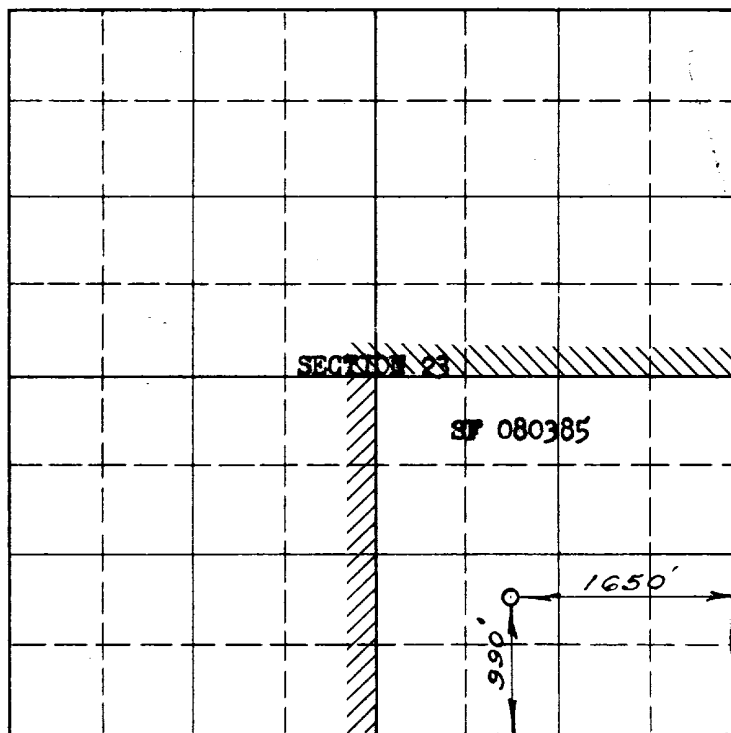

Scale 4 inches equal 1 mile

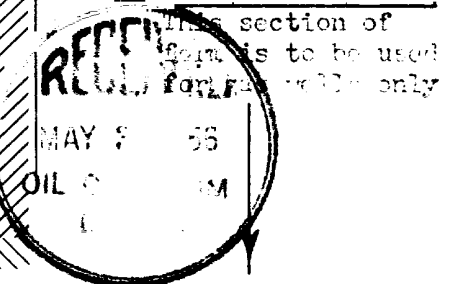

This is to certify that the above plat was prepared from field notes of actual surveys made by me or under my supervision and that the same are true and correct to the best of my knowledge and belief.

Date Surveyed MARCH 8, 1956

E. O. Walker
Registered Professional Engineer and/or
Land Surveyor

(Seal)

1. Is this well a Dual Comp.
Yes _____ No X
2. If the answer to Question 1 is yes, are there any other dually completed wells within the dedicated acreage.
Yes _____ No _____

Name E. O. Walker
Position Petroleum Engineer
Representing El Paso Natural Gas Co.
Address Box 997, Farmington, N.M.

NOTE: Plat re-issued to show corrected elevation.Farmington, New Mexico **NOTE:** THIS PLAT IS RE-ISSUED TO SHOW CORRECTED ELEVATION.