

UNITED STATES
DEPARTMENT OF THE INTERIOR
GEOLOGICAL SURVEY

APPLICATION FOR PERMIT TO DRILL, DEEPEN, OR PLUG BACK

1a. TYPE OF WORK

DRILL ☒DEEPEN ☐PLUG BACK ☐

b. TYPE OF WELL

OIL
WELL ☐GAS
WELL ☒

OTHER

SINGLE
ZONE ☒MULTIPLE
ZONE ☐

2. NAME OF OPERATOR

PAN AMERICAN PETROLEUM CORPORATION

3. ADDRESS OF OPERATOR

P. O. Box 480, Farmington, New Mexico

4. LOCATION OF WELL (Report location clearly and in accordance with any State requirements.)*

At surface

1850 FNL and 1070 FNL

At proposed prod. zone Same

14. DISTANCE IN MILES AND DIRECTION FROM NEAREST TOWN OR POST OFFICE*

44 miles southeast of Blanco, New Mexico

15. DISTANCE FROM PROPOSED*

LOCATION TO NEAREST
PROPERTY OR LEASE LINE, FT.
(Also to nearest drlg. unit line, if any)

1070'

18. DISTANCE FROM PROPOSED LOCATION*

TO NEAREST WELL, DRILLING, COMPLETED,
OR APPLIED FOR, ON THIS LEASE, FT.

3300'

16. NO. OF ACRES IN LEASE

320

19. PROPOSED DEPTH

7900'

17. NO. OF ACRES ASSIGNED
TO THIS WELL

320

20. ROTARY OR CABLE TOOLS

Rotary

21. ELEVATIONS (Show whether DF, RT, GR, etc.)

Will report later.

22. APPROX. DATE WORK WILL START*

5-17-65

23.

PROPOSED CASING AND CEMENTING PROGRAM

SIZE OF HOLE	SIZE OF CASING	WEIGHT PER FOOT	SETTING DEPTH	QUANTITY OF CEMENT
13-3/4"	10-3/4"	48#	200	250 Sacks
9-7/8"	7-5/8"	24#	3650	1000 Sacks
6-3/4"	4-1/2"	10.5#	7900	450 Sacks (2 Stage Tool to be set 100' below base of Mezaverte)

Copies of Location Plat are attached.

Copies of any logs run will be furnished upon completion of well.

RECEIVED

MAY 12 1965

U. S. GEOLOGICAL SURVEY
FARMINGTON, N. M.

Verbal approval received 5-13-65, Dick Krahle to J. C. Glover.

IN ABOVE SPACE DESCRIBE PROPOSED PROGRAM: If proposal is to deepen or plug back, give data on present productive zone and proposed new productive zone. If proposal is to drill or deepen directionally, give pertinent data on subsurface locations and measured and true vertical depths. Give blowout preventer program, if any.

24. F. L. Nabors, District Engineer
SIGNED BY F. H. HOLLINGSWORTH

SIGNED

TITLE

DATE May 13, 1965

(This space for Federal or State office use)

PERMIT NO.

APPROVAL DATE

APPROVED BY

TITLE

CONDITIONS OF APPROVAL, IF ANY: 13 1965

P. T. McGRATH
DISTRICT ENGINEER

*See Instructions On Reverse Side

RECEIVED

JUN 3 1965

OIL CON. COM.
DIST. 3

NEW MEXICO OIL CONSERVATION COMMISSION
WELL LOCATION AND ACREAGE DEDICATION PLAT

SECTION A.

DATE May 12, 1965

OPERATOR Pan American Petroleum Corporation

LEASE San Juan 27-5 Unit

WELL NO. 98 UNIT LETTER B SECTION 14 TOWNSHIP 27 North RANGE 5 West NMPM

LOCATED 1850 FEET FROM North LINE. 1070 FEET FROM West LINE

COUNTY 10 Arriba S. L. ELEVATION Report Later DEDICATED ACREAGE 320 ACRES

NAME OF PRODUCING FORMATION Dakota POOL Basin Dakota

1. IS THE OPERATOR THE ONLY OWNER IN THE DEDICATED ACREAGE OUTLINED ON THE PLAT BELOW? YES ☒ NO ☐

2. IF THE ANSWER TO QUESTION ONE IS "NO," HAVE THE INTERESTS OF ALL THE OWNERS BEEN CONSOLIDATED BY COMMUNICIPATION AGREEMENT OR OTHERWISE? YES ☐ NO ☐ IF ANSWER IS "YES," TYPE OF CONSOLIDATION

3. IF THE ANSWER TO QUESTION TWO IS "NO," LIST ALL THE OWNERS AND THEIR RESPECTIVE INTERESTS BELOW:
OWNER LAND DESCRIPTION

SECTION B.

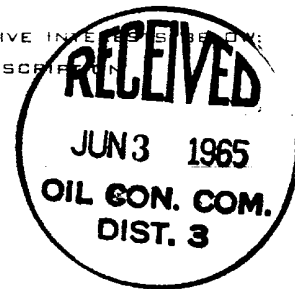
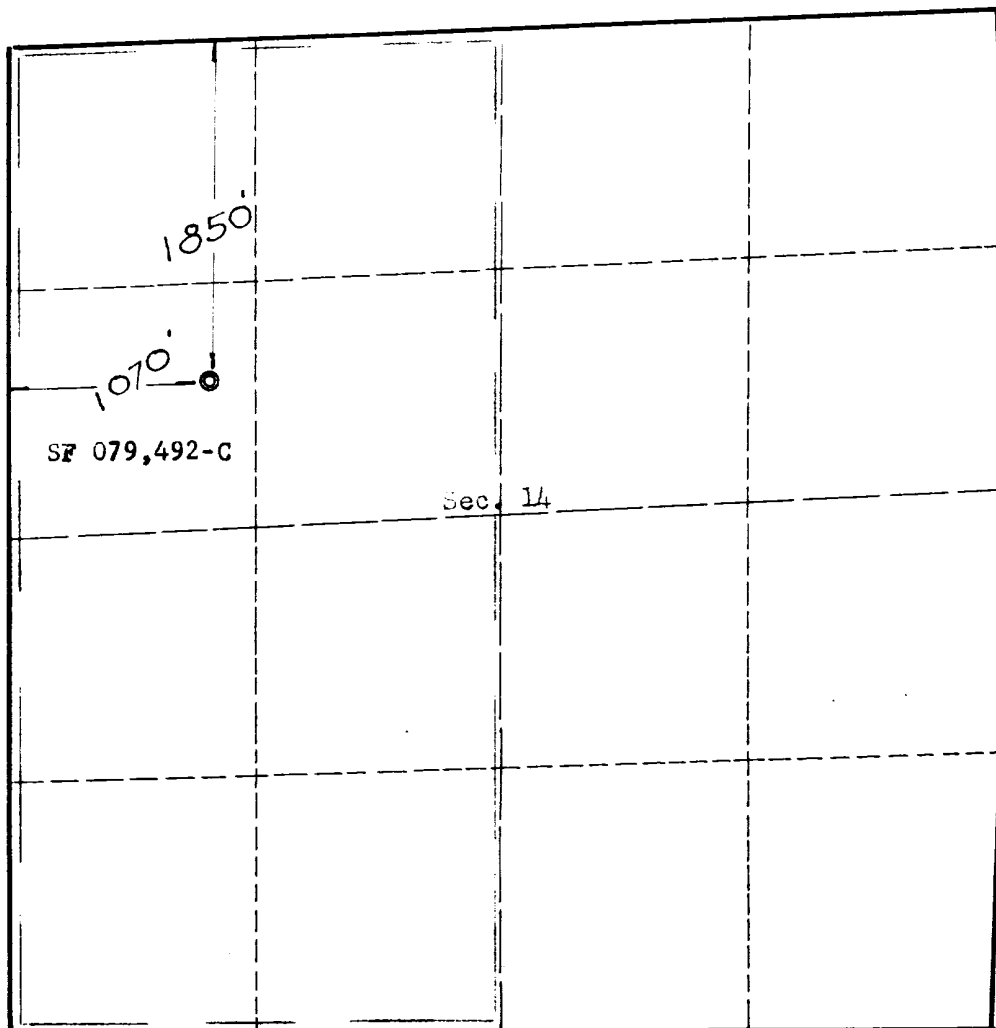

THIS IS TO CERTIFY THAT THE INFORMATION IN SECTION A ABOVE IS TRUE AND COMPLETE TO THE BEST OF MY KNOWLEDGE AND BELIEF.

PAN AMERICAN PETROLEUM CORP.

(OPERATOR)
F. H. Hollingsworth

F. H. Hollingsworth

(REPRESENTATIVE)

P. O. Box 480

Farmington, New Mexico

(ADDRESS)

THIS IS TO CERTIFY THAT THE WELL LOCATION SHOWN ON THE PLAT IN SECTION B WAS PLOTTED FROM FIELD NOTES OF ACTUAL SURVEYS MADE BY ME OR UNDER MY SUPERVISION AND THAT THE SAME IS TRUE AND CORRECT TO THE BEST OF MY KNOWLEDGE AND BELIEF.

DATE SURVEYED April 5, 1965

**FOUR STATES
ENGINEERING CO.**

FARMINGTON, NEW MEXICO

Emmett A. Cochran
REGISTERED ENGINEER OR
LAND SURVEYOR

CERTIFICATE NO. 3602