

(SUBMIT IN TRIPLICATE)

UNITED STATES
DEPARTMENT OF THE INTERIOR
GEOLOGICAL SURVEY

Land Office Santa Fe
Lease No. 079360
Unit Rincon Unit

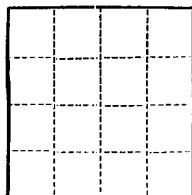

SUNDRY NOTICES AND REPORTS ON WELLS

NOTICE OF INTENTION TO DRILL	<input checked="" type="checkbox"/>	SUBSEQUENT REPORT OF WATER SHUT-OFF
NOTICE OF INTENTION TO CHANGE PLANS	<input type="checkbox"/>	SUBSEQUENT REPORT OF SHOOTING OR ACIDIZING
NOTICE OF INTENTION TO TEST WATER SHUT-OFF	<input type="checkbox"/>	SUBSEQUENT REPORT OF ALTERING CASING
NOTICE OF INTENTION TO RE-DRILL OR REPAIR WELL	<input type="checkbox"/>	SUBSEQUENT REPORT OF RE-DRILLING OR REPAIR
NOTICE OF INTENTION TO SHOOT OR ACIDIZE	<input type="checkbox"/>	SUBSEQUENT REPORT OF ABANDONMENT
NOTICE OF INTENTION TO PULL OR ALTER CASING	<input type="checkbox"/>	SUPPLEMENTARY WELL HISTORY
NOTICE OF INTENTION TO ABANDON WELL	<input type="checkbox"/>	

(INDICATE ABOVE BY CHECK MARK NATURE OF REPORT, NOTICE, OR OTHER DATA)

April 15, 1957

Well No. 05 (52) is located 1650 ft. from N line and 890 ft. from E line of sec. 15

NE Section 15 27N 7W N.M.P.M.
(1/4 Sec. and Sec. No.) (Twp.) (Range) (Meridian)

So. Blanco P.C. Ext. & Blanco Rio Arriba New Mexico
(Field) (County or Subdivision) (State or Territory)

The elevation of the derrick floor above sea level is 6756 ft.

DETAILS OF WORK

(State names of and expected depths to objective sands; show sizes, weights, and lengths of proposed casings; indicate mudding jobs, cementing points, and all other important proposed work)

It is intended to drill & drill complete a well in the Pictured Cliffs formation & Mesa Verde formation. Mud circulation will be used thru the Pictured Cliffs formation & set intermediate casing. Gas circulation will be used thru the Mesa Verde & a production liner will be set. Possible productive intervals will be perforated & fractured. Estimated Total Depth 5720'.

Casing Program:

10-3/4" at 170' with 125 sacks cement circulated to the surface.

7-5/8" at 3440' with 250 sacks cement.

5-1/2" liner at 5720' with 300 sacks cement.

The E/2 of Section 15 is dedicated to the Mesa Verde.

The SE/4 of Section 15 is dedicated to the Pictured Cliffs.

E/2 & SE/4, SP 079360.

I understand that this plan of work must receive approval in writing by the Geological Survey before operations may be commenced.

Company El Paso Natural Gas Company

Address Box 997

Farmington, New Mexico

By ORIGINAL SIGNED F.W. BOYD

Title Petroleum Engineer



NEW MEXICO
OIL CONSERVATION COMMISSION

WELL LOCATION AND/OR GAS PRODUCTION PLAT

APRIL 8, 1957

EL PASO NATURAL GAS COMPANY

RINCON UNIT

SF 079360

85 (PM)

15

27 N

7 W

1650

NORTH

890

EAST

RIO ARriba

6746

SO BLANCO PC EXT.

160 AC. PC

P.C. & M.V.

BLANCO MV

320 AC. MV

(1882 PLATS)

Note: All distances must be from outer boundaries of section.

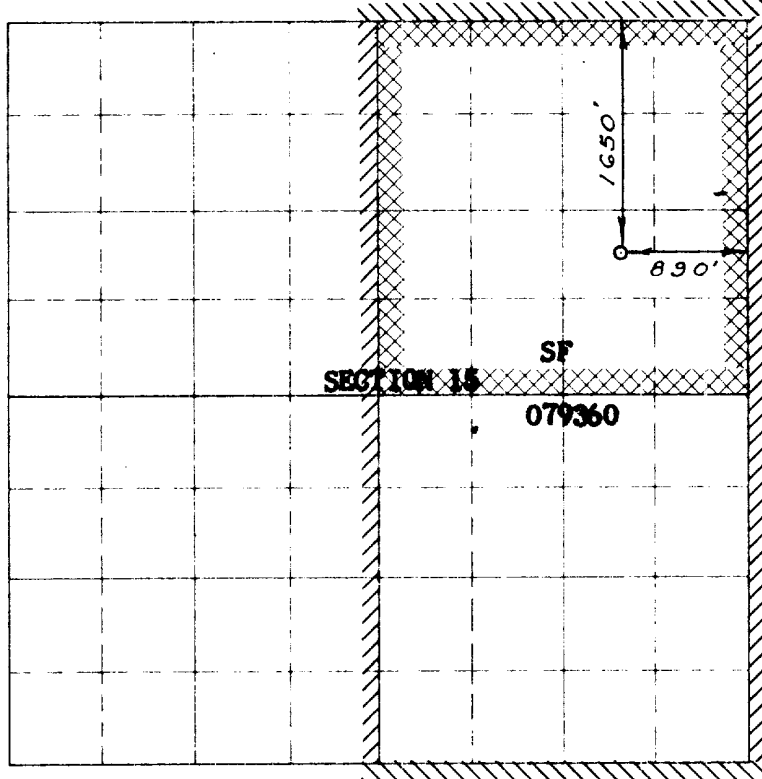

Scale: 1 inch = 1 mile

NOTE

This section of
form is to be used
for gas wells only

This is to certify that the above plat was prepared from
field notes of actual surveys made by me or under my
supervision and that the same are true and correct to the
best of my knowledge and belief.

Date Surveyed **FEBRUARY 5, 1957**

E. O. Walker
Registered Professional Engineer and/or Land Surveyor

1. Is this well a Dual Comp.

Yes ☒ No ☐

2. If the answer to Question 1
is yes, are there any other dually
completed wells within the
dedicated acreage.

Yes ☐ No ☒

Name **ORIGINAL SIGNED F.W. BOYD**

Position **Petroleum Engineer**

Representing **El Paso Natural Gas**

Address **Box 997, Farmington, N.M.**

(Seal)

Farmington, New Mexico