

Form 9-581a  
(Feb. 1961)

(SUBMIT IN TRIPLICATE)

Land Office Santa Fe

Lease No. 030668

Unit San Juan 27-5- Unit  
14-03-001-950

UNITED STATES  
DEPARTMENT OF THE INTERIOR  
GEOLOGICAL SURVEY

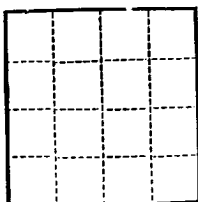

SUNDRY NOTICES AND REPORTS ON WELLS

NOTICE OF INTENTION TO DRILL.....	<input checked="" type="checkbox"/>	SUBSEQUENT REPORT OF WATER SHUT-OFF.....
NOTICE OF INTENTION TO CHANGE PLANS.....		SUBSEQUENT REPORT OF SHOOTING OR ACIDIZING.....
NOTICE OF INTENTION TO TEST WATER SHUT-OFF.....		SUBSEQUENT REPORT OF ALTERING CASING.....
NOTICE OF INTENTION TO RE-DRILL OR REPAIR WELL.....		SUBSEQUENT REPORT OF RE-DRILLING OR REPAIR.....
NOTICE OF INTENTION TO SHOOT OR ACIDIZE.....		SUBSEQUENT REPORT OF ABANDONMENT.....
NOTICE OF INTENTION TO PULL OR ALTER CASING.....		SUPPLEMENTARY WELL HISTORY.....
NOTICE OF INTENTION TO ABANDON WELL.....		

(INDICATE ABOVE BY CHECK MARK NATURE OF REPORT, NOTICE, OR OTHER DATA)

May 20, 1960

Well No. 52 (FM) is located 300 ft. from RM line and 300 ft. from RM line of sec. 4

S.W. Sec. 4 27 N 5 W N.M.P.M.  
(1/4 Sec. and Sec. No.) (Twp.) (Range) (Meridian)

Wildest P.C. & Blanco M.V. Rio Arriba New Mexico  
(Field) (County or Subdivision) (State or Territory)

The elevation of the derrick floor above sea level is 5629 ft.

DETAILS OF WORK

(State names of and expected depths to objective sands; show sizes, weights, and lengths of proposed casings; indicate mudding jobs, cementing points, and all other important proposed work)

It is intended to drill & dual complete a well in the Pictured Cliffs formation & Mesa Verde formation. Mud circulation will be used thru the Pictured Cliffs formation & set intermediate casing. Gas circulation will be used thru the Mesa Verde & a production liner will be set. Possible productive intervals will be perforated & fractured. Estimated Total Depth 5825'.

Casing Program:

10 3/4" at 170' with 125 sacks cement circulated to the surface.  
7 5/8" at 3540' with 250 sacks cement.  
5 1/2" liner at 5825' with 300 sacks cement.

The W/2 of Section 4 is dedicated to the Mesa Verde.  
The SW/4 of Section 4 is dedicated to the Pictured Cliffs.

W/2 S.F. 080668

I understand that this plan of work must receive approval in writing by the Geological Survey before operations may be commenced.

Company El Paso Natural Gas Company

Address Box 997  
Hardington, New Mexico

By ORIGINAL SIGNED J.J. TILPERSON

Title Petroleum Engineer

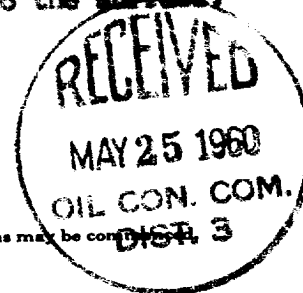

## NEW MEXICO OIL CONSERVATION COMMISSION

## Well Location and Acreage Dedication Plat

Section A.

Date MAY 10, 1960

Operator **EL PASO NATURAL GAS COMPANY** Lease **SAN JUAN 27-5 UNIT** SF **080668**  
 Well No. **52(PM)** Unit Letter **M** Section **4** Township **27-N** Range **5-W** N.M.P.M.  
 Located **800** Feet From **SOUTH** Line, **800** Feet From **WEST** Line  
 County **RIO ARriba** G. L. Elevation **6619** Dedicated Acreage **320.23 & 160** Acres  
 Name of Producing Formation **MESA VERDE AND PICTURED CLIFFS** Pool **BLANCO MV & WILDCAT PC**

1. Is the Operator the only owner in the dedicated acreage outlined on the plat below?

Yes ☐ No ☒2. If the answer to question one is "no", have the interests of all the owners been consolidated by communitization agreement or otherwise? Yes ☒ No ☐ If answer is "yes", Type of Consolidation.**Unit Agreement**

3. If the answer to question two is "no", list all the owners and their respective interests below.

Owner

Land Description



Section B.

This is to certify that the information in Section A above is true and complete to the best of my knowledge and belief.

**El Paso Natural Gas Company**ORIGINAL SIGNED **J.J. TILLERSON**

(Representative)

**Box 997**

(Address)

**Farmington, New Mexico**

Note: All distances must be from outer boundaries of section.

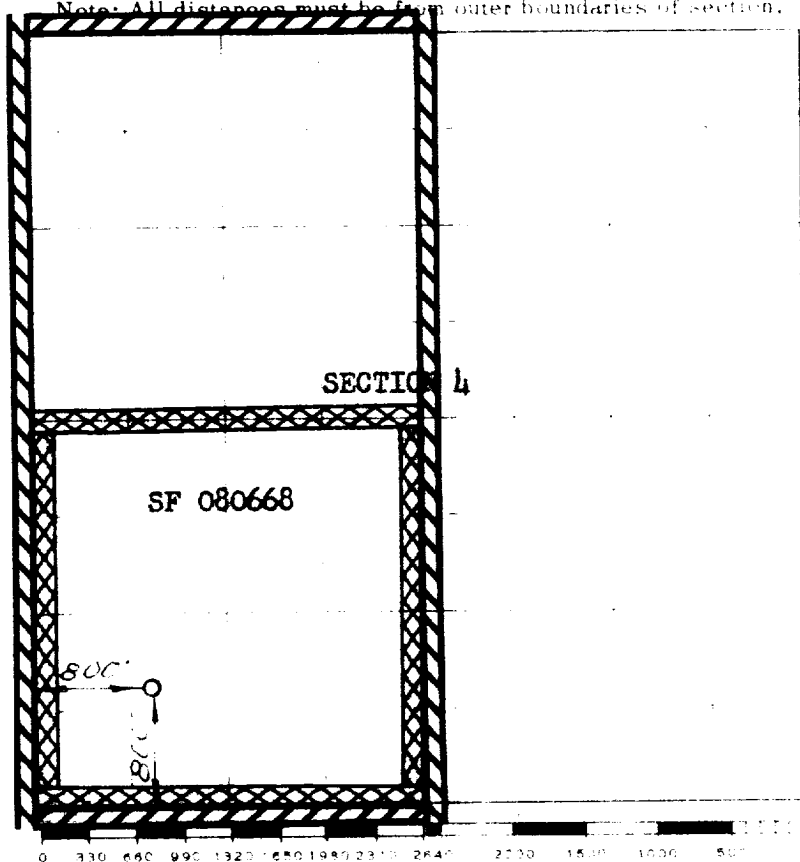

Scale 1 inches equal 1 mile

This is to certify that the above plat was prepared from field notes of actual surveys made by me or under my supervision and that the same are true and correct to the best of my knowledge and belief.

(Seal)

Date Signed

**FEBRUARY 10, 1960**

*David C. Tillerson*  
 Surveyor

Examination of Map