

NEW MEXICO OIL CONSERVATION COMMISSION WELL LOCATION AND ACERAGE DEDICATION PLAT

All distances must be from the outer boundaries of the Section

Operator BENSON-MONTIN-GREER DRILLING CORPORATION				Lease JICARILLA 200		Well No 1 (D-21)	
Unit Letter D	Section 21	Township 27 NORTH	Range 1 WEST	County XXIMPLEY RIO ARRIBA			
Actual Footage Location of Well: 660 feet from the NORTH line and 825 feet from the WEST line							
Ground Level Elev. 7655.72	Producing Formation Mangos	Post Wildcat	Dedicated Acreage 160		Acres		

- Outline the acreage dedicated to the subject well by colored pencil or hatchure marks on the plat below.
- If more than one lease is dedicated to the well, outline each and identify the ownership thereof (both as to working interest and royalty).
- If more than one lease of different ownership is dedicated to the well, have the interests of all owners been consolidated by communitization, unitization, force-pooling, etc?

X () Yes () No If answer is "yes," type of consolidation _____

If answer is "no," list the owners and tract descriptions which have actually consolidated (Use reverse side of this form if necessary)

No allowable will be assigned to the well until all interests have been consolidated (by communitization, unitization, forced-pooling, or otherwise) or until a non standard unit, eliminating such interests, has been approved by the Commission.

CERTIFICATION

I hereby certify that the information contained herein is true and complete to the best of my knowledge and belief.

Harold N. Strahl
Name

Position **Engineer**

Benson-Montin-Greer Drilling Corp.
Company

Date **May 25, 1966**

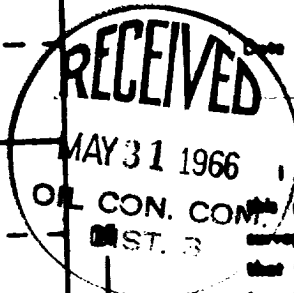

I hereby certify that the well location shown on this plat was plotted from field notes of actual surveys made by me or under my supervision, and that the same is true and correct to the best of my knowledge and belief.

Date Surveyed **April 13, 1966**

James L. Larkin
Name of Engineer or Land Surveyor
James L. Larkin

Certificate No. **1463**

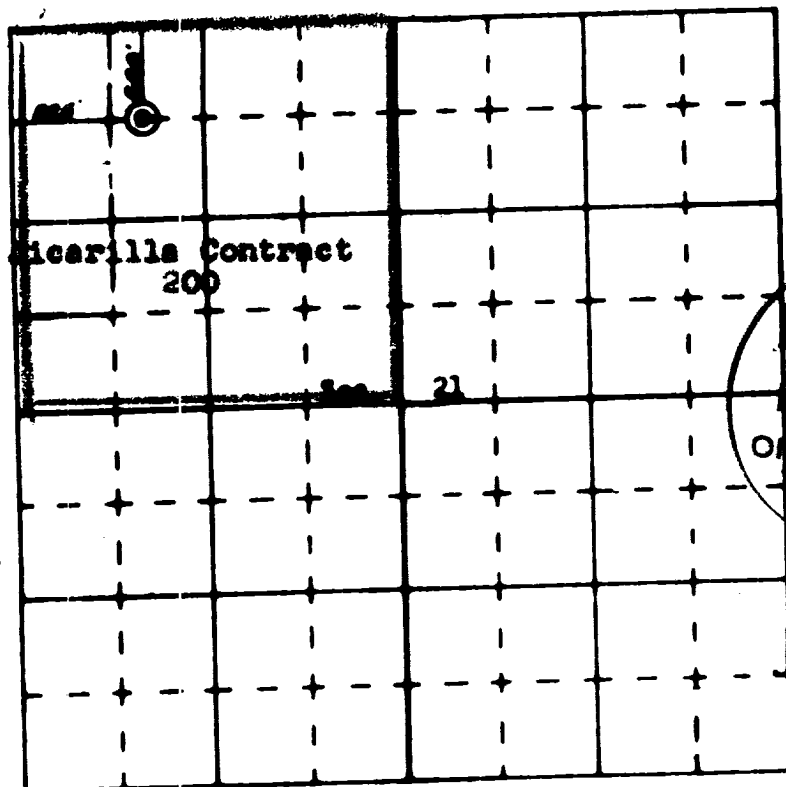

SCALE—4 INCHES EQUALS 1 MILE

HAN JUAN ENGINEERING COMPANY, FARMINGTON, N. M.

UNITED STATES
DEPARTMENT OF THE INTERIOR
GEOLOGICAL SURVEYSUBMIT IN TRIPLICATE*
(Other instructions on re-
verse side)Form approved.
Budget Bureau No. 42-R1424.

5. LEASE DESIGNATION AND SERIAL NO.

Contract 200

6. IF INDIAN, ALLOTTEE OR TRIBE NAME

Jicarilla Apache

7. UNIT AGREEMENT NAME

8. FARM OR LEASE NAME

Jicarilla 200

9. WELL NO.

1 (D-21)

10. FIELD AND POOL, OR WILDCAT

Wildcat11. SEC., T., R., M., OR BLK. AND
SURVEY OR AREA**Sec. 21, T-27N, R-1W**

12. COUNTY OR PARISH

13. STATE

Rio Arriba**New Mexico****SUNDRY NOTICES AND REPORTS ON WELLS**
(Do not use this form for proposals to drill or to deepen or plug back to a different reservoir.
Use "APPLICATION FOR PERMIT—" for such proposals.)1. ☐ OIL
WELL ☒ GAS
WELL ☐ OTHER

2. NAME OF OPERATOR

BENSON-MONTIN-GREEK DRILLING CORP.

3. ADDRESS OF OPERATOR

221 Petroleum Center Building, Farmington, New Mexico4. LOCATION OF WELL (Report location clearly and in accordance with any State requirements.*
See also space 17 below.)
At surface**660' FNL, 825' FWL, Sec. 21, T-27N, R-1W**

14. PERMIT NO.

15. ELEVATIONS (Show whether DF, RT, GR, etc.)

7655' GR

16. Check Appropriate Box To Indicate Nature of Notice, Report, or Other Data

NOTICE OF INTENTION TO:

TEST WATER SHUT-OFF ☐FRACTURE TREAT ☐SHOOT OR ACIDIZE ☐REPAIR WELL ☐(Other) ☐PULL OR ALTER CASING ☐MULTIPLE COMPLETE ☐ABANDON* ☐CHANGE PLANS ☐

SUBSEQUENT REPORT OF:

WATER SHUT-OFF ☐FRACTURE TREATMENT ☒SHOOTING OR ACIDIZING ☐(Other) ☐REPAIRING WELL ☐ALTERING CASING ☐ABANDONMENT* ☐(NOTE: Report results of multiple completion on Well
Completion or Recompletion Report and Log form.)

17. DESCRIBE PROPOSED OR COMPLETED OPERATIONS (Clearly state all pertinent details, and give pertinent dates, including estimated date of starting any proposed work. If well is directionally drilled, give subsurface locations and measured and true vertical depths for all markers and zones pertinent to this work.)*

8-14-66 TD 7232' RKB. PBD 7189' RKB (bit, bit sub, 1 drill collar and approximately 10" of second drill collar left in hole as a result of downhole fire). Attempted to sand-oil frac using six pump trucks pumping sand-oil mixture, one pump truck pumping liquid carbon dioxide, and two blenders. Pumped 200 barrels of crude oil without sand into formation with 2600# pressure at rate of 50 BPM with no apparent breakdown. Shut down to get carbon dioxide started. Started pumping again with sand mixture of 1/8# per gallon and carbon dioxide at rate of approximately 2 1/2 BPM. When sand-oil mixture reached formation pump pressure started increasing and well sanded completely off.

8-15-66 Rigged up to clean out sand.

RECEIVED**AUG 24 1966****U. S. GEOLOGICAL SURVEY
FARMINGTON, N. M.**

18. I hereby certify that the foregoing is true and correct

SIGNED

TITLE

Engineer

DATE

8-23-66

(This space for Federal or State office use)

APPROVED BY

TITLE

DATE

CONDITIONS OF APPROVAL, IF ANY: