

UNITED STATES  
DEPARTMENT OF THE INTERIOR  
GEOLOGICAL SURVEY

APPLICATION FOR PERMIT TO DRILL, DEEPEN, OR PLUG BACK

1a. TYPE OF WORK  
 DRILL                       DEEPEN                       PLUG BACK

b. TYPE OF WELL  
 OIL WELL                       GAS WELL                       OTHER                       SINGLE ZONE                       MULTIPLE ZONE

2. NAME OF OPERATOR  
 El Paso Natural Gas Company

3. ADDRESS OF OPERATOR  
 PO Box 990, Farmington, NM 87401

4. LOCATION OF WELL (Report location clearly and in accordance with any State requirements.\*)  
 At surface  
 At proposed prod. zone                      1550'N, 1717'E

14. DISTANCE IN MILES AND DIRECTION FROM NEAREST TOWN OR POST OFFICE\*

15. DISTANCE FROM PROPOSED\* LOCATION TO NEAREST PROPERTY OR LEASE LINE, FT. (Also to nearest drlg. unit line, if any)

16. NO. OF ACRES IN LEASE

17. NO. OF ACRES ASSIGNED TO THIS WELL  
 320.00

18. DISTANCE FROM PROPOSED LOCATION\* TO NEAREST WELL, DRILLING COMPLETED, OR APPLIED FOR, ON THIS LEASE, FT.

19. PROPOSED DEPTH  
 8275'

20. ROTARY OR CABLE TOOLS  
 Rotary

21. ELEVATIONS (Show whether DP, RT, GR, etc.)  
 6968'GL

22. APPROX. DATE WORK WILL START\*

23. PROPOSED CASING AND CEMENTING PROGRAM

SIZE OF HOLE	SIZE OF CASING	WEIGHT PER FOOT	SETTING DEPTH	QUANTITY OF CEMENT
13 3/4"	9 5/8"	32.3#	200'	220 cu. ft. to circulate to surface
8 3/4"	7"	20#	4115'	195 cu. ft. to cover Ojo Alamo
6 1/4"	4 1/2"	10.5#&11.6#	8275'	640 cu. ft. to reach intermediate string

Selectively perforate and sandwater fracture the Dakota formation.

Forest approval has been secured.

The E/2 of Section 8 is dedicated to this well.



IN ABOVE SPACE DESCRIBE PROPOSED PROGRAM: If proposal is to deepen or plug back, give data on present productive zone and proposed new productive zone. If proposal is to drill or deepen directionally, give pertinent data on subsurface locations and measured and true vertical depths. Give blowout preventer program, if any.

24. SIGNED A. G. Bisco TITLE Drilling Clerk DATE March 18, 1974

(This space for Federal or State office use)

PERMIT NO. \_\_\_\_\_ APPROVAL DATE \_\_\_\_\_

APPROVED BY [Signature] TITLE \_\_\_\_\_ DATE \_\_\_\_\_

CONDITIONS OF APPROVAL, IF ANY:

**NEW MEXICO OIL CONSERVATION COMMISSION  
WELL LOCATION AND ACREAGE DEDICATION PLAT**

Form C-102  
Supersedes C-128  
Effective 1-1-65

All distances must be from the outer boundaries of the Section.

Operator <b>EL PASO NATURAL GAS COMPANY</b>		Lease <b>SAN JUAN 27-4 UNIT (SF-080673)</b>		Well No. <b>95</b>
Unit Letter <b>G</b>	Section <b>8</b>	Township <b>27-N</b>	Range <b>4-W</b>	County <b>RIO ARriba</b>
Actual Footage Location of Well: <b>1550</b> feet from the <b>NORTH</b> line and <b>1717</b> feet from the <b>EAST</b> line				
Ground Level Elev. <b>6968</b>	Producing Formation <b>DAKOTA</b>	Pool <b>BASIN DAKOTA</b>	Dedicated Acreage: <b>320.00</b> Acres	

1. Outline the acreage dedicated to the subject well by colored pencil or hachure marks on the plat below.
2. If more than one lease is dedicated to the well, outline each and identify the ownership thereof (both as to working interest and royalty).
3. If more than one lease of different ownership is dedicated to the well, have the interests of all owners been consolidated by communitization, unitization, force-pooling, etc?

Yes  No If answer is "yes," type of consolidation unitization

If answer is "no," list the owners and tract descriptions which have actually been consolidated. (Use reverse side of this form if necessary.) \_\_\_\_\_

No allowable will be assigned to the well until all interests have been consolidated (by communitization, unitization, forced-pooling, or otherwise) or until a non-standard unit, eliminating such interests, has been approved by the Commission.

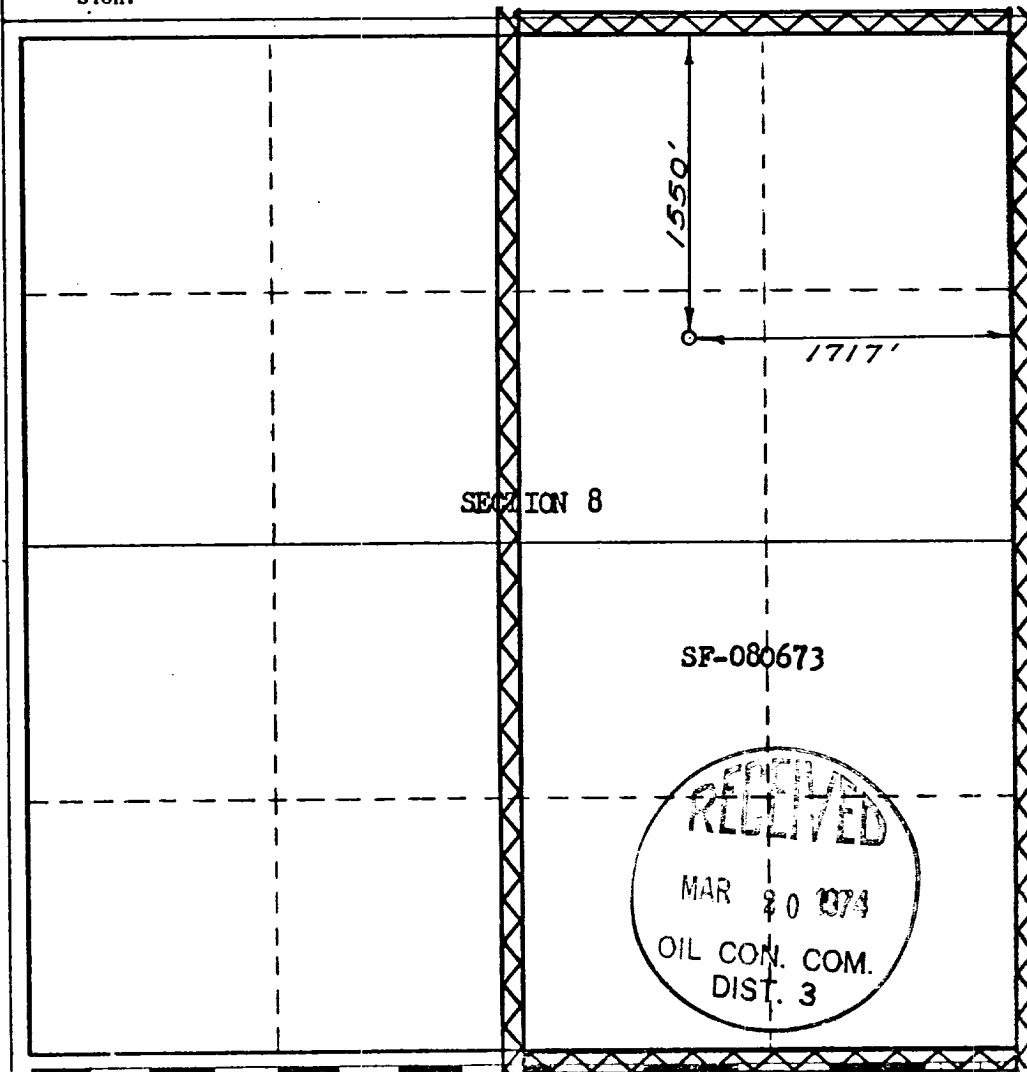

<b>CERTIFICATION</b>	
I hereby certify that the information contained herein is true and complete to the best of my knowledge and belief. Original Signed by <b>D. G. Brisco</b>	
Name	<b>D. G. Brisco</b>
Position	<b>Surveyor</b>
Company	<b>El Paso Natural Gas Co.</b>
Date	<b>October 8, 1968</b>
I hereby certify that the well location shown on this plat was plotted from field notes of actual surveys made by me or under my supervision, and that the same is true and correct to the best of my knowledge and belief.	
Date Surveyed	<b>OCTOBER 8, 1968</b>
Registered Professional Engineer and/or Land Surveyor <i>Daniel O'Neil</i>	
Certificate No.	<b>1760</b>

0 330 660 990 1320 1650 1980 2310 2640 2000 1500 1000 500 0

SAN JUAN 27-4 UNIT 95  
SWNE/4 SECTION 8, T-27-N, R-4-W

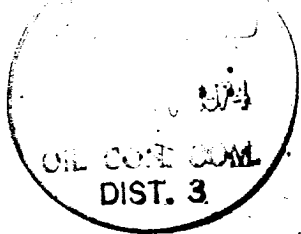
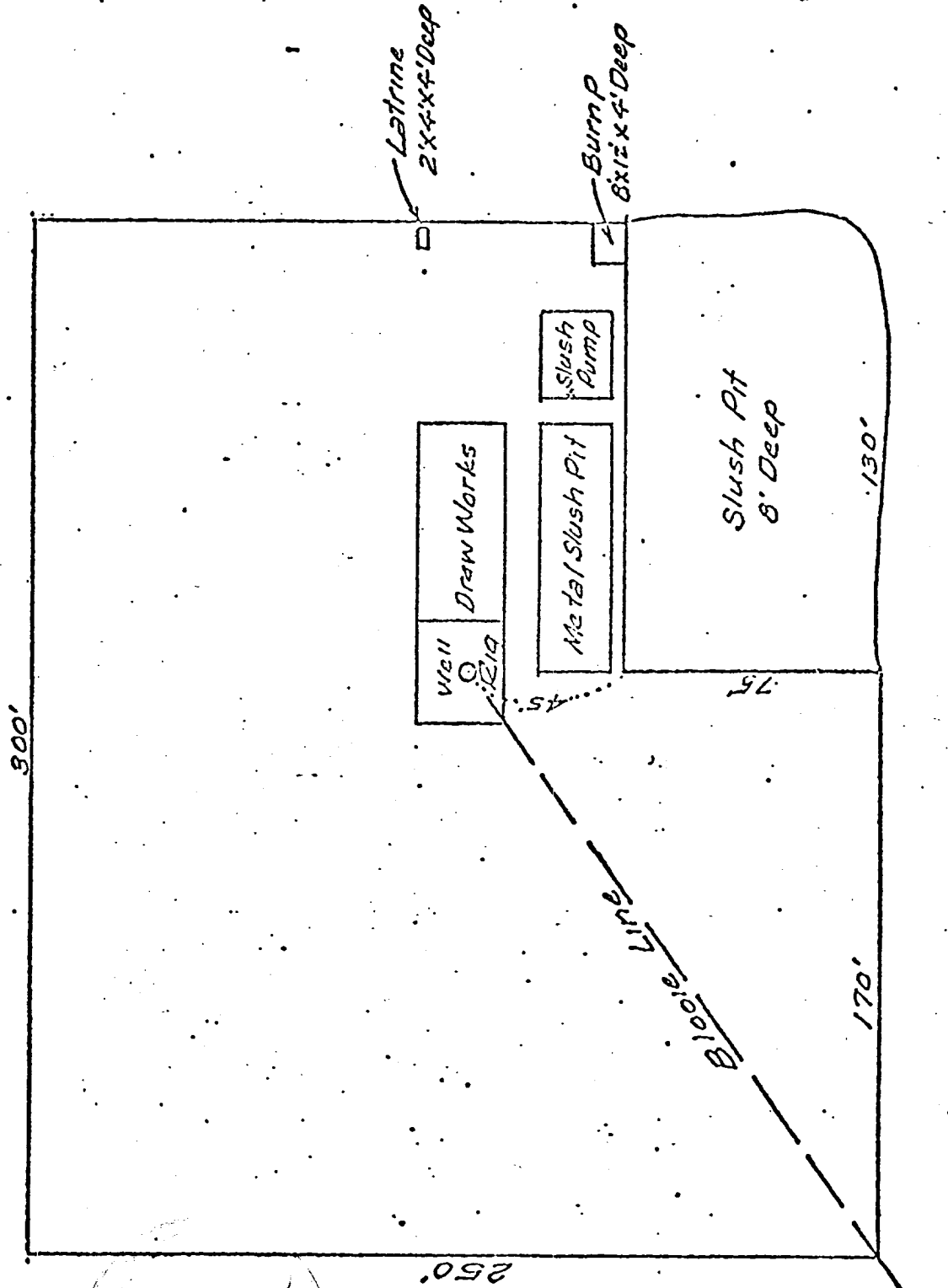
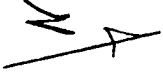

San Juan 27-4 Unit # 95  
 27 2 1/4 Sec. 8, T-27-N, R-4-W

R-4-W

J  
 27  
 17

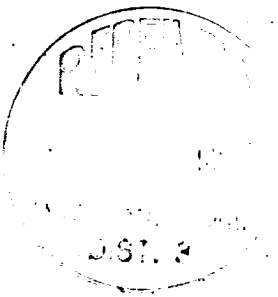
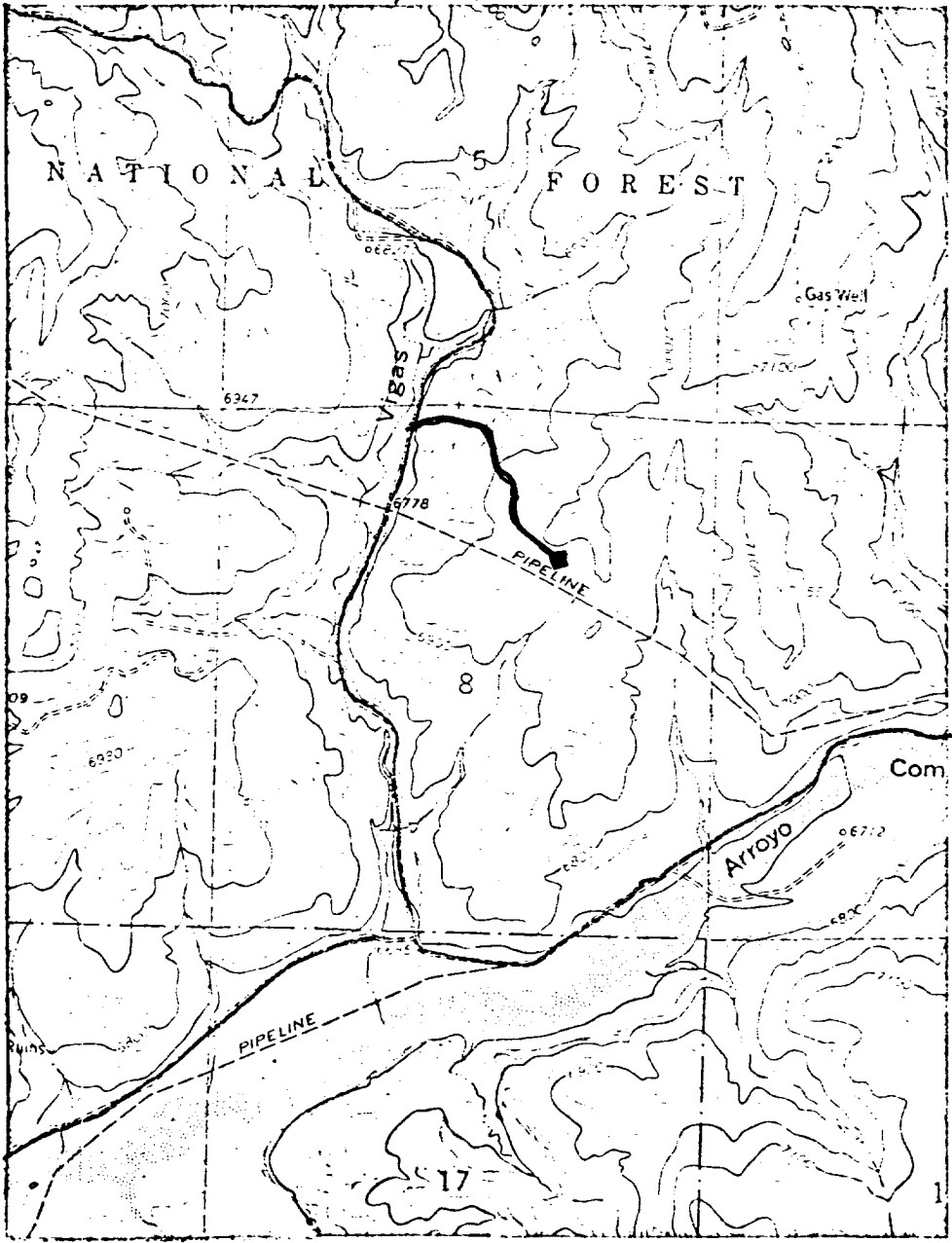

LEGEND OF RIGHT-OF-WAYS

- EXISTING ROADS ————
- EXISTING PIPELINES - + + +
- EXISTING ROAD & PIPELINE - + + +
- PROPOSED ROADS ————
- PROPOSED PIPELINES - + + + +
- PROPOSED ROAD & PIPELINE - + + +