

# El Paso Natural Gas Company

El Paso, Texas 79974

March 29, 1974

ADDRESS REPLY TO  
POST OFFICE BOX 990  
FARMINGTON, NEW MEXICO 87401

Mr. Jerry Long  
U. S. Geological Survey  
Post Office Box 1809  
Durango, Colorado 81301

Re: Application for Permit to Drill  
San Juan 28-6 Unit #203  
NE/4 Section 7, T-27-N, R6-W  
Basin Dakota

Dear Mr. Long:

Details regarding existing roads, pipelines, wells, etc. relative to the above well location are included on the previously submitted base maps, "Field Road Map" and "Composite Map No. 1".

The proposed new well location, new roads and new pipeline are shown on the attached plat along with connecting existing roads and pipelines in the vicinity of the proposed new well.

Water for drilling and completion operations will be obtained from the following location: water hole located in Section 10, T-27-N, R-6-W.

Waste material will be disposed of by burial in the burn pit, latrine, or reserve pit as applicable. There will be no camp nor air strip associated with drilling this well. Upon completion or abandonment of this well, the location will be cleaned and leveled and a dry hole marker placed, if applicable.

Yours very truly,

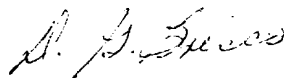

D. G. Brisco  
Drilling Clerk

pb



24

UNITED STATES  
DEPARTMENT OF THE INTERIOR  
GEOLOGICAL SURVEY

30-039-20847

5. LEASE DESIGNATION AND SERIAL NO.

NM 03583

6. IF INDIAN, ALLOTTEE OR TRIBE NAME

7. UNIT AGREEMENT NAME

San Juan 28-6 Unit

8. FARM OR LEASE NAME

San Juan 28-6 Unit

9. WELL NO.

203

10. FIELD AND POOL, OR WILDCAT

Basin Dakota

11. SEC., T., R. M., OR BLK.  
AND SURVEY OR AREASec. 7, T-27-N, R-6-W  
NMMPM

12. COUNTY OR PARISH

Rio Arriba

13. STATE

NM

## APPLICATION FOR PERMIT TO DRILL, DEEPEN, OR PLUG BACK

1A. TYPE OF WORK

DRILL ☒DEEPEN ☐PLUG BACK ☐

B. TYPE OF WELL

OIL  
WELL ☐GAS  
WELL ☒

OTHER

SINGLE  
ZONE ☒MULTIPLE  
ZONE ☐

2. NAME OF OPERATOR

El Paso Natural Gas Company

3. ADDRESS OF OPERATOR

PO Box 990, Farmington, NM 87401

4. LOCATION OF WELL (Report location clearly and in accordance with any State requirements.)\*  
At surface

1470'N, 1688'E

At proposed prod. zone

14. DISTANCE IN MILES AND DIRECTION FROM NEAREST TOWN OR POST OFFICE\*

15. DISTANCE FROM PROPOSED\*

LOCATION TO NEAREST  
PROPERTY OR LEASE LINE, FT.  
(Also to nearest drlg. unit line, if any)

16. NO. OF ACRES IN LEASE

17. NO. OF ACRES ASSIGNED  
TO THIS WELL

320.00

18. DISTANCE FROM PROPOSED LOCATION\*  
TO NEAREST WELL, DRILLING, COMPLETED,  
OR APPLIED FOR, ON THIS LEASE, FT.

19. PROPOSED DEPTH

7510'

20. ROTARY OR CABLE TOOLS

Rotary

21. ELEVATIONS (Show whether DF, RT, GR, etc.)

6359'GL

22. APPROX. DATE WORK WILL START\*

23. PROPOSED CASING AND CEMENTING PROGRAM

SIZE OF HOLE	SIZE OF CASING	WEIGHT PER FOOT	SETTING DEPTH	QUANTITY OF CEMENT
13 3/4"	9 5/8"	32.3#	200'	225 cu. ft. to circulate
8 3/4"	7"	20.0#	3300'	230 cu. ft. to cover Ojo Alamo
6 1/4"	4 1/2"	10.5#&11.6#	7510'	640 cu. ft. to fill to 3300'

Selectively perforate and sandwater fracture the Dakota formation.

The E/2 of Section 7 is dedicated to this well.



IN ABOVE SPACE DESCRIBE PROPOSED PROGRAM: If proposal is to deepen or plug back, give data on present productive zone and proposed new productive zone. If proposal is to drill or deepen directionally, give pertinent data on subsurface locations and measured and true vertical depths. Give blowout preventer program, if any.

24.

SIGNED

TITLE

Drilling Clerk

DATE

March 29, 1974

(This space for Federal or State office use)

PERMIT NO.

APPROVAL DATE

APPROVED BY

TITLE

DATE

CONDITIONS OF APPROVAL, IF ANY:

\*See Instructions On Reverse Side

**N MEXICO OIL CONSERVATION COMMISSION**  
**WELL LOCATION AND ACREAGE DEDICATION PLAT**

Form C-102  
 Supersedes C-128  
 Effective 1-1-65

All distances must be from the outer boundaries of the Section.

Operator <b>EL PASO NATURAL GAS COMPANY</b>			Lease <b>SAN JUAN 28-6 UNIT (NM-03583)</b>		Well No. <b>203</b>
Unit Letter <b>G</b>	Section <b>7</b>	Township <b>27-N</b>	Range <b>6-W</b>	County <b>RIO ARriba</b>	
Actual Footage Location of Well: <b>1470</b> feet from the <b>NORTH</b> line and <b>1688</b> feet from the <b>EAST</b> line					
Ground Level Elev. <b>6359</b>	Producing Formation <b>DAKOTA</b>	Pool <b>BASIN DAKOTA</b>		Dedicated Acreage: <b>320.00</b> Acres	

1. Outline the acreage dedicated to the subject well by colored pencil or hachure marks on the plat below.
2. If more than one lease is dedicated to the well, outline each and identify the ownership thereof (both as to working interest and royalty).
3. If more than one lease of different ownership is dedicated to the well, have the interests of all owners been consolidated by communitization, unitization, force-pooling, etc?

☐ Yes ☐ No If answer is "yes," type of consolidation unitization

If answer is "no," list the owners and tract descriptions which have actually been consolidated. (Use reverse side of this form if necessary.) \_\_\_\_\_

No allowable will be assigned to the well until all interests have been consolidated (by communitization, unitization, forced-pooling, or otherwise) or until a non-standard unit, eliminating such interests, has been approved by the Commission.

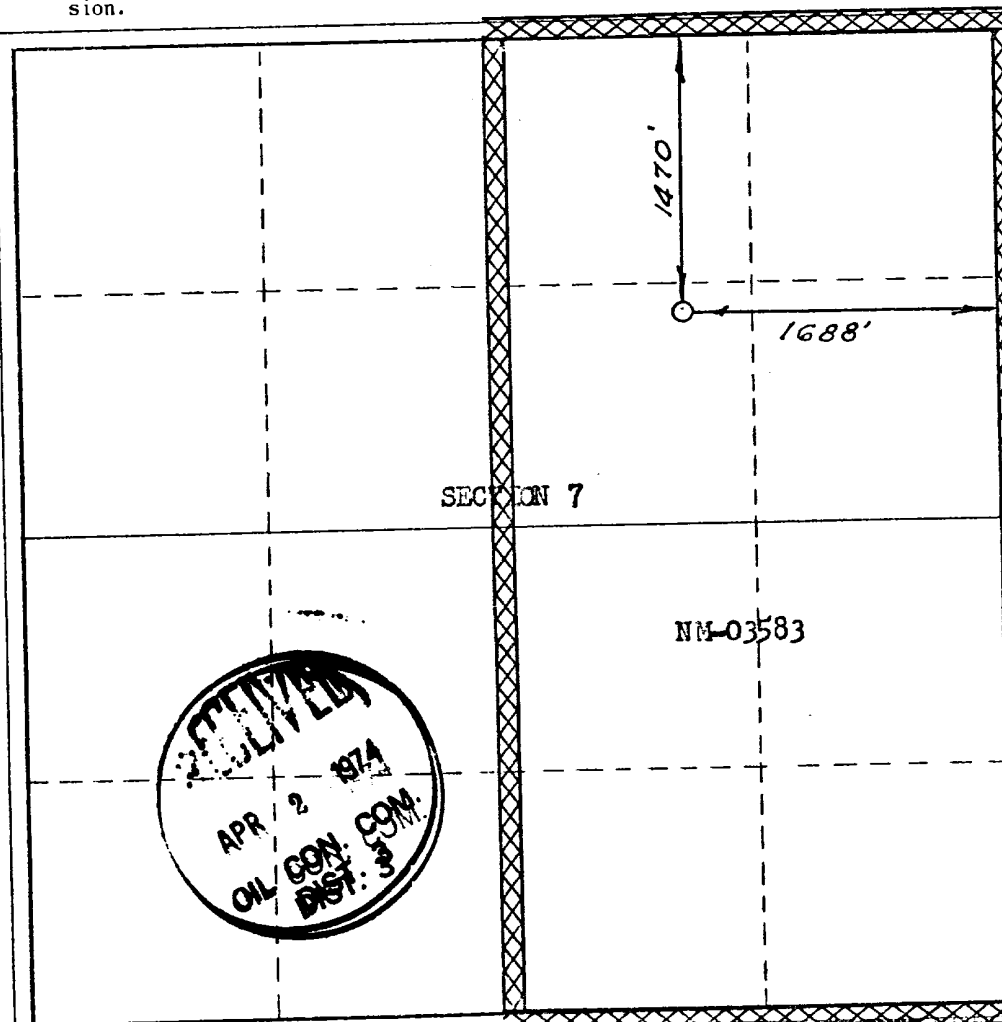

**CERTIFICATION**

I hereby certify that the information contained herein is true and complete to the best of my knowledge and belief.

Original Signed by

Name **O. G. Brisco**  
 Position **Oilman, Clerk**  
 Company **El Paso Natural Gas Co.**  
 Date \_\_\_\_\_

I hereby certify that the well location shown on this plat was plotted from field notes of actual surveys made by me or under my supervision, and that the same is true and correct to the best of my knowledge and belief.

Date Surveyed  
**MARCH 7, 1974**

Registered Professional Engineer and/or Land Surveyor

*[Signature]*  
 Certificate No. **1760**

0 330 660 990 1320 1650 1980 2310 2640 2000 1500 1000 500 0

Site Plan Unit 10, 203  
April 2, 1974, 10:45-11

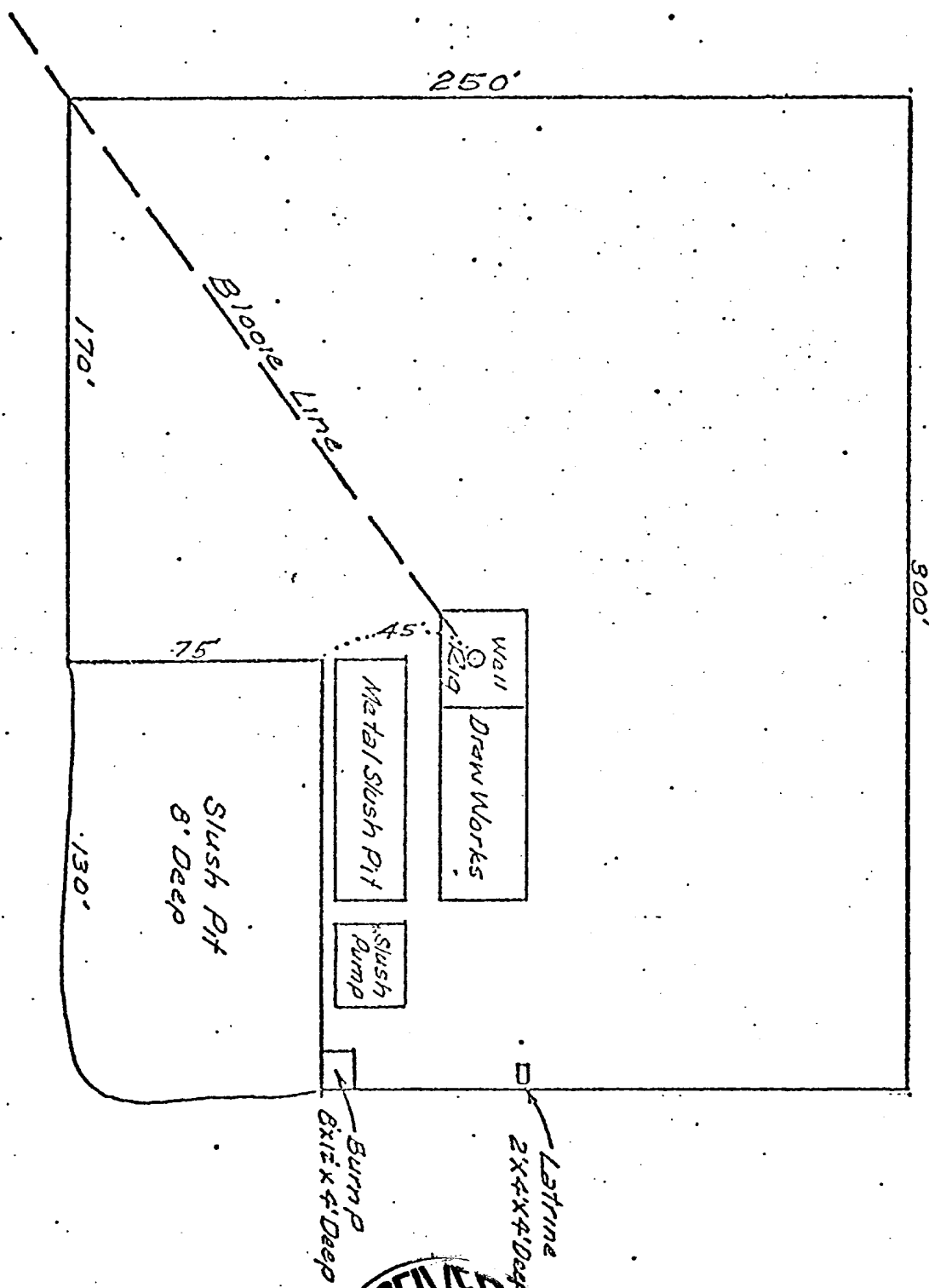

**RECEIVED**  
APR 2 1974  
OIL CON. COM.  
DIST. 3

San Juan 28.6 Unit # 203  
 24 1/2 Sec. 9, T. 27 N. R. 6 W

R. 6 W

27  
 7

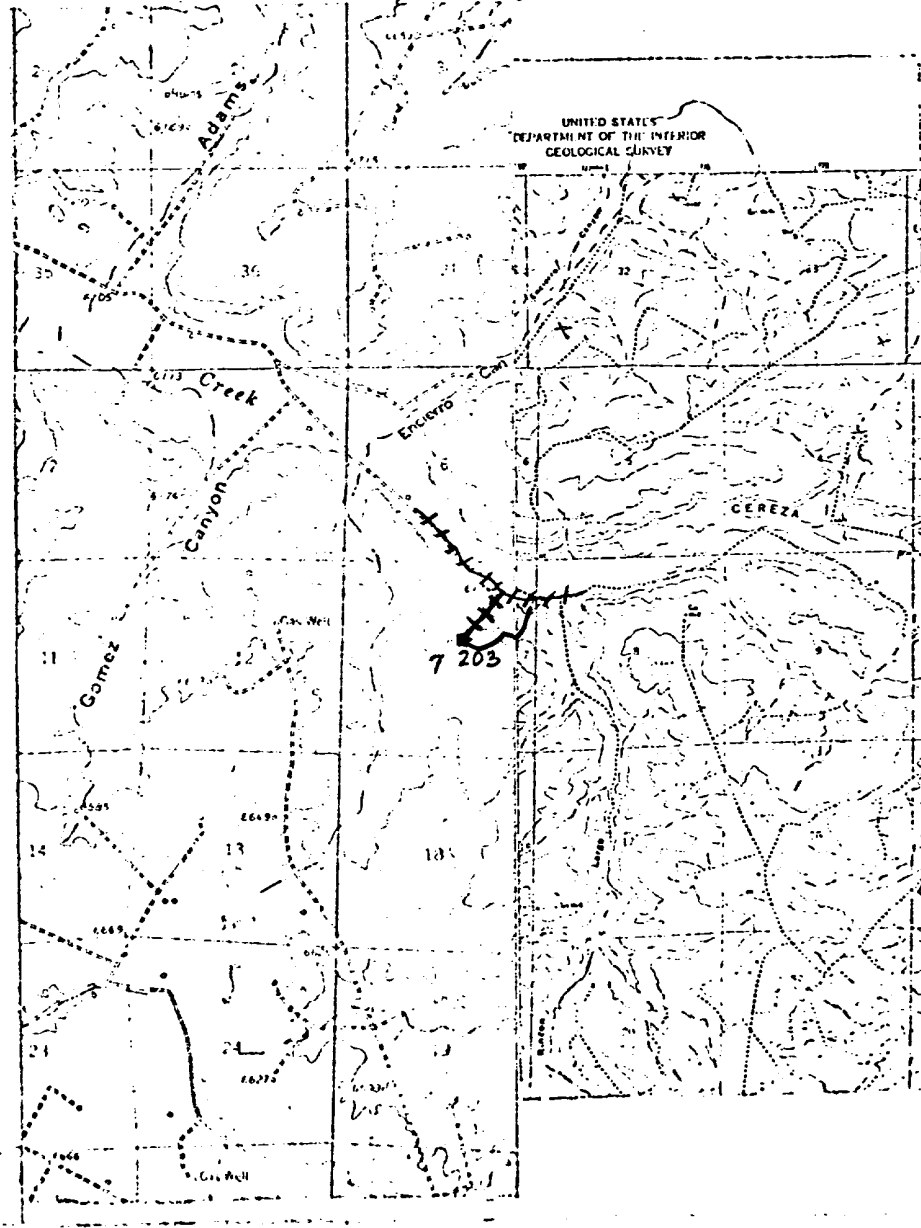

LEGEND OF RIGHT-OF-WAYS

- EXISTING ROADS —————
- EXISTING PIPELINES - - - - -
- EXISTING ROAD & PIPELINE - - - - -
- PROPOSED ROADS —————
- PROPOSED PIPELINES + + + + +
- PROPOSED ROAD & PIPELINE + + + + +