

NO. OF COPIES RECEIVED	
DISTRIBUTION	
SANTA FE	1
FILE	1
U.S.G.S.	2
LAND OFFICE	1
OPERATOR	1

# NEW MEXICO OIL CONSERVATION COMMISSION

Form C-101  
Revised 14-65

20892  
30-039-20492

APPLICATION FOR PERMIT TO DRILL, DEEPEN, OR PLUG BACK			
1a. Type of Work DRILL <input checked="" type="checkbox"/> DEEPEN <input type="checkbox"/> PLUG BACK <input type="checkbox"/>		5A. Indicate Type of Lease STATE <input checked="" type="checkbox"/> FEE <input type="checkbox"/>	
b. Type of Well OIL WELL <input type="checkbox"/> GAS WELL <input checked="" type="checkbox"/> OTHER <input type="checkbox"/>		5. State Oil & Gas Lease No. E-290-13	
2. Name of Operator El Paso Natural Gas Company		7. Unit Agreement Name San Juan 28-6 Unit	
3. Address of Operator PO Box 990, Farmington, NM 87401		8. Farm or Lease Name San Juan 28-6 Unit	
4. Location of Well UNIT LETTER O LOCATED 815 FEET FROM THE South LINE AND 1710 FEET FROM THE East LINE OF SEC. 2 TWP. 27N RGE 6W NMPM		9. Well No. 189	
		10. Field and Pool, or Wildcat So. Blanco Pictured Cliffs	
		12. County Rio Arriba	
		19. Proposed Depth 3560'	
		19A. Formation Pictured Cliffs	
		20. Rotary or C.T. Rotary	
21. Elevations (Show whether DF, RT, etc.) 6663' GL		21A. Kind & Status Plug. Bond Statewide	
		21B. Drilling Contractor	
		22. Approx. Date Work will start	

23. PROPOSED CASING AND CEMENT PROGRAM					
SIZE OF HOLE	SIZE OF CASING	WEIGHT PER FOOT	SETTING DEPTH	SACKS OF CEMENT	EST. TOP
12 1/4"	8 5/8"	24.0#	120'	112 cu. ft.	circ. to surface
6 3/4"	2 7/8"	6.4#	3560'	272 cu. ft.	2668'

Selectively perforate and sandwater fracture the Pictured Cliffs formation.

The SE/4 of Section 2 is dedicated to this well.

APPROVAL VALID  
FOR 90 DAYS UNLESS  
DRILLING COMMENCED,  
EXPIRES 7-30-74



IN ABOVE SPACE DESCRIBE PROPOSED PROGRAM: IF PROPOSAL IS TO DEEPEN OR PLUG BACK, GIVE DATA ON PRESENT PRODUCTIVE ZONE AND PROPOSED NEW PRODUCTIVE ZONE. GIVE BLOWOUT PREVENTER PROGRAM, IF ANY.

I hereby certify that the information above is true and complete to the best of my knowledge and belief.

Signed A. G. Durio Title Drilling Clerk Date April 30, 1974

(This space for State Use)

APPROVED BY A. G. Durio TITLE PETROLEUM ENGINEER DIST. NO. 3 DATE MAY 1 1974  
CONDITIONS OF APPROVAL, IF ANY:

**NEW MEXICO OIL CONSERVATION COMMISSION  
WELL LOCATION AND ACREAGE DEDICATION PLAT**

Form C-102  
Supersedes C-128  
Effective 1-1-65

All distances must be from the outer boundaries of the Section.

Operator <b>EL PASO NATURAL GAS COMPANY</b>			Lease <b>SAN JUAN 28-6 UNIT (E-290-13)</b>		Well No. <b>189</b>
Unit Letter <b>0</b>	Section <b>2</b>	Township <b>27 NORTH</b>	Range <b>6 WEST</b>	County <b>RIO ARriba</b>	
Actual Footage Location of Well: <div style="display: flex; justify-content: space-between;"> <span><b>815</b> feet from the <b>SOUTH</b> line and</span> <span><b>1710</b> feet from the <b>EAST</b> line</span> </div>					
Ground Level Elev. <b>6663</b>	Producing Formation <b>PICTURED CLIFFS</b>	Pool <b>SO. BLANCO PICTURED CLIFFS</b>	Dedicated Acreage: <b>160.00</b> Acres		

1. Outline the acreage dedicated to the subject well by colored pencil or hachure marks on the plat below.
2. If more than one lease is dedicated to the well, outline each and identify the ownership thereof (both as to working interest and royalty).
3. If more than one lease of different ownership is dedicated to the well, have the interests of all owners been consolidated by communitization, unitization, force-pooling, etc?

☒ Yes    ☐ No    If answer is "yes," type of consolidation Unitization

If answer is "no," list the owners and tract descriptions which have actually been consolidated. (Use reverse side of this form if necessary.) \_\_\_\_\_

No allowable will be assigned to the well until all interests have been consolidated (by communitization, unitization, forced-pooling, or otherwise) or until a non-standard unit, eliminating such interests, has been approved by the Commission.

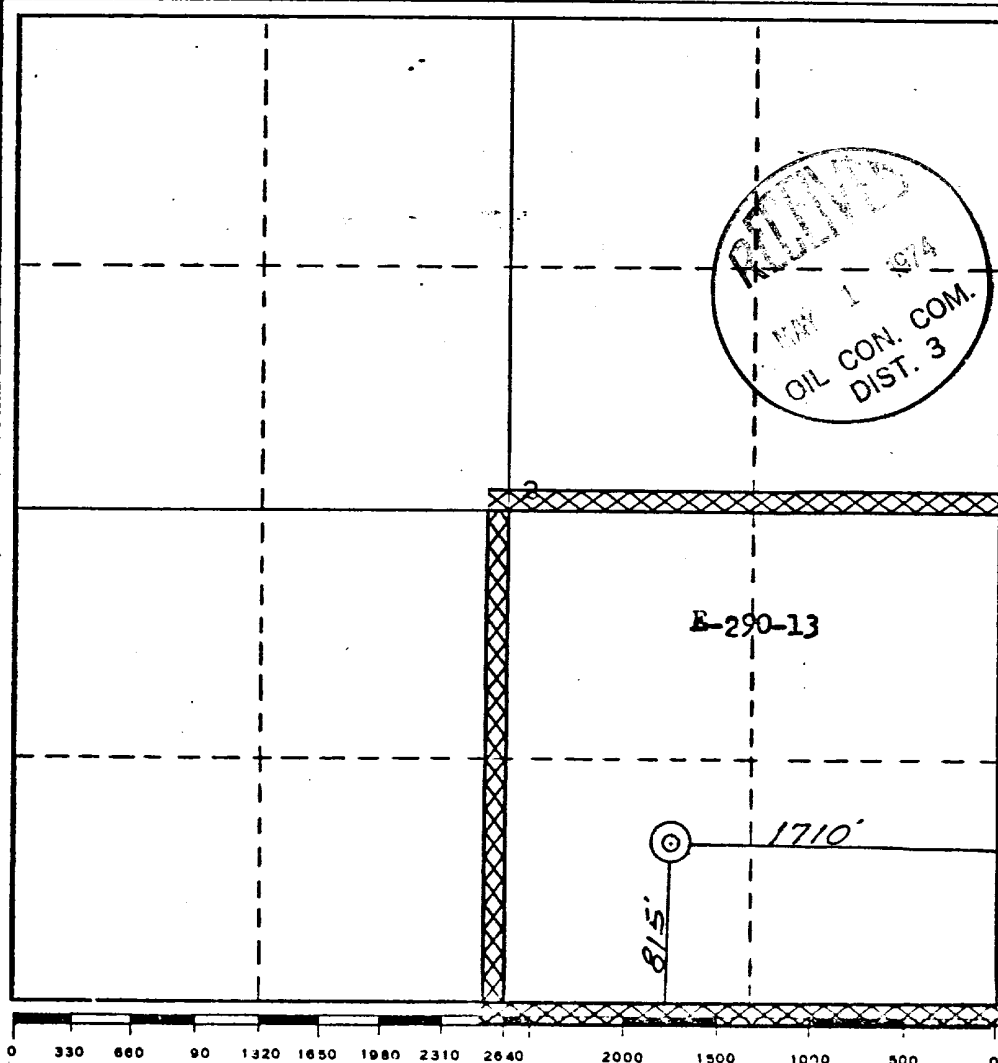

**CERTIFICATION**

I hereby certify that the information contained herein is true and complete to the best of my knowledge and belief.

*A. G. Arico*  
 Name \_\_\_\_\_  
 Position **Drilling Clerk**  
 Company **El Paso Natural Gas Co.**  
 Date **April 30, 1974**

I hereby certify that the well location shown on this plat was plotted from field notes of actual surveys made by me or under my supervision, and that the same is true and correct to the best of my knowledge and belief.

*James P. Lane*  
 Date **19 March 1974**  
 Registered Professional Engineer  
 and/or Professional Surveyor  
 State of New Mexico  
 Certificate No. **14803**

0 330 660 990 1320 1650 1980 2310 2640 2000 1500 1000 500 0