

OIL CONSERVATION COMMISSION
DISTRICT

OIL CONSERVATION COMMISSION
BOX 2088
SANTA FE, NEW MEXICO

DATE 11-11-74

RE: Proposed MC _____
Proposed DHC ✓ _____
Proposed NSL _____
Proposed SWD _____
Proposed WFX _____
Proposed PMX _____

Gentlemen:

I have examined the application dated 11-5-74
for the El Paso Nat. Gas Co SJO 27-4-133 U. 27-27N-4W
Operator Lease and Well No. Unit, S-T-R

and my recommendations are as follows:

Logography has been verified. approve

Yours very truly,

Curry C. United

El Paso Natural Gas Company

El Paso, Texas 79978

November 5, 1974

ADDRESS REPLY TO
POST OFFICE BOX 980
FARMINGTON NEW MEXICO 87401

Mr. A. L. Porter, Secretary and Director
New Mexico Oil Conservation Commission
Post Office Box 2088
Santa Fe, New Mexico 87501

Dear Mr. Porter:

This is a request for administrative approval for an unorthodox gas well location in the Basin Dakota pool. Terrain features make an orthodox location and access road expensive to build and maintain.

It is intended to locate the El Paso Natural Gas Company San Juan 27-4 Unit #133 2335' from the South line and 2225' from the West line of Section 27, T-27-N, R-4-W, NMPM, Rio Arriba County, New Mexico. The West half of Section 27 is dedicated to this well.

The terrain in the West half of Section 27 is very rough. An orthodox location would require an access road with a greater than 12% grade which would be expensive to build and to maintain. Maintenance would be expensive because of erosional problems encountered in roads with this steep of a grade. For these reasons it is requested that the unorthodox location be approved.

All of the offsetting proration units are included in units of which El Paso Natural Gas Company is the operator.

Plats showing the proposed well location with terrain features and operator of offset leases are attached.

Yours truly,

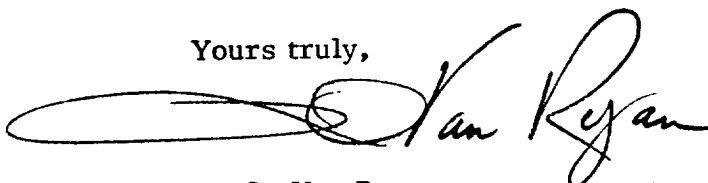

L. O. Van Ryan
Senior Petroleum Engineer

LOVR:pb

cc: Emery Arnold with attachments
Jim Permenter with attachments
Jerry Long with attachments

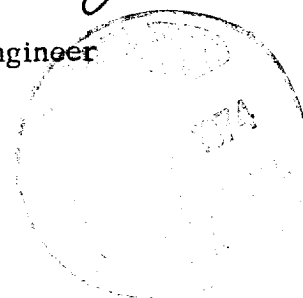

R 4 W

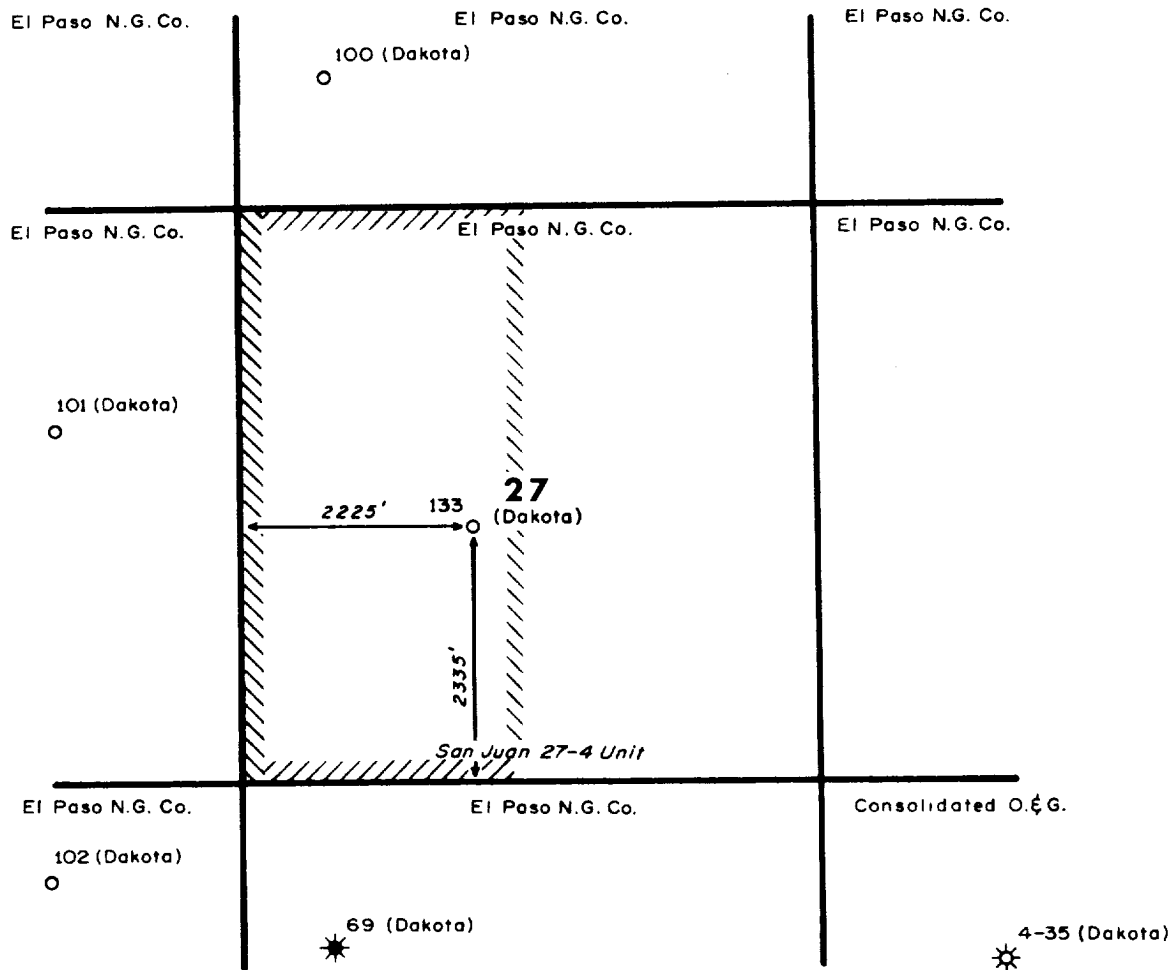

					ENG. REC.		DATE		<p>El Paso Natural Gas Company</p> <p>DAKOTA OWNERSHIP</p> <p>Offsetting E.P.N.G. #133 San Juan 27-4 Unit, S27-27N-4W</p> <p>Rio Arriba Co., New Mexico</p>				
					DRAWN		J.H.					10-29-74	
					CHECKED								
					CHECKED								
					PROJ. APP.								
PRT.	SEP.	DATE	TO	W.O.	DESIGN				SCALE: 3" = 1 mi.		DWG. NO.	REV.	
PRINT RECORD					W.O.								

El Paso Natural Gas Company

El Paso, Texas 79978

November 5, 1974

ADDRESS REPLY TO
POST OFFICE BOX 890
FARMINGTON, NEW MEXICO 87401

Mr. Jerry Long
U. S. Geological Survey
Post Office Box 1809
Durango, Colorado 81301

Re: Application for Permit to Drill
San Juan 27-4 Unit #133
SW/4 Section 27, T-27-N, R-4-W
Basin Dakota

Dear Mr. Long:

Details regarding existing roads, pipelines, wells, etc. relative to the above well location are included on the previously submitted base maps, "Field Road Map" and "Composite Map No. 1".

The proposed new well location, new roads and new pipeline are shown on the attached plat along with connecting existing roads and pipelines in the vicinity of the proposed new well.

Water for drilling and completion operations will be obtained from the following location: a water hole located in the SE/4 Section 18, T-27-N, R-4-W.

Waste material will be disposed of by burial in the burn pit, latrine, or reserve pit as applicable. There will be no camp nor air strip associated with drilling this well. Upon completion or abandonment of this well, the location will be cleaned and leveled and a dry hole marker placed, if applicable.

Yours very truly,

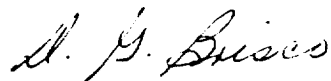

D. G. Brisco
Drilling Clerk

pb



UNITED STATES
DEPARTMENT OF THE INTERIOR
GEOLOGICAL SURVEY

APPLICATION FOR PERMIT TO DRILL, DEEPEN, OR PLUG BACK

1a. TYPE OF WORK

DRILL ☒DEEPEN ☐PLUG BACK ☐

b. TYPE OF WELL

OIL
WELL ☐GAS
WELL ☒

OTHER

SINGLE
ZONE ☒MULTIPLE
ZONE ☐

2. NAME OF OPERATOR

El Paso Natural Gas Company

3. ADDRESS OF OPERATOR

PO Box 990, Farmington, NM 87401

4. LOCATION OF WELL (Report location clearly and in accordance with any State requirements.)*
At surface

2335'S, 2225'W

At proposed prod. zone

14. DISTANCE IN MILES AND DIRECTION FROM NEAREST TOWN OR POST OFFICE*

15. DISTANCE FROM PROPOSED*

LOCATION TO NEAREST
PROPERTY OR LEASE LINE, FT.
(Also to nearest drlg. unit line, if any)18. DISTANCE FROM PROPOSED LOCATION*
TO NEAREST WELL, DRILLING, COMPLETED,
OR APPLIED FOR, ON THIS LEASE, FT.

21. ELEVATIONS (Show whether DF, RT, GR, etc.)

7114'GR

16. NO. OF ACRES IN LEASE

19. PROPOSED DEPTH

8421'

17. NO. OF ACRES ASSIGNED
TO THIS WELL

320.00

20. ROTARY OR CABLE TOOLS

Rotary

22. APPROX. DATE WORK WILL START*

23.

PROPOSED CASING AND CEMENTING PROGRAM

SIZE OF HOLE	SIZE OF CASING	WEIGHT PER FOOT	SETTING DEPTH	QUANTITY OF CEMENT
13 3/8"	9 5/8"	32.3#	200'	224 cu. ft. to circulate
8 3/4"	7"	20.0#	4007'	110 cu. ft. to cover Ojo Alamo
6 1/4"	4 1/2"	10.5#&11.6#	8421'	600 cu. ft. to fill to 4007'

Selectively perforate and sandwater fracture the Dakota formation.

Forest approval has been secured.

The West half of Section 27 is dedicated to this well.

IN ABOVE SPACE DESCRIBE PROPOSED PROGRAM: If proposal is to deepen or plug back, give data on present productive zone and proposed new productive zone. If proposal is to drill or deepen directionally, give pertinent data on subsurface locations and measured and true vertical depths. Give blowout preventer program, if any.

24.

SIGNED

A. G. Davis

TITLE

Drilling Clerk

DATE

November 5, 1974

(This space for Federal or State office use)

PERMIT NO.

APPROVAL DATE

APPROVED BY

TITLE

DATE

CONDITIONS OF APPROVAL, IF ANY:

*See Instructions On Reverse Side

**NEW MEXICO OIL CONSERVATION COMMISSION
WELL LOCATION AND ACREAGE DEDICATION PLAT**

Form C-102
Supersedes C-128
Effective 1-1-65

All distances must be from the outer boundaries of the Section.

Operator El Paso Natural Gas Company			Lease San Juan 27-4 Unit (SF-080675)		Well No. 133
Unit Letter K	Section 27	Township 27N	Range 4W	County Rio Arriba	
Actual Footage Location of Well:					
2335 feet from the South line and		2225 feet from the West line			
Ground Level Elev. 7114	Producing Formation Dakota	Pool BASIN DAKOTA	Dedicated Acreage: 320.00 Acres		

1. Outline the acreage dedicated to the subject well by colored pencil or hatchure marks on the plat below.
2. If more than one lease is dedicated to the well, outline each and identify the ownership thereof (both as to working interest and royalty).
3. If more than one lease of different ownership is dedicated to the well, have the interests of all owners been consolidated by communitization, unitization, force-pooling, etc?

☒ Yes ☐ No If answer is "yes," type of consolidation Unitization

If answer is "no," list the owners and tract descriptions which have actually been consolidated. (Use reverse side of this form if necessary.) _____

No allowable will be assigned to the well until all interests have been consolidated (by communitization, unitization, forced-pooling, or otherwise) or until a non-standard unit, eliminating such interests, has been approved by the Commission.

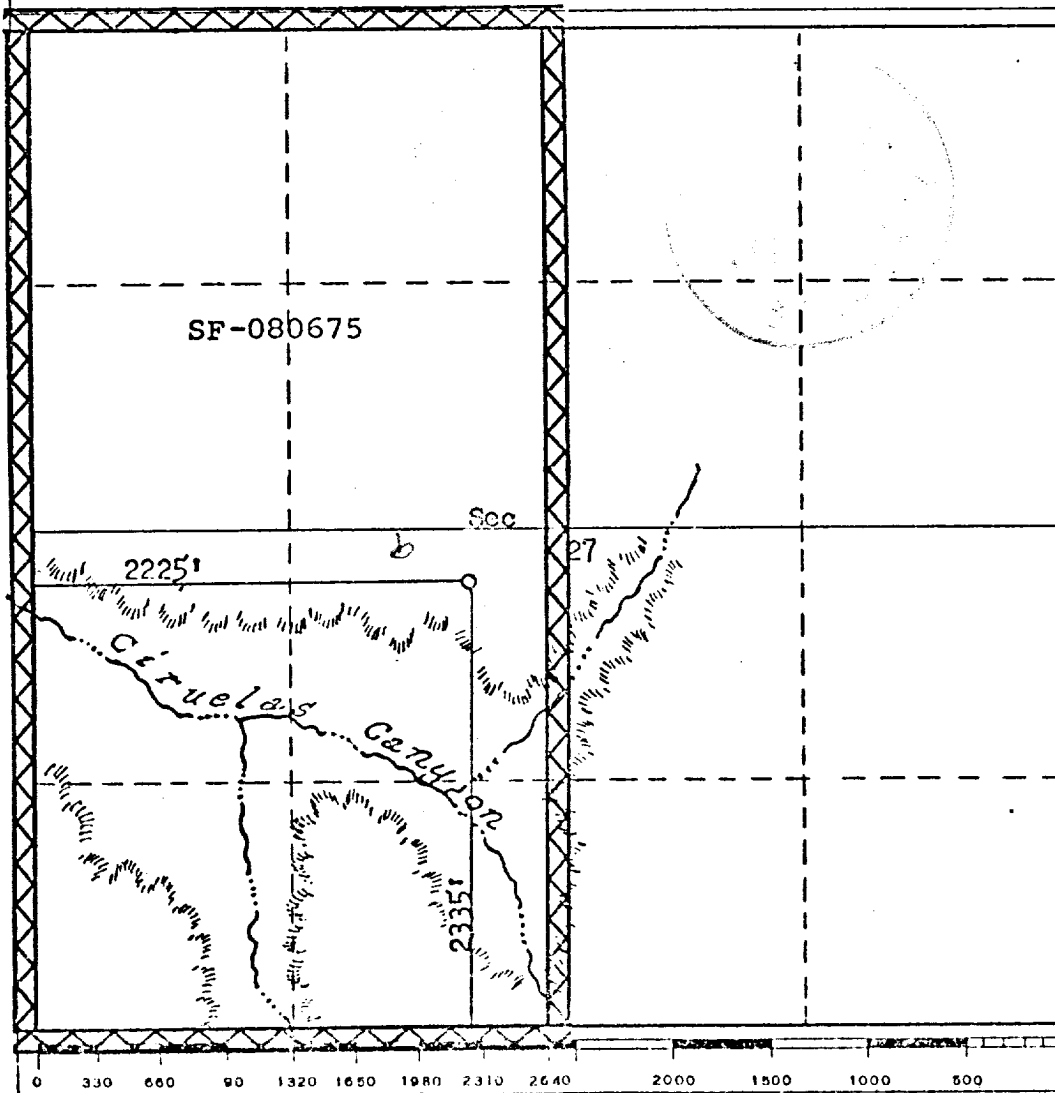

CERTIFICATION	
I hereby certify that the information contained herein is true and complete to the best of my knowledge and belief.	
<i>A. G. Success</i>	
Name	Drilling Clerk
Position	El Paso Natural Gas Co.
Company	November 5, 1974
Date	
I hereby certify that the well location shown on this plat was plotted from field notes of actual surveys made by me or under my supervision, and that the same is true and correct to the best of my knowledge and belief.	
Date Surveyed	April 27, 1974
Registered Professional Engineer and/or Land Surveyor	
<i>Fred B. Kern Jr.</i>	
Certificate No.	3950

Diep

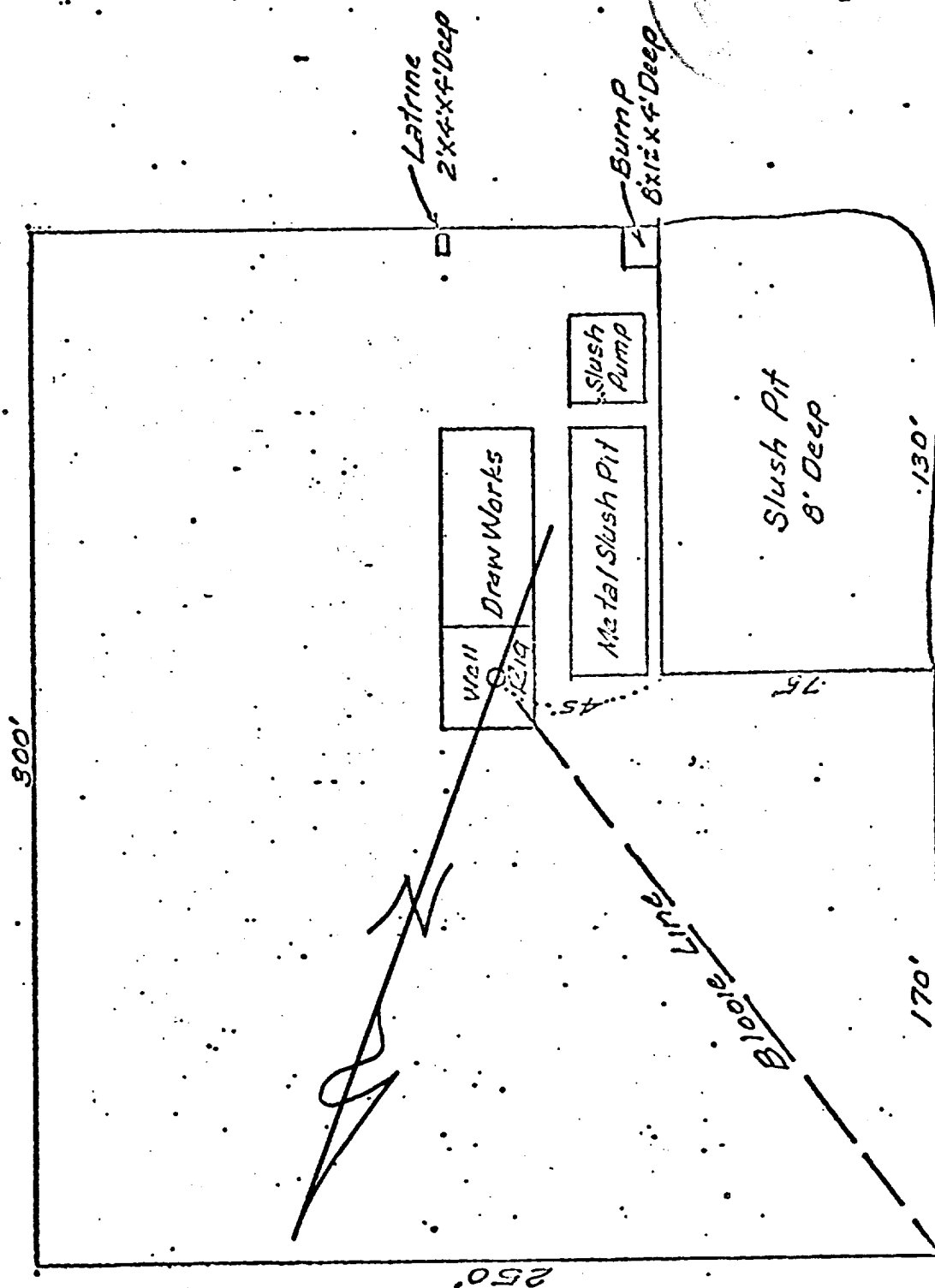

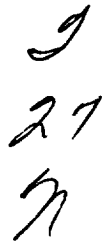

EXISTING ROADS	_____
EXISTING PIPELINES	++ ++ ++
EXISTING ROAD & PIPELINE	++ ++ ++
PROPOSED ROADS	_____
PROPOSED PIPELINES	++ ++ ++ ++
PROPOSED ROAD & PIPELINE	++ ++ ++ ++