

OIL CONSERVATION COMMISSION
AZTEC DISTRICT

OIL CONSERVATION COMMISSION
BOX 2088
SANTA FE, NEW MEXICO

DATE 8/22/78

RE: Proposed MC _____
Proposed DHC _____
Proposed NSL XXX _____
Proposed SWD _____
Proposed WFX _____
Proposed PMX _____

Dick Stamets

Gentlemen:

I have examined the application dated 8/17/78
for the El Paso Natural Gas Co. San Juan 27-4 Unit #133 K-27-27N-4W
Operator Lease and Well No. Unit, S-T-R

and my recommendations are as follows:

Approve for both pools - Basin-Dakota and Blanco-Mesaverde

Yours very truly,

AR Hendricks

El Paso NATURAL GAS
COMPANY

P. O. BOX 2088
FARMINGTON, NEW MEXICO 87401
PHONE: 505-325-2841

August 17, 1978

Mr. Joe Ramey
New Mexico Oil Conservation Commission
P. O. Box 2088
Santa Fe, New Mexico 87501

Dear Mr. Ramey:

This is a request for administrative approval for an unorthodox gas well location for a dual well in the Blanco Mesa Verde and Basin Dakota pools.

It is intended to locate the El Paso Natural Gas Company's San Juan 27-4 Unit No. 133 at 2335' from the South line and 2225' from the West line of Section 27, T 27 N, R 4 W, Rio Arriba County, New Mexico.

Approval was previously granted for this well in an unorthodox location in the Basin Dakota pool. It is now proposed to dually complete the well which requires approval for an unorthodox location in the Blanco Mesa Verde pool.

Rough terrain, consisting of steep canyon walls in the southwest corner of this section, makes it very difficult to build an orthodox gas well location with a usable access road.

El Paso Natural Gas Company is the only operator of proration units offsetting the proposed unorthodox location.

Plats showing the proposed well location and the terrain of Section 27, along with an ownership plat, are attached.

Very truly yours,

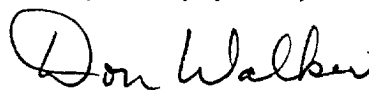

D. C. Walker
Project Drilling Engineer

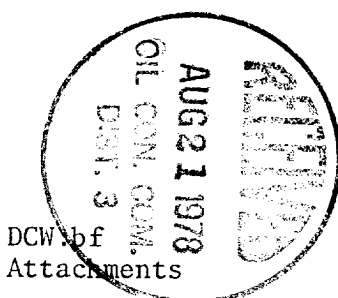

EL PASO NATURAL GAS COMPANY

Well Name San Juan 27-4 Unit #133
Mesaverde-Dakota

Footage-----2335' FSL, 2225' FWL

APPLICATION FOR NON-STANDARD LOCATION

County Rio Arriba State New Mexico Section 27 Township 27N Range 4W

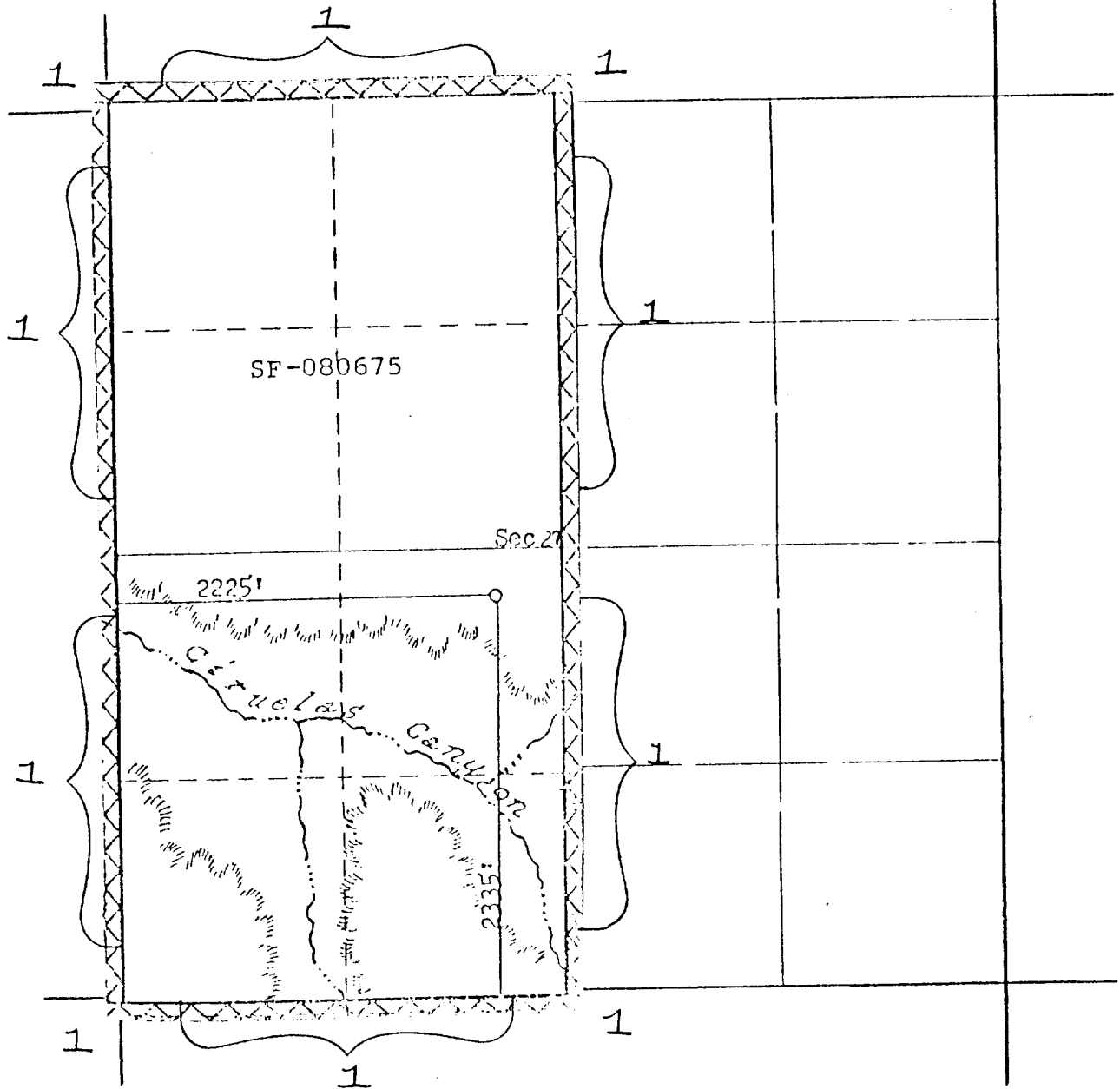

REMARKS:

(1) EL PASO NATURAL GAS COMPANY - SAN JUAN 27-4 UNIT

N MEXICO OIL CONSERVATION COMMISSION
WELL LOCATION AND ACREAGE DEDICATION PLAT

Form C-102
Supersedes C-128
Effective 1-1-65

All distances must be from the outer boundaries of the Section.

Operator El Paso Natural Gas Company			Lease San Juan 27-4 Unit (SF-030675)		Well No. 133
Unit Letter K	Section 27	Township 27N	Range 4W	County Rio Arriba	
Actual Footage Location of Well: 2335 feet from the South line and 2225 feet from the West line					
Ground Level Elev. 7114	Producing Formation Dakota & Mesa Verde		Pool Basin Dakota - Blanco Mesa Verde	Dedicated Acreage: 320.00 ± 320.00 acres	

1. Outline the acreage dedicated to the subject well by colored pencil or hatchure marks on the plat below.
2. If more than one lease is dedicated to the well, outline each and identify the ownership thereof (both as to working interest and royalty).
3. If more than one lease of different ownership is dedicated to the well, have the interests of all owners been consolidated by communitization, unitization, force-pooling, etc?

X

Unitization

☐ Yes ☐ No If answer is "yes," type of consolidation _____

If answer is "no," list the owners and tract descriptions which have actually been consolidated. (Use reverse side of this form if necessary.) _____

No allowable will be assigned to the well until all interests have been consolidated (by communitization, unitization, forced-pooling, or otherwise) or until a non-standard unit, eliminating such interests, has been approved by the Commission. NOTE: THIS PLAT IS REISSUED TO SHOW DUAL DEDICATION. 6-29-78

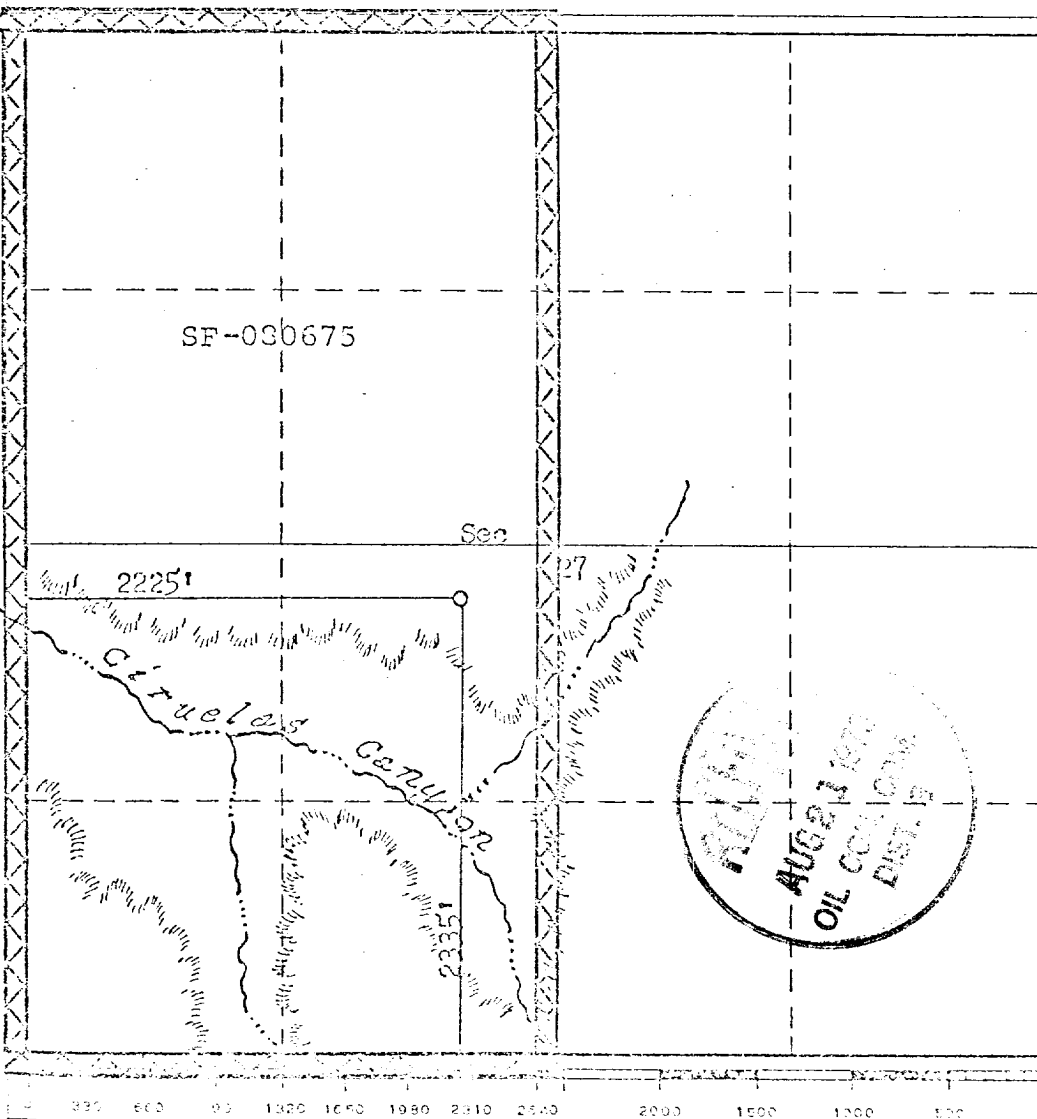

CERTIFICATION

I hereby certify that the information contained herein is true and complete to the best of my knowledge and belief.

M. G. Suces

Name
Drilling Clerk

Position
El Paso Natural Gas Co.

Company
August 9, 1978

Date

I hereby certify that the well location shown on this plat was plotted from field notes of actual surveys made by me or under my supervision, and that the same is true and correct to the best of my knowledge and belief.

Date Surveyed

April 2, 1974

Registered Professional Engineer and/or Licensed Surveyor

Fred N. Jones Jr.

Certificate No.

3950