

# El Paso Natural Gas Company

El Paso, Texas 79978

May 23, 1975

ADDRESS REPLY TO  
POST OFFICE BOX 990  
FARMINGTON NEW MEXICO 87401

Mr. Jerry Long  
U. S. Geological Survey  
Post Office Box 1809  
Durango, Colorado 81301

Re: Application for Permit to Drill  
San Juan 28-7 Unit #213  
NESE/4 Section 29, T-27-N, R-7-W  
Largo Chacra Ext.

Dear Mr. Long:

Details regarding existing roads, pipelines, wells, etc. relative to the above well location are included on the previously submitted base maps, "Field Road Map" and "Composite Map No. 1".

The proposed new well location, new roads and new pipeline are shown on the attached plat along with connecting existing roads and pipelines in the vicinity of the proposed new well.

Water for drilling and completion operations will be obtained from the following location: water well located in Section 15, T-27-N, R-7-W.

Waste material will be disposed of by burial in the burn pit, latrine, or reserve pit as applicable. There will be no camp nor air strip associated with drilling this well. Upon completion or abandonment of this well, the location will be cleaned and leveled and a dry hole marker placed, if applicable.

Yours very truly,

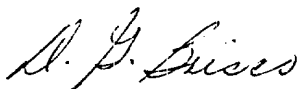

D. G. Brisco  
Drilling Clerk

pb

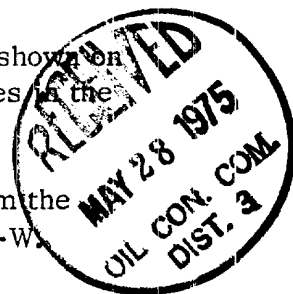

MAY 27 1975

LOCATION AND EQUIPMENT LAYOUT

SAN JUAN 28-7 # 213 (CHACRA)

SE/4 - 29-27-7

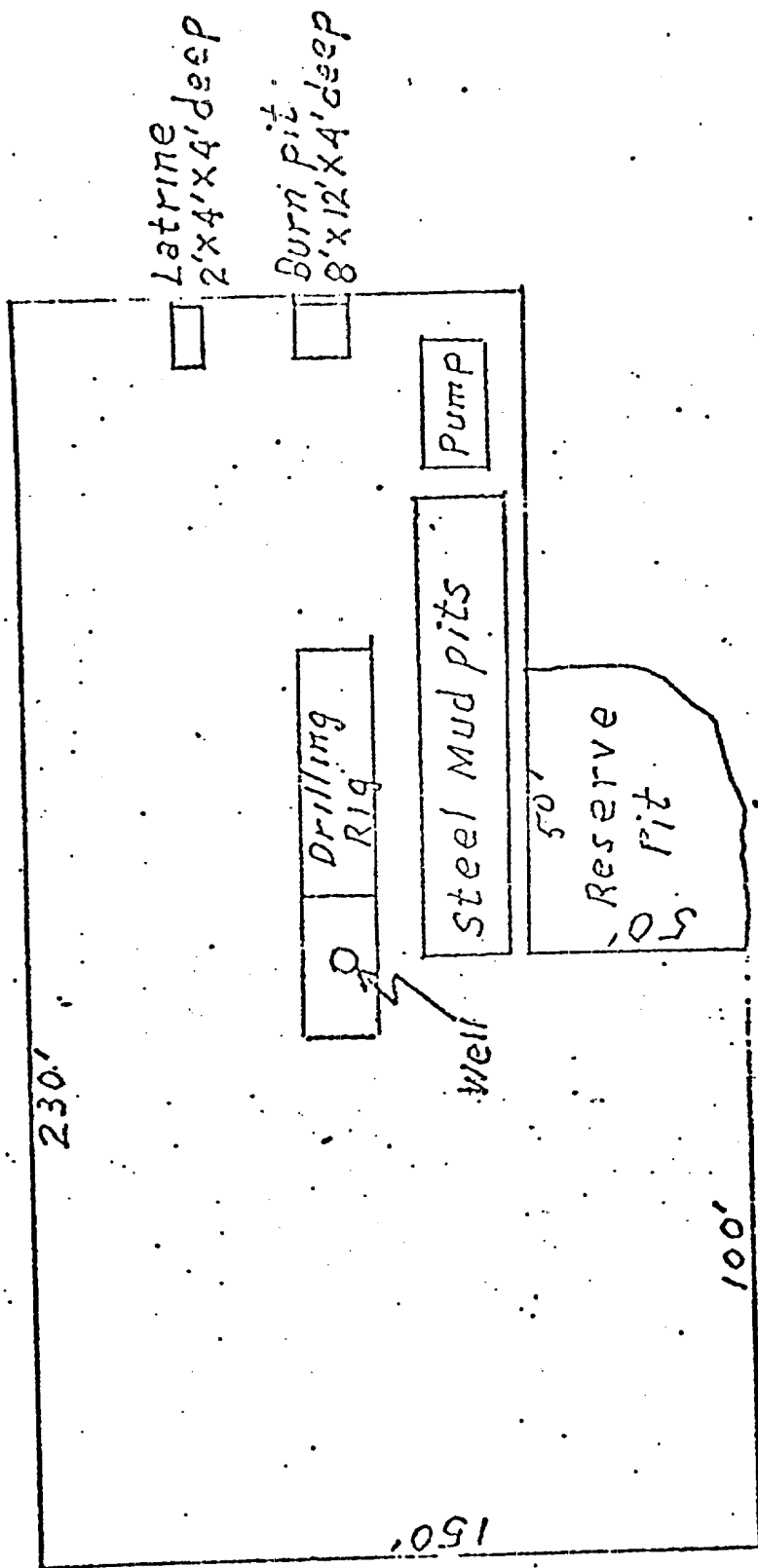

San Juan 28.7 Unit #213  
 NE SE/4 Sec. 29, T-27-N, R-7-W

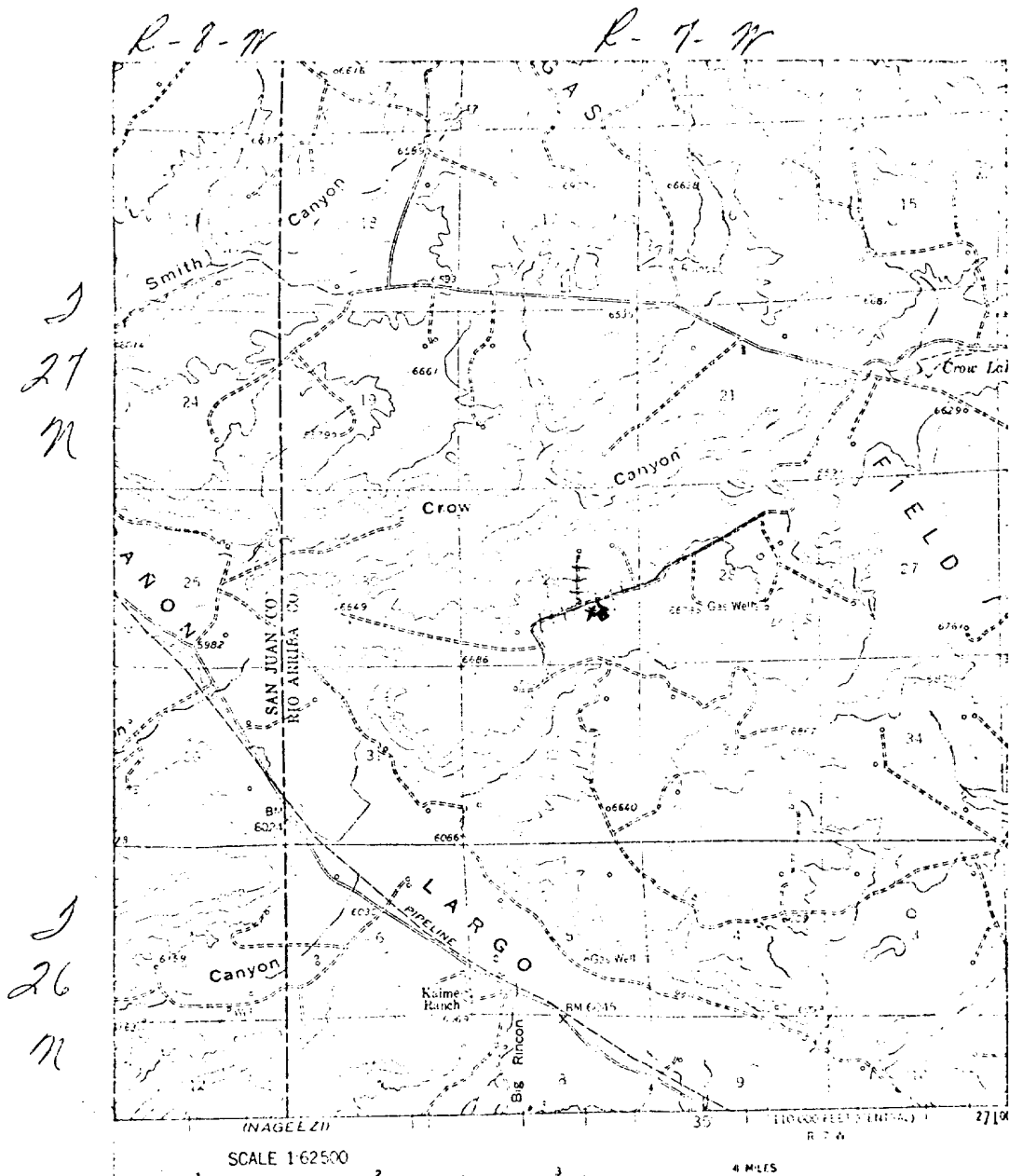

# LEGEND OF RIGHT-OF-WAYS

EXISTING ROADS	—
EXISTING PIPELINES	—+—+—+—
EXISTING ROAD & PIPELINE	—+—+—+—
PROPOSED ROADS	—
PROPOSED PIPELINES	+ + + +
PROPOSED ROAD & PIPELINE	+ + + +