

WELL LOCATION AND ACREAGE DEDICATION PLAT

Supersedes C-128
Effective 1-4-65

All distances must be from the outer boundaries of the Section.

Operator Meridian Oil Inc.			Lease Jicarilla 94		Well No. 6-A
Unit Letter P	Section 27	Township 27N	Range 3W	County Rio Arriba	
Actual Footage Location of Well:					
790 feet from the South line and		990 feet from the East line			
Ground Level Elev. 7220	Producing Formation Mesaverde / Pic. Cliffs		Pool Blanco / Gavilan		Dedicated Acreage: 320/160 acres

1. Outline the acreage dedicated to the subject well by colored pencil or hachure marks on the plat below.
2. If more than one lease is dedicated to the well, outline each and identify the ownership thereof (both as to working interest and royalty).
3. If more than one lease of different ownership is dedicated to the well, have the interests of all owners been consolidated by communitization, unitization, force-pooling, etc?

☐ Yes ☐ No If answer is "yes," type of consolidation _____

If answer is "no," list the owners and tract descriptions which have actually been consolidated. (Use reverse side of this form if necessary.) _____

No allowable will be assigned to the well until all interests have been consolidated (by communitization, unitization, forced-pooling, or otherwise) or until a non-standard unit, eliminating such interests, has been approved by the Commission.

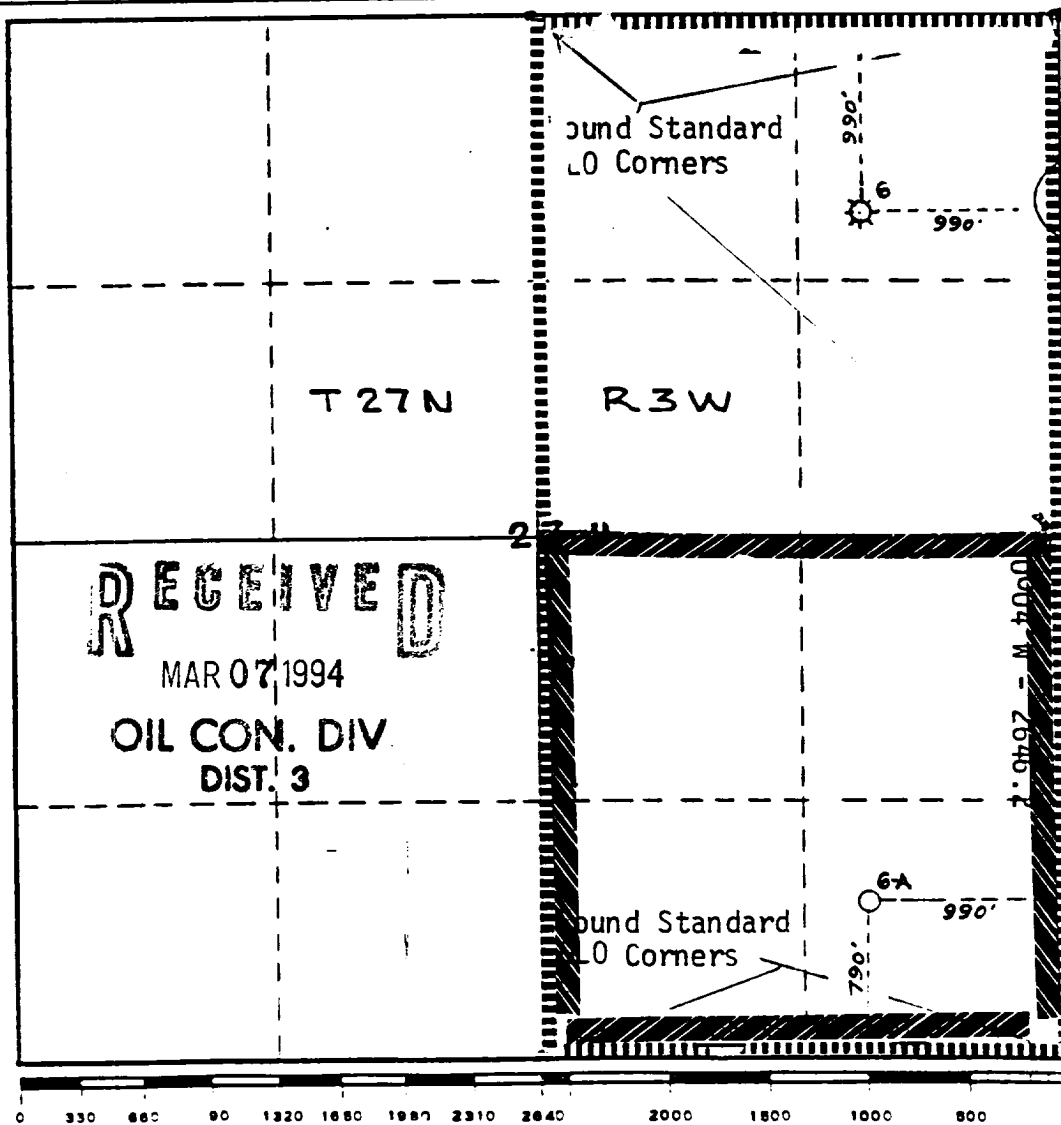

CERTIFICATION

I hereby certify that the information contained herein is true and complete to the best of my knowledge and belief.

Name
Peggy Bradfield

Position
Regulatory Representative

Company
Meridian Oil Inc.

Date
3-3-94

I hereby certify that the well location shown on this plat was plotted from field notes of actual surveys made by me or under my supervision, and that the same is true and correct to the best of my knowledge and belief.

Date Surveyed

May 15, 1976

Registered Professional Engineer and/or Land Surveyor

H. A. Carson

Certificate No.

5063