

submitted in lieu of Form 3160-5

UNITED STATES  
DEPARTMENT OF THE INTERIOR  
BUREAU OF LAND MANAGEMENT

Sundry Notices and Reports on Wells

1. Type of Well  
GAS

2. Name of Operator  
MERIDIAN OIL

3. Address & Phone No. of Operator  
PO Box 4289, Farmington, NM 87499 (505) 326-9700

4. Location of Well, Footage, Sec., T, R, M  
990' FNL, 1658' FWL Sec. 23, T-27-N, R-3-W, NMPM

5. Lease Number  
Jic Cont 94

6. If Indian, All. or Tribe Name  
Jicarilla Apache

7. Unit Agreement Name

8. Well Name & Number  
Jicarilla 94 #5A

9. API Well No.

10. Field and Pool  
Gavilan PC/  
Blanco MV

11. County and State  
Rio Arriba Co, NM

12. CHECK APPROPRIATE BOX TO INDICATE NATURE OF NOTICE, REPORT, OTHER DATA

Type of Submission	Type of Action	
<input checked="" type="checkbox"/> Notice of Intent	<input type="checkbox"/> Abandonment	<input type="checkbox"/> Change of Plans
<input type="checkbox"/> Subsequent Report	<input type="checkbox"/> Recompletion	<input type="checkbox"/> New Construction
<input type="checkbox"/> Final Abandonment	<input type="checkbox"/> Plugging Back	<input type="checkbox"/> Non-Routine Fracturing
	<input type="checkbox"/> Casing Repair	<input type="checkbox"/> Water Shut off
	<input type="checkbox"/> Altering Casing	<input type="checkbox"/> Conversion to Injectio
	<input checked="" type="checkbox"/> Other - pay add	

13. Describe Proposed or Completed Operations

The Pictured Cliffs will be perforated and stimulated in the following manner: TOOH w/tbg. Set RBP above existing M perfs. Run CBL to verify TOC. If good top is not seen at least 50' above proposed top PC perf, remedial cmt work will be performed. The PC will be perf'd 3742-3909' and stimulate w/approx 1500 gal acid and fracture stimulated. Run after frac GR log to verify if frac stayed in zone. TIH w/2 3/8" tbg landed @ 6200 Application is being made to NMOCD for commingling. Attached is a procedure and wellbore diagram.

14. I hereby certify that the foregoing is true and correct.

Signed [Signature] (BA) Title Regulatory Affairs Date 1/6/94

(This space for Federal or State Office use)  
APPROVED BY [Signature] Title Assistant Area Manager Date 2/16/94  
CONDITION OF APPROVAL, if any:

NMOCD

NEW MEXICO OIL CONSERVATION COMMISSION  
WELL LOCATION AND ACREAGE DEDICATION PLAT

Form C-102  
Supersedes C-128  
Effective 1-1-65

All distances must be from the outer boundaries of the Section.

Operator <b>Meridian Oil Inc.</b>			Lease <b>Jicarilla 94</b>		Well No. <b>5A</b>
Unit Letter <b>C</b>	Section <b>23</b>	Township <b>27N</b>	Range <b>3W</b>	County <b>Rio Arriba</b>	
Actual Footage Location of Well: <b>990</b> feet from the <b>North</b> line and <b>1658</b> feet from the <b>West</b> line					
Ground Level Elev. <b>7203</b>	Producing Formation <b>Mesaverde/Pic.Cliffs Blanco/Gavilan</b>			Dedicated Acreage: <b>320/160</b> Acres	

1. Outline the acreage dedicated to the subject well by colored pencil or hachure marks on the plat below.
2. If more than one lease is dedicated to the well, outline each and identify the ownership thereof (both as to working interest and royalty).
3. If more than one lease of different ownership is dedicated to the well, have the interests of all owners been consolidated by communitization, unitization, force-pooling, etc?

☐ Yes ☐ No If answer is "yes," type of consolidation \_\_\_\_\_

If answer is "no," list the owners and tract descriptions which have actually been consolidated. (Use reverse side of this form if necessary.) \_\_\_\_\_

No allowable will be assigned to the well until all interests have been consolidated (by communitization, unitization, forced-pooling, or otherwise) or until a non-standard unit, eliminating such interests, has been approved by the Commission.

Call West - 2656.8'

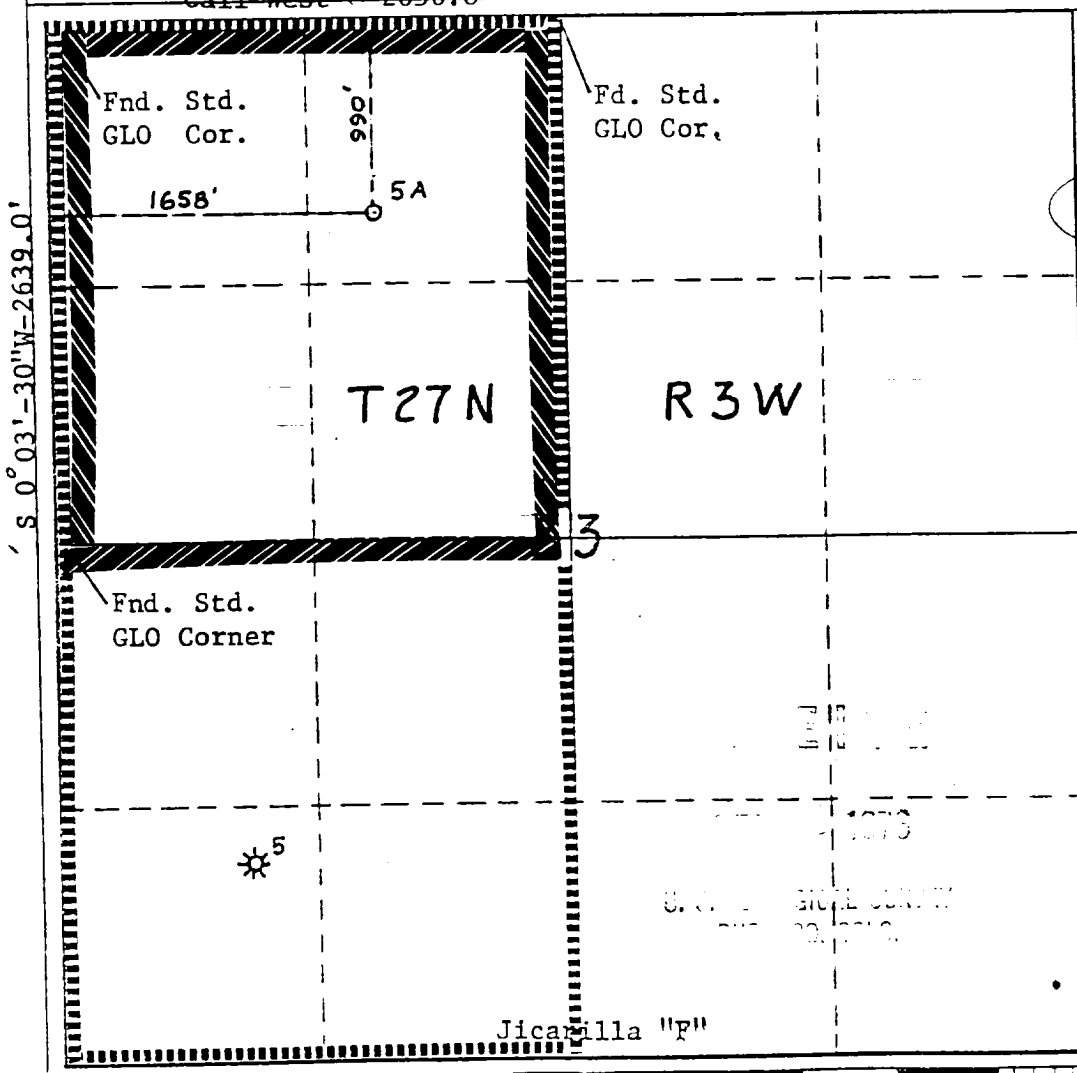

CERTIFICATION

I hereby certify that the information contained herein is true and complete to the best of my knowledge and belief.

*Peggy Bradfield*  
Name

Peggy Bradfield

Position

Regulatory Representative

Company

Meridian Oil Inc.

Date

1-6-94

I hereby certify that the well location shown on this plat was plotted from field notes of actual surveys made by me or under my supervision, and that the same is true and correct to the best of my knowledge and belief.

*J. F. Godfrey, Jr.*  
Date Surveyed  
July 22, 1976

Registered Professional Engineer  
and/or Land Surveyor

J. F. Godfrey, Jr.

Certificate No.

**JICARILLA 94 #5A**  
Unit C, Section 23, T27N, R03W  
Recommended Recompletion Procedure  
*Pictured Cliffs Pay Add & Completion*

Note: Notify BLM (761-8762) and NMOCD (334-6178) 24 hours prior to rig activity.

---

Inspect location and install and/or test rig anchors. Install 1 - 400 bbl rig tank and fill w/ 2% KCl water. Approximately 202 jts. 2-3/8" 4.7# J-55 tubing will be required (MOI, District Tools) for cleanout and production. Comply with all BLM, NMOCD, Jicarilla Apache, and MOI rules and regulations. Notify engineering when work has commenced. Hold Safety Meetings on a regular basis.

---

1. Install 1 X 400 bbl frac tanks and fill with 2% KCl water.
2. Hold Safety Meeting. MIRU. Place fire and safety equipment in easily accessible locations. NU relief line and blooie line to laydown flow tank. Obtain and record all wellhead pressures.
3. Blow down tubing. If tubing will not blow down, kill well with KCl water. PBTD is 6264'.
4. TOOH with 5690' of 2-3/8" 4.70# tubing, visually inspect and tally tubing.
5. RU wireline. RIH with 4-1/2" 10.5# gauge ring and check pipe. PU Baker Model G Retrievable bridge plug, TIH and set bridge plug at 4200'. Run GR - CBL - CCL in 4-1/2 casing from bridge plug to Surface pipe (Cmt circulated on both stages). TOC must be above 3690' to continue. Evaluate GR - CBL - CCL and send copy to production engineering.
6. TIH w/ treesaver. Pressure test treesaver and casing to 3200 psi. for 15 min. If pressure test fails, prepare to test and repair casing. Contact Production Engineering and a casing repair will be submitted. TOOH with treesaver.

**Pictured Cliffs Stimulation:**

7. Select-Fire Perf. the following intervals w/ 3-1/8" HSC -3125-306, 12 gram Owen charges 0.31" holes w/ 12.02 " penetration:  
  

**3742' - 3909'. (22 Holes)**
8. RD wireline. TIH w/ treesaver.
9. RU stimulation company. **Hold Safety Meeting.** Pressure test surface treating lines to 5000 psi. **Maximum STP during acid job is 3200 psi.** Pump 1,500 gals 15% HCl w/additives at a rate of 4-6 BPM, attempt to ball-out the perforations. Drop a total of 33 7/8" RCN ball sealers (1.3sp.gr.) spaced evenly throughout the job. Record rates and pressures while attempting to achieve ball-out.
10. RD stimulation company. TOOH w/ treesaver. RU wireline, run junk basket to knock-off/retrieve as many ballsealers as possible. TIH w/ treesaver. RU stimulation company. Prepare to fracture stimulate the Pictured Cliffs.
11. Pressure test surface treating lines to 5000 psi. **Maximum treating pressure is 3200 psi.** Fracture and tag the PC according to the attached procedure. Flow-back the well immediately using a variable choke manifold. Increase choke size as needed to keep the well from logging off, if possible. When pressures and flow rates allow, TOOH w/ treesaver.

**Jicarilla 94 #5A  
Pictured Cliffs Pay-Add**

12. TIH w/ retrieving head and 2-3/8" 4.70# workstring and clean out to the retrievable bridge plug @ 4200' with air until sand production is minimal. Obtain pitot gauge for the Pictured Cliffs formation. Record pitot gauge as the Pictured Cliffs formation only. Latch onto the retrievable bridge plug and TOOH.
13. RU wireline, run After-frac Tracer Survey-GammaRay (report if frac stayed in zone, if possible), POOH. RD wireline. Send copy of logs to Production Engineering.
14. TIH w/ one joint 2-3/8" 4.7# J-55 tubing, seating nipple, and 2-3/8" production tubing. Cleanout to 6264' with air. Land tubing @ +/-6200' (64' of rathole) and obtain final pitot gauge. ND BOP, NU WH. Contact Production Operations for well tie-in. RD and MOL.

Approved: \_\_\_\_\_  
Drilling Superintendent

**Suggested Vendors:**

Wireline:	Blue Jet	325-5584
Radioactive Tag:	ProTechnics, Intl	326-7133
Tubing:	MOI, District Tools	326-9826
Stimulation:	BJ Services	327-6288
Treesaver:	WIT	599-5609
Production Oper.:	Bruce Voiles	326-9571
Engineering:	Brian Ault	326-9871 w 326-6613 h

# Jicarilla 94 #5A

Unit C, Sec. 23, T27N, R3W

*Pictured Cliffs Pay Add and Stimulation*

