

UNITED STATES
DEPARTMENT OF THE INTERIOR
GEOLOGICAL SURVEY

30-039-21765

APPLICATION FOR PERMIT TO DRILL, DEEPEN, OR PLUG BACK

1a. TYPE OF WORK

DRILL ☒DEEPEN ☐PLUG BACK ☐

b. TYPE OF WELL

OIL
WELL ☐GAS
WELL ☒

OTHER

SINGLE
ZONE ☐MULTIPLE
ZONE ☐

2. NAME OF OPERATOR

Jerome P. McHugh

3. ADDRESS OF OPERATOR

Box 234, Farmington, NM 87401

4. LOCATION OF WELL (Report location clearly and in accordance with any State requirements.)*

At surface

990' FNL - 1650' FEL

At proposed prod. zone

5. LEASE DESIGNATION AND SERIAL NO.

Contract 90

6. IF INDIAN, ALLOTTEE OR TRIBE NAME

Jicarilla Apache

7. UNIT AGREEMENT NAME

8. FARM OR LEASE NAME

Chris

9. WELL NO.

4

10. FIELD AND POOL, OR WILDCAT

Blanco Mesaverde

11. SEC., T., R., M., OR BLK.
AND SURVEY OR AREA

Sec 9, T27N, R3W

12. COUNTY OR PARISH

Rio Arriba

13. STATE

NM

15. DISTANCE FROM PROPOSED*

LOCATION TO NEAREST
PROPERTY OR LEASE LINE, FT.
(Also to nearest drilg. unit line, if any)

990'

16. NO. OF ACRES IN LEASE

17. NO. OF ACRES ASSIGNED
TO THIS WELL

350.60

18. DISTANCE FROM PROPOSED LOCATION*
TO NEAREST WELL, DRILLING, COMPLETED,
OR APPLIED FOR, ON THIS LEASE, FT.Approx
1/2 mi.

19. PROPOSED DEPTH

6200'

20. ROTARY OR CABLE TOOLS

Rotary

21. ELEVATIONS (Show whether DF, RT, GR, etc.)

6938' GR

22. APPROX. DATE WORK WILL START*

6-1-78

23.

PROPOSED CASING AND CEMENTING PROGRAM

SIZE OF HOLE	SIZE OF CASING	WEIGHT PER FOOT	SETTING DEPTH	QUANTITY OF CEMENT
12-1/4"	8-5/8"	32.30#	200'	200 sx
7-7/8"	4-1/2"	10.5#	6200'	1000 sx (2 stages)

Plan to drill well with mud thru Mesaverde formation, set 4-1/2" casing and cement to surface in two stages, selectively perforate and frac Mesaverde formation, cleanout after frac, run 1-1/4" tubing and complete well.

Will use hydraulic blowout preventer furnished by rig while drilling, Shaffer double-gate manual BOP while completing, and 600 series screwed API wellhead.

NMERB Requirement: Gas is not dedicated at this time.

IN ABOVE SPACE DESCRIBE PROPOSED PROGRAM: If proposal is to deepen or plug back, give data on present productive zone and proposed new productive zone. If proposal is to drill or deepen directionally, give pertinent data on subsurface locations and measured and true vertical depths. Give blowout preventer program, if any.

24.

SIGNED

Thomas A. Dugan

TITLE

Agent

DATE

5-3-78

(This space for Federal or State office use)

PERMIT NO.

APPROVAL DATE

APPROVED BY

TITLE

CONDITIONS OF APPROVAL, IF ANY:

RECEIVED

MAY 8 1978

U. S. GEOLOGICAL SURVEY
DURANGO, COLO.

*See Instructions On Reverse Side

NEW MEXICO OIL CONSERVATION COMMISSION
WELL LOCATION AND ACREAGE DEDICATION PLAT

Form C-102
Supersedes C-128
Effective 1-1-65

All distances must be from the outer boundaries of the Section.

Operator Jerome P. McHugh		Lease Chris		Well No. 4
Unit Letter 5	Section 9	Township 27 North	Range 3 West	County Rio Arriba
Actual Footage Location of Well: 990 feet from the North line and 1650 feet from the East line				
Ground Level Elev. 6938	Producing Formation Mesa Verde	Pool Blanco	Dedicated Acreage: 350.60 Acres	

1. Outline the acreage dedicated to the subject well by colored pencil or hatchure marks on the plat below.
2. If more than one lease is dedicated to the well, outline each and identify the ownership thereof (both as to working interest and royalty).
3. If more than one lease of different ownership is dedicated to the well, have the interests of all owners been consolidated by communitization, unitization, force-pooling, etc?

☐ Yes ☐ No If answer is "yes," type of consolidation _____

If answer is "no," list the owners and tract descriptions which have actually been consolidated. (Use reverse side of this form if necessary.) _____

No allowable will be assigned to the well until all interests have been consolidated (by communitization, unitization, forced-pooling, or otherwise) or until a non-standard unit, eliminating such interests, has been approved by the Commission.

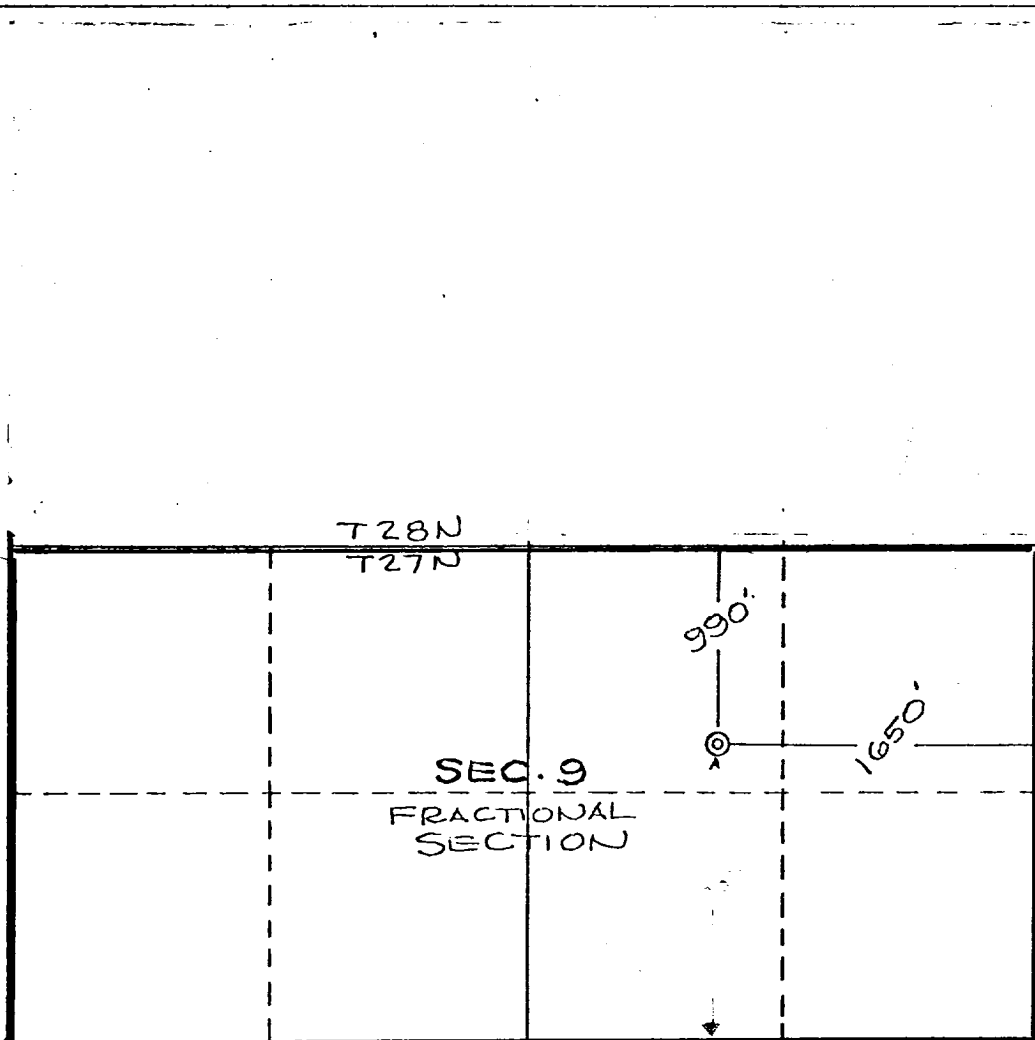

CERTIFICATION

I hereby certify that the information contained herein is true and complete to the best of my knowledge and belief.

Thomas L. Dugan
Name
Thomas L. Dugan
Position
Agent
Company
Jerome P. McHugh
Date
5-3-78

I hereby certify that the well location shown on this plat was plotted from field notes of actual surveys made by me or under my supervision and that the same are true and correct to the best of my knowledge and belief.

E. V. Echohawk
REGISTERED LAND SURVEYOR
Reg. No. 3602
WEST V. ECHOHAWK

Date Surveyed
April 25, 1978
Registered Professional Engineer
and/or Land Surveyor

E. V. Echohawk
Certificate No. 3602
E. V. Echohawk LS