

UNITED STATES
DEPARTMENT OF THE INTERIOR
GEOLOGICAL SURVEY

APPLICATION FOR PERMIT TO DRILL, DEEPEN, OR PLUG BACK

1a. TYPE OF WORK

DRILL ☒DEEPEN ☐PLUG BACK ☐

b. TYPE OF WELL

OIL
WELL ☐GAS
WELL ☒

OTHER

SINGLE
ZONE ☐MULTIPLE
ZONE ☐

2. NAME OF OPERATOR

Palmer Oil & Gas Company

3. ADDRESS OF OPERATOR

P. O. Box 2564, Billings, MT 59103

4. LOCATION OF WELL (Report location clearly and in accordance with any State requirements.*)

At surface

SW $\frac{1}{4}$ SE $\frac{1}{4}$ 1170' FSL-1470' FEL

At proposed prod. zone

Same

14. DISTANCE IN MILES AND DIRECTION FROM NEAREST TOWN OR POST OFFICE*

Approx. 27 miles North of Ojito

10. DISTANCE FROM PROPOSED*

LOCATION TO NEAREST
PROPERTY OR LEASE LINE, FT.
(Also to nearest drlg. unit line, if any)

1170'

16. NO. OF ACRES IN LEASE

Joint Venture

18. DISTANCE FROM PROPOSED LOCATION*
TO NEAREST WELL, DRILLING, COMPLETED,
OR APPLIED FOR, ON THIS LEASE, FT.

19. PROPOSED DEPTH

6350'

17. NO. OF ACRES ASSIGNED
TO THIS WELL

E-320

20. ROTARY OR CABLE TOOLS

Rotary

21. ELEVATIONS (Show whether DF, RT, GR, etc.)

7319' GR.

22. APPROX. DATE WORK WILL START*

Oct. 15, 1979

23. PROPOSED CASING AND CEMENTING PROGRAM

SIZE OF HOLE	SIZE OF CASING	WEIGHT PER FOOT	SETTING DEPTH	QUANTITY OF CEMENT
12-1/4"	9-5/8" (new)	36#	300'	300 sacks
8-3/4"	7" (new)	20#	4000'	250 sacks
6-1/4"	4-1/2" (new)	10.5#	6350'	600 sacks

- Palmer Oil & Gas Company will drill a 6350' Mesaverde test in the SW $\frac{1}{4}$ SE $\frac{1}{4}$ of Section 20-T27N-R2W.
- Well to be drilled by rotary tools. Set 300' of 9-5/8" casing and cement to surface; drill 8-3/4" hole to 4000' and set 7" casing. Air drill 4000' to T.D. and run 4 $\frac{1}{2}$ " casing.
- IES and Porosity Logs will be run at T.D. All potential zones will be analyzed from surface to total depth, and if potentially commercial, 4 $\frac{1}{2}$ " casing or liner will be set, cemented and perforated.
- After perforating, the productive zones will be fractured, if necessary.
- Survey plat attached.
- Spacing unit will be E $\frac{1}{2}$ of Section 20.
- Gas is not dedicated.

IN ABOVE SPACE DESCRIBE PROPOSED PROGRAM: If proposal is to deepen or plug back, give data on present productive zone and proposed new productive zone. * If proposal is to drill or deepen directionally, give pertinent data on subsurface locations and measured and true vertical depths. Give blowout preventer program, if any.

24.

SIGNED

Robert D. Ballantyne
Robert D. Ballantyne

TITLE Drilling Superintendent

DATE August 21, 1979

(This space for Federal or State office use)

PERMIT NO.

APPROVAL DATE

APPROVED BY

TITLE

DATE

CONDITIONS OF APPROVAL, IF ANY:

OK

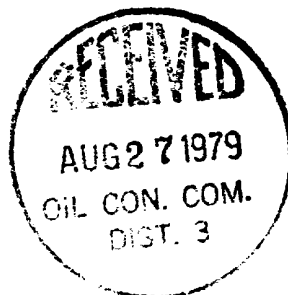

NEW MEXICO OIL CONSERVATION COMMISSION
WELL LOCATION AND ACREAGE DEDICATION PLAT

Form C-102
Supersedes C-128
Effective 1-1-65

All distances must be from the outer boundaries of the Section.

Operator PALMER OIL & GAS COMPANY			Lease APACHE JVA		Well No. 4-A
Unit Letter 0	Section 20	Township 27N	Range 2W	County Rio Arriba	
Actual Footage Location of Well: 1170 feet from the South line and 1170 feet from the East line					
Ground Level Elev. 7319	Producing Formation Mesaverde		Pool Blanco-Mesaverde	Dedicated Acreage: 320 Acres	

1. Outline the acreage dedicated to the subject well by colored pencil or hachure marks on the plat below.
2. If more than one lease is dedicated to the well, outline each and identify the ownership thereof (both as to working interest and royalty).
3. If more than one lease of different ownership is dedicated to the well, have the interests of all owners been consolidated by communitization, unitization, force-pooling, etc?
☐ Yes ☐ No If answer is "yes," type of consolidation _____

If answer is "no," list the owners and tract descriptions which have actually been consolidated. (Use reverse side of this form if necessary.) _____

No allowable will be assigned to the well until all interests have been consolidated (by communitization, unitization, forced-pooling, or otherwise) or until a non-standard unit, eliminating such interests, has been approved by the Commission.

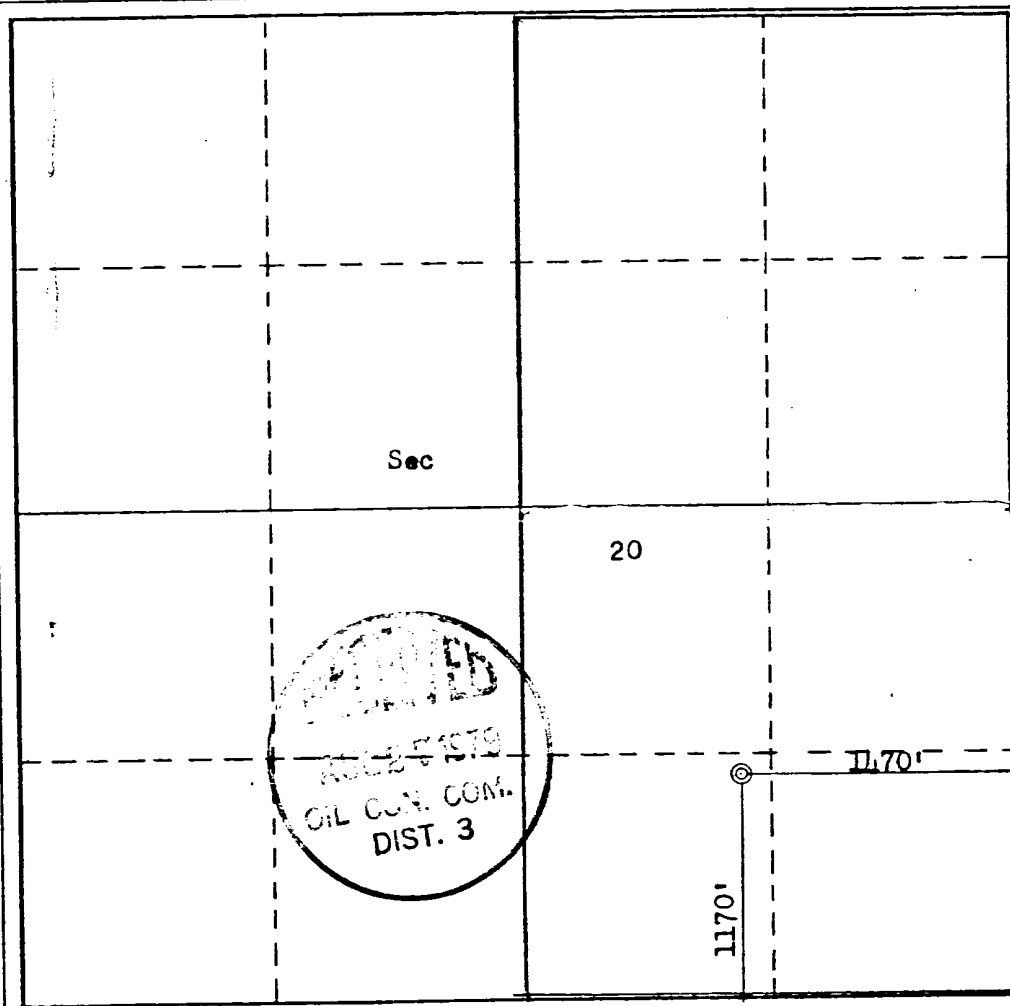

CERTIFICATION

I hereby certify that the information contained herein is true and complete to the best of my knowledge and belief.

Robert D Ballantyne

Name

Robert D. Ballantyne

Position

Drilling Superintendent

Company

Palmer Oil & Gas Company

Date

I hereby certify that the well location shown on this plat was plotted from field notes of actual surveys made by me or under my supervision, and that the same is true and correct to the best of my knowledge and belief.

Date Surveyed

October 26, 1977

Registered Professional Engineer and/or Land Surveyor

Fred B. Kerk Jr.
Fred B. Kerk Jr.

Certificate No. A.C.R. JR.

3950

TWELVE POINT PLAN OF DEVELOPMENT

For Surface Use with Palmer Oil & Gas Company's
Apache JVA #4-A
SW $\frac{1}{4}$ SE $\frac{1}{4}$ Section 20-T27N-R2W
Rio Arriba County, New Mexico

1. Existing roads including location of the exit from the main highway.
Existing roads include the main road which runs along the southern boundary of the Jicarilla Apache Reservation, turn north on good gravel road two and a quarter miles to a fork, turn east on access road and travel for a half mile to the location. See Appendix 1, Pages 85, 86, and 87 of Environmental Study dated October 10, 1976, and Maps #1 and #2.
2. Planned access road.
See Topographic Map #1.
Access road is bladed.
3. Location of wells.
See Map #3.
4. Location of tank batteries, production facilities and production gathering and service lines.
If this well is productive, it would be gas; therefore, the facilities would be the wellhead, tanks for oil and condensate, 10' x 10' water pit if necessary, separator and gas line to the well. The tanks and separator would be set within 150' of the well and the gas line would run adjacent and parallel to roads.
5. Location and type of water supply.
No arrangement has been made at this time.
6. Source of construction materials.
All construction material such as gravel, sand, timbers, etc. will be purchased and hauled to the location. No water, sand or gravel will be used from this land.
7. Methods for handling waste disposal.
 - 1) Cuttings will be buried three feet below the surface.
 - 2) Drilling fluids will be left in a fenced, open pit to evaporate.
 - 3) Produced oil or condensate (if any) will be stored in a tank.
 - 4) Portable toilet to be provided.
 - 5) Trash will be burned in burn pit.
 - 6) After pit area is sufficiently dry, cuttings will be pushed into pit and sub-soil will be placed on any remaining fluid and cuttings, then top-soil, if any, will be placed over both pit and location area.
8. Ancillary facilities.
No camps or airstrips will be used.
9. Wellsite layout.
See Plat #3. This location was approved as the JVA #4 well. The location was changed for geological reasons. The location was built as approved by the Government Agency September 25, 1978.

10. Plans for restoration of surface.

Upon completion of the well, all pits will be backfilled and top soil replaced and recontoured back to the original terrain. Pits will be backfilled as soon as they evaporate enough to permit such work. Should it be necessary to protect livestock or wild game, pits will be fenced and maintained until clean-up operations are commenced. Should oil accumulate on the pit, it will be removed and buried six feet deep or overhead flagging will be employed to protect wildlife.

11. Other information.

- 1) Topography - Drillsite and access low valley profile. See Pages 85, 86, and 87 of Environmental Study.
- 2) Vegetation - Sparse grass and sagebrush.
- 3) Land use - Land is used for grazing with no reservoir or water on this site. There are no known archaeological, cultural, or historical sites on this site. An archaeological survey clearance was done September 25, 1978.

12. Lessee's or operator's representative.

Elledge Consulting and Production Company
1701 Bloomfield Highway
Farmington, New Mexico 84701

Harold W. Elledge, President

Office Phone (505) 327-1181

OR

Robert D. Ballantyne
P. O. Box 2564
Billings, Montana 59103

Office Phone (406) 248-3151
Home Phone (406) 656-1304

13. I hereby certify that I, or persons under my direct supervision, have inspected the proposed drillsite and access route; that I am familiar with the conditions which presently exist; that the statements made in this plan are, to the best of my knowledge, true and correct; and, that the work associated with the operations proposed herein will be performed by Four Corners Drilling Co. and its contractors and sub-contractors in conformity with this plan and the terms and conditions under which it is proposed.

PALMER OIL & GAS COMPANY

By: Robert D. Ballantyne
Robert D. Ballantyne
Drilling Superintendent

Township 27N, Range 2W, County Rio Arriba, State New Mexico

Island Township Plat

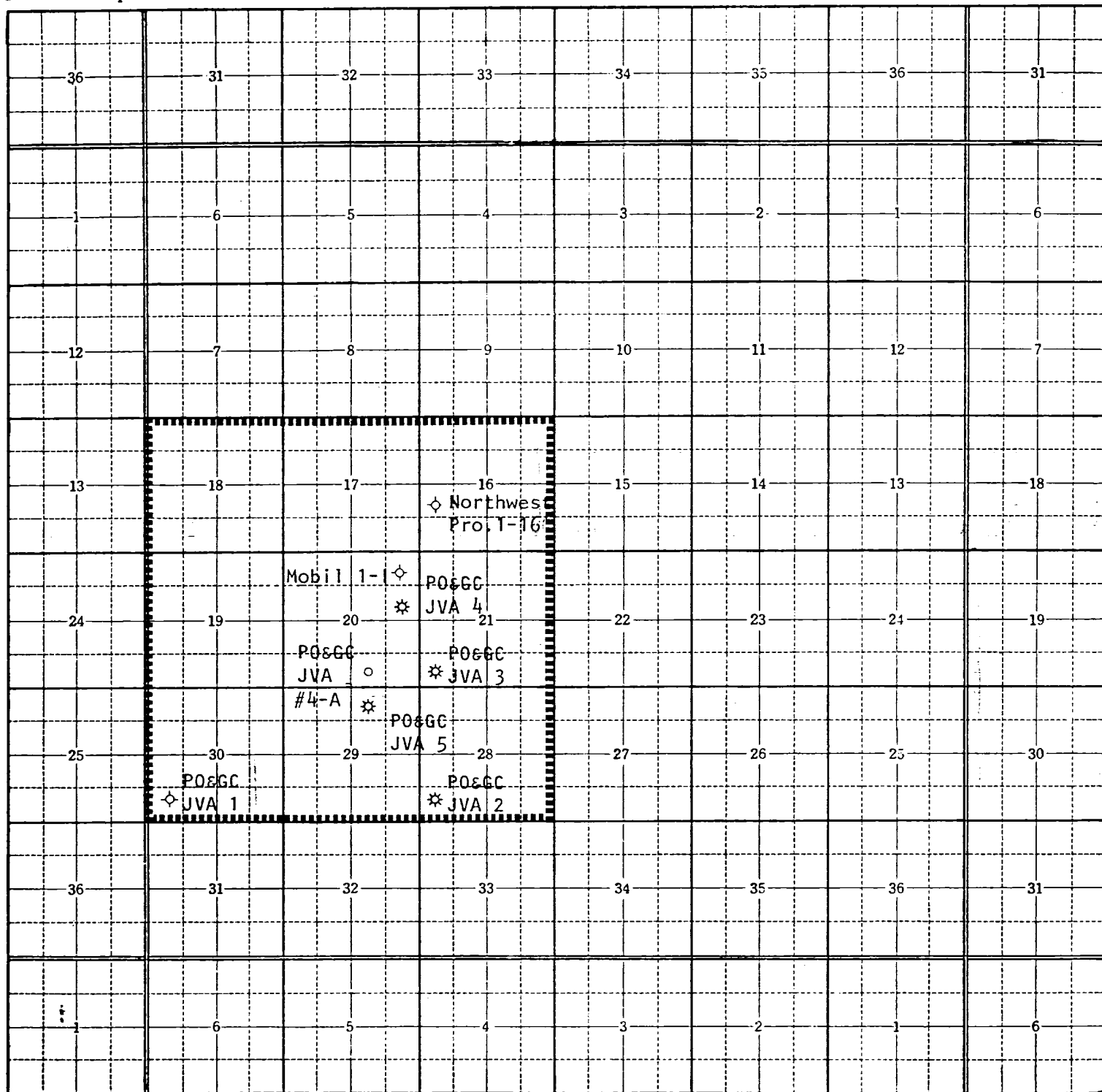

JVA #9
T27N-R2W, Sec. 20
SW $\frac{1}{4}$ SE $\frac{1}{4}$

Map #3

SEVEN POINT WELL CONTROL PLAN

PALMER OIL & GAS COMPANY
Apache JVA # 4-A
SW $\frac{1}{4}$ SE $\frac{1}{4}$ Section 20-T27N-R2W
Rio Arriba County, New Mexico

1. Surface Casing: 9-5/8" 36#/ft., Grade K-55, Short T&C, set at 300' and cemented with pump and plug method back to surface.
2. Casinghead Flange: 10" 900 S adapted to 1500 psig W. P. Larkin (or equivalent) casinghead with two 2" 1500 psi L. P. outlets.
3. 7" intermediate casing will be set to approximately 4000' to case off any possible water from the Picture Cliff formation so as the remaining hole can be air drilled.
4. Blowout Preventor: A 10" 3000 psig W. P. Double gate hydraulic Shaffer BOP (or equivalent) with drill pipe rams and blind rams. All fill, kill, and choke lines will be minimum of 2" 2000 psi working pressure. The rams will be closed daily and checked for proper operation.
5. Auxiliary Equipment: a) Drill pipe floats will be allowed at contractor's discretion; b) Visual and manual monitoring of mud system will be maintained.
6. Anticipated bottom hole pressure is less than 1800 psi at 6350' or a gradient of .277 psi/ft.
7. Well will be drilled with water base mud system with 8.8-9.0 ppg weight 35-45 seconds viscosity to 4000' - Air drilling from 4000 to T.D.

PALMER OIL & GAS COMPANY

By: Robert D. Ballantyne
Robert D. Ballantyne
Drilling Superintendent

OUR CORNERS DRILLING CO.
P. O. BOX 1067
702 E. BROADWAY
FARMINGTON, NEW MEXICO 87401
TELEPHONE: (505) 327-1122

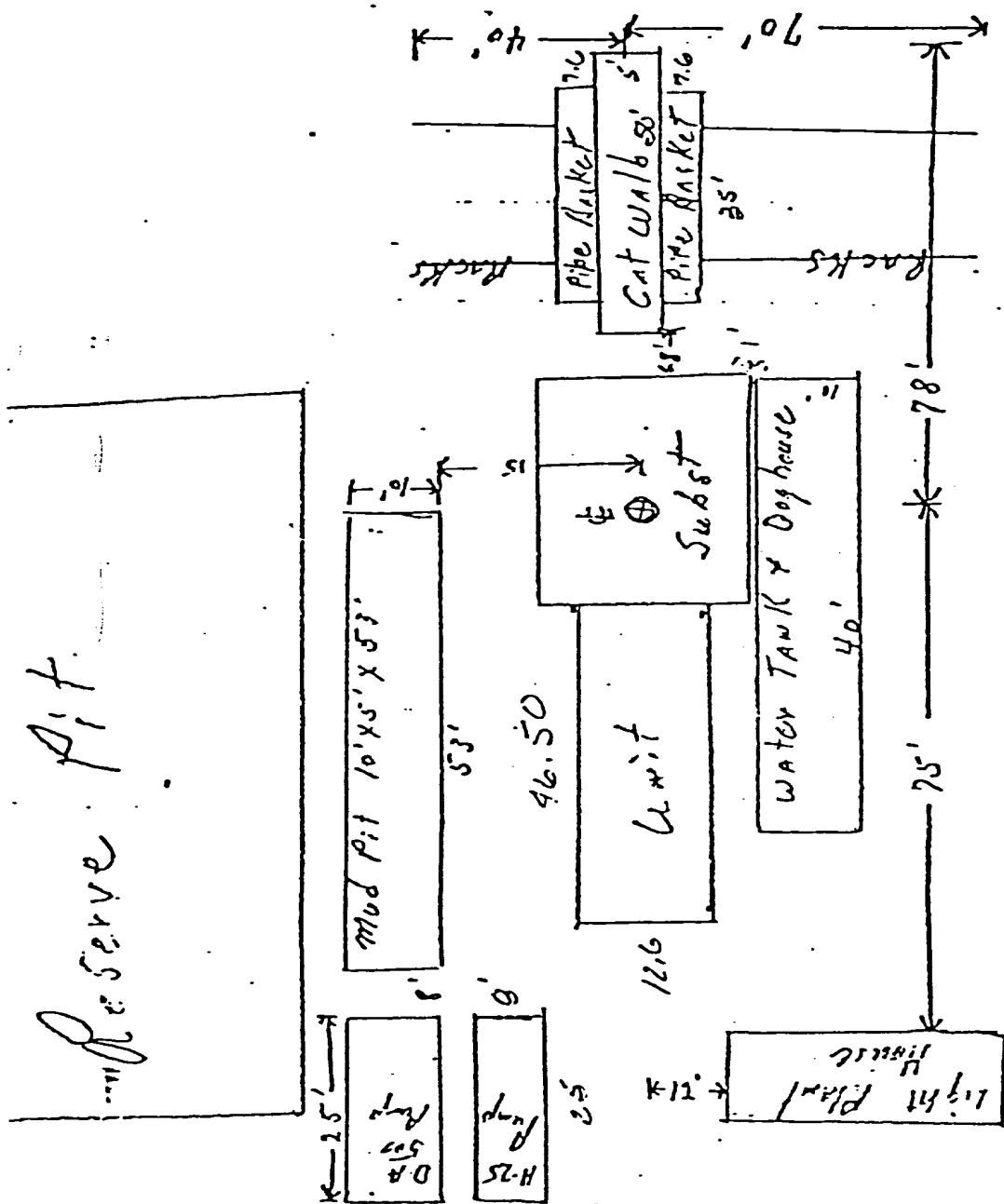

PLAT #3

Apache JVA #4-A
SWSE Sec. 20-27N-2W

... 000 feet

Proposed well 5A is to be located 1,160 feet from the
south line and 1,025 feet from the west line of section 20

at an elevation of approximately 7,290 feet. This well will lie just off an existing road so only minimal construction



Figure 25
Looking North Across the Proposed 5A Location

will be necessary to gain access to the well. Should this well prove productive, it will be connected to the flow line from well 4A which will lie at the edge of this location.

Proposed well 5B will lie 1,550 feet from the north line and 850 feet from the west line of section 20 at an elevation of about 7,175 feet. This location will lie just off an existing road so essentially no new road construction will be necessary to gain access to the well. Should this well prove productive it will be connected to the flow line from the 4A well which will cross the edge of this location.



Figure 26
Looking North Across the Proposed 5B Location