

UNITED STATES
DEPARTMENT OF THE INTERIOR
GEOLOGICAL SURVEY

30 039-22542

APPLICATION FOR PERMIT TO DRILL, DEEPEN, OR PLUG BACK

1. TYPE OF WORK
 DRILL DEEPEN PLUG BACK

2. TYPE OF WELL
 OIL WELL GAS WELL OTHER SINGLE ZONE MULTIPLE ZONE

3. NAME OF OPERATOR
 CURTIS J. LITTLE

4. ADDRESS OF OPERATOR
 P. O. Box 2487
 Farmington NM 87401

5. LOCATION OF WELL (Report location clearly and in accordance with any State requirements.)
 1800' FSL/2000' FWL

6. DISTANCE IN MILES AND DIRECTION FROM NEAREST TOWN OR POST OFFICE*
 same

7. UNIT ACQUISITION NAME
 NM-0111-A

8. FARM OR LEASE NAME
 TURNER

9. WELL NO.
 #1

10. FIELD AND POOL, OR WILDCAT
 SOUTH BLANCO PC

11. SEC., T. R., M., OR BLK. AND SURVEY OR AREA
 Sec. 21-26N-7W

12. COUNTY OR PARISH 13. STATE
 Rio Arriba NM.

14. DISTANCE FROM PROPOSED* LOCATION TO NEAREST PROPERTY OR LEASE LINE, FT. (Also to nearest drlg. unit line, if any)
 1800'

15. DISTANCE FROM PROPOSED* LOCATION TO NEAREST WELL, DRILLING COMPLETED, OR APPLIED FOR, ON THIS LEASE, FT.
 1/2 mile

16. NO. OF ACRES IN LEASE
 1240

17. NO. OF ACRES ASSIGNED TO THIS WELL
 160

18. PROPOSED DEPTH
 2375

19. ROTARY OR CABLE TOOLS
 rotary

20. ELEVATIONS (Show whether DF, RT, GR, etc.)
 6173 GL

21. APPROX. DATE WORK WILL START*
 2-1-82

23. PROPOSED CASING AND CEMENTING PROGRAM

SIZE OF HOLE	SIZE OF CASING	WEIGHT PER FOOT	SETTING DEPTH	QUANTITY OF CEMENT
8-3/4"	7"	23#	120'	60 sx - circulate
6-1/4"	2.875"	6.4#	2375'	200 sx - to cover OjoAlamo

Propose to drill with mud, run mechanical logs, selectively perforate, test, and sand/water fracture the Pictured Cliffs Formation. BHP is not expected to exceed 800 psi.

A 10" 3000 psi WP and 6000 psi test double gate BOP with blind and pipe rams will be used for blowout prevention.

The gas is dedicated to El Paso.

IN ABOVE SPACE DESCRIBE PROPOSED PROGRAM: If proposal is to deepen or plug back, give data on present productive zone and proposed new productive zone. If proposal is to drill or deepen directionally, give pertinent data on subsurface locations and measured and true vertical depths. Give blowout prevention program, if any.

24. SIGNED Curtis J. Little TITLE Operator DATE 1-19-82
 CURTIS J. LITTLE

PERMIT NO. _____
 APPROVED BY _____ TITLE _____
 CONDITIONS OF APPROVAL, IF ANY:

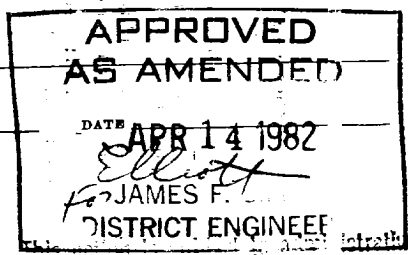
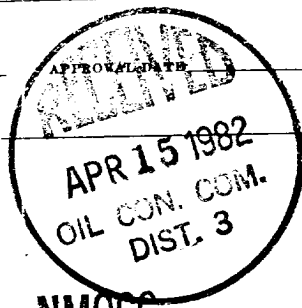

2 note
 4/12/82

NMOCC

OIL CONSERVATION DIVISION

STATE OF NEW MEXICO
ENERGY AND MINERALS DEPARTMENT

P. O. BOX 2088
SANTA FE, NEW MEXICO 87501

Form C-02
Revised 10-1-78

All distances must be from the corner boundaries of the Section.

Operator CURTIS J. LITTLE			Lease TURNER		Well No. 1
Unit Letter K	Section 22	Township 25N	Range 7W	County Rio Arriba	
Actual Footage Location of Well: 1800 feet from the South line and 2000 feet from the West line					
Ground Level Elev. 6173	Producing Formation Pictured Cliffs	Pool So. Blanco PC		Dedicated Acreage: 160	Acres

1. Outline the acreage dedicated to the subject well by colored pencil or hachure marks on the plat below.
2. If more than one lease is dedicated to the well, outline each and identify the ownership thereof (both as to working interest and royalty).
3. If more than one lease of different ownership is dedicated to the well, have the interests of all owners been consolidated by communitization, unitization, force-pooling, etc?

Yes No If answer is "yes," type of consolidation _____

If answer is "no," list the owners and tract descriptions which have actually been consolidated. (Use reverse side of this form if necessary.) _____

No allowable will be assigned to the well until all interests have been consolidated (by communitization, unitization, forced-pooling, or otherwise) or until a non-standard unit, eliminating such interests, has been approved by the Commission.

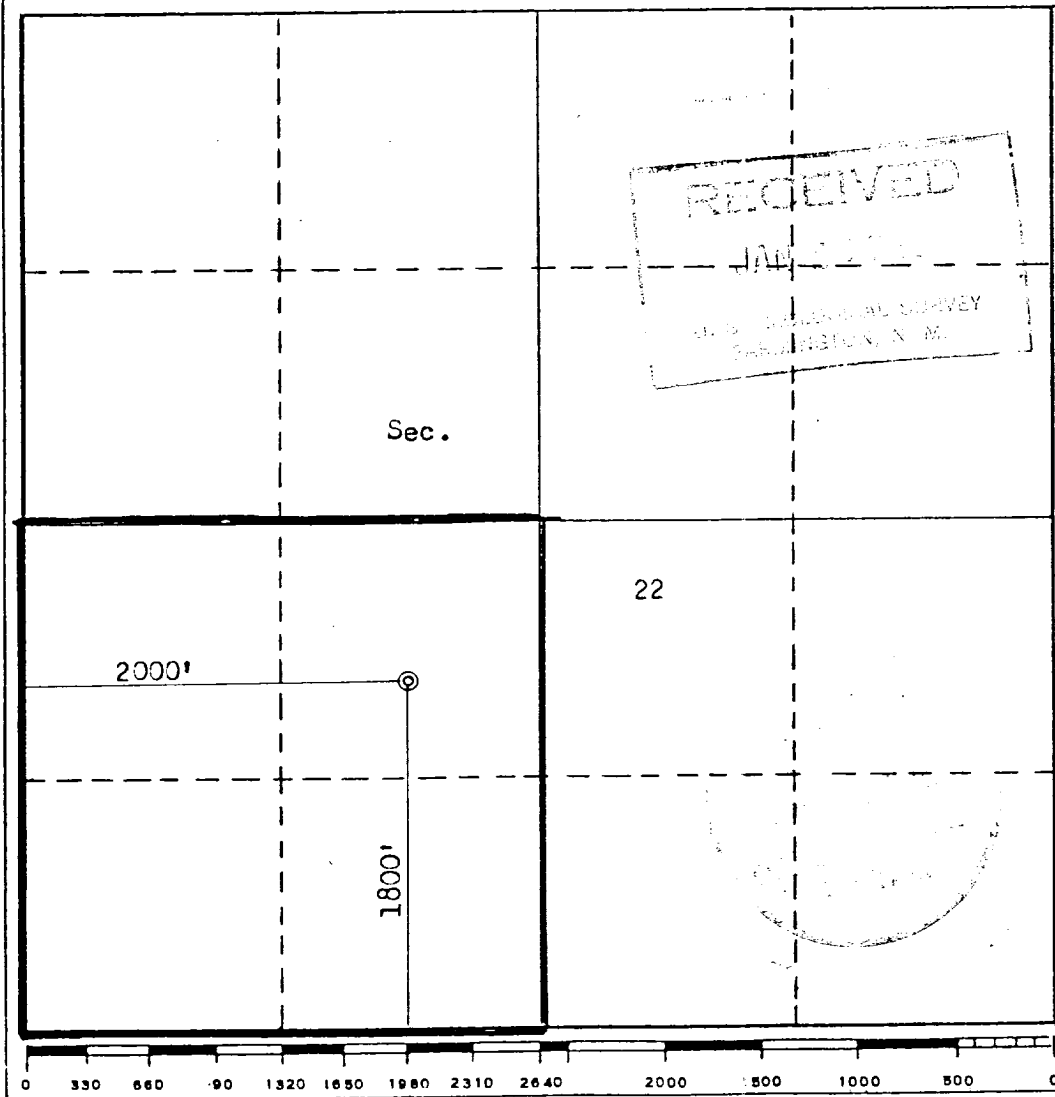

CERTIFICATION

I hereby certify that the information contained herein is true and complete to the best of my knowledge and belief.

Curtis J. Little

Name
CURTIS J. LITTLE

Position
Operator

Company
Curtis J. Little

Date
January 19, 1982

I hereby certify that the well location shown on this plat was plotted from field notes of actual surveys made by me or under my supervision, and that the same is true and correct to the best of my knowledge and belief.

Date Surveyed
December 14, 1981

Registered Professional Engineer and/or Land Surveyor
Fred B. Kerr Jr.
Fred B. Kerr Jr.

Certificate No.
3950



Vicinity Map for
 Curtis J. Little #1 Turner (ALTERNATE LOC)
 1800' FSL 2000' FWL Sec 22-T26N-R7W
 Rio Arriba County New Mexico