

UNITED STATES  
DEPARTMENT OF THE INTERIOR  
GEOLOGICAL SURVEY30-039-23051  
5. LEASE DESIGNATION AND SERIAL NO.  
SF 079491A

## APPLICATION FOR PERMIT TO DRILL, DEEPEN, OR PLUG BACK

1a. TYPE OF WORK DRILL <input checked="" type="checkbox"/> DEEPEN <input type="checkbox"/> PLUG BACK <input type="checkbox"/>			6. IF INDIAN, ALLOTTEE OR TRIBE NAME		
b. TYPE OF WELL OIL WELL <input type="checkbox"/> GAS WELL <input checked="" type="checkbox"/> OTHER <input type="checkbox"/> SINGLE ZONE <input checked="" type="checkbox"/> MULTIPLE ZONE <input type="checkbox"/>			7. UNIT AGREEMENT NAME San Juan 27-5 Unit		
2. NAME OF OPERATOR El Paso Natural Gas Company			8. FARM OR LEASE NAME San Juan 27-5 Unit		
3. ADDRESS OF OPERATOR PO Box 289, Farmington, NM 87401			9. WELL NO. 199		
4. LOCATION OF WELL (Report location clearly and in accordance with any State requirements.)* At surface 1820'N, 960'E  At proposed prod. zone			10. FIELD AND POOL, OR WILDCAT Tapacito PC		
14. DISTANCE IN MILES AND DIRECTION FROM NEAREST TOWN OR POST OFFICE* 8 miles south of Gobernador, NM			11. SEC., T., R., M., OR BLK. AND SURVEY OR AREA H Sec. 10, T-27-N, R-5-W NMPM		
15. DISTANCE FROM PROPOSED* LOCATION TO NEAREST PROPERTY OR LEASE LINE, FT. (Also to nearest drilg. unit line, if any) 1520'		16. NO. OF ACRES IN LEASE Unit	17. NO. OF ACRES ASSIGNED TO THIS WELL 160.00		
18. DISTANCE FROM PROPOSED LOCATION* TO NEAREST WELL, DRILLING, COMPLETED, OR APPLIED FOR, ON THIS LEASE, FT. 800'		19. PROPOSED DEPTH 4300'	20. ROTARY OR CABLE TOOLS Rotary		
21. ELEVATIONS (Show whether DF, RT, GR, etc.) 7302' GL			22. APPROX. DATE WORK WILL START*		

23. PROPOSED CASING AND CEMENTING PROGRAM				
SIZE OF HOLE	SIZE OF CASING	WEIGHT PER FOOT	SETTING DEPTH	QUANTITY OF CEMENT
12 1/4"	8 5/8"	24.0#	120'	106 cu.ft.circ. to surface
6 3/4"	2 7/8"	6.4#	4300'	329 cu.ft.to cover Ojo Al.

Selectively perforate and sandwater fracture the Pictured Cliffs formati

A 3000 psi WP and 6000 psi test double gate preventer equipped with blind and pipe rams will be used for blow out prevention on this well.

This gas is dedicated.

The NE/4 of Section 10 is dedicated to this well.

IN ABOVE SPACE DESCRIBE PROPOSED PROGRAM: If proposal is to deepen or plug back, give data on present productive zone and proposed new productive zone. If proposal is to drill or deepen directionally, give pertinent data on subsurface locations and measured and true vertical depths. Give blowout preventer program, if any.

24. SIGNED D. G. Brisco TITLE Drilling Clerk DATE April 15, 1982

(This space for Federal or State office use)

PERMIT NO. APPROVAL DATE

APPROVED BY TITLE  
CONDITIONS OF APPROVAL, IF ANY:

\*See Instructions On Reverse Side

NMOCC

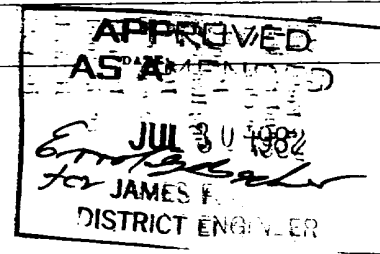

All distances must be from the outer boundaries of the Section.

Operator EL PASO NATURAL GAS COMPANY			Lease SAN JUAN 27-5 UNIT (SF 079491A)		Well No. 199
Unit Letter H	Section 10	Township 27N	Range 5W	County Rio Arriba	
Actual Footage Location of Well: 1820 feet from the North line and 960 feet from the East line					
Ground Level Elev. 7302	Producing Formation PICTURED CLIFFS		Pool TAPACITO PICTURED CLIFFS	Dedicated Acreage: 160.00 Acres	

1. Outline the acreage dedicated to the subject well by colored pencil or hatchure marks on the plat below.
2. If more than one lease is dedicated to the well, outline each and identify the ownership thereof (both as to working interest and royalty).
3. If more than one lease of different ownership is dedicated to the well, have the interests of all owners been consolidated by communitization, unitization, force-pooling, etc?

☒ Yes ☐ No If answer is "yes," type of consolidation Unitization

If answer is "no," list the owners and tract descriptions which have actually been consolidated. (Use reverse side of this form if necessary.)

No allowable will be assigned to the well until all interests have been consolidated (by communitization, unitization, forced-pooling, or otherwise) or until a non-standard unit, eliminating such interests, has been approved by the Commission. REISSUED TO SHOW LOCATION AND DEDICATION CHANGES MARCH 30, 1982

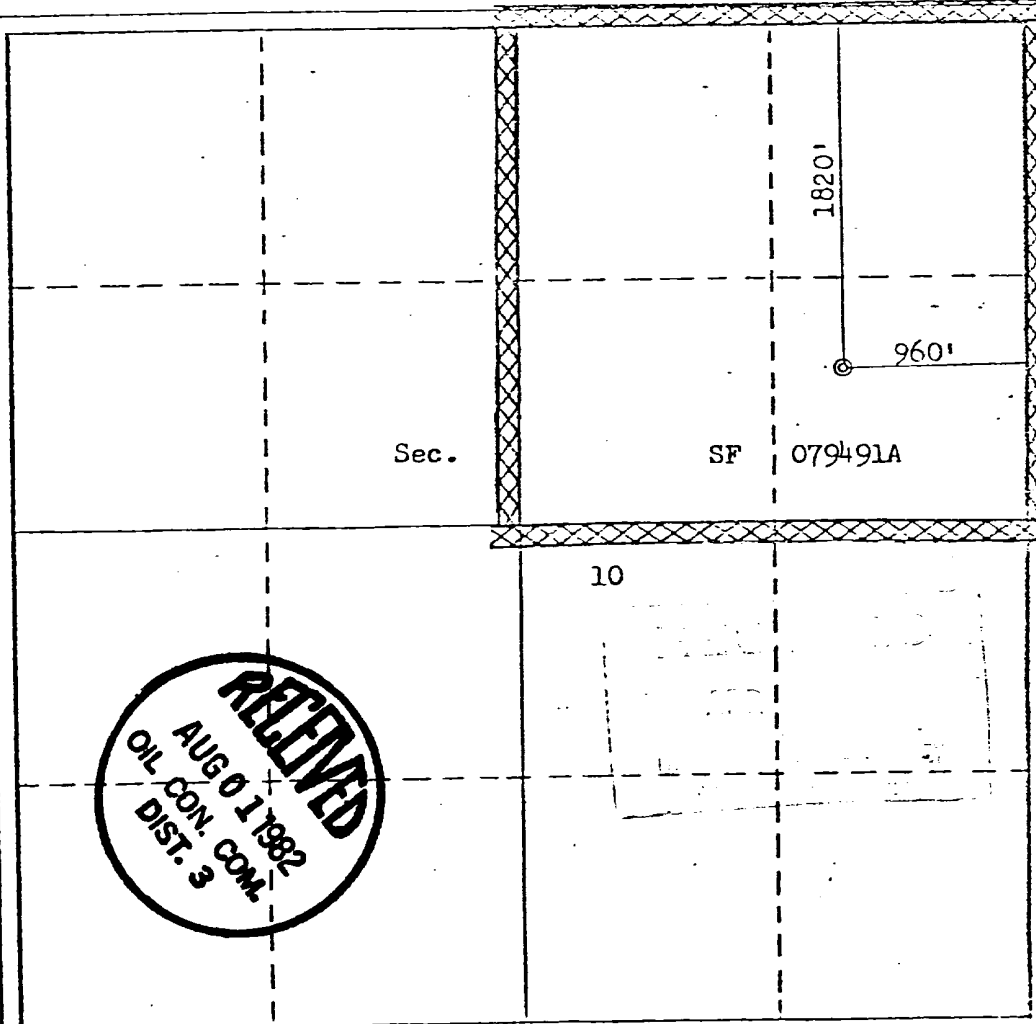

#### CERTIFICATION

I hereby certify that the information contained herein is true and complete to the best of my knowledge and belief.

*J. P. Quisco*

Name

Drilling Clerk

Position

El Paso Natural Gas Co

Company

April 15, 1982

Date

I hereby certify that the well location shown on this plat was plotted from field notes of actual surveys made by me or under my supervision, and that the same is true and correct to the best of my knowledge and belief.

Date Surveyed

March 2, 1982

Registered Professional Engineer and/or Land Surveyor

*Fred B. Kerr*  
Fred B. Kerr

Certificate No.

3950