

NEW MEXICO OIL CONSERVATION COMMISSION
WELL LOCATION AND ACREAGE DEDICATION PLAT

Form C-102
Supersedes C-128
Effective 1-1-65

All distances must be from the outer boundaries of the Section.

Operator TENNECO OIL COMPANY			Lease SAN JUAN UNIT 28-7		Well No. 166E
Unit Letter F	Section 16	Township 27N	Range 7W	County Rio Arriba	
Actual Footage Location of Well: 1600 feet from the North line and 1450 feet from the West line					
Ground Level Elev. 6613	Producing Formation Dakota		Pool Basin Dakota		Dedicated Acreage: 320 Acres

1. Outline the acreage dedicated to the subject well by colored pencil or hachure marks on the plat below.
2. If more than one lease is dedicated to the well, outline each and identify the ownership thereof (both as to working interest and royalty).
3. If more than one lease of different ownership is dedicated to the well, have the interests of all owners been consolidated by communitization, unitization, force-pooling, etc?

☒ Yes ☐ No If answer is "yes," type of consolidation Unitization

If answer is "no," list the owners and tract descriptions which have actually been consolidated. (Use reverse side of this form if necessary.)

No allowable will be assigned to the well until all interests have been consolidated (by communitization, unitization, forced-pooling, or otherwise) or until a non-standard unit, eliminating such interests, has been approved by the Commission.

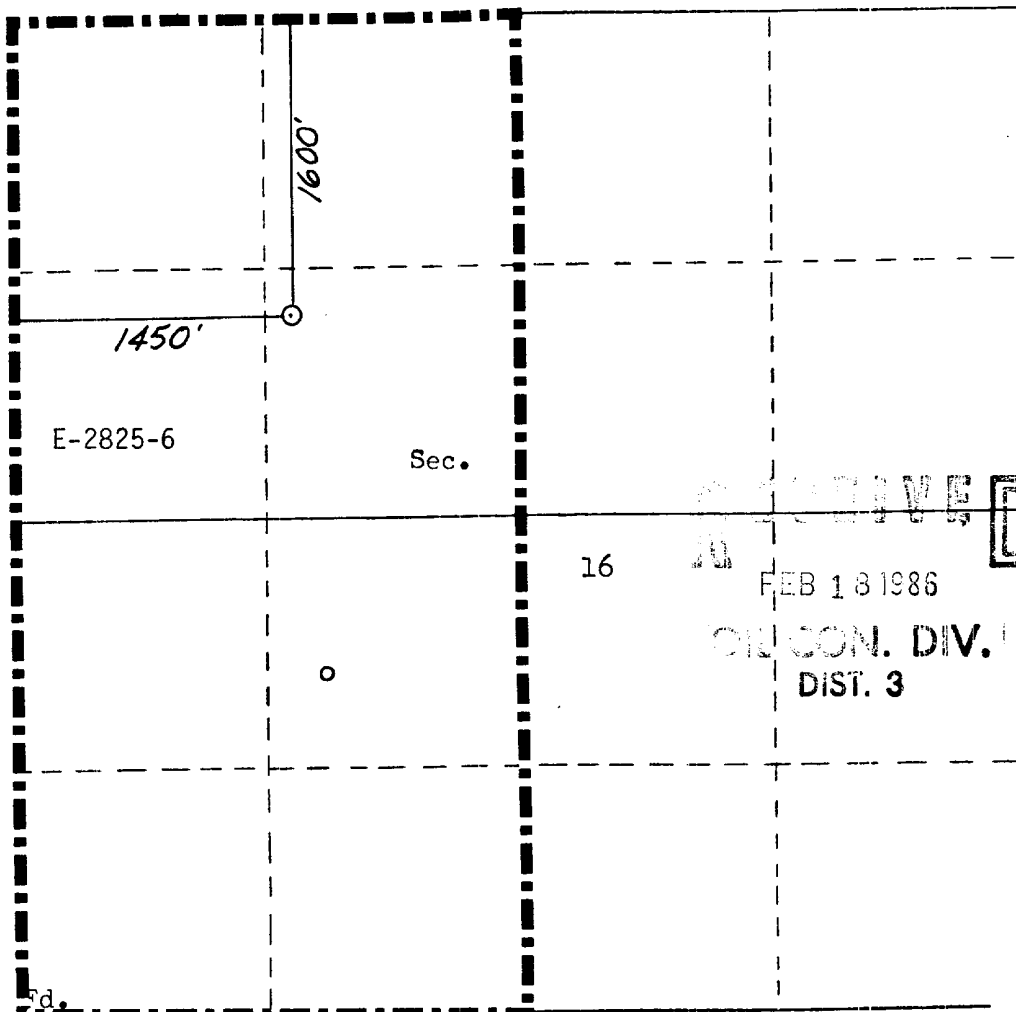

CERTIFICATION

I hereby certify that the information contained herein is true and complete to the best of my knowledge and belief.

Rick Roark
Name

Rick Roark

Position
Regulatory Analyst II

Company
Tenneco Oil Co.

Date
February 14, 1986

I hereby certify that the well location shown on this plat was plotted from field notes of actual surveys made by me or under my supervision, and that the same is true and correct to the best of my knowledge and belief.

Date Surveyed
William E. Mahanke

Registered Professional Engineer and Surveyor

William E. Mahanke
Certificate No. 8466

Scale 1"=1000'

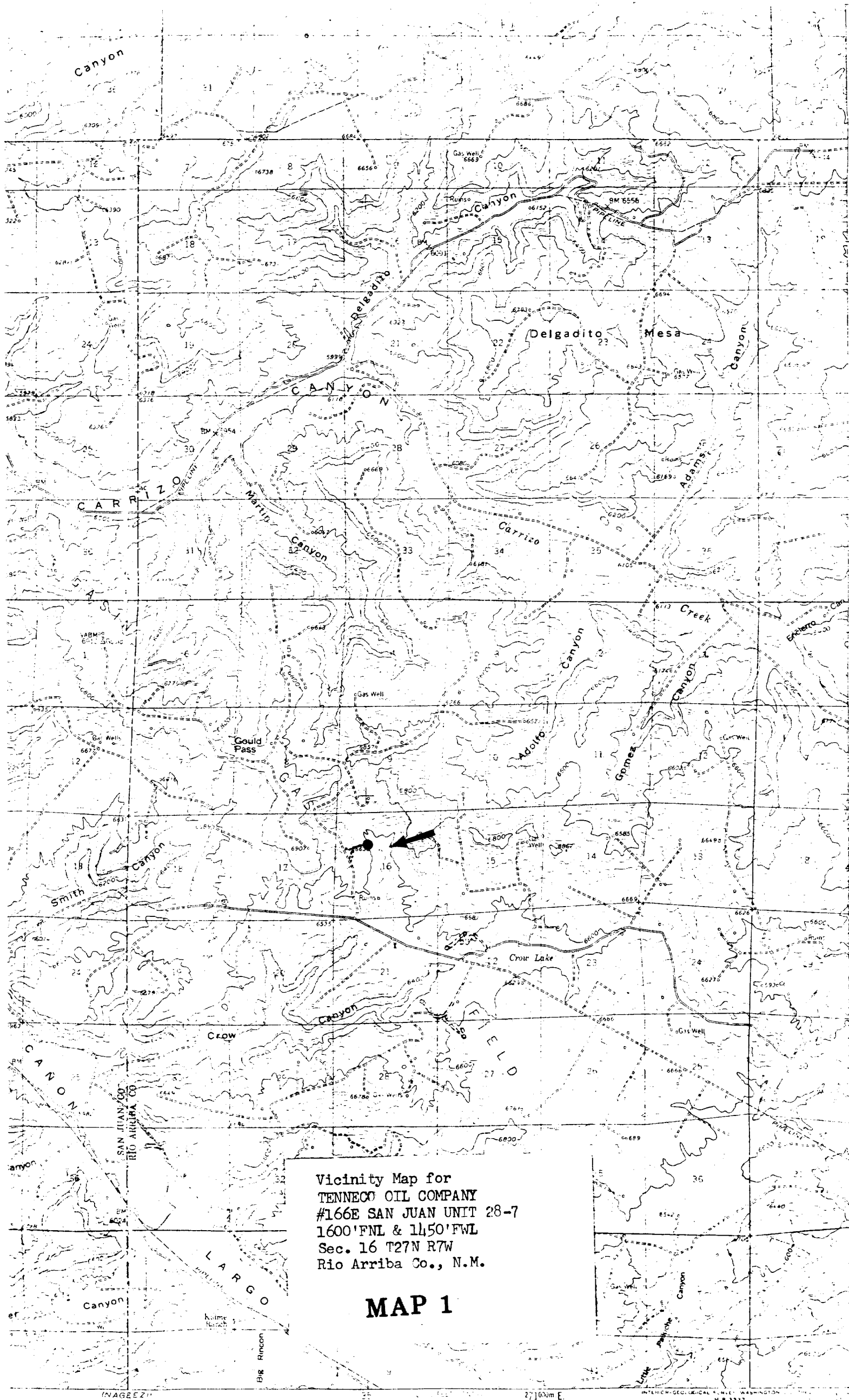

Vicinity Map for
TENNECO OIL COMPANY
#166E SAN JUAN UNIT 28-7
1600'FNL & 1450'FWL
Sec. 16 T27N R7W
Rio Arriba Co., N.M.

MAP 1

(PAGE 57)

2' 10.30m E

6.44. (c) $\frac{1}{2}$