

(SUBMIT IN TRIPLICATE)

UNITED STATES
DEPARTMENT OF THE INTERIOR
GEOLOGICAL SURVEY

Land Office Santa Fe

Lease No. SP 078953

Unit J. W. Goddard

SUNDRY NOTICES AND REPORTS ON WELLS

NOTICE OF INTENTION TO DRILL.....	<input checked="" type="checkbox"/>	SUBSEQUENT REPORT OF WATER SHUT-OFF.....
NOTICE OF INTENTION TO CHANGE PLANS.....		SUBSEQUENT REPORT OF SHOOTING OR ACIDIZING.....
NOTICE OF INTENTION TO TEST WATER SHUT-OFF.....		SUBSEQUENT REPORT OF ALTERING CASING.....
NOTICE OF INTENTION TO RE-DRILL OR REPAIR WELL.....		SUBSEQUENT REPORT OF RE-DRILLING OR REPAIR.....
NOTICE OF INTENTION TO SHOOT OR ACIDIZE.....		SUBSEQUENT REPORT OF ABANDONMENT.....
NOTICE OF INTENTION TO PULL OR ALTER CASING.....		SUPPLEMENTARY WELL HISTORY.....
NOTICE OF INTENTION TO ABANDON WELL.....		

(INDICATE ABOVE BY CHECK MARK NATURE OF REPORT, NOTICE, OR OTHER DATA)

April 21, 1958

J. W. Goddard

Well No. 3 is located 2100 ft. from S line and 1980 ft. from W line of sec. 11

N/2-SW/4 Section 11

(1/4 Sec. and Sec. No.)

26N

(Twp.)

12W

(Range)

N.M.P.M.

(Meridian)

Undesignated (Gallup)

(Field)

San Juan

(County or Subdivision)

New Mexico

(State or Territory)

The elevation of the derrick floor above sea level is _____ ft.

DETAILS OF WORK

(State names of and expected depths to objective sands; show sizes, weights, and lengths of proposed casings; indicate mudding jobs, cementing points, and all other important proposed work)

It is our intention to drill Well No. 3 to approximately 5300' to test the Gallup formation. Our casing program is as follows:

400' of 10-3/4" OD 32.75# casing, cemented with 350 sks. cement, to be circulated.

5300' of 5-1/2" OD 14# casing, cemented with 250 sks. cement.

The designated drilling unit is the N/2-SW/4 of Section 11-26N-12W, San Juan County, New Mexico.

I understand that this plan of work must receive approval in writing by the Geological Survey before operations may be commenced.

Company SKELLY OIL COMPANY

Box 426

Address Farmington, New Mexico

By (Signed) E. M. Cooper

Title District Superintendent

NEW MEXICO OIL CONSERVATION COMMISSION
Well Location and Acreage Dedication Plat

Section A.

Date April 21, 1958

Operator SKELLY OIL COMPANY Lease J. W. GODDARD
Well No. 3 Unit Letter K Section 11 Township 26 NORTH Range 12 WEST NMPM
Located 2100 Feet From THE SOUTH Line, 1980 Feet From THE WEST Line
County SAN JUAN G. L. Elevation _____ Dedicated Acreage 40 ~~40~~ Acres
Name of Producing Formation Gallup Pool Undesignated

1. Is the Operator the only owner* in the dedicated acreage outlined on the plat below?
Yes X No _____.
2. If the answer to question one is "no," have the interests of all the owners been consolidated by communitization agreement or otherwise? Yes _____ No _____. If answer is "yes," Type of Consolidation _____
3. If the answer to question two is "no," list all the owners and their respective interests below:
REF. GLO Plat dated: 19 JULY 1915

Owner

Land Description

Section B

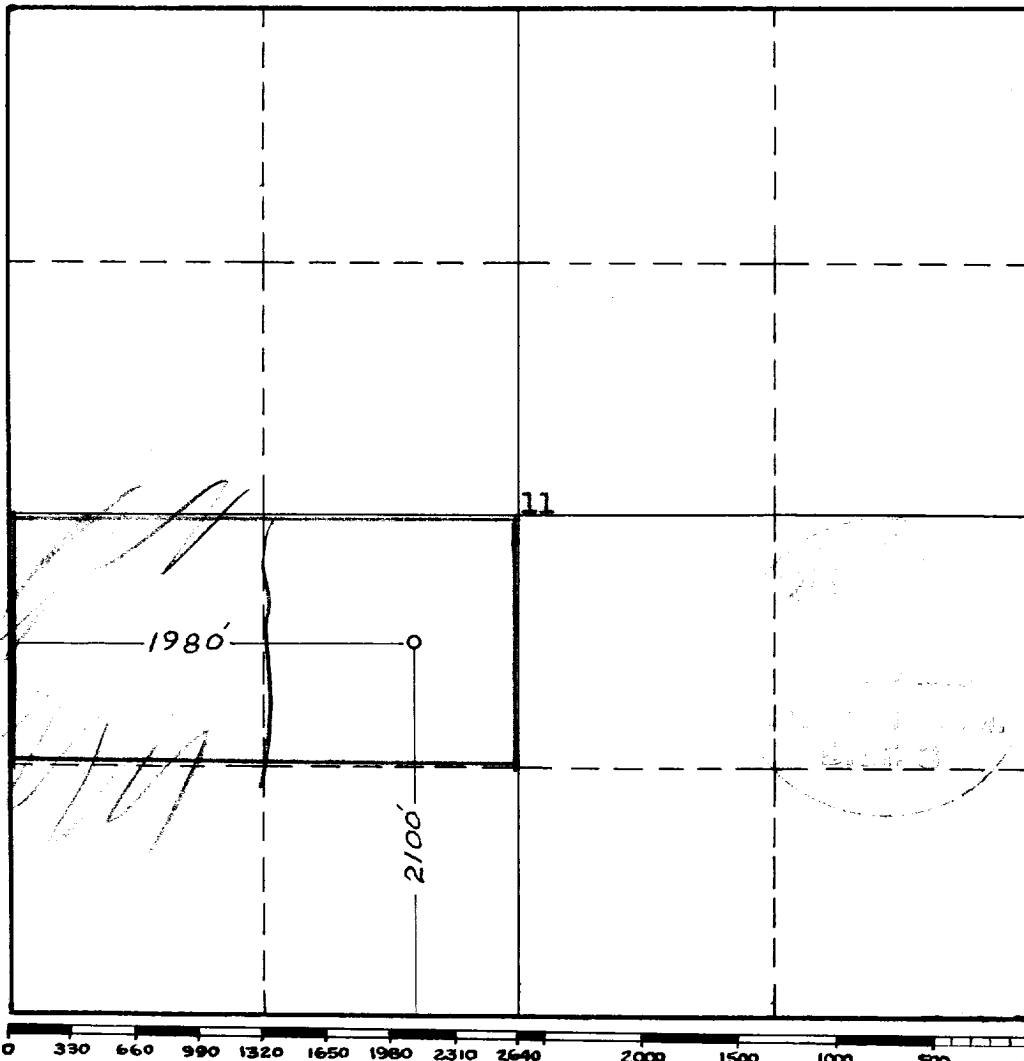

This is to certify that the information in Section A above is true and complete to the best of my knowledge and belief.

SKELLY OIL COMPANY

(Operator)

(Signed, S. M. Cooper)

(Representative)

Box 426, Farmington, New Mexico
Address

This is to certify that the well location shown on the plat in Section B was plotted from field notes of actual surveys made by me or under my supervision and that the same is true and correct to the best of my knowledge and belief.

Date Surveyed 17 APRIL 1958

James P. Leese
Registered Professional
Engineer and/or Land Surveyor.

JAMES P. LEESE

Certificate No. 1463

(See instructions for completing this form on the reverse side)